



SAFETY & OPERATING INSTRUCTIONS



EDLUND TITAN Max-Cut
Models FDW/FDWW-014, -038, -012, -16S, -14S, -38S, -12S
For Serial # 5000+

⚠ WARNING

READ AND UNDERSTAND THIS MANUAL AND ALL INSTRUCTIONS BEFORE OPERATING THE TITAN MAX-CUT.



Edlund Innovation Redefined™

319 Queen City Park Road, Burlington, VT 05401, USA 800-772-2126 www.edlundco.com
An ISO 9001:2015 Company

Table of Contents

CHAPTER 1 - INTRODUCING THE EDLUND TITAN MAX-CUT	1
Conventions used in this manual	1
Specifications for the Edlund TITAN Max-Cut.....	1
CHAPTER 2 - GENERAL SAFETY RULES	3
Labels.....	3
Operating the Edlund TITAN Max-Cut Safely.....	4
Additional information and potential changes	4
CHAPTER 3 - OPERATING YOUR EDLUND TITAN MAX-CUT	5
Using the Edlund TITAN Max-Cut	5
Changing Between Grid and Wedge Sizes	6
Using the Extra Blade Cartridge Storage Slot.....	6
Edlund TITAN Max-Cut Features	8
CHAPTER 4 - MAINTAINING THE EDLUND TITAN MAX-CUT.....	9
Cleaning and Inspection.....	9
Blade and Pusher Maintenance	10
Replacing the Blade Assembly	10
CHAPTER 5 – TROUBLESHOOTING	11
Troubleshooting Table	11
CHAPTER 6 - PARTS LISTS, DIAGRAMS, AND WARRANTY.....	12
Parts List - Edlund TITAN Max-Cut	12
Exploded View - TITAN Max-Cut.....	13
Warranty.....	15

CHAPTER 1 - INTRODUCING THE EDLUND TITAN MAX-CUT

This manual will help you set up and safely operate your new Edlund TITAN Max-Cut. Careful adherence to the safety and operating instructions in this manual will ensure many years of productive use. Please let us know of any questions you may have. To expedite your call, please have your serial number and/or order number handy. **For technical assistance, please call Toll-Free 1-800-772-2126 and one of our Customer Service Representatives will be happy to help you.**

Conventions used in this manual

⚠ WARNING (ORANGE)

THIS INDICATES A POTENTIALLY HAZARDOUS SITUATION, WHICH, IF NOT AVOIDED, COULD RESULT IN MINOR OR MODERATE INJURY.

NOTE: This information may be helpful to you.

Tip: This is a helpful hint to guide you in getting the most out of your Edlund TITAN Max-Cut.

Specifications for the Edlund TITAN Max-Cut

Model Number FDWW-014	1/4" Dice Grid (6.4mm) w/ wall mount
Model Number FDW-014	1/4" Dice Grid (6.4mm) w/ suction cup base
Model Number FDWW-038	3/8" Dice Grid (10mm) w/ wall mount
Model Number FDW-038	3/8" Dice Grid (10mm) w/ suction cup base
Model Number FDWW-012	1/2" Dice Grid (13mm) w/ wall mount
Model Number FDW-012	1/2" Dice Grid (13mm) w/ suction cup base
Model Number FDWW-16S	3/16" Slicer (5mm) w/ wall mount
Model Number FDW-16S	3/16" Slicer (5mm) w/ suction cup base
Model Number FDWW-14S	1/4" Slicer Grid (6.3mm) w/ wall mount
Model Number FDW-14S	1/4" Slicer (6.3mm) w/ suction cup base
Model Number FDWW-38S	3/8" Slicer (10mm) w/ wall mount
Model Number FDW-38S	3/8" Slicer (10mm) w/ suction cup base
Model Number FDWW-12S	1/2" Slicer (13mm) w/ wall mount
Model Number FDW-12S	1/2" Slicer (13mm) w/ suction cup base
Model Number FDW	No Base/Blade/Pusher

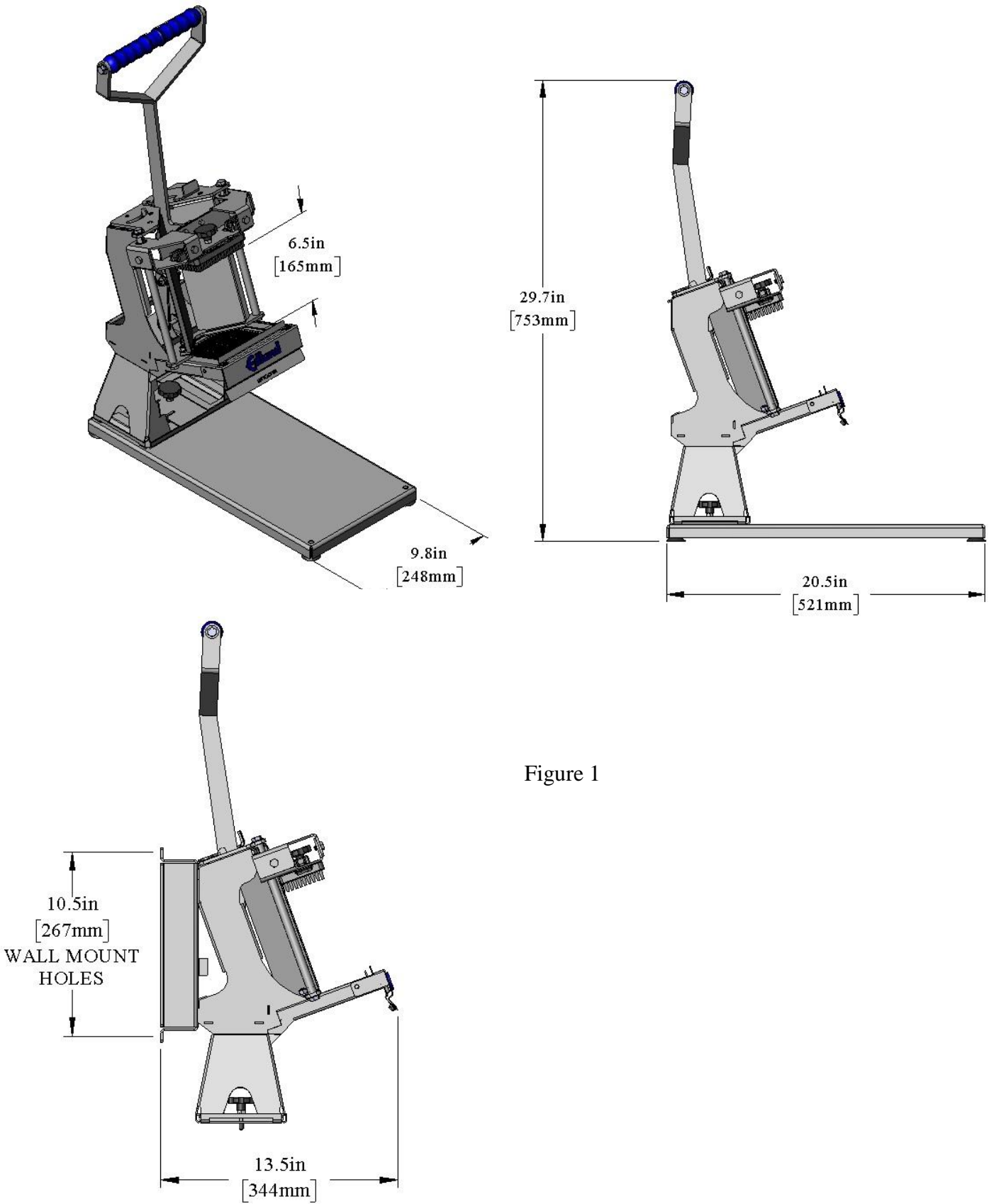

Figure 1

CHAPTER 2 - GENERAL SAFETY RULES

⚠ WARNING

READ THIS SAFETY AND OPERATING MANUAL BEFORE YOU USE THE EDLUND TITAN MAX-CUT. BECOME FAMILIAR WITH THE SERVICE RECOMMENDATIONS TO ENSURE THE BEST PERFORMANCE FROM YOUR MAX-CUT.

Labels

Your Edlund TITAN Max-Cut carries prominent labels as reminders for its proper and safe use. Shown below are copies of all the labels that appear on the equipment. Take a moment to study them and make a note of their location on your Edlund TITAN Max-Cut *before* you operate the Max-Cut. Replace damaged or missing safety and information labels immediately.



Warning #L316



Read Manual #L228



Cut Hazard #L229

Operating the Edlund TITAN Max-Cut Safely

WARNING

YOU MUST OPERATE THE MAX-CUT SAFELY. UNSAFE OPERATION MAY RESULT IN A NUMBER OF HAZARDOUS CONDITIONS. THE MAX-CUT CAN CUT, AND SEVER PARTS OF YOUR BODY IF THEY BECOME CAUGHT BETWEEN THE BLADES AND THE PRODUCT BEING CUT. ALWAYS TAKE THE FOLLOWING PRECAUTIONS WHEN USING THE MAX-CUT:

- NEVER ALLOW PEOPLE WHO ARE UNFAMILIAR WITH THESE INSTRUCTIONS TO USE THE MAX-CUT.
- NEVER ALLOW CHILDREN TO OPERATE THE MAX-CUT.
- ALWAYS OPERATE THE MAX-CUT FROM DIRECTLY IN FRONT WITH THE CARTRIDGE RETAINER CLOSED.
- ALWAYS OPERATE THE MAX-CUT WITH BOTH HANDS ON THE HANDLE.
- ALWAYS USE THE WASH GUARD DURING WASHING AND STORAGE OF THE BLADE CARTRIDGE.
- IN CASE OF JAMMED PRODUCE IN THE BLADES AREA, USE EXTREME CAUTION WHEN DISLODGING.
- DO NOT ATTEMPT TO REMOVE JAMMED PRODUCE WITH BARE HAND. REMOVE THE BLADE CARTRIDGE AND SPRAY AND RINSE IN THE SINK.
- WE RECOMMEND WEARING PROTECTIVE GOGGLES OR SAFETY GLASSES WITH SIDE SHIELDS WHILE CUTTING PRODUCT TO PROTECT YOUR EYES FROM POSSIBLE SPLASHING OF LIQUID FROM THE PRODUCT.
- DO NOT, UNDER ANY CONDITIONS, REMOVE, BEND, CUT, FIT, WELD, OR OTHERWISE ALTER STANDARD PARTS ON THE EDLUND TITAN MAX-CUT. MODIFICATIONS COULD CAUSE PERSONAL INJURIES AND WILL VOID YOUR WARRANTY.
- CHECK THE BLADES FOR WEAR, CRACKS, DENTS AND BENDS.
- DO NOT OPERATE THE MAX-CUT WHEN UNDER THE INFLUENCE OF ALCOHOL, DRUGS, OR MEDICATION.
- INSPECT THE MAX-CUT BEFORE AND AFTER OPERATING EACH DAY OR SHIFT AND AFTER ANY CHANGE OR ADJUSTMENT FOR:
 - ⇒ LOOSE SCREWS,
 - ⇒ ALL COVERS AND GUARDS ARE IN PLACE,
 - ⇒ DAMAGED OR WORN PARTS,
 - ⇒ BENT BLADES & PUSHERS,
 - ⇒ DAMAGED OR LOOSE BLADES,
 - ⇒ NO BROKEN WELDS AND,
 - ⇒ ASSURE THAT THE MAX-CUT HAS RECEIVED A THOROUGH CLEANING.

Tip: Reference Chapter 5 for Troubleshooting tips.

No list of Warnings and Cautions can be all-inclusive. If situations occur that are not covered by this manual, the operator must apply common sense and operate this machine in a safe manner.

Additional information and potential changes

The Edlund Company reserves the right to discontinue, change, and improve its products at any time without notice or obligation to the purchaser. The descriptions and specifications contained in this manual were in effect at printing. Equipment described within this manual may be optional. Some illustrations may not be applicable to your TITAN Max-Cut.

CHAPTER 3 - OPERATING YOUR EDLUND TITAN MAX-CUT

This chapter covers the procedures for operating your new Edlund TITAN Max-Cut and discusses basic operation features. You may find it helpful to review the Features in Figure 2 on page 9.

Using the Edlund TITAN Max-Cut

Mounting the Wall Bracket

The TITAN Max-Cut can be mounted to the wall using the Wall Mount Bracket. Models FDWW-xxx include the Wall Mount Bracket. Additional Wall Mount Brackets can be purchased separately. To attach the Bracket to the wall, select the preferred location for the Bracket, taking into account the size and space needed to operate the TITAN Max-Cut (see Figure 1). Orient the Bracket vertically, with the mounting hooks pointing up. Align the two mounting holes to be centered on a wall stud. Use appropriate sized Lag Screws capable of holding a minimum of 150 lbs to secure the Wall Mount to the wall. It is very important the Wall Mount Bracket is securely fastened to a wall before use. If you are unsure of how to fasten the Wall Mount Bracket, please consult a professional contractor for installation.

1. Your Max-Cut has been configured to one of the following sizes: 1/4" Dice Grid, 3/8" Dice Grid, 1/2" Dice Grid, 3/16" Slice, 1/4" Slice, 3/8" Slice, 1/2" Slice, 6-Slice Wedger or an 8-Slice Wedger. Verify the Blades and Pusher match by checking the size stamp on both.

⚠ WARNING

USE CAUTION WHEN HANDLING THE BLADE CARTRIDGE, THE BLADES ARE VERY SHARP. ALWAYS HAVE THE WASH GUARD ATTACHED TO THE BLADE CARTRIDGE WHEN HANDLING.

2. Lift the Handle Arm to its full upright position.
3. Engage the Handle Latch by rotating clockwise (Figure 2 on page 9).
4. Open the Cartridge Retainer (Figure 2 on page 9) by rotating it up. Orient the selected Blade Cartridge and slide it into the Max-Cut. The Blade Cartridge can only go into the unit in one orientation, with the Front Flange down and the Cartridge Alignment Holes towards the back of the unit.
5. Make sure the Cartridge Alignment Holes (Figure 2 on page 9) are fully seated on the Alignment Pins in the Max-Cut unit.
6. Fully close the Cartridge Retainer by rotating it downward until it "snaps" over the Blade Cartridge.

NOTE: The Cartridge Retainer will not close until the Blade Cartridge is fully seated into the Max-Cut. Do not operate without the Cartridge Retainer end cap fully closed and "snapped" down.

7. Place a container at the front of the Max-Cut, beneath the Blades to receive the cut product.
8. Place the product to be cut on the Blades, against the V-Bed.
9. Disengage the Handle Latch by rotating counterclockwise (Figure 2 on page 9).
10. With both hands on the Handle, pull the Handle Arm all the way down. The cut produce will fall into the container.
11. Place more produce in the Max-Cut and repeat as required.

NOTE: Experience will dictate how fast you should lower the Handle Arm with a continuous fluid motion. For diced produce, slice to desired thickness first, and then place on the dicing grid. It is not recommended to cut more than 2 layers of produce per dicing action.

Changing Between Grid and Wedge Sizes

1. If a Blade Cartridge and Pusher are already mounted on the Max-Cut, remove them following the "**Cleaning and Inspection**" instructions (**Chapter 4**).
2. Verify that the Grid or Wedge size of the desired Blade Cartridge and Pusher match.
3. Install the Pusher by aligning the two rubber stoppers with the slots on the Pusher Plate. Push the rubber stoppers up, aligning the pins on the Plastic Pusher with the alignment holes on the Pusher Plate. Continue to slide the Plastic Pusher up until completely flush against the Pusher Plate. Turn Pusher Lock Knob clockwise to firmly attach Plastic Pusher to the Pusher Plate.
4. Install the Blade Cartridge by following the "**Using the Edlund TITAN Max-Cut**" instructions.
5. Check the clearance between the Pusher Tips and the Blades: the Pusher Tips should be spaced evenly between the Blades. Refer to the **Troubleshooting** section (**Chapter 5**) for information on how to diagnosis misalignment of the Pusher and blades.

Using the Extra Blade Cartridge Storage Slot

1. A Wash Guard should be attached to the Blade Cartridge before inserting into the Extra Storage Slot. Attach the Wash Guard following the "**Clean and Inspection**" instructions (**Chapter 4**).
2. Flip the Blade cartridge over so the underside is on top.
3. Start by sliding the rear of the Blade Cartridge into the front cutouts of the Storage Slot.
4. Slide the Blade Cartridge all the way to the back, aligning the Blade Cartridge with the cutouts in the rear of the Titan Max-cut unit.
5. Continue to slide the Blade Cartridge until the front flange, now on the top, stops against the frame of the Max-Cut.
6. To remove the Blade Cartridge: Lift up the front of the Blade Cartridge and pull away from the Base.

Changing Between Table and Wall Mount

The Edlund TITAN Max-Cut can be used in several different locations, maximizing productivity. Select from one of the options below which outline the procedures for removing and changing between the various mounting options.

Installing the Max-Cut on the Suction-cup Stand

1. Remove any Blade Cartridges from the Extra Cartridge Storage Slot (Figure 2, page 9). See **"Using the Extra Blade Cartridge Storage Slot"** for instructions.
2. Lift the Handle to its full upright position.
3. Rotate the Handle Latch (Figure 2, page 9) clockwise to secure the Handle in the upright position.
4. Place the Max-Cut on the Suction-Cup Stand, positioning the Base Mounting Hooks (Figure 2, page 9) on the Stand within the corresponding notches in the Max-Cut Base.
5. Slide the Max-Cut to the left until the Alignment Tabs (Figure 2, page 9) fully engage with the notches in the Base of the Max-Cut.
6. Turn the Base Locking Knob (Figure 2, page 9) clockwise until it is tight against the Base of the Max-Cut.

Removing the Max-Cut from the Suction-cup Stand

1. Remove any Produce Pans from the Discharge Area below the Blades.
2. Remove any Blade Cartridges from the Extra Cartridge Storage Slot (Figure 2, page 9). See **"Using the Extra Blade Cartridge Storage Slot"** for instructions.
3. Lift the Handle to its full upright position.
4. Rotate the Handle Latch (Figure 2, page 9) clockwise to secure the Handle in the upright position.
5. Unscrew the Base Locking Knob (Figure 2, page 9) until it disengages from the Suction-Cup Stand.
6. Slide the Max-Cut to the right, disengaging the Base Mounting Hooks in the Stand from the unit.
7. Lift the Max-Cut away from the Stand.

Installing the Max-Cut on the Wall Mount Bracket

1. Remove any Blade Cartridges from the Extra Cartridge Storage Slot (Figure 2, page 9). See **"Using the Extra Blade Cartridge Storage Slot"** for instructions.
2. Lift the Handle to its full upright position.
3. Rotate the Handle Latch (Figure 2, page 9) clockwise to secure the handle in the upright position.
4. Ensure the Wall Bracket Latch (Figure 2, page 9) is not engaged by rotating clockwise, to the unlock position.
5. Align the Mounting Hooks (Figure 2, page 9) with the Notches on the Rear of the Max-Cut.
6. Lower the Max-Cut until it is fully seated within the Wall Mounting Hooks, ensure both Mounting Hooks are engaged.
7. Rotate the Wall Bracket Latch (Figure 2, page 9) counterclockwise to engage with the Wall Mount Bracket.

Removing the Max-Cut from the Wall Mount Bracket

1. Remove any Blade Cartridges from the Extra Cartridge Storage slot (Figure 2, page 9). See **"Using the Extra Blade Cartridge Storage Slot"** for instructions.
2. Lift the Handle to its full upright position.
3. Rotate the Handle Latch (Figure 2, page 9) clockwise to secure the Handle in the upright position.
4. Rotate the Wall Bracket Latch (Figure 2, page 9) clockwise to disengage from the Wall Mount Bracket.
5. Lift the Max-Cut straight up until the Wall Mounting Hooks on the Wall Mount Bracket are disengaged from the Max-Cut.

Edlund TITAN Max-Cut Features

NOTE: The model shown in Figure 2 may look slightly different from your Max-Cut.

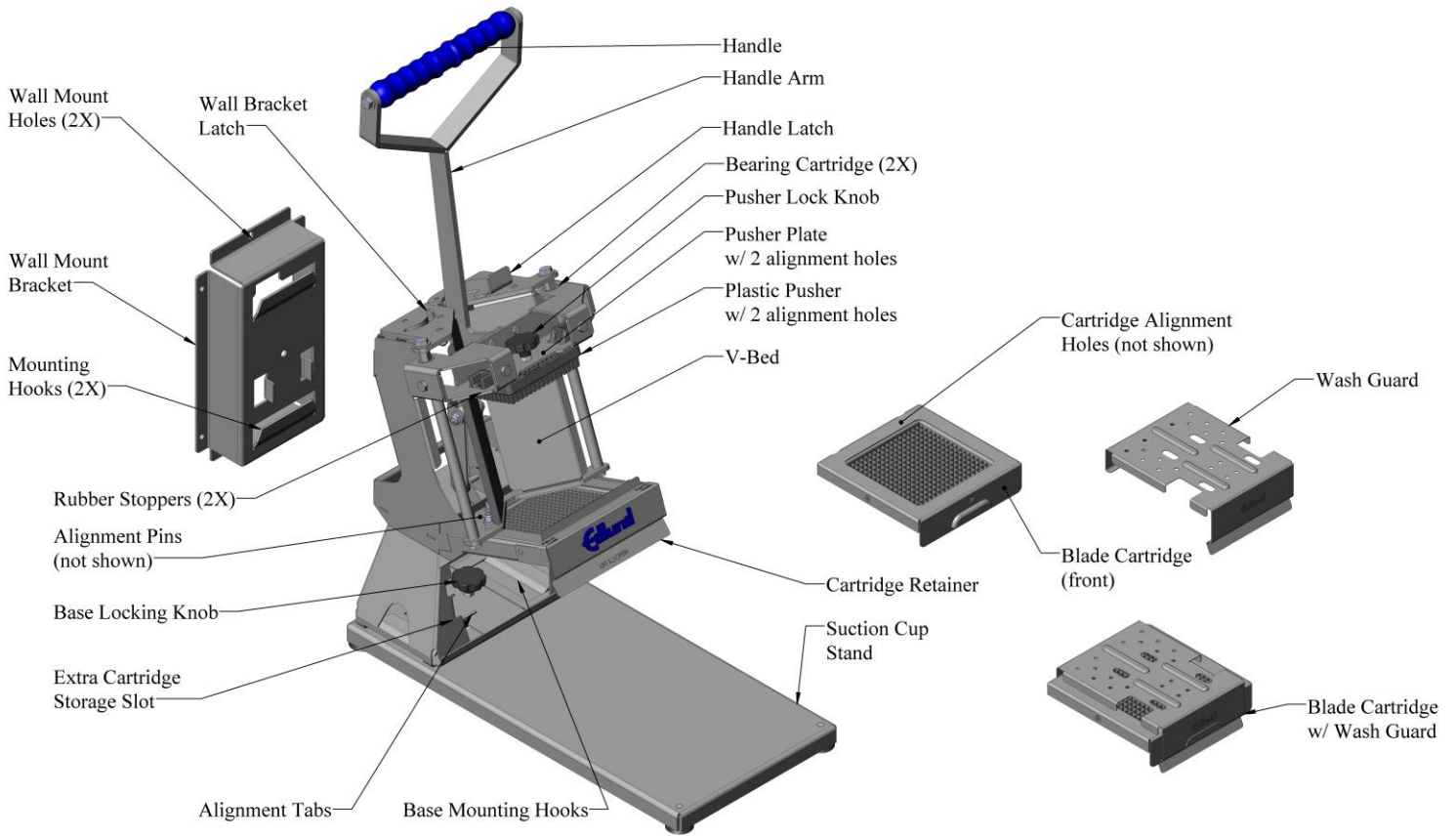

Figure 2

CHAPTER 4 - MAINTAINING THE EDLUND TITAN MAX-CUT

This chapter covers regular maintenance procedures that will ensure the best performance and long life of your Max-Cut. You should always clean the Max-Cut after every use.

WARNING

USE CAUTION WHEN HANDLING THE BLADE CARTRIDGE, THE BLADES ARE VERY SHARP. ALWAYS HAVE THE WASH GUARD ATTACHED TO THE BLADE CARTRIDGE WHEN HANDLING.

Cleaning and Inspection

1. Lift the Handle Arm to its full upright position.
2. Rotate the Handle Bracket (Figure 2, page 9) clockwise to secure the Handle in the upright position.
3. Pull the Bottom Flange of the Cartridge Retainer (Figure 2, page 9) upward to disengage from the Blade Cartridge. Rotate the Cartridge Retainer upward until it is clear of the Blade Cartridge.
4. Slide the Blade Cartridge out of the Max-Cut by gripping the Front Flange of the Blade Cartridge and pulling it away from the unit.
5. Remove the Pusher Assembly by unscrewing the Pusher Lock Knob (Figure 2, page 9). Then slide the Plastic Pusher down, away from the bottom of the Pusher Plate.

NOTE: The Pusher can now be thoroughly cleaned using normal cleaning methods such as a bristled brush, soap and rinsed with water through the patent pending Wash-Through Slots on the rear of the Plastic Pusher.

6. Place the plastic Pusher in the Blade Cartridge, aligning the Pusher tips with the corresponding openings in the Blade Cartridge. The Plastic Pusher tabs should be closest to the Front Flange of the Blade Cartridge (Figure 3, page 11).
7. Attach the Wash Guard by hooking the rear of the Wash Guard over the rear of the Blade Cartridge (Figure 3, page 11). Center the Wash Guard on the Blade Cartridge and rotate the Wash Guard down, aligning the Pusher Plastic Clips with the large Notches in the Wash Guard. Continue to rotate the Wash Guard down until the Front "snaps" over the louver on the front Flange of the Blade Cartridge.

NOTE: The Wash Guard can be attached to the Blade Cartridge with or without the plastic Pusher, if desired.

8. Wash the Blade Cartridge assembly by hand or in a dishwasher. The Blade Cartridge should always be washed with the Wash Guard installed. The components of the Edlund Titan Max-Cut are completely dishwasher safe.
9. After washing, inspect the Blades for nicks, bends and other damage. If damaged, replace or return to Edlund for repair.

NOTE: Do not allow product waste to remain on the Max-Cut. Dried waste deposits are unsanitary and may affect the operation of the Max-Cut.

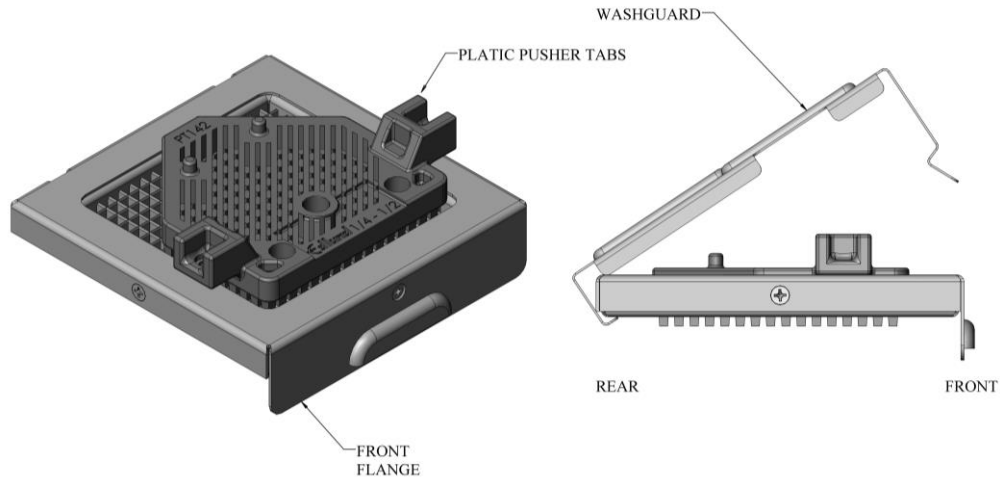

Figure 3

Blade and Pusher Maintenance

1. Examine the Pusher Tips and Rubber Stoppers. The Pusher Tips should not be damaged or missing. If they are damaged, replace the plastic Pusher. Replace the Rubber Stoppers if damaged or missing.
2. Check the clearance between the Pusher Assembly Tips and the Blades. Make sure they do not rest on or touch the Blades at any point during the Pusher travel.

Replacing the Blade Assembly

1. If there is damage to the Blade Cartridge Frame, replace the entire Blade Cartridge.
2. Individual Blades cannot be replaced. Contact the Edlund Company for information on Blade Cartridge refurbishment programs.

CHAPTER 5 – TROUBLESHOOTING

Consult the Troubleshooting Table below for common problems and their solutions. If you continue to experience problems, call our Technical Support Representatives at **1-800-772-2126**.

Troubleshooting Table

⚠ WARNING

USE CAUTION WHEN HANDLING THE BLADE CARTRIDGE, THE BLADES ARE VERY SHARP. ALWAYS HAVE THE WASH GUARD ATTACHED TO THE BLADE CARTRIDGE WHEN HANDLING.

SYMPTOM	POSSIBLE CAUSE
The Cartridge Retainer will not close.	<ul style="list-style-type: none"> ⇒ Make sure the Blade Cartridge is fully inserted into the Max-Cut Frame and the Alignment Pins are engaged. ⇒ Make sure the Blade Cartridge is inserted in the correct orientation (with the Alignment Holes inward) and the Front Flange on the Blade Cartridge down. ⇒ Debris may be jammed in the Latch area. Remove any debris and clean the Latch area. ⇒ The End Cap is bent or damaged; replace the End Cap.
The Pusher Assembly Tips hit the Blades.	<ul style="list-style-type: none"> ⇒ The Blade Cartridge is not fully inserted into the Frame; see Chapter 3 "Using the Edlund TITAN Max-Cut". ⇒ The Plastic Pusher is not fully secured to the Pusher Plate. Check to ensure the Pusher Alignment Pins are aligned with the corresponding holes in the Pusher Plate. ⇒ The Pusher Assembly and the Blade Cartridge do not match. Insert the correct matching Blade Cartridge. See page 9. ⇒ Make sure the Blade Cartridge Assembly hardware is tight. ⇒ The Blades are bent out of shape; replace the Blade Cartridge. ⇒ The Guide Rod hardware is loose. Contact Edlund Customer Service for further assistance. ⇒ If the clearance between the Pusher Assembly Tips and the Blades cannot be achieved, contact Edlund Customer Service for further instruction.
Rough or Sticky Operation	<ul style="list-style-type: none"> ⇒ Inspect Guide Rods for dirt, food residue, or other contaminants. ⇒ Clean guide rods and operate the Max-Cut a few times to expose potentially missed contaminants. ⇒ It may be beneficial to apply a small amount of food grade lubricant (such as Drakeol 35 Mineral Oil) to the Guide Rods and handle/pusher linkages.

CHAPTER 6 - PARTS LISTS, DIAGRAMS, AND WARRANTY

Parts List - Edlund TITAN Max-Cut

NOTE: Part numbers listed are available through the Edlund Company or authorized parts supplier.

<u>Part#</u>	<u>Description</u>	
AS042	QUICK CHANGE KNOB, TITAN	1
AS070	ASSY, QUICK CHANGE KNOB, TITAN PUSHER	1
BK113	DICER, WALLMOUNT LOCKLATCH	1
BK125	HANDLE LATCH, TITAN	1
BK210	TITAN PUSHER, TOP	1
BK211	TITAN PUSHER, BOTTOM	1
BK214	BRACKET, CENTER HANDLE LINKAGE	1
BK219	BRACKET, LINKAGE MOUNT	1
BK222	BRACKET, MAX-CUT GUIDE PLATE	2
BK227	TITAN PUSHER BRACKET, LEFT, RIGHT	2
CV071	COVER, TITAN	1
G082M	GRIP, SLICERS, MODIFIED	2
KT210	KIT, TITAN PUSHER BEARINGS	2
N032	NUT, 1/4-20 S/S NYLOCK	13
N059	NUT, 10-32 S/S NYLOCK	6
P215	PLATE, TITAN TOP	1
P216	PLATE, TITAN BOTTOM	1
R210	ROD, TITAN	2
S040	SCREW, 1/4-20 X 3/8 S/S HEX HEAD	4
S050	SCREW, 10-32 X 5/8" S/S, HEX HEAD	2
S058	SCREW, 5/16-18 X 3/4 S/S HEX HEAD	6
S883	SPACER, .75OD X .312ID X .375L	2
S920	SCREW, 1/4-20 x 1-5/8", 18-8, HEX HEAD	2
S925	SCREW, 1/4-20 X 1-1/8", S/S, HEX HEAD	1
W006	WASHER, FLAT NYLON, .032 THICK	2
W010	WASHER, #10 S/S	4
W015	WASHER, 1/4", FLAT, S/S	14
W016	WASHER, 5/16" S/S FLAT	6
WA007	FLAT WASHER, NYLON, FITS 3/8 IN.	4
WD090	WELDMENT, SLICER HANDLE TUBE	1
WD127	WELDMENT, TITAN FRAME	1
WD229	WELDMENT, TITAN HANDLE	1

Exploded View - TITAN Max-Cut

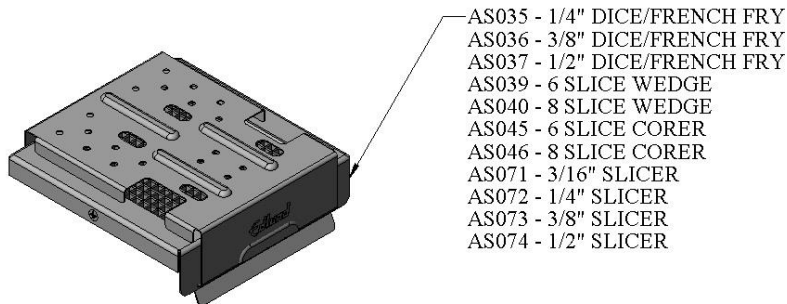
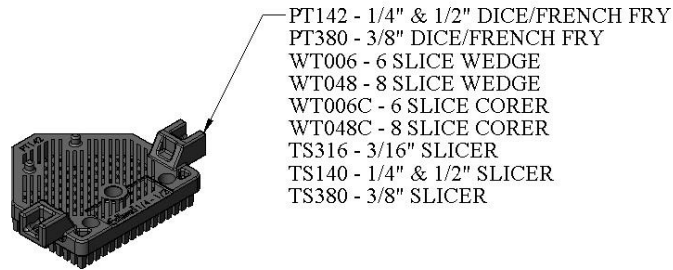
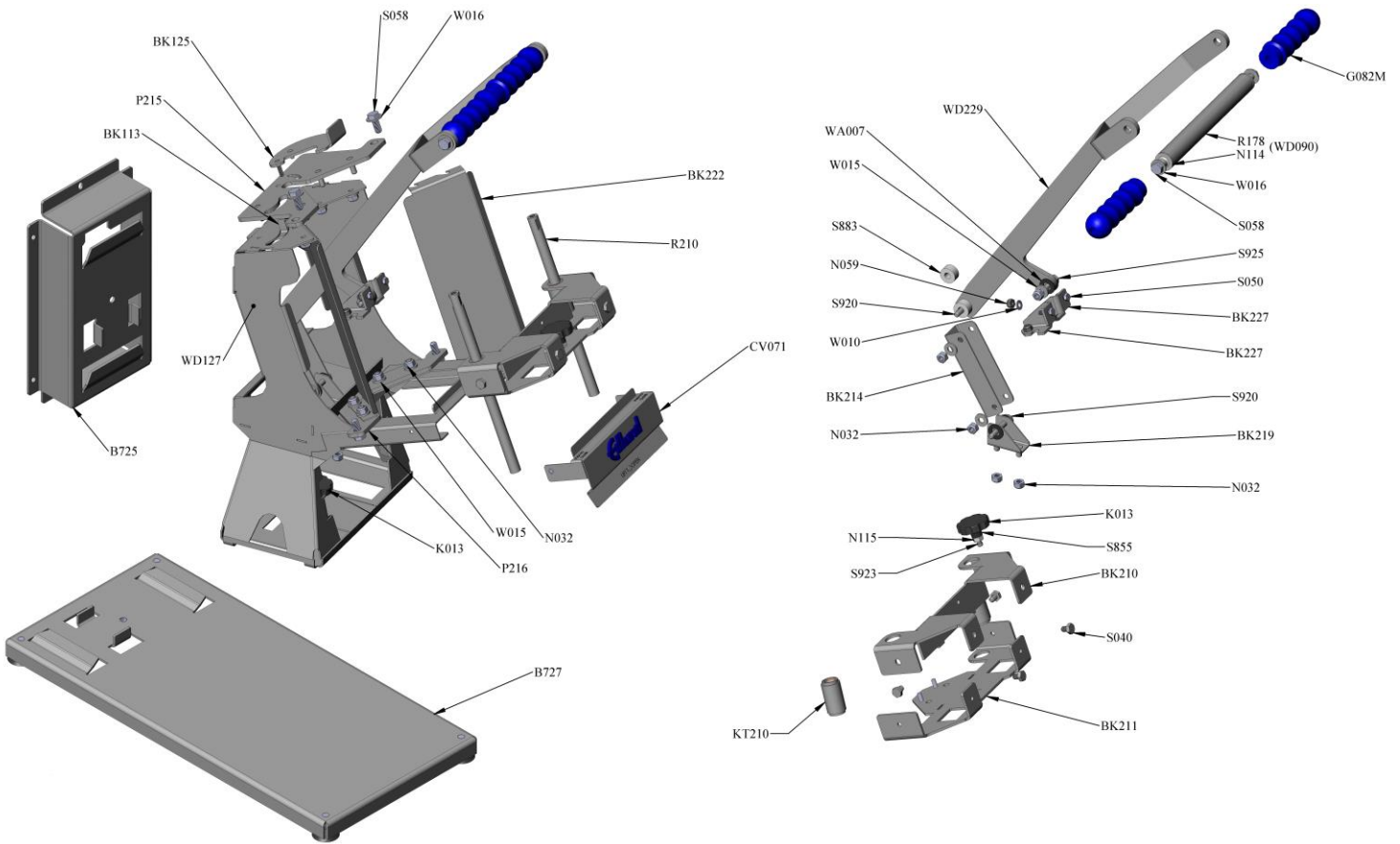

THIS PAGE INTENTIONALLY LEFT BLANK



TITAN Max-Cut

Models FDW/FDWW-014, -038, -012, -16S, -14S, -38S, -12S

WARRANTY:

All Edlund products are guaranteed against defects in material and workmanship for a period of one year from date of purchase, except where specifically noted. The company's obligation under this warranty is limited to repairing or replacing without charge any part or parts found to be defective **under normal use**. It is the responsibility of the purchaser to return the entire unit to the factory, **properly packed, transportation charges prepaid**. This warranty does not cover knives and gears on can openers. No other warranty, written or verbal, is authorized by the company. Warranty charges do not include state, federal, foreign, excise, municipal, or other sales or use taxes. All such taxes are the responsibility of the purchaser.

Carrier is responsible for merchandise in transit to you.

Edlund Company reserves the right to make changes in design or add any improvements on any product. The right is always reserved to modify our equipment because of factors beyond our control and government regulations. Charges to update equipment do not constitute a warranty charge.

The following are not covered under warranty:

1. failure from neglect, abuse, careless handling or mis-application of unit.
2. failure caused by improper maintenance.

Return products to: Edlund Company, LLC, Service Department
319 Queen City Park Rd., Burlington, VT 05401, USA
An ISO 9001:2015 Company

Phone: (800) 772-2126 & (802) 862-9661 • Fax: (802) 862-4822