

Work Table Drawers



INCLUDED PARTS

- A** Assembled Drawer

TOOLS NEEDED

- Screwdriver
- Drill with appropriate Drill Bit
- (8) Self-tapping sheet metal screws per drawer
- Allen Wrench

PRIOR TO INSTALLATION

- If you bought your table and drawers at the same time, install the drawers BEFORE assembling the table.
- If you are mounting drawers to an existing table, remove the tabletop using an allen wrench to unscrew the legs from the tabletop's gussets and lifting it off.



DO NOT ATTEMPT TO INSTALL THE DRAWER ON A FULLY ASSEMBLED TABLE

ATTACHING THE DRAWER TO TABLETOP

1 Set the tabletop upside down on a surface that won't scratch it before assembling.

2 Flip the drawer upside down so the mounting brackets rest on the underside of the tabletop.

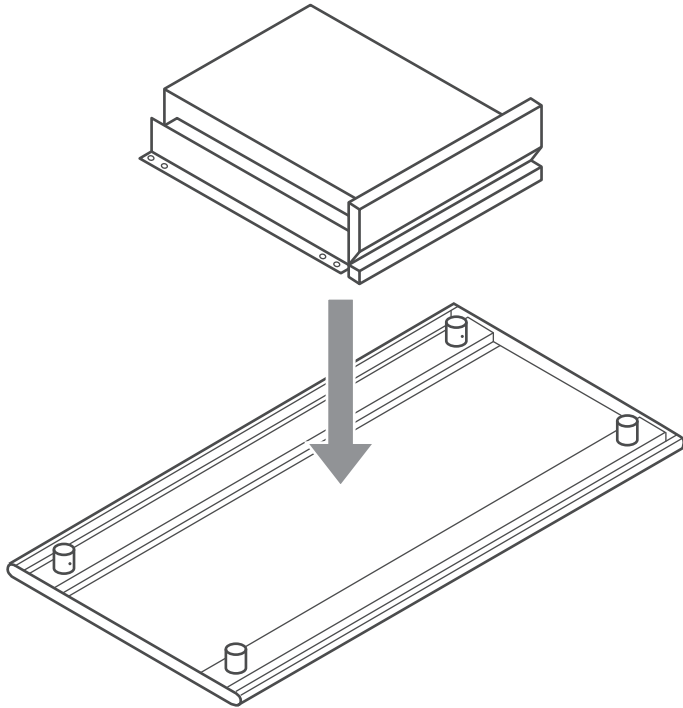

3 Align the drawer how you would like to mount it. The pre-drilled mounting holes should line up with the hat channels on the tabletop. Pull the drawer in and out to make sure that the door will clear the lip of the table. If it doesn't, you will need to shim with washers between the hat channel and brackets.

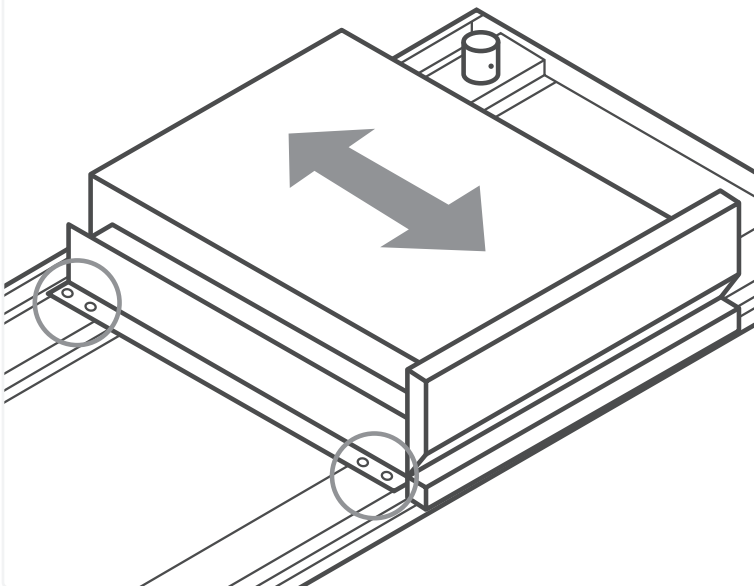

4 Hold the drawer securely, making sure the drawer sits square to the table edges. Drill pilot holes in the hat channels making sure to not drill all the way through the tabletop.

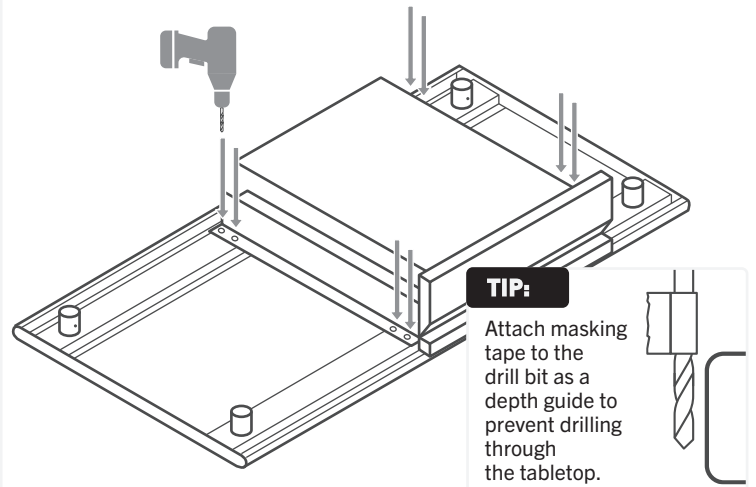

5 Use (8) self-tapping sheet metal screws to attach the drawer to the tabletop.

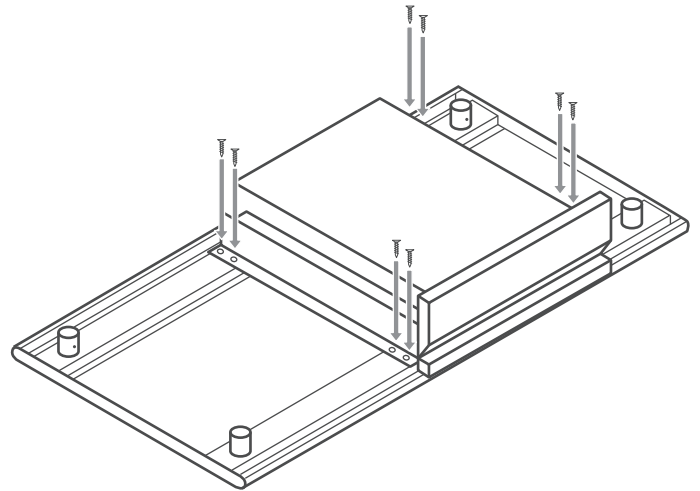

6 Reattach the tabletop to the legs.

7 Carefully flip the assembled table onto its feet.

