

BACKYARD PRO



SIDE SHELF INSTRUCTIONS

Please follow the steps below to ensure correct installation of your new Backyard Pro side shelf.

TOOLS NEEDED:

Wrench



1

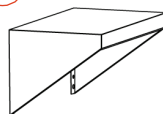

x1

A

M6 x 16 (x6)

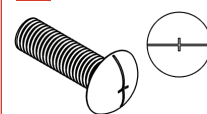

STEP 1

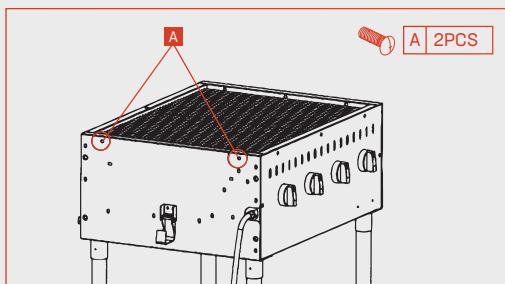

Install Screw-A (2PCS) into the holes in the top of the grill body section.

STEP 2

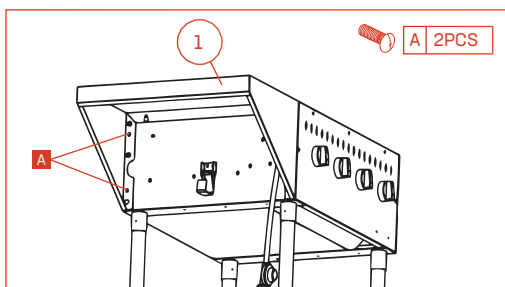

Fasten the left side of the side shelf (1) using Screw-A (2PCS).

STEP 3

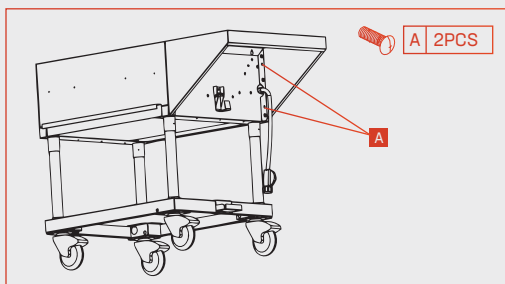

Fasten the right side of the side shelf (1) using Screw-A (2PCS).

The side shelf is now fully assembled. ✓