

Assembly Instructions Global II Portable Restroom *with HD Extrusion Molding*



The Most Rugged Portable Restroom and Parts in the Industry!



2530 Xenium Lane North, Minneapolis, MN 55441
Telephone: 763-553-1900 Fax: 763-553-1905
800-328-3332 / www.satelliteindustries.com

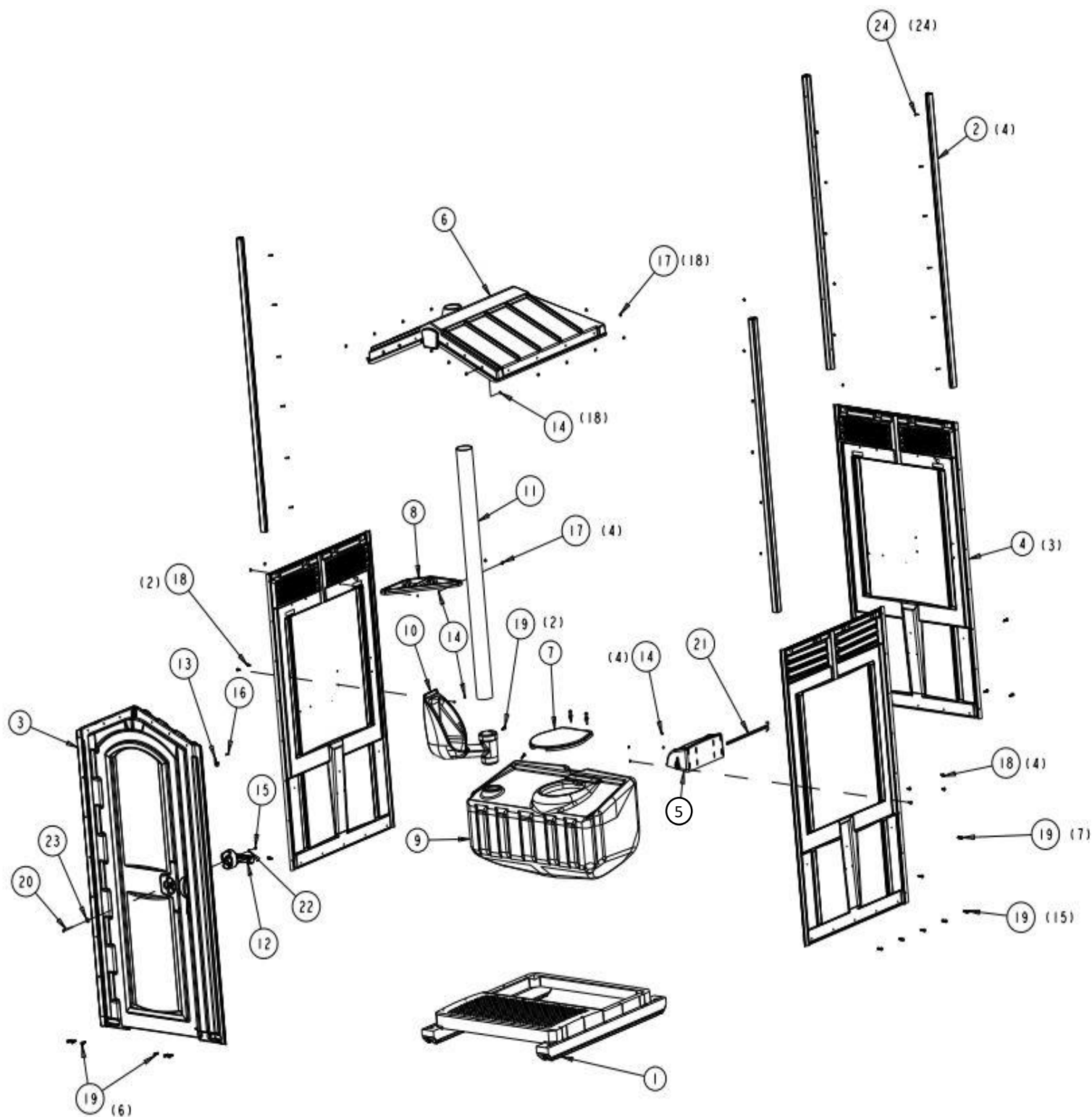

2

KIT- GB HD EXT HDWE ADD ON (40084)			
24	18755	24	RIVET, AVDEL SILVER LONG

1

HDWE GB II (40225)			
23	11360	1	WASHER- ¼ ID FENDER STNLS
22	12382	1	WASHER- ¼ FLAT STNLS
21	22310	1	SPINDLE- PRGRD II 3 ROLL METAL
20	40052	1	RIVET, #66 LSH W/LCK MANDREL
19	13860	30	SCREW, #14 X 1-1/2 W/WSH GOLD
18	11054	6	RIVET, #68 AAL POP
17	11030	22	RIVET. #66 AAL POP
16	17436	1	RIVET, AVDEL SILVER
15	16307	1	NUT-1/4-20 NYLOC STNLS
14	11315	26	WASHER, 3/16 RIVET STNLS
13	10891	1	HOOK, FLAT COAT STNLS
12	40057	1	HANDLE- GB TOILET
ITEM	PART #	QTY	DESCRIPTION

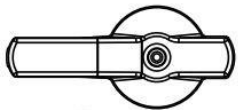

12 PN 40057

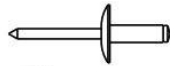

17 PN 11030

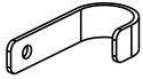

13 PN 10891



18 PN 11054



14 PN 11315



19 PN 13860



20 PN 40052



15 PN 16307



21 PN 22310



16 PN 17436



22 PN 12382



23 PN 11360

2

1

GLOBAL II RESTROOM			
12	14133	1	VENT PIPE. 4 X 62-1/2 GREY
11	14119	1	URINAL, STAND OVER DGRY
10	10553	1	TANK, TUFWAY DGRY
8	16075	1	SHELF, MX2 & TUFWAY
7	10570	1	SEAT, TOILET TUF/FRE/LIB BLACK
6	40223	1	ROOF- GB II NATURAL
	40084	1	KIT- GB HD EXT HDWE ADD ON
5	22209	1	HOOD- PAPERGRD 3 ROLL DGRY
	40225	1	HDWE GB II
4	40224	3	DESIGN, GB II PANEL
3	22202	1	DESIGN, GB II FRONT ASSY
2	40019	4	EXTRUSION- GB HD DRILLED GREY
1	40014	1	BASE- GB DIRT BUSTER
ITEM	PART#	QTY	DESCRIPTION

Tools Needed:

- | | | |
|--------------------------|---------------------------|-------------------|
| 1. Drill / Driver | 2. #10 Drill Bit | 3. Rivet Gun |
| 4. Phillips Screw Driver | 5. 7/16" Deep Well Socket | 6. Ratchet Wrench |

Step 1: Assemble (3) side panels together using HD extrusion:

***Tip:** It may help to place panel on table or a stack of tanks before assembly.

1. Slide the HD Extrusion between the (2) panels. *Note: Side panels are riveted together later.*
2. Repeat on other side.

NOTE: NOTCH ON EXTRUSION MUST BE TOWARD BOTTOM OF PANEL.

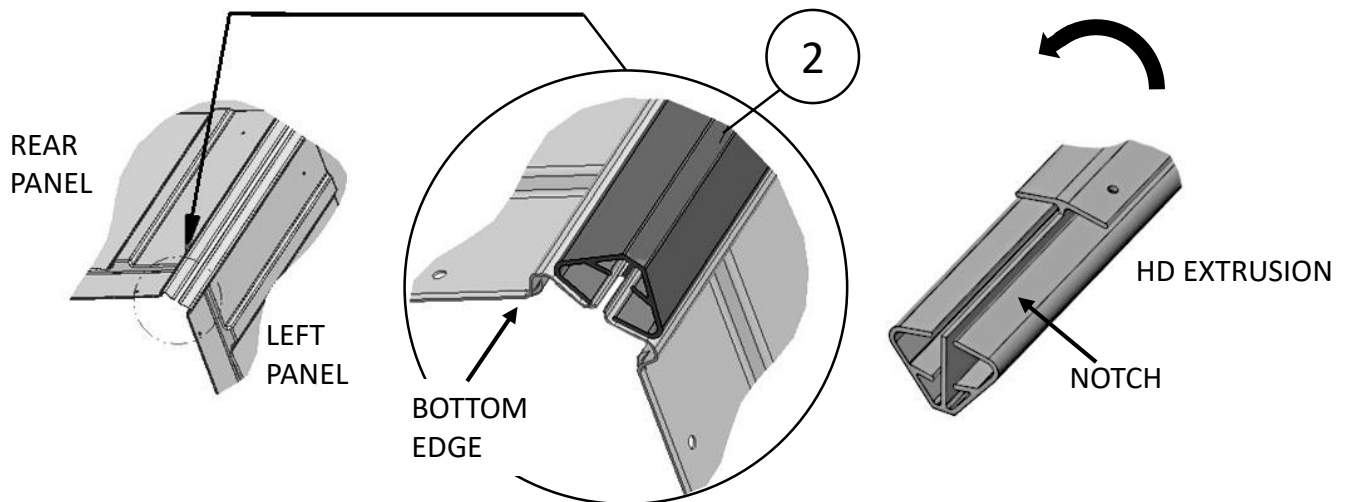

Step 2: Assemble Base to side panels:

1. Butt bottom of the rear panel up against the runners. Align rear panel center hole with center mark on base and fasten with Screw #13860. Finish remaining (4) holes.
2. Align side panel's center holes with grooves on base sides down to top of base runner and fasten with Screws #13860.

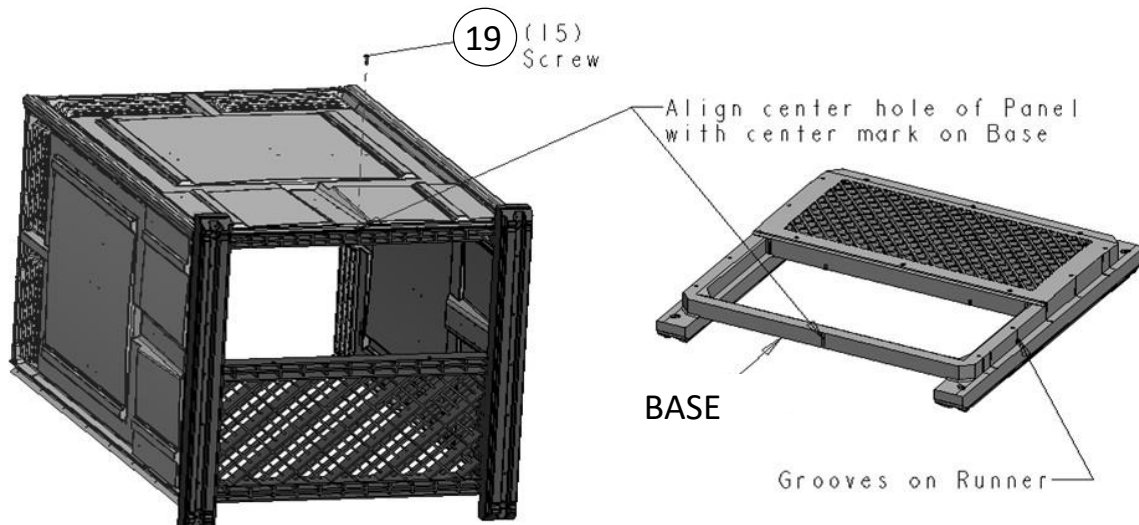

Step 3: Fasten Extrusion to Side Panels:

1. Using holes in Extrusion as a guide (on inside of unit), drill out using a #10 drill bit. (6) Places per side.

Warning: Drill through first layer of panel only.

2. Fasten Extrusion to panel with expanding rivets #18755.
3. Repeat on other side.

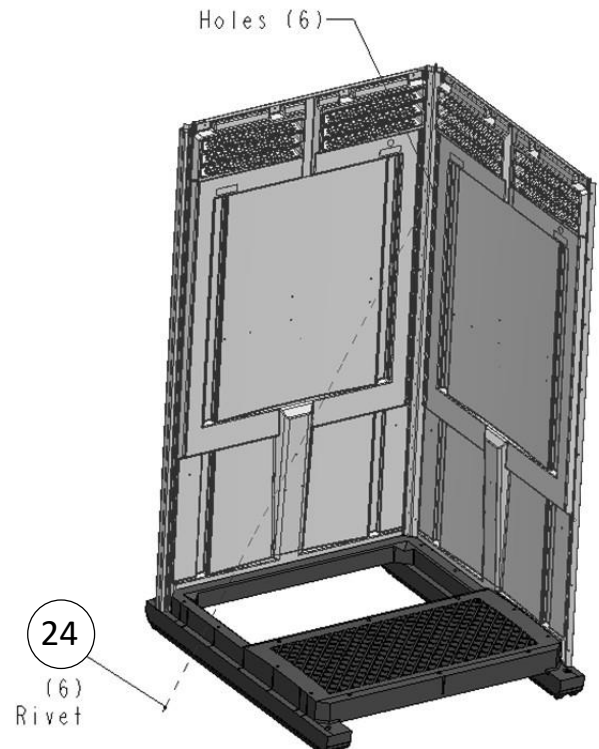

Step 4: Fasten Tank to Unit:

1. Position tank against the back wall and attach the tank starting with each side. Have (1) person stand in tank while lagging panels to tank. This ensures that the tank is in the correct position. Tighten screws #13860 until rubber washer begins to flatten.

WARNING: DO NOT TO OVER TIGHTEN SCREWS.

2. See location chart below for screw location. **Note:** Do not use dimples if they don't match chart locations.
3. Fasten toilet seat.

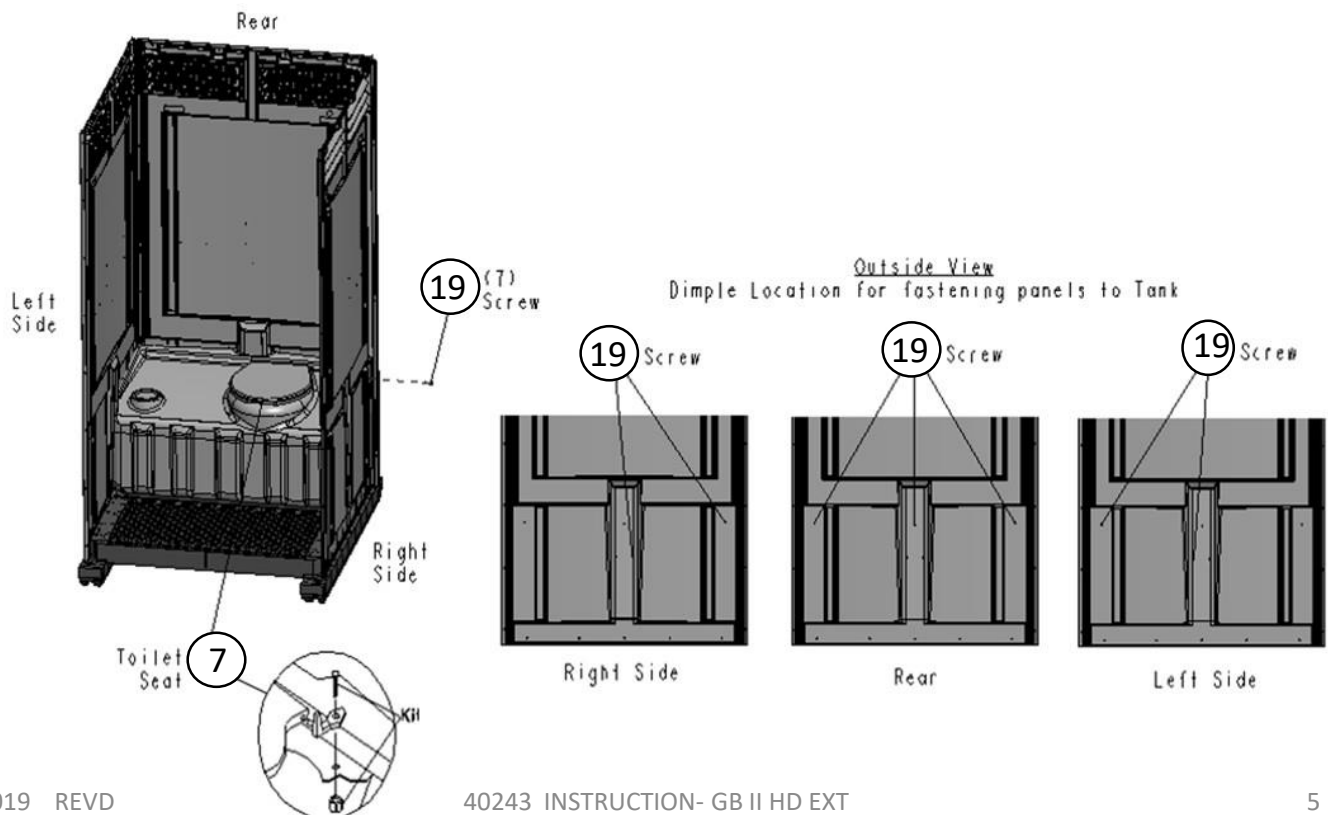

Step 5:

Assemble Paperguard to unit:

1. Using #10 Drill Bit, Drill out the (4) dimples on side panel as shown.
2. Fasten Toilet Paper Holder to unit using (4) Rivets #11054 and (4) washers #11315. (*Washers are installed on inside of paper holder.*)
3. Insert spindle 22310 in paperholder.

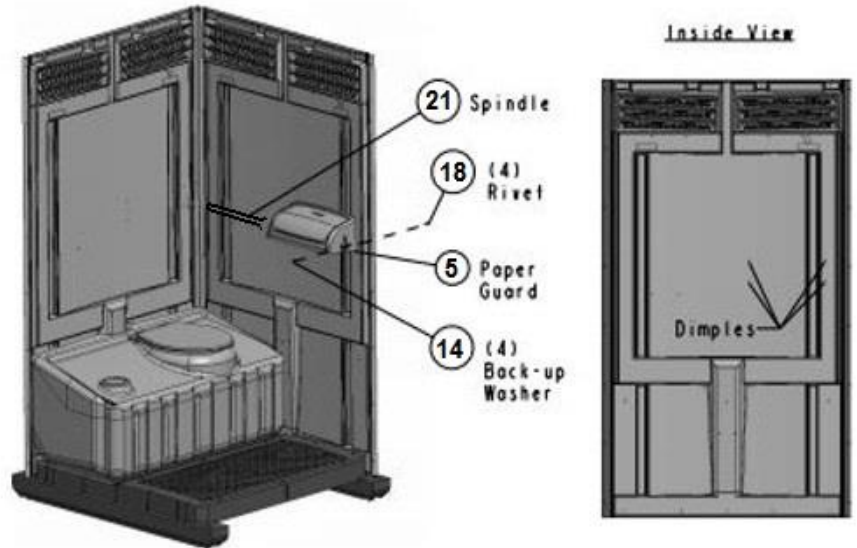

Step 6: Assemble Urinal to unit:

1. Using #10 Drill Bit, Drill (2) holes in side panel at dimples.
2. Insert round tube of Urinal in tank urinal hole.
3. Use (2) rivets #11054 and (2) washers #11315. *Washers are installed on inside of Urinal.*
4. Fasten urinal to tank using 1 screw #13860 in dimple located on back of tank collar.

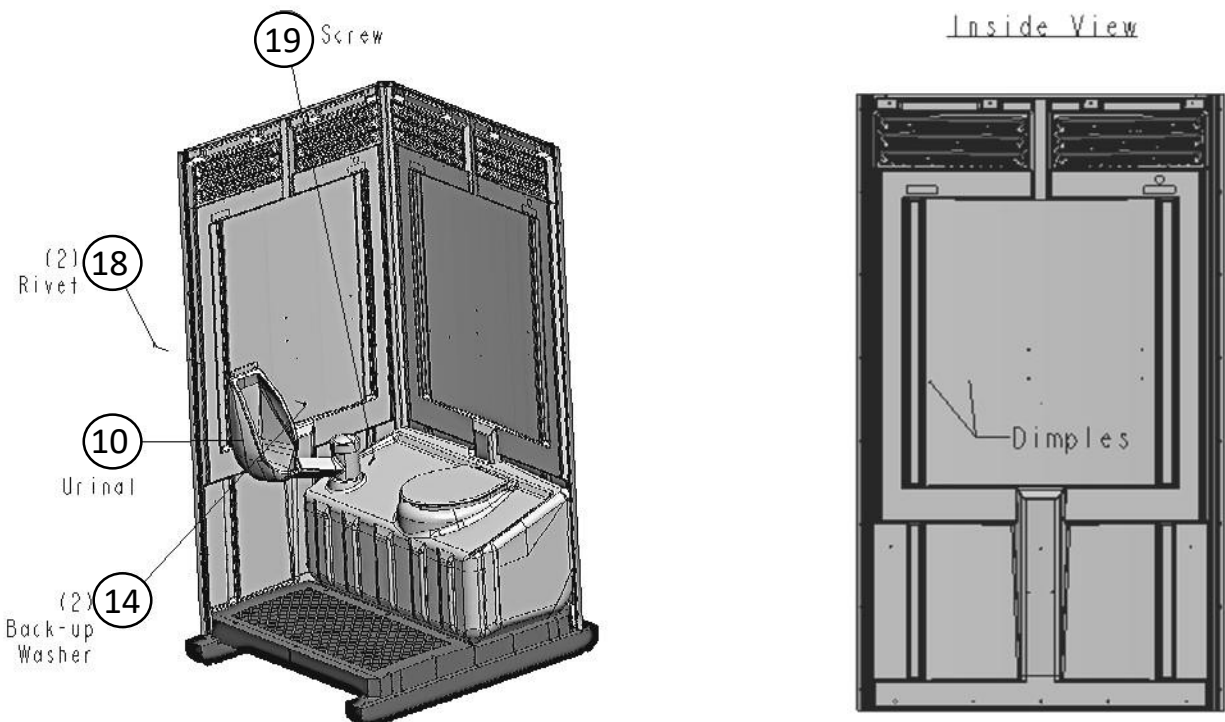

Step 7: Assemble Shelf to unit

1. Using #10 Drill Bit, Drill (2) holes in 2 side panels at dimples location. (see below)
2. Fasten Shelf to unit in rear left corner using (4) Rivets #11030 from the outside, through panel and into holes in shelf. Use (2) back-up washers #11315 on outside 2 rivets only.

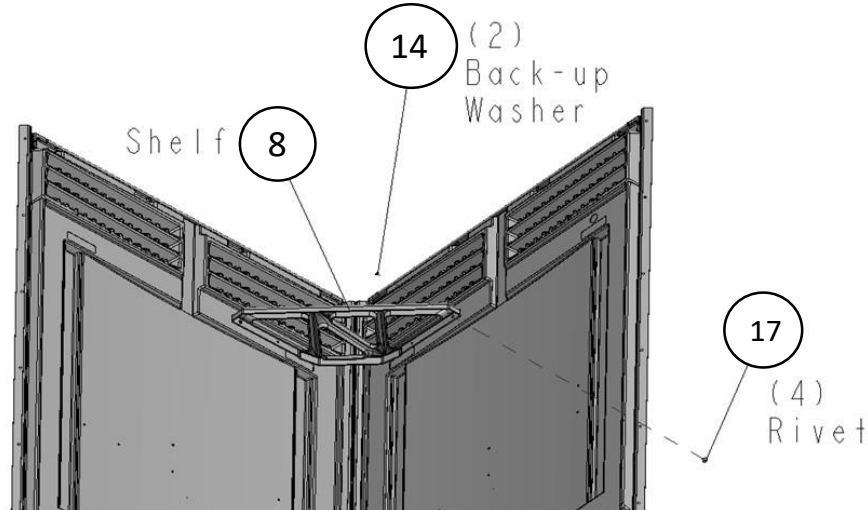

Step 8: Assemble coat hook to doorframe.

1. Drill at dimple using #10 drill bit
2. Fasten Coat Hook to the frame using Rivet #17436.

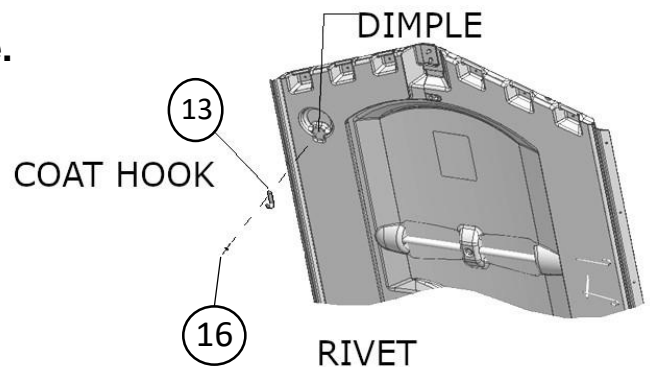

Step 9: Install Door Handle.

1. Assemble Door Handle to Door using (1) Screw #40052, (1) Washer Fender #11360, on outside of front & (1) Handle #40057, (1) Washer Flat #12382 and (1) Nut #16307 on door inside.
2. Tighten nut using 7/16" Deep Well Socket & Phillips screw driver until threads are engaged with nylon in lock nut, at least one full thread must be showing, *otherwise nylon nut will loosen and fall off.*

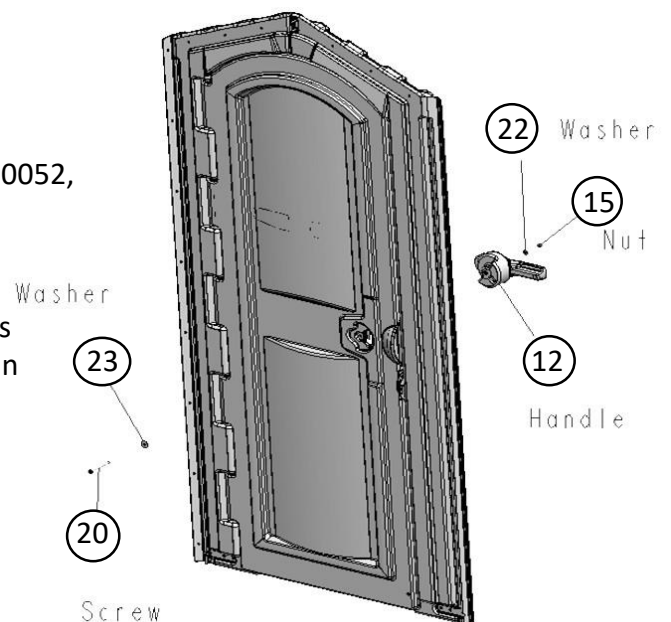

Step 10: Assemble Front to Panels.

1. Install HD Extrusions between the front and panel.

Note: Fasten front to panels using the same method as STEP 3 Fasten Extrusion to Side Panel. (6) Places per side using rivets #18755.

Warning: Do not drill through first layer of panel or front only.

2. Repeat on other side.

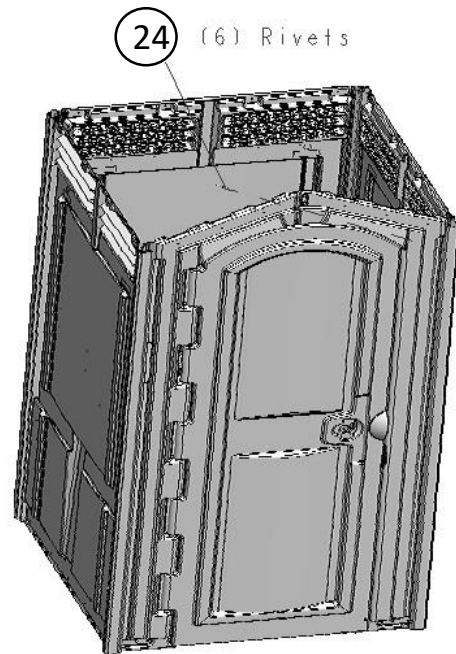

Step 11: Assemble Front to Base.

1. Fasten Front to **Dirt Buster Base** use (6) screws #13860 through pre-drilled holes in bottom of door frame. Install (2) screws through pre-drilled holes in bottom of door frame left side & (2) screws through pre-drilled holes in bottom of door frame right side.
2. Open the door and install the final (2) screws #13860 through two pre-drilled holes behind the door, near inside edge of frame, (1) left and (1) right side.

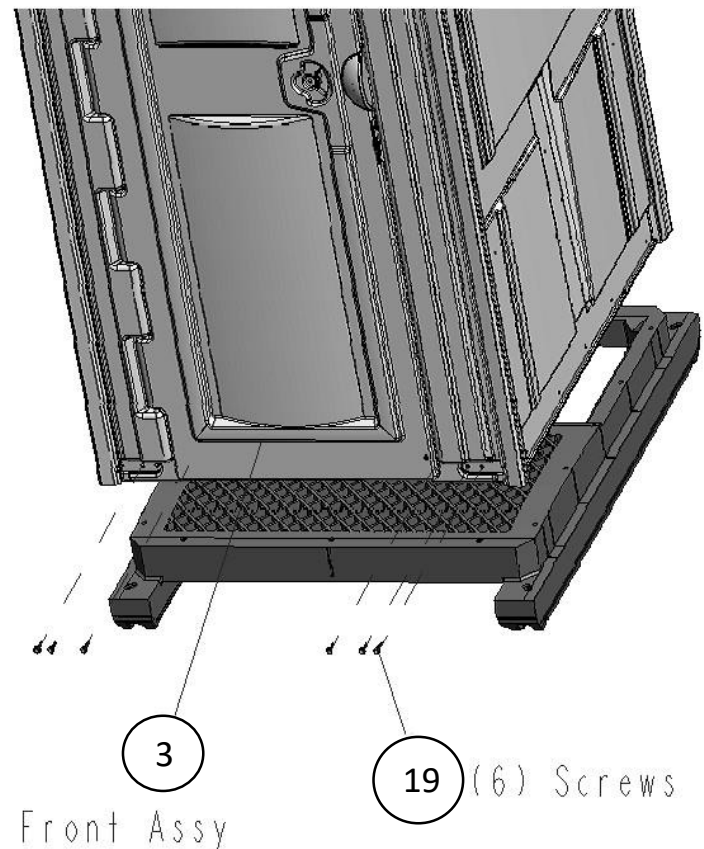
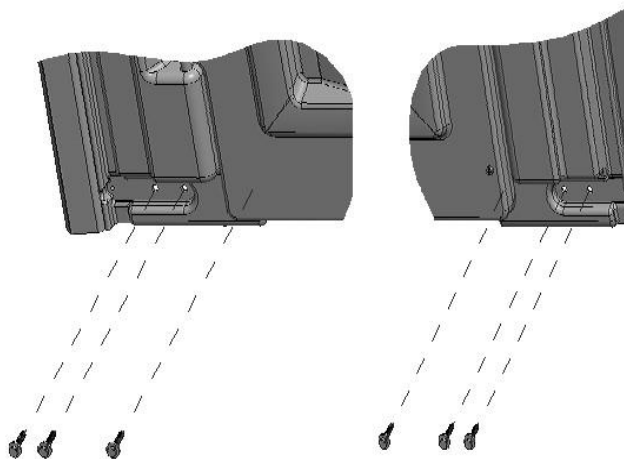

Step 12: Assemble Roof to unit.

1. Place roof on top of unit. Fasten roof to unit use (18) Rivets #11030 & (18) Washers #11315
Washers are installed on inside of unit.

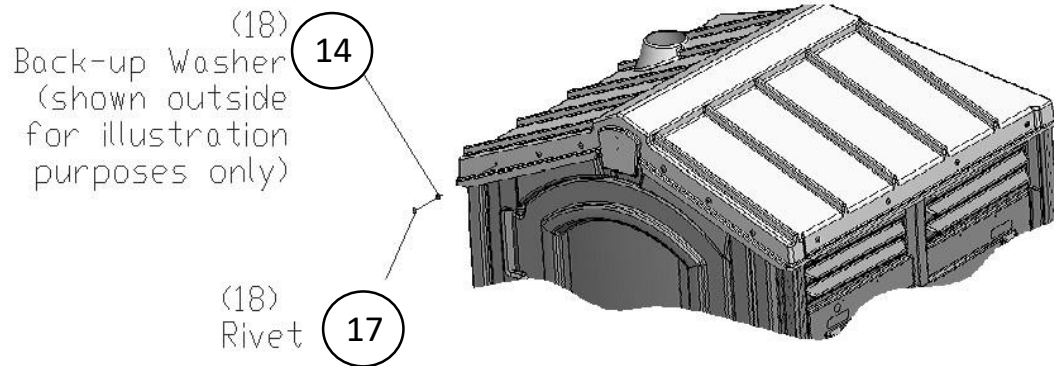

Step 13: Assemble Vent Pipe to unit.

1. Insert Vent Tube through roof & down into top of urinal tube & fasten vent pipe to urinal tube using (1) screw #13860 in dimple located on back of tube.

