

ASSEMBLY GUIDE - FAST TRACK TABLES

Z BRACKET INSTRUCTIONS

1

Lay the stainless steel table face down on a smooth surface to protect it from scratching.

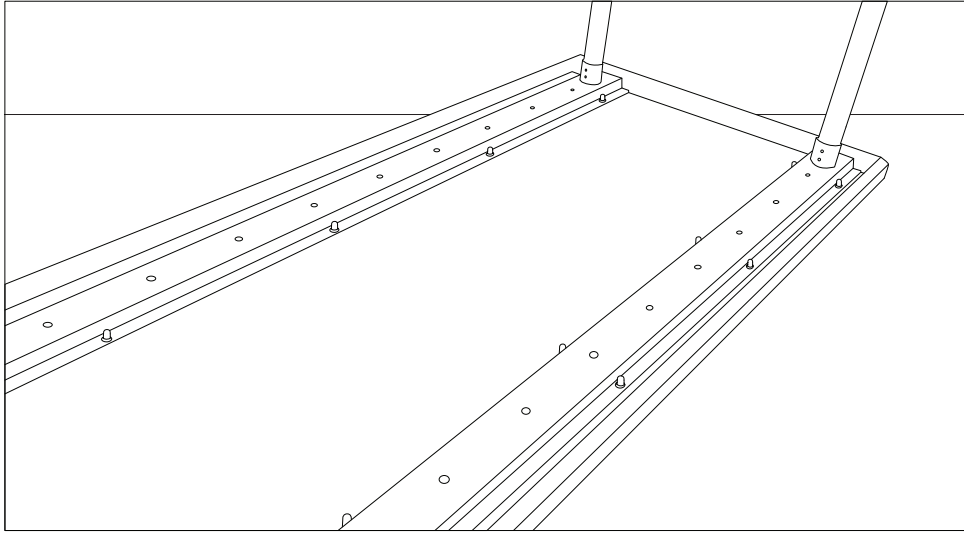

2

Align the Uni-strut with the threaded inserts. These inserts run lengthwise on both sides of the table's hat channels.

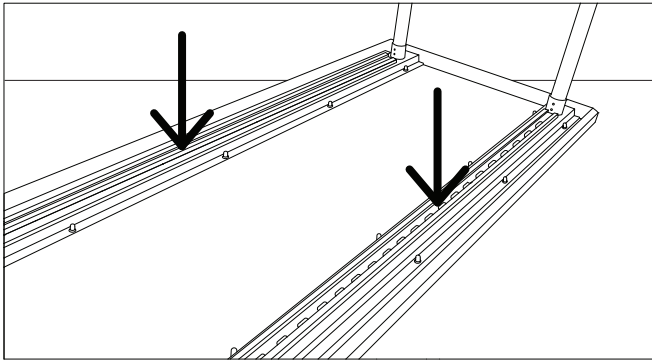

3

Using the provided screws, secure the threaded insert to the table. Make sure the Uni-struts are securely screwed in.

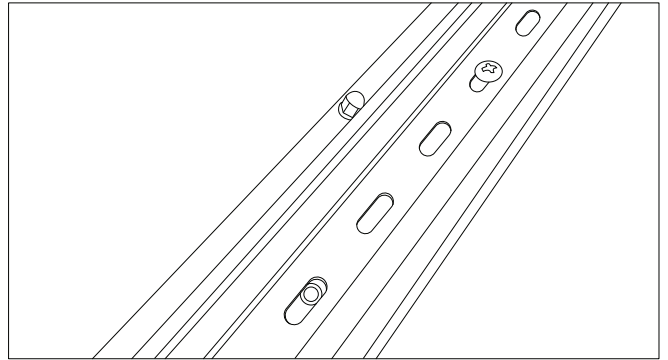

Z BRACKET INSTRUCTIONS, CONT.

4

Take the spring clips and place them into the Uni-strut. Turn them counterclockwise to secure them in place.

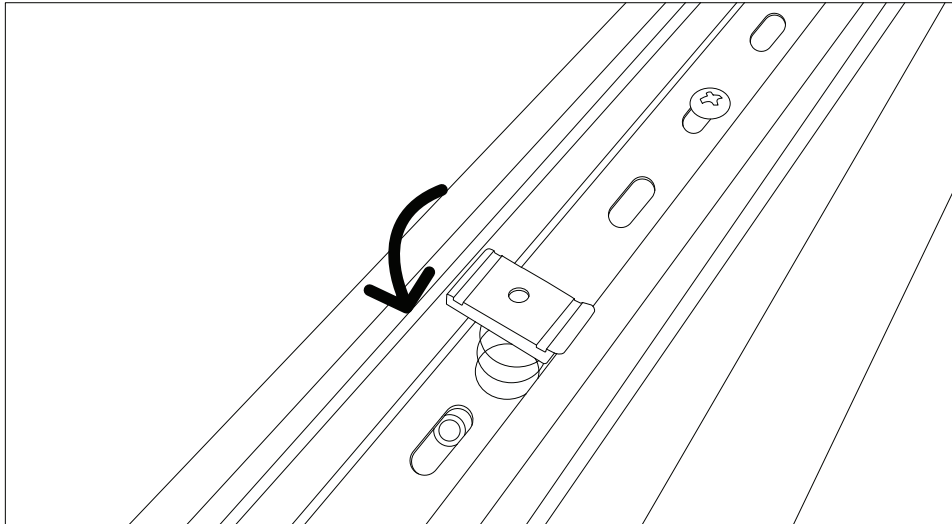

5

Align the Z-brackets over the spring clips. The Z-brackets align vertically with the table. Then tighten the Z-brackets into the threaded spring clips.

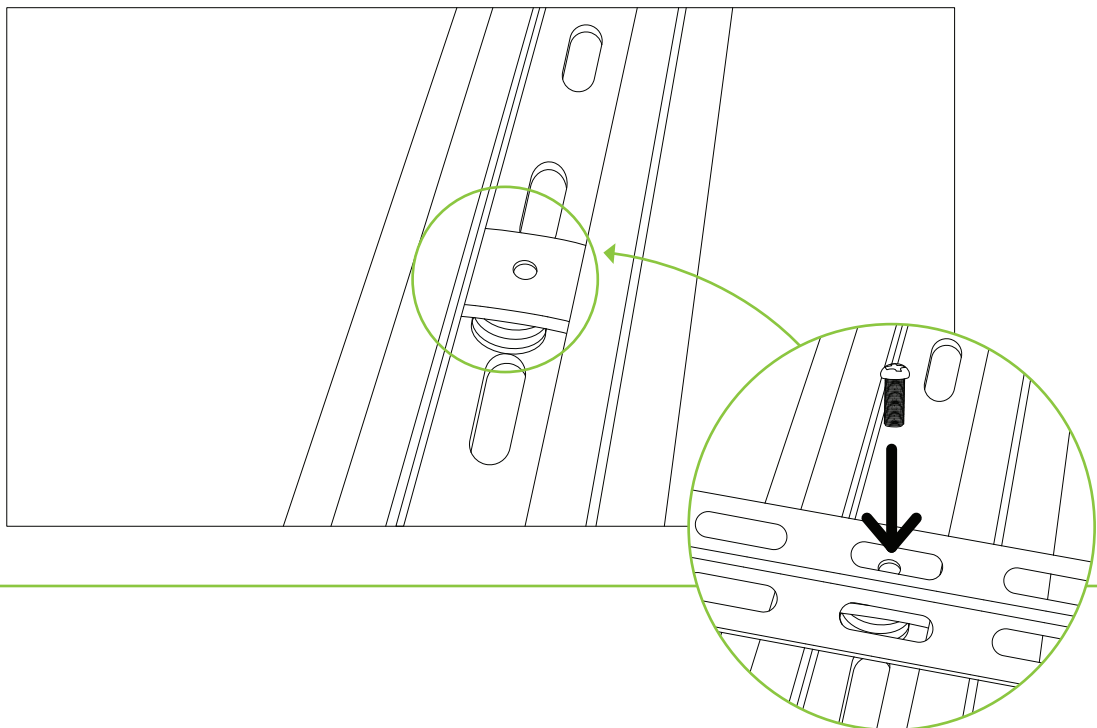
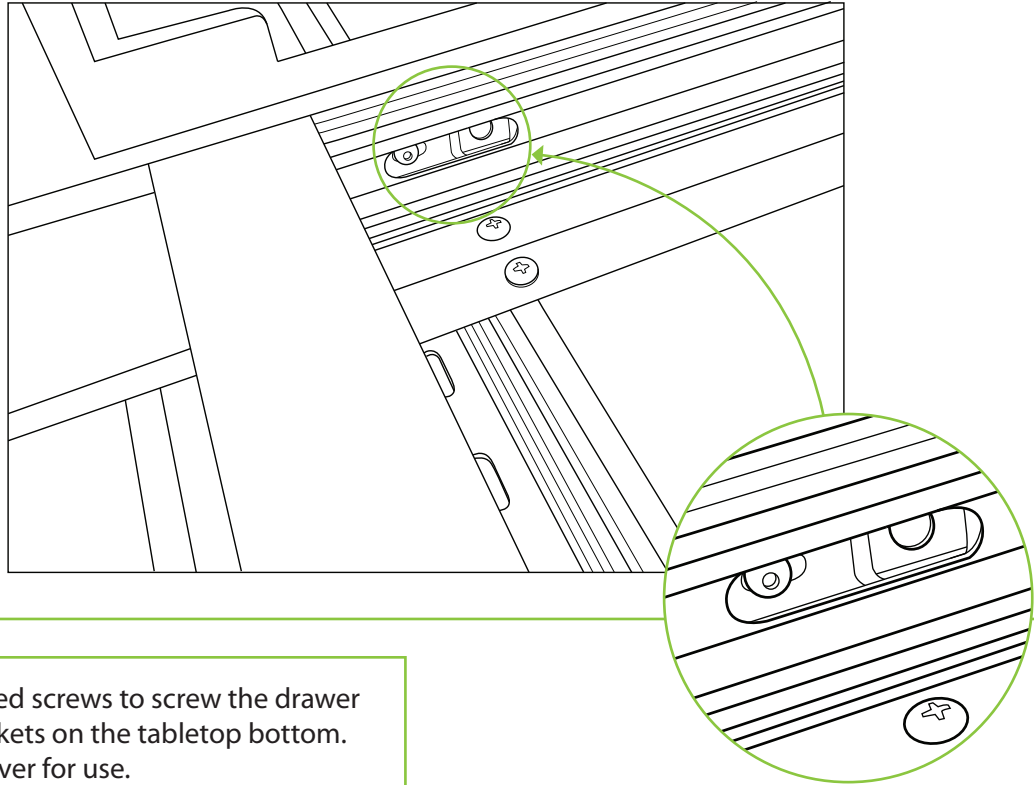

TABLE DRAWER MOUNTING

Once you have installed the Z-brackets, you are ready to install the drawer.

1

Align the threaded screw holes on the top of the drawer with the Z-brackets.



2

Use the provided screws to screw the drawer into the Z-brackets on the tabletop bottom. Flip the table over for use.

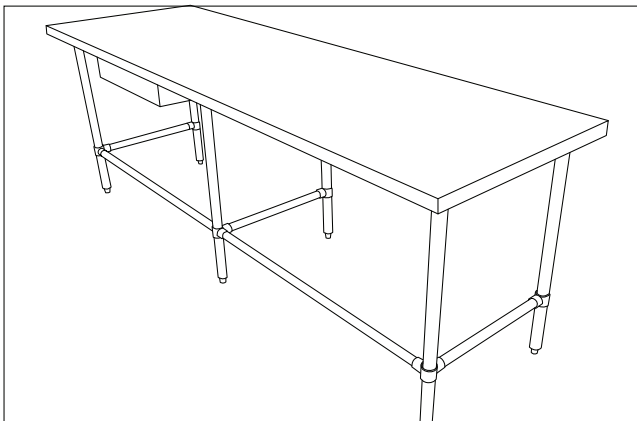

ASSEMBLY GUIDE - DOLLY 600GRDASH

BUN PAN RACK MOUNTING

Once you have installed the Z-brackets, you are ready to install the bun pan rack.

1

Align the threaded screw holes on the top of the bun pan rack with the Z-brackets.

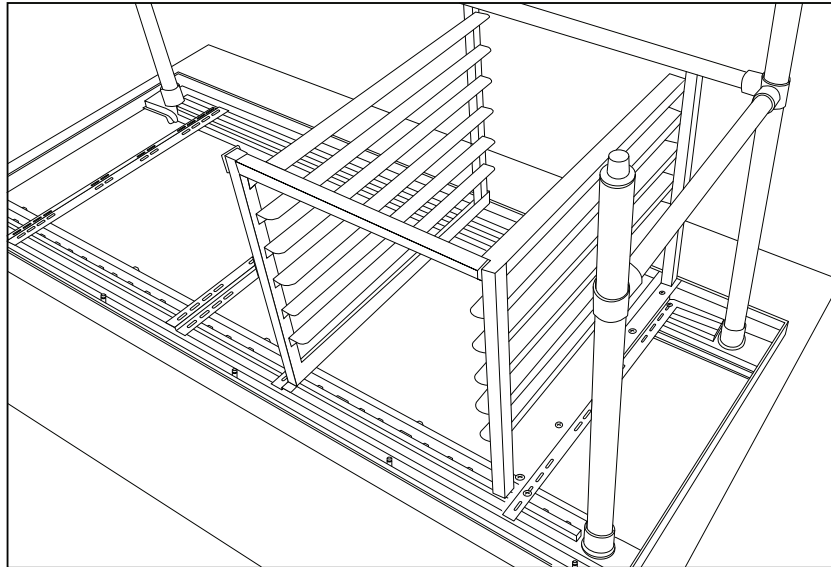

2

Use the provided screws to attach the bun pan rack to the Z-brackets on the tabletop bottom. Flip the table over for use.

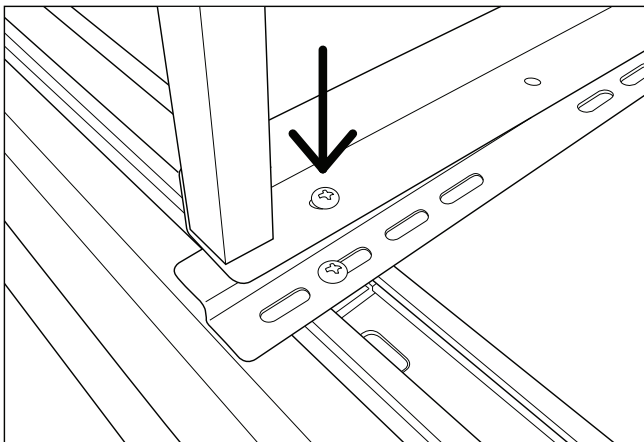

3

Using the provided screws, secure the threaded insert to the table. Make sure the Uni-struts are securely screwed in.

