

Countertop Step-Up Ranges



351SRCPG12NL, 351SRCPG24NL, 351SRCPG36NL

REVISED 12/2022

Safety Precautions

CAUTION:

- Failure to comply with the following operation instructions could lead to potential hazards and/or unsafe practice and could result in injury and damage to product and property.

NOTICE:

- Local codes regarding installation vary greatly from one area to another. The National Fire Protection Association, Inc., states in its NFPA96 latest edition that Local codes are “Authority Having Jurisdiction” when it comes to requirement for installation of equipment. Therefore, installation should comply with all Local codes.
- This product is intended for commercial use only. Not for residential use.

WARNING:

- Do not store or use gasoline or other flammable vapors and liquids in the vicinity of this or any other equipment.
- Improper installation, adjustment, alteration, service or maintenance could lead to property damage, injury or death. Read the installation, operating and maintenance instructions thoroughly before installing or servicing CPG equipment. This manual must be retained for future reference.
- A fully licensed installer must handle all maintenance and repair.

Gas Pressure

- The appliance and its individual shutoff valve (to be supplied by user) must be disconnected from the gas supply piping system during any pressure testing of that system at test pressures in excess of ½ PSI (3.45 kPa).
- The appliance must be isolated from the gas supply piping system by closing its individual manual shut-off valve during any pressure testing of the gas supply piping system at test pressures equal to or less than ½ PSI (3.45 kPa).



Intertek

3182799

Conforms to ANSI STD Z83.11b-2009 (R2011)

Conforms to CSA STD 1.8b-2009 (R2011)

NSF Tested by ETL



Intertek

Parts Diagram

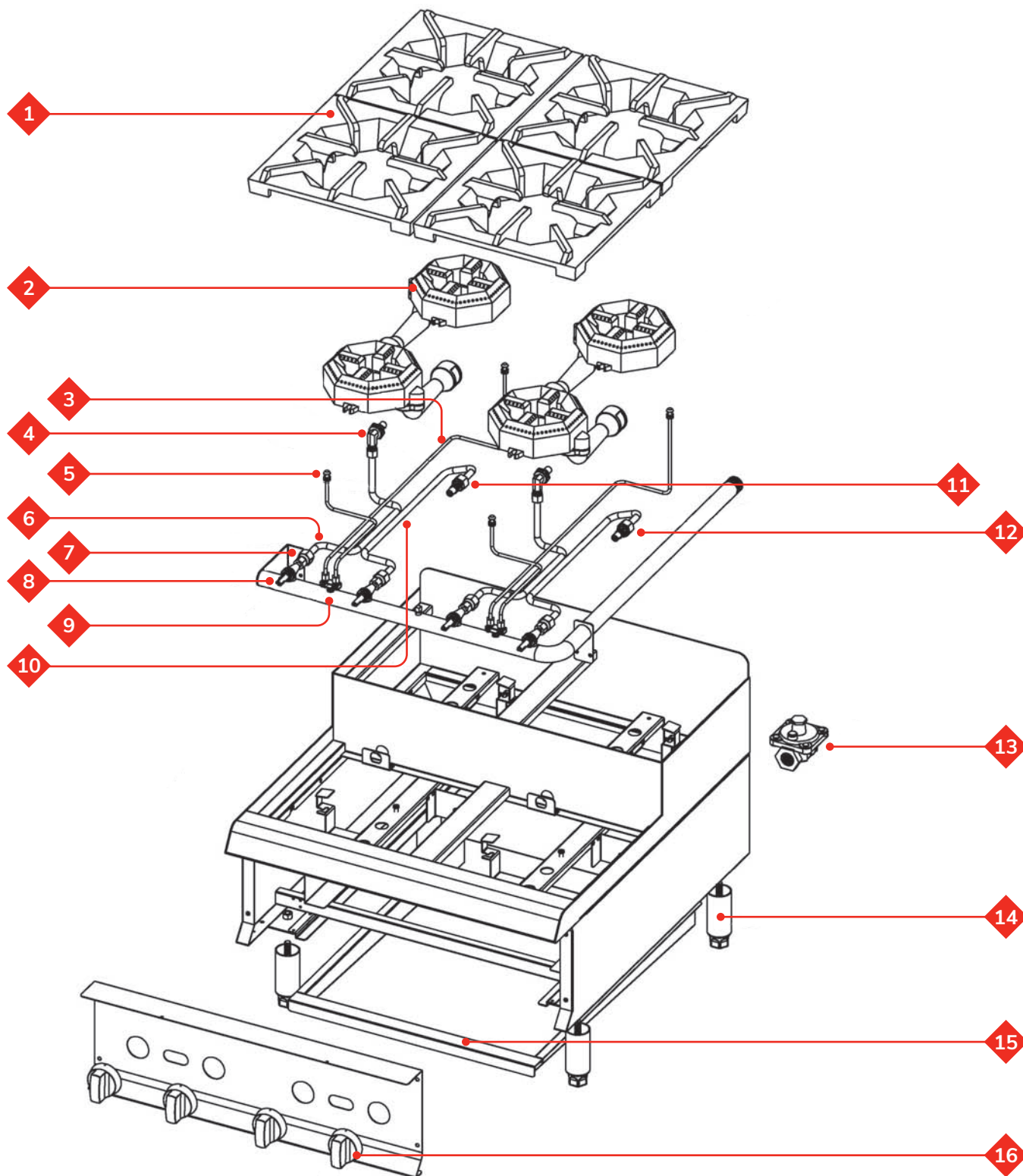

Parts List

#	DESCRIPTION	ITEM #	MODEL	QTY
1	Grate	3511015096	351SRCPG12NL	2
			351SRCPG24NL	4
			351SRCPG36NL	6
2	Burner	3511472521	351SRCPG12NL	2
			351SRCPG24NL	4
			351SRCPG36NL	6
			351SRCPG12NL	1
3	Pilot Pipe Assembly - Rear	3511071026	351SRCPG24NL	2
			351SRCPG36NL	3
			351SRCPG12NL	1
4	Orifice Connection - Rear	3511067404	351SRCPG24NL	2
			351SRCPG36NL	3
			351SRCPG12NL	1
5	Pilot Pipe Assembly - Front	3511071015	351SRCPG24NL	2
			351SRCPG36NL	3
			351SRCPG12NL	1
6	Main Pipe Assembly - Rear	3511473193	351SRCPG12NL	1
			351SRCPG24NL	2
			351SRCPG36NL	3
			351SRCPG12NL	2
7	Valve Connection	3511820085	351SRCPG24NL	4
			351SRCPG36NL	6
8	Valve	3511068502	351SRCPG12NL	2
			351SRCPG24NL	4
			351SRCPG36NL	6
9	Pilot Valve	351302220027	351SRCPG12NL	1
			351SRCPG24NL	2
			351SRCPG36NL	3
10	Main Pipe Assembly - Front	3511473192	351SRCPG12NL	1
			351SRCPG24NL	2
			351SRCPG36NL	3
11	Orifice Connection - Front	3511067402	351SRCPG12NL	1
			351SRCPG24NL	2
			351SRCPG36NL	3

12	Orifice - Natural Gas	3511068643	351SRCPG12NL	2
			351SRCPG24NL	4
			351SRCPG36NL	6
12	Orifice - Liquid Propane	3511068652	351SRCPG12NL	2
			351SRCPG24NL	4
			351SRCPG36NL	6
13	Regulator	3511069501	351SRCPG12NL	1
			351SRCPG24NL	1
			351SRCPG36NL	1
14	Foot	3511005373	351SRCPG12NL	4
			351SRCPG24NL	4
			351SRCPG36NL	4
15	Tray	3511029395	351SRCPG12NL	1
			351SRCPG24NL	1
			351SRCPG36NL	1
16	Dial	3511473191	351SRCPG12NL	2
			351SRCPG24NL	4
			351SRCPG36NL	6