

#944BJ162213G & #944BJ162216G

LAVEX
JANITORIAL



ASSEMBLY INSTRUCTIONS

ASSEMBLY

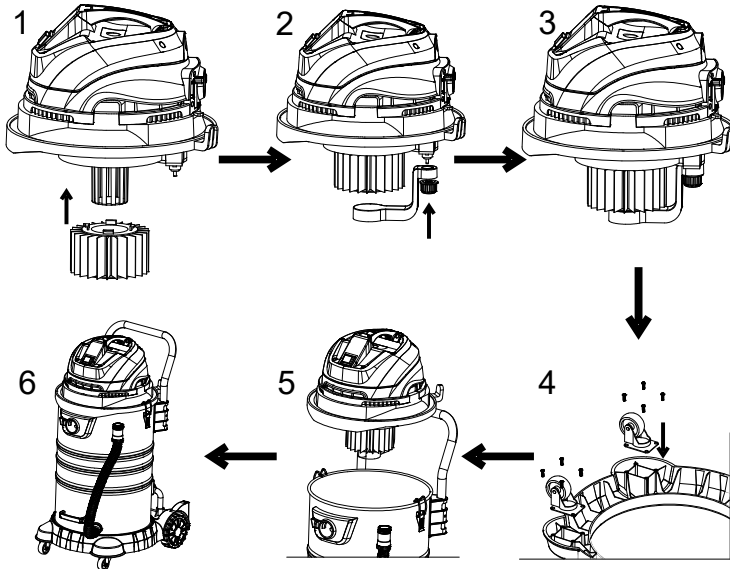

- 1) Attach the filter to the top cover.
- 2) Place locking mechanism in location indicated to secure filter.
- 3) Tighten knob on locking mechanism to secure filter in its place.
- 4) Attach wheels to base.
- 5) Attach handle to base.
- 6) Clip top cover into place with tank locks.

HOSE CONNECTION

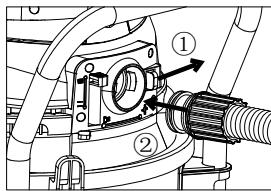
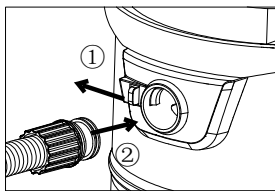

- 1) Insert hose connector into inlet and ensure that the connector is fastened tightly.
- 2) Loosen the screws on the handle to adjust height, tighten once set.

HOSE PREPARATION

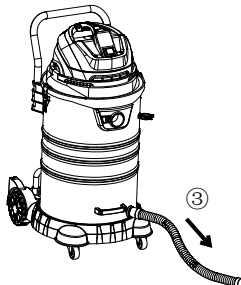
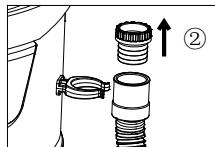
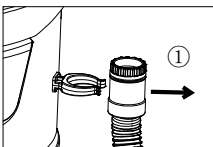

- 1) Remove vacuum hose from clamp on side of unit.
- 2) Unscrew cuff from end of hose before each use to allow tool attachment.
- 3) Attach desired tool for each use, return to clamp on side of unit when finished.