

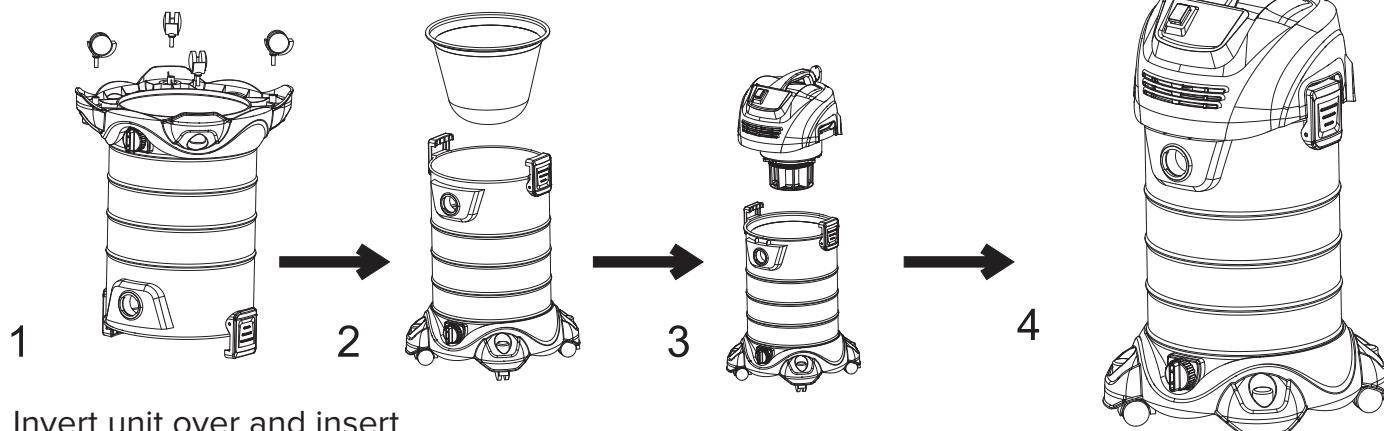

#944BJ1348G & #944BJ13410G

# ASSEMBLY INSTRUCTIONS

## ASSEMBLY



- 1) Invert unit over and insert wheels into base.
- 2) Flip unit over onto wheels and insert the filter into the base.
- 3) Place the top cover onto the base.
- 4) Clip into place with tank locks.

## HOSE CONNECTION

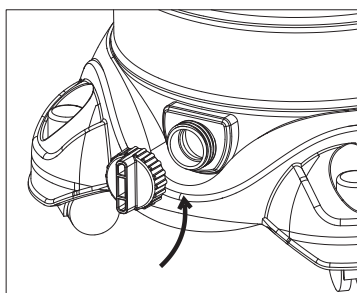
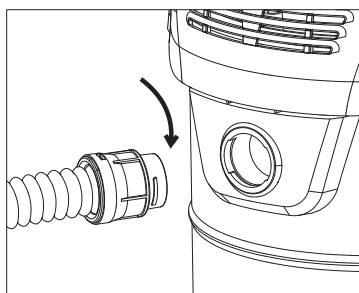

- 1) Insert hose connector into inlet and ensure that the connector is fastened tightly.
- 2) Press the connector button and pull the connector out when you want to pull hose connector from this machine.
- 3) Insert hose connector into the blowing mouth when you want to use its blowing function.