

#257SGCW1200

# Garden Cart

### ASSEMBLY TIPS

- Read these instructions thoroughly before proceeding.
- Tighten all parts by hand. Do not use power tools.
- For your safety, do not overload.

### PARTS LIST

**1** Base (1 pc)

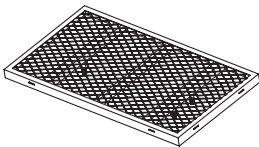

**2** Yoke (1 pc)

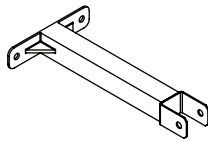

**3** Front Axle (1 pc)

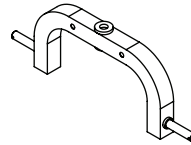

**4** Rear Axle (1 pc)

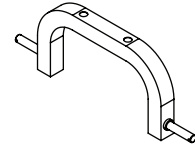

**5** Front/Rear Panel (2 pcs)

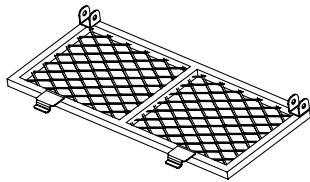

**6** Side Panel (2 pcs)

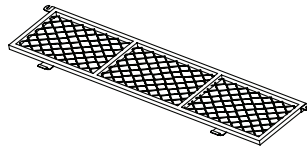

**7** Wheels (4 pcs)

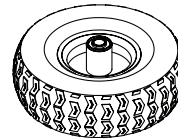

**8** Handle (1 pc)

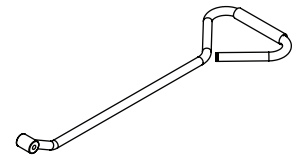

**A** Bolts, Nuts, & Washers  
M8 (3 sets)

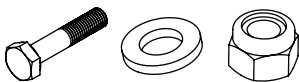

**B** Locking Bar  
(2 Right, 2 Left)

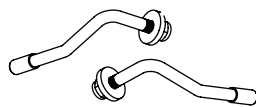

**C** Wheel Pin (4 pcs)



**D** Plastic Pad (1 pc)

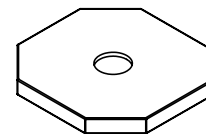

**E** Plastic Washer  
M16 (8 pcs)

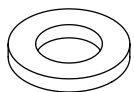

**F** Washer  
M14 (3 pcs)

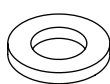

**G** Lock Nuts M14 (3 pcs)

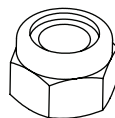

### STEP 1

#### Prepare Assembly

Turn the base (1) upside down.

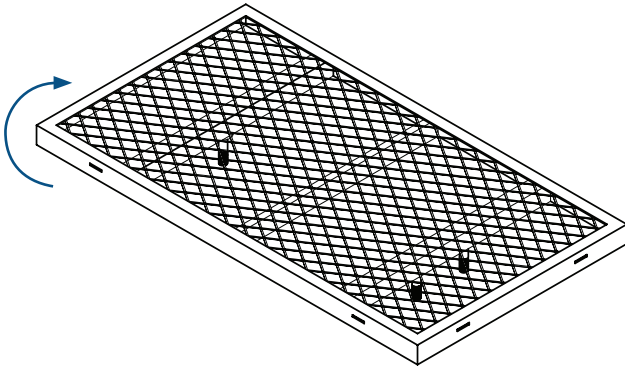

### STEP 2

#### Front Axle Assembly

Attach the yoke (2) to the front axle (3) by using two sets of M8 bolts, nuts, and washers (A).

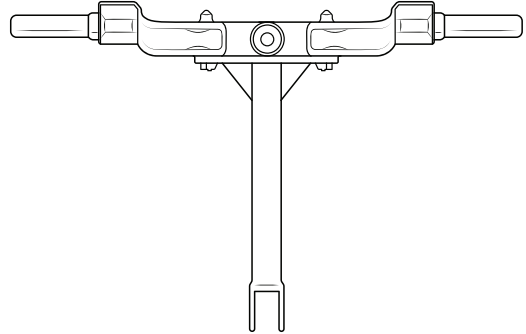

### STEP 3

#### Front Axle to Base Assembly

Attach the front axle (3) assembly to the base (1). Next, slide the front axle assembly onto the pre-assembled pivot bolt. Finally, secure by using a plastic pad (D), another washer M14 (F), and a lock nut M14 (G).

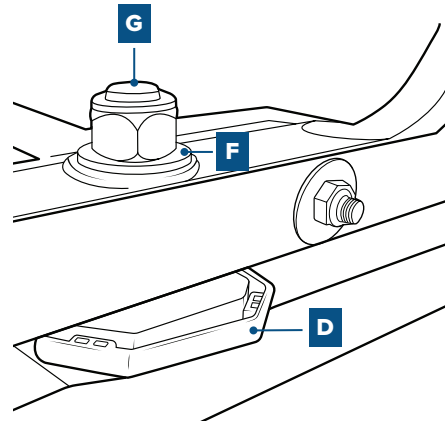

### STEP 4

#### Rear Axle Assembly

Attach the rear axle (4) to the base (1). First, slide the rear axle (4) onto the pre-assembled pivot bolts. Next, secure by using 2 washers M14 (F) and 2 lock nuts M14 (G).

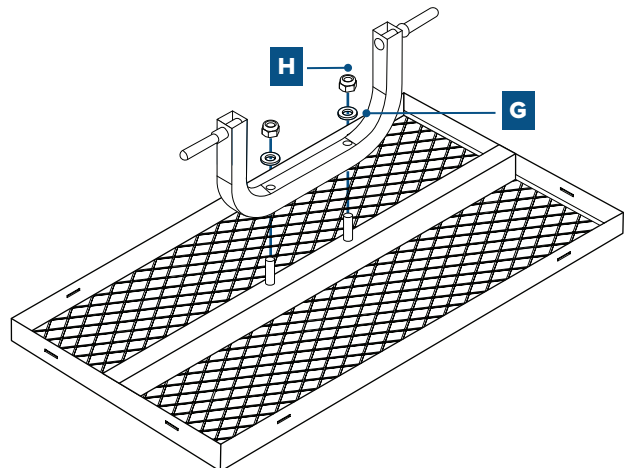

### STEP 5

#### Wheel Assembly

First, attach the wheels (7) onto each axle. Next, insert 2 pcs washers M16 (E) for each axle. Then, insert the wheel pins (C) into the axle's hole. Next, bend back the ends of the wheel pins with pliers to keep them in place.

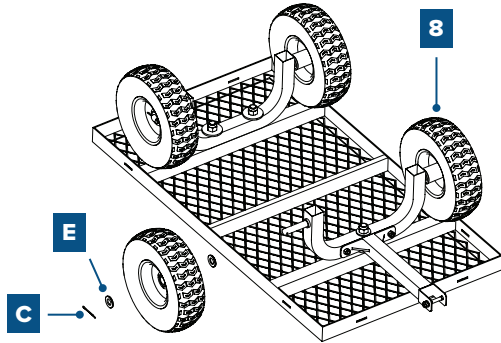

### STEP 6

#### Turn the Cart Upright

Attach the handle (8) with the yoke (2) by using the M8 bolts, nuts, and washers (A) to lock it. Do not over-tighten.

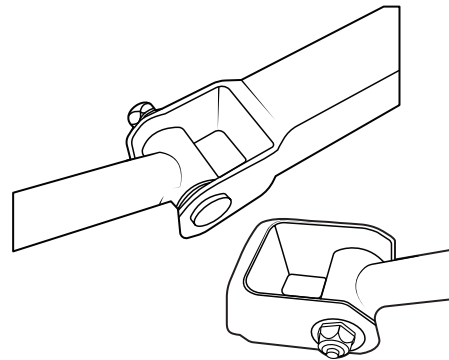

### STEP 7

#### Panel Assembly

Insert the front panel and rear panel (5) and 2 side panels (6) onto the base.

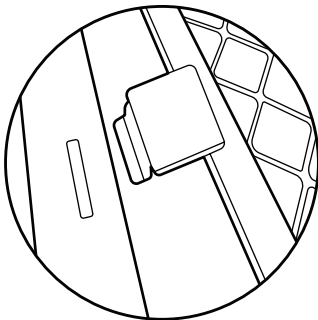

Latch the front panel and rear panel (5) to the side panels (6). Secure by using the 2 sets of locking bars (B).

