

Model L-1Xe

Quick Setup

Instructions



WARNING : Electrical and plumbing connections need to be made by a licensed service person and comply with all Federal, State and Local Health, Electrical, Plumbing and Safety codes.

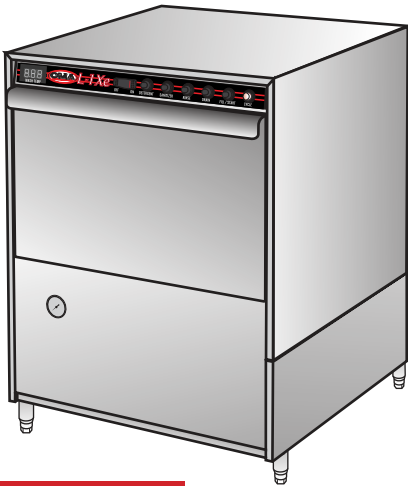

4 LEVELING LEGS

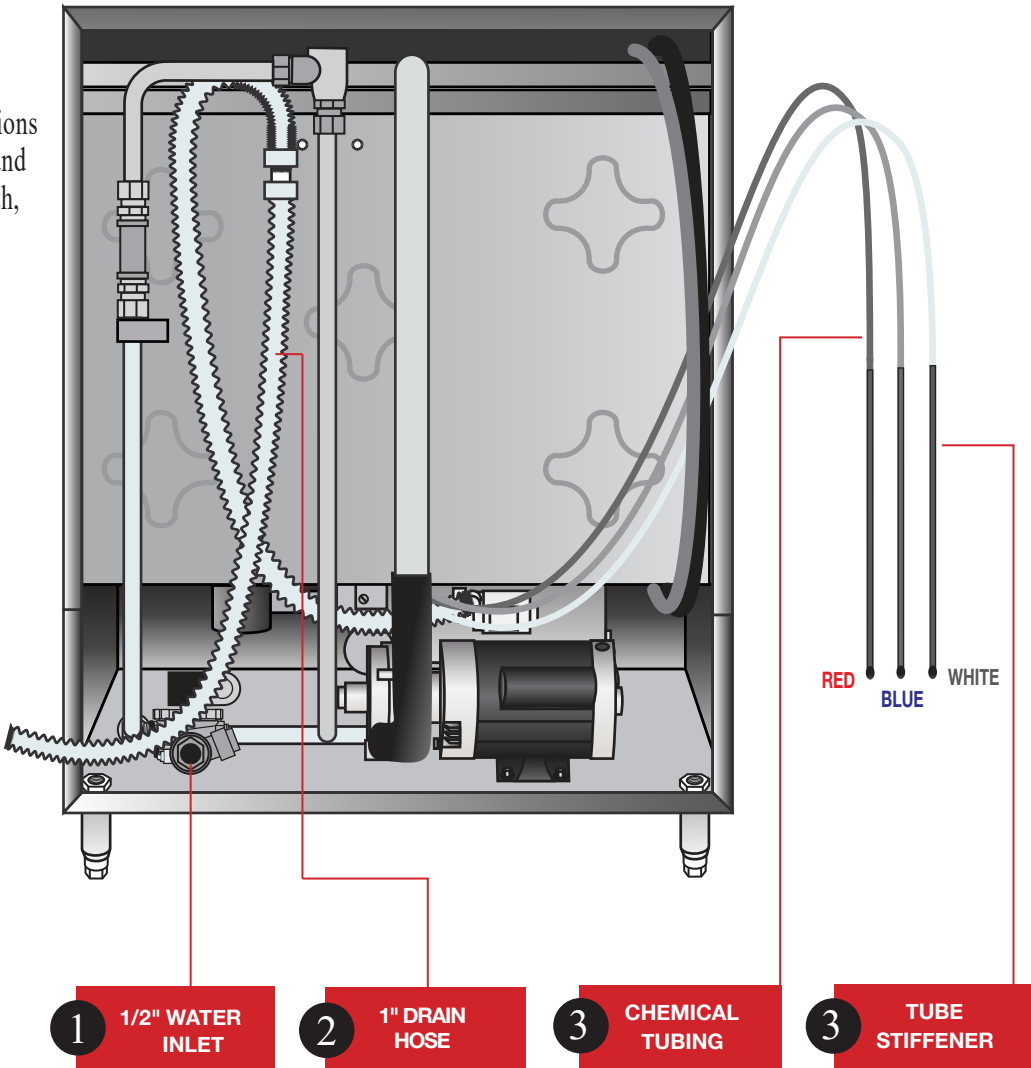

- 1 1/2" WATER INLET
- 2 1" DRAIN HOSE
- 3 CHEMICAL TUBING
- 3 TUBE STIFFENER

STEP 1

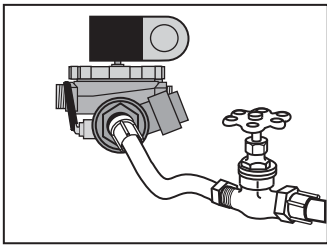

Connect dishmachine to hot water source minimum 120°F required, 140°F temperature recommended.

STEP 2

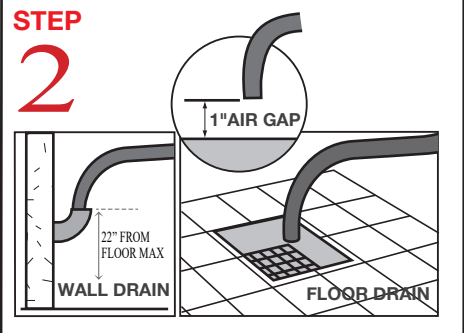

Connect the drain hose to wall or floor drain. The floor drain must have a 1-inch air gap between drain hose and floor drain.

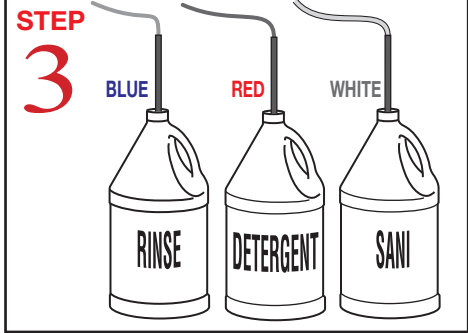

Insert tube stiffener with chemical tubing into each corresponding chemical dispenser.

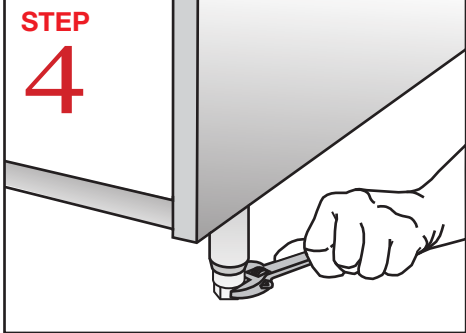

Level dishmachine by adjusting leveling legs. Dishmachine must be level, front and back, to ensure proper performance.

Model L-1Xe Quick Setup Instructions



WARNING : Electrical and plumbing connections need to be made by a licensed service person and comply with all Federal, State and Local Health, Electrical, Plumbing and Safety codes.

NOTE: WATER AND CHEMICALS TO THIS DISHWASHER MUST BE PROGRAMMED BY A QUALIFIED CHEMICAL SPECIALIST.

- CYCLE LIGHT
- 5 POWER
- THERMOMETER
- 6 DETERGENT
- 6 SANITIZER
- 6 RINSE
- DRAIN
- 7 FILL / START

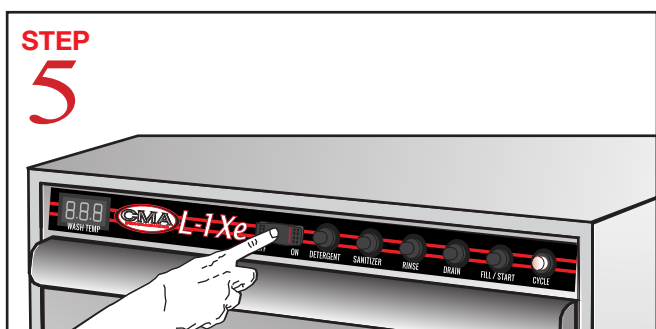
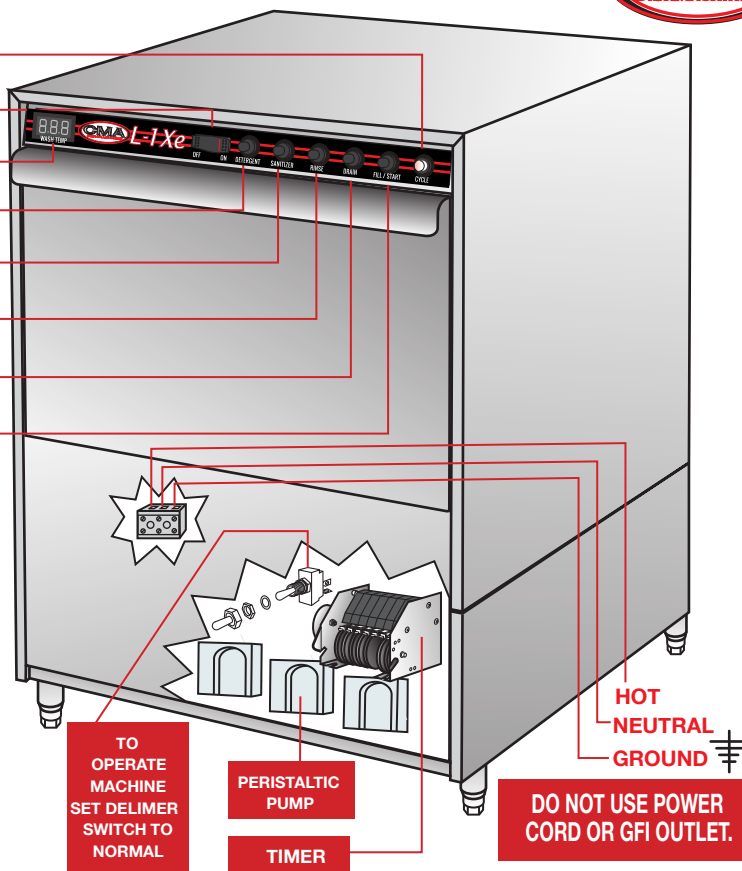

Push power switch to "ON" power.

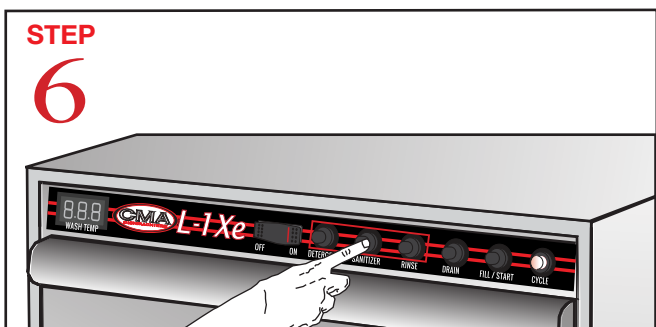

Press and Hold down "SANI", "DETERGENT" and "RINSE" switches to prime chemicals. This step must be repeated each time chemical containers are changed.

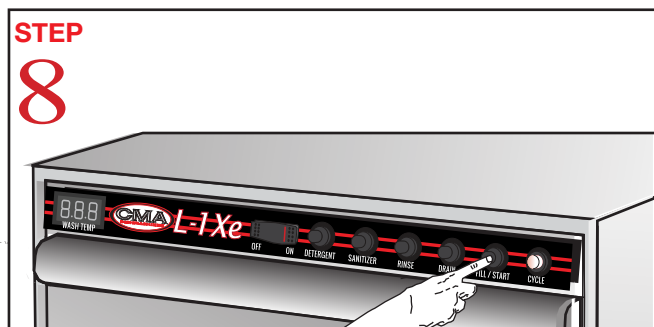
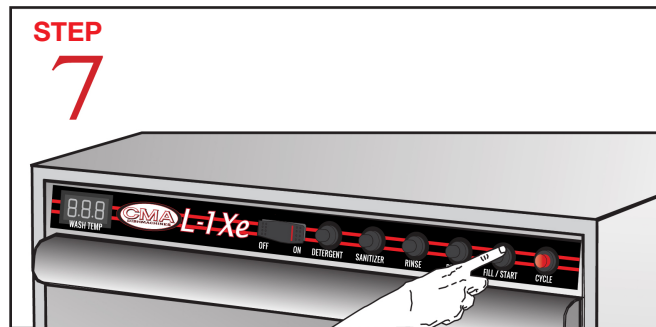

Close the door, then press start switch.

Hold down "FILL" Switch for approximately 10 - 15 seconds to allow water to flow into the dishwasher. The 4th cam of timer assembly has to be adjusted to maintain the same water level during the cycle.

an Ali Group Company

