

# Route Stand ASSEMBLY INSTRUCTIONS

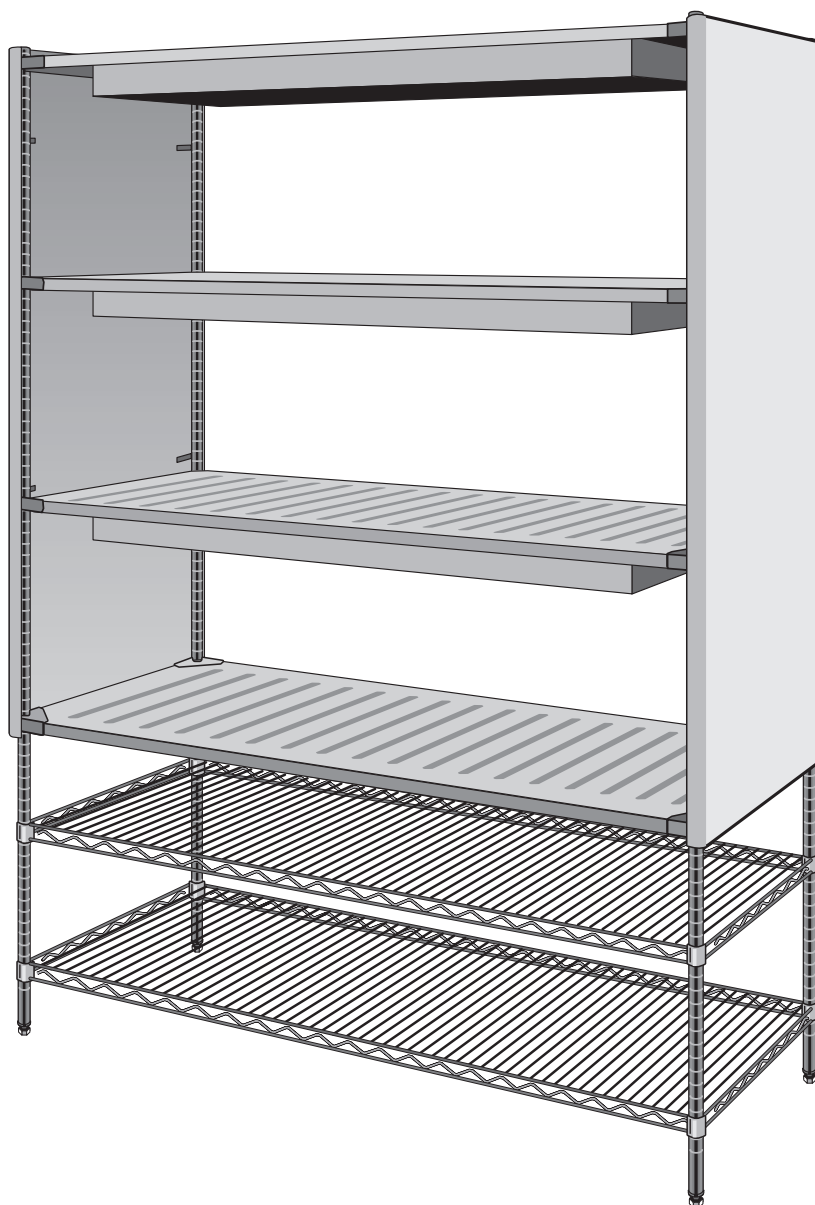

INSTR #320900 rev. E 12/23

## Route Stand



optional

### Route Stand

4 ea. DD8708 86"  
Split Post W/Thrd  
Connector

1 ea. 1860NC  
18" x 60" Wire  
Shelf (2nd wire  
shelf is optional -  
can be ordered  
separately)

4 ea. Solid Shelf  
(DD1310J)

1

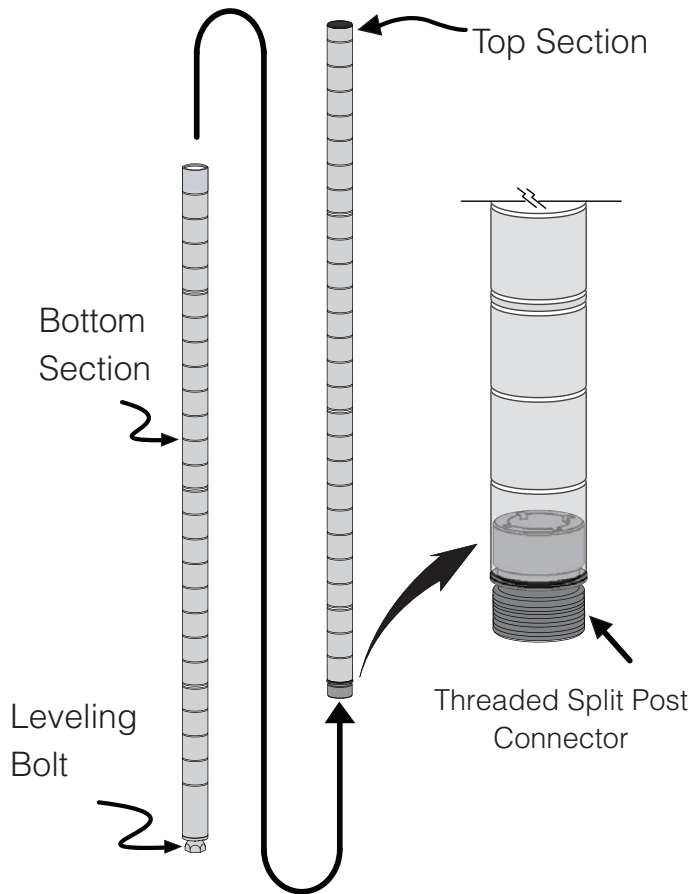

2

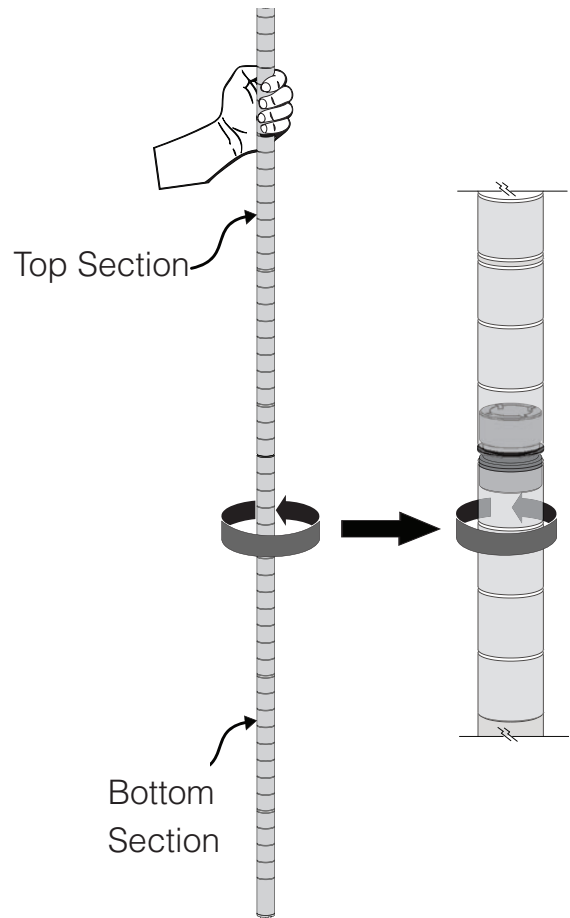

3

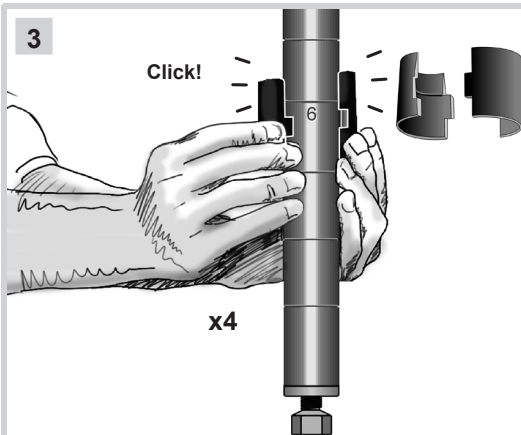

**IMPORTANT: All components attach to the posts by means of the black plastic split sleeves shown above.**

Snap a 2-piece plastic sleeve together around each post on groove #6 to support the bottom shelf. Be sure that the wider part is downward and the bead on the inside of the sleeves snaps into the numbered groove on the post.

4



Stand the 18" x 60" wire shelf on its side and, working from the bottom-side of the shelf, slide the four posts up through the post holes until the plastic sleeves on the posts are seated. Note: the mat wires on the top of the wire shelf and the collars are thicker at the bottom.

5

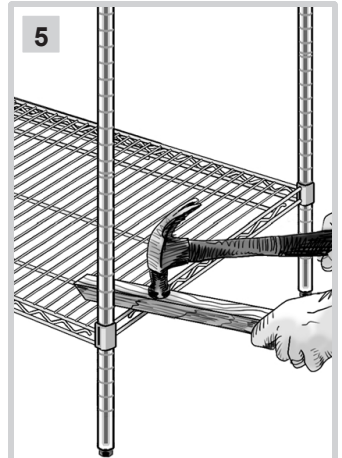

Set the unit upright on the floor and seat each corner of with a rubber mallet or with a hammer and board as shown above. Do this for every shelf.

6

4. Using split sleeves as in steps 4 and 6 above, attach the second Wire Shelf and the Solid Shelves (DD1310J) as shown at right.

2nd wire shelf is optional  
( can be ordered separately)

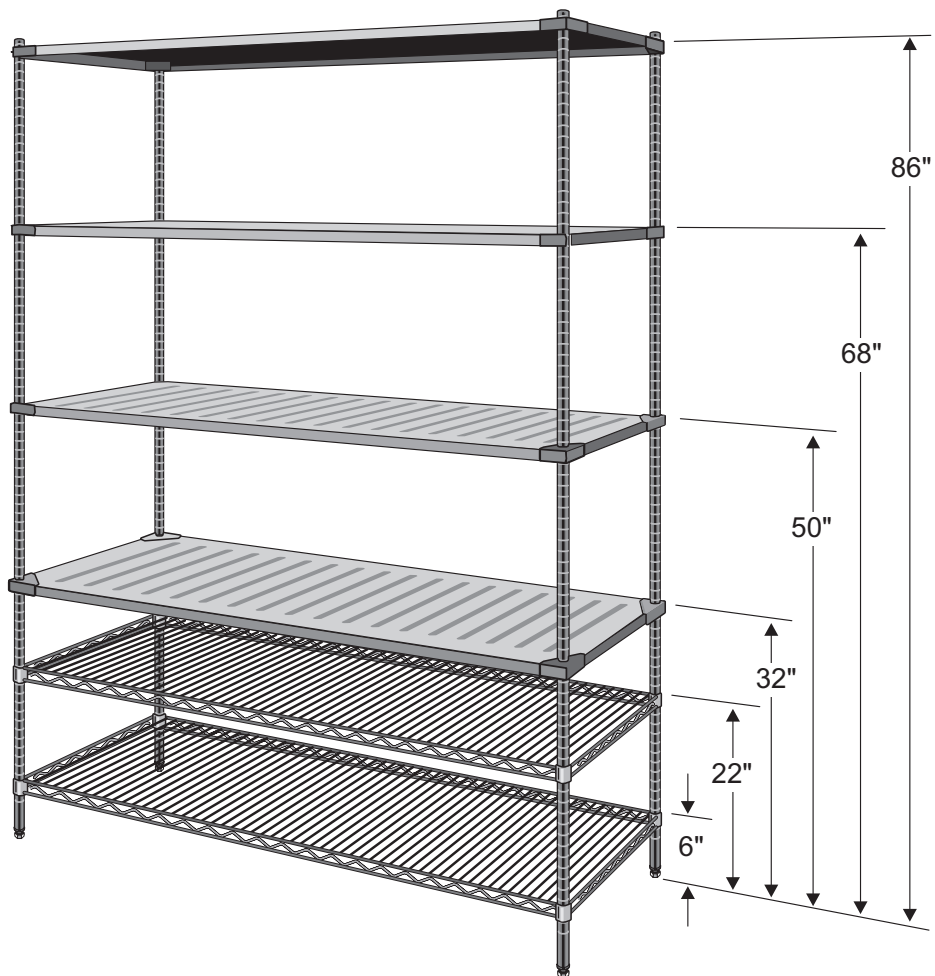

7

Install heaters according to manufacturer's instructions.

8

Attach End Panels (DD1310B) as shown at right, using the attached clips.

