

INSTRUCTIONS MANUAL

PIZZA OVEN ELECTRIC

MODEL



FS55E-1

FS66E-1

FS78E-1

FS55E-2

FS66E-2

FS78E-2



Intertek



Intertek

CONTENTS

A	GENERAL INFORMATIO _____	Page	2
A1	DESCRIBING _____	Page	4
A2	TECHNICAL INFORMATION _____	Page	5
A3	TRANSPORT _____	Page	9
A4	UNPACKING _____	Page	9
B	ASSEMBLY _____	Page	9
C	GENERAL WARNINGS _____	Page	11
D	USING THE DEVICE _____	Page	12
E	CLEANING and MAINTENANCE _____	Page	14
F	TROUBLESHOOTING _____	Page	15
I	SPARE PARTS LIST-DISASSEMBLED VIEW _____	Page	16

A GENERAL INFORMATION

PLEASE READ THE OPERATING AND MAINTENANCE INSTRUCTIONS CAREFULLY BEFORE INSTALLING THIS DEVICE. INCORRECT INSTALLATION AND PARTS REPLACEMENT DAMAGE TO THE PRODUCT.

IT MAY CAUSE INJURY TO PERSONS. OUR COMPANY IS NOT RESPONSIBLE FOR INTENTIONAL DAMAGE TO THE DEVICE, DAMAGES CAUSED BY NEGLIGENCE, FAILURE TO COMPLY WITH THE INSTRUCTIONS AND REGULATIONS, OR INCORRECT CONNECTIONS. UNAUTHORIZED INTERFERENCE WITH THE DEVICE WILL VOID THE PRODUCT WARRANTY.

1. Keep this manual handy in a safe place for future reference to other operators.
2. **The installation of the device must be carried out by authorized personnel in accordance with the current regulations and instructions in the country where it will be used.**
3. This device must be used by trained persons.
4. In case of device malfunction, turn off the device. Only a service center authorized by the manufacturer should service the device. Ask for original spare parts.

WARNING:

- This device must be installed in accordance with current legislation and used only in a well-ventilated area. See instructions before installing and using this device.
- Improper installation, adjustment, replacement, service or maintenance may result in property damage, injury or death. Read installation, use and maintenance instructions before installing or servicing this equipment.

SAFETY SYMBOLS



These symbols are intended to alert the user to the presence of important operating and maintenance instructions in the manual accompanying the appliance.

SERVICE AND MAINTENANCE / MAINTENANCE AND REPAIRS

Contact your local authorized service agent for service or required maintenance.

Contactez un technicien agréé pour toute réparation ou maintenance.

Please record the model number, serial number, voltage and purchase date in the area below and have it ready when you call to ensure a faster service.

Model No.
Serial No.
Voltage
Purchase Date

Authorized Service Agent Listing Reference the listing provided with the unit Or for an updated listing go to

Website / Site web: www.empero.com.tr

E-mail / Courriel: empero@empero.com.tr

Service Help Desk	
Company	Galaxy Group Corp
Website / Site	www.galaxygroupcorp.com
Telephone	(908) 315-3222
Fax	-
Adresse:	899 Newark Tpke, Kearny NJ 07032 USA

IMPORTANT

Before operating the device, ensure that all paper protection and packaging is removed. This device should only be installed in the closed position.



WARNING : The device must be used by trained personnel.

*This high efficiency appliance is a professional electric pizza oven for use in industrial kitchens. Direct contact with food in ovens is limited to pizza, bread and bakery products.

Other foods can be used as long as they are cooked in a pan or on a tray.

Model	Depth (A) Cm / inch	Width (B) Cm / inch	Height (C) Cm / inch	Approximate weight	
				Without package Kg / Lb	Packed Kg / Lb
FS55E-1	1309 mm 51.54"	1171.7 mm 46.13"	1247.7 mm 49.12"	325 kg 716.50 lb	375 kg 826.73 lb
FS66E-1	1615 mm 63.58"	1171.7 mm 46.13"	1247.7 mm 49.12"	410 kg 903.89 lb	470 kg 1036.17 lb
FS78E-1	1915 mm 75.39"	1171.7 mm 46.13"	1247.7 mm 49.12"	460 kg 1014.13 lb	530 kg 1168.45 lb
FS55E-2	1309 mm 51.54"	1171.7 mm 46.13"	1346.4 mm 53.01"	635 kg 1399.94 lb	700 kg 1543.24 lb
FS66E-2	1615 mm 63.58"	1171.7 mm 46.13"	346.4 mm 53.01"	805 kg 1774.72 lb	880 kg 1940.07 lb
FS78E-2	1915 mm 75.39"	1171.7 mm 46.13"	1346.4 mm 53.01"	905 kg 1995.18 lb	990 kg 2182.58 lb

A2 INFORMATIONS TECHNIQUES

Model	Voltage	Total Input BTUs	KW Total	Ampere (Max.)
FS55E-1	208 V-1P	-	9 KW	43,3 A
	208 V-3P			25 A
FS66E-1	208 V-1P	-	11,25 KW	54 A
	208 V-3P			31,25 A
FS78E-1	208 V-1P	-	13 KW	62,5 A
	208 V-3P			36,25 A
FS55E-2	208 V-1P	-	18 KW	86,5 A
	208 V-3P			50 A
FS66E-2	208 V-1P	-	22,50 KW	108,2 A
	208 V-3P			62,50 A
FS78E-2	208 V-1P	-	26 KW	125 A
	208 V-3P			72,50 A

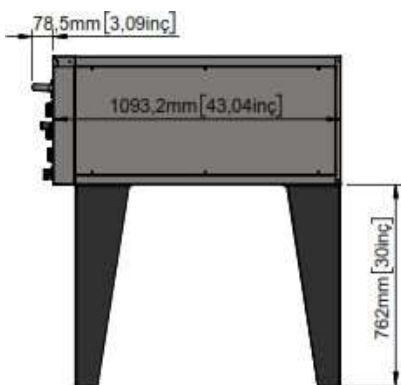
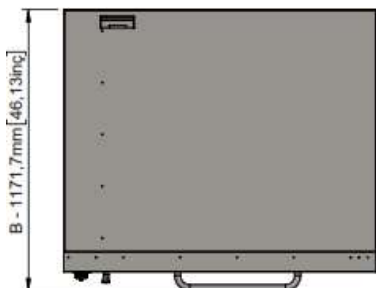
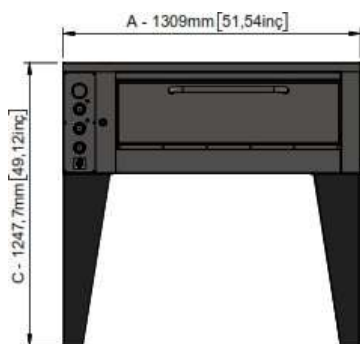

FS55E-1

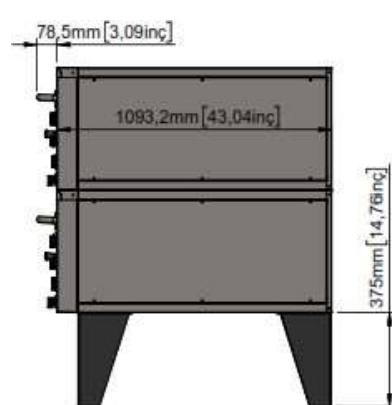
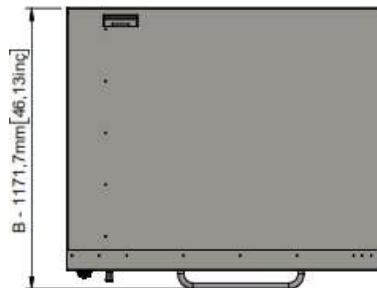
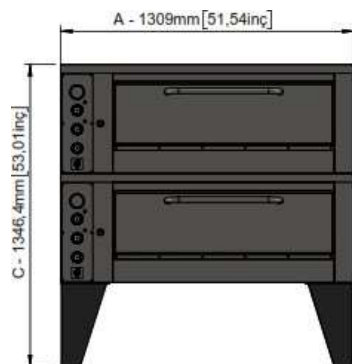

FS55E-2

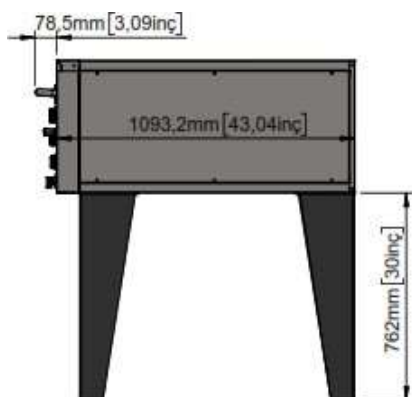
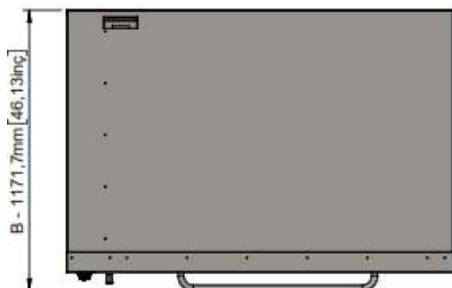
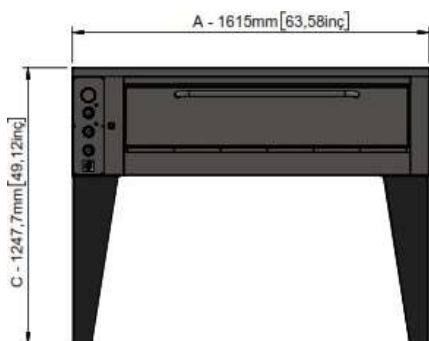

FS66E-1

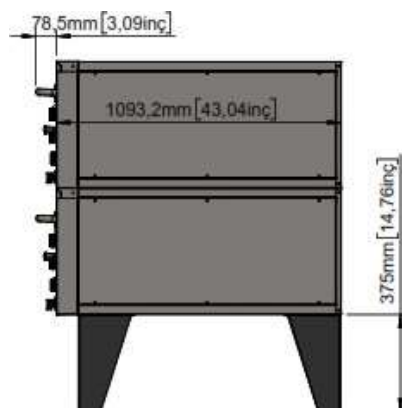
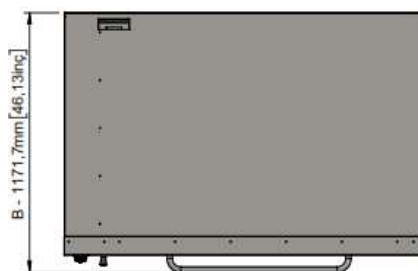
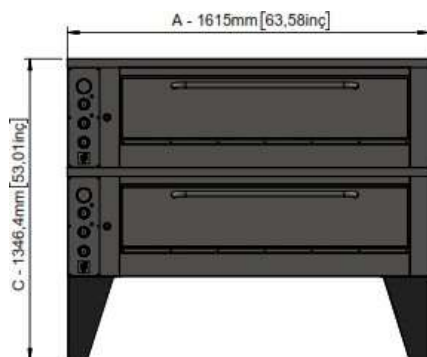

FS66E-2

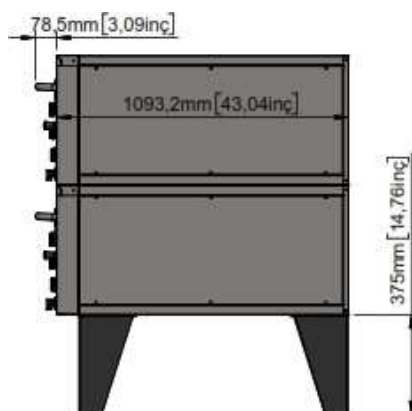
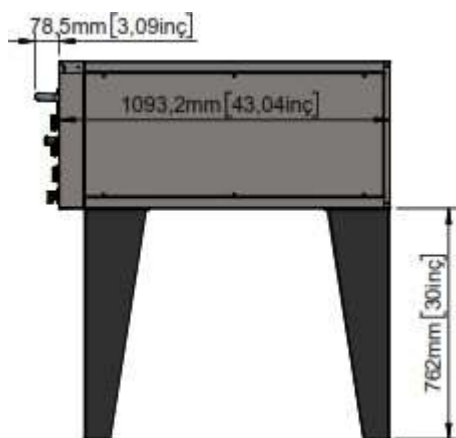
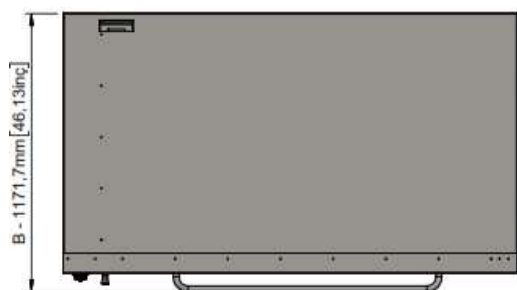
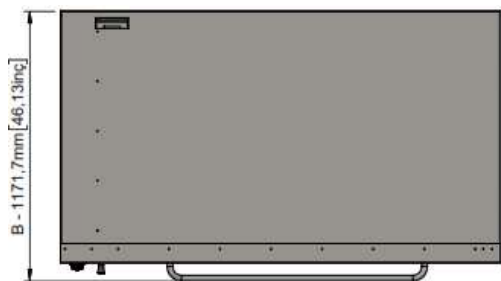
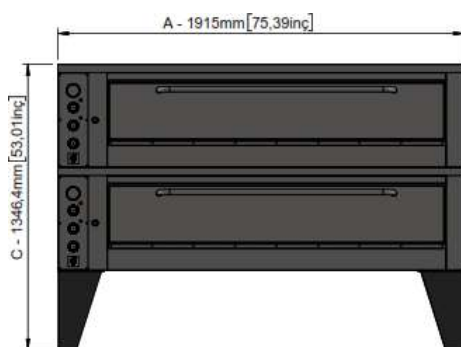
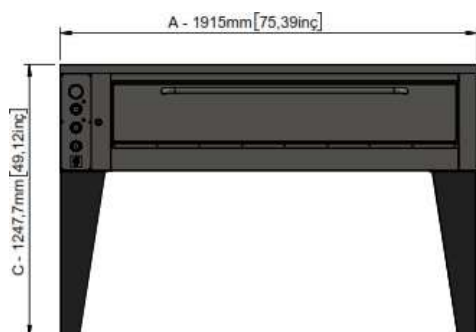

FS78E-1

FS78E-2

A3 TRANSPORT

*This device cannot be handheld. Therefore, use a lifting vehicle (forklift or pallet truck) to transport the device. (The lifting arms of the forklift or pallet truck must reach more than half of the bottom of the device).

A4 UNPACKING

*The device must be opened and its packaging must be destroyed in accordance with the regulations in the country of use. Food contact parts are stainless steel. All plastic parts are marked with the symbol of the material.

*Check that the parts of the device are complete and that there is no damage during transportation.

B ASSEMBLY

*Place the product on a flat and solid ground, take necessary precautions against risks of tipping over.

*The personnel who will provide installation and service to the device must be experts in their field and have an installation-service license issued by our company.

*All adjustments and changes related to the electrical connection of the device must be made by an authorized person.

*The appliance must be connected in accordance with the national and local electrical standards of the country concerned.



The grounding connection of the device must be made in accordance with standards and safety rules.

*The grounding of the device must be connected to the grounding line of the electrical installation on the nearest panel.

*The device's electrical connection, main fuse and residual current fuse must be made in accordance with the applicable regulations and rules.



GAPS		
	Flammable	Fireproof
Ground	N/A	30" / 762 mm
Sides	N/A	12" / 304,8 mm
Back	N/A	3" / 76,2 mm

WARNING: Leave enough space around the device for adequate ventilation. Read and follow all labels on the unit.



Hot surface

C GENERAL WARNINGS



*Do not use the device in facilities without adequate lighting.



*Do not touch any moving parts while using the device.



*Do not install the device near flammable or explosive materials. There should be a minimum distance of 10 cm between oven surfaces and flammable materials.



*Do not run the device idle.



*Do not load too much below or above the capacity of the device.



*Do not intervene in the device without using appropriate protective equipment.



*Do not open the oven door while the cooking compartment is hot.



*In the event of a fire or flame flash for any reason in the area where the appliance is being used, immediately turn off the electrical switches (if any) and use a fire extinguisher. Never use water to extinguish the flame.



*Never allow the tightness check to be carried out with flame.



*A hood large enough to completely cover the oven must be installed. Hood pipes, can be used without fans up to a maximum of 3 meters. If the hood pipe distance is more than 3 meters, a fan must be installed.

D USING THE DEVICE

Control Panel:

- A : Thermometer
- B: Indicator lamp
- C :Thermostat up/
down
- D: ON/OFF switch

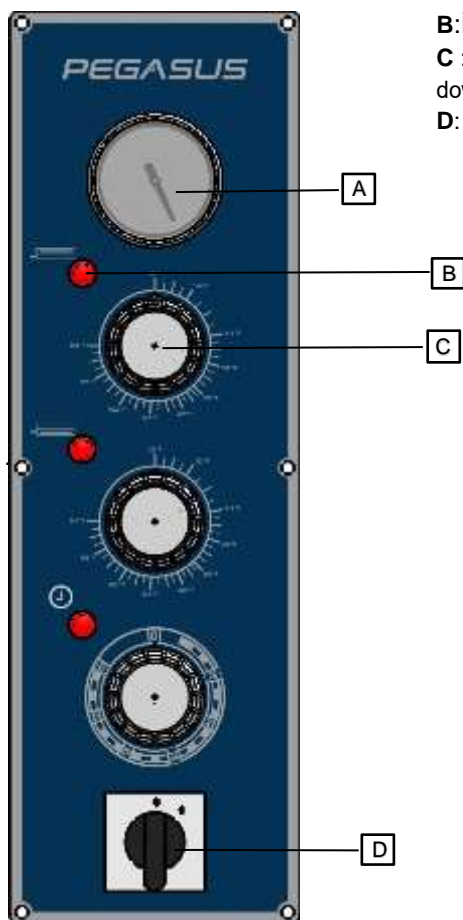

D USING THE DEVICE

USE OF:

- Clean and dry the internal and external surfaces with a warm damp cloth before operating The device.
- Turn the ON/OFF switch to the on position to operate the device.
- Set the thermostat temperature setting to the desired temperature.
- Preheat the appliance before placing the product. To do this, run the appliance for 5-10 minutes at a temperature above 140°F.
- Place the pizzas in the oven and close the appliance door.
- During cooking, press the lighting button to see the product without opening the appliance door.
- When finished using the appliance, turn the ON/OFF switch to the off position and unplug the appliance.

E CLEANING and MAINTENANCE

➤ WHAT TO DO AFTER EACH USE:

- Make sure that the electrical connections are switched off when cleaning the appliance.
- After each use, clean the dirt on the interior surfaces of the oven with a soft cloth using a degreasing spray before the device cools down completely.
- Do not use acid or similar materials when cleaning the device.
- Do not use pressurized water or steam when cleaning the device.
- Do not clean the device with materials that may scratch the chrome material, such as steel wool.

➤ THINGS TO BE DONE PERIODICALLY;

- Maintenance should only be performed by trained persons.
- Perform periodic maintenance of the device every 15 days.
- Check the lighting lamp according to the frequency of use.
- Check the cooking stones at regular intervals. Replace broken or deformed stones.
- Check the ventilation of the environment where the device is located at regular intervals.

F TROUBLESHOOT

THE DEVICE DOES NOT WORK	<ol style="list-style-type: none"> 1. Check if the appliance is plugged in. 2. Check the electrical connections and voltage. 3. Check if the fuse is on or off. 4. Check the resistances.
THE APPLIANCE DOESN'T COOK WELL	<ol style="list-style-type: none"> 1. Check the heat settings. 2. Do not overload the oven.
THE APPLIANCE STOPPED	<ol style="list-style-type: none"> 1. The appliance can stop due to low voltage. In this situation check the voltage 2. When the oven operating temperature is more than maximum temperature, the oven will get STOP position automatically.

- If cooking at Pizza Ovens (Electric) is not done at suitable quality
- If any function of security doesn't work
- Do not use the appliance.

***If the above problems still persist, contact our authorized services.**

I SPARE PARTS LIST- DISASSEMBLED VIEW

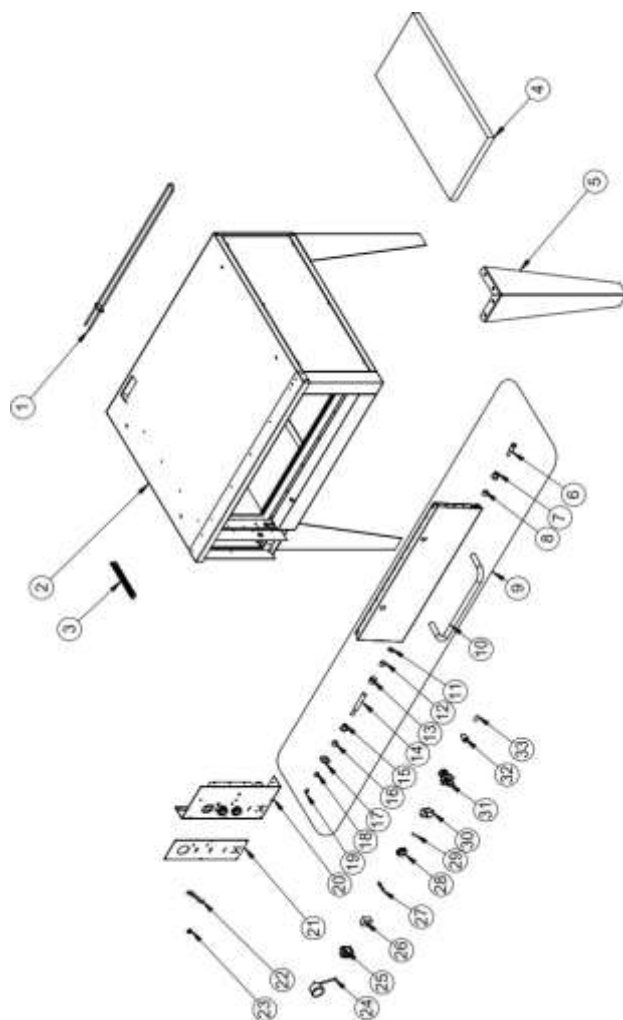

FS55E-1

I SPARE PARTS LIST- DISASSEMBLED VIEW

FS55E-1		
NO	NAME OF THE PRODUCT	PRODUCT CODE
1	126121 208V-600 W RESISTANCE	M.ELK-RZS-BRU-BPE-003
2	CHASSIS	-
3	THERMOSTAT HOUSING SHEET	YSC-KNX.EPZ-PN-0218
4	STONE (910*457*40)	M.TAS-FRN-BP-003
5	FOOT STICK	YSC-KNX.BP-LZ-0025
6	COVER DRIVE SHAFT	YTL-KNX.BP-KS-0007
7	COVER SHAFT LOWER BUSHING	YTL-KNX.BP-KS-0003
8	UPPER COVER SHAFT LOWER BUSHING	YTL-KNX.BP-KS-0004
9	COVER	ARA-KNX.BP-EB-0001
10	COVER HANDLE	YBR-KNX.BPE-KS-0004
11	PUL	YSC-KNX.BP-LZ-0016
12	UPPER COVER SHAFT LOWER BUSHING	YTL-KNX.BP-KS-0004
13	COVER SHAFT LOWER BUSHING	YTL-KNX.BP-KS-0003
14	COVER SHAFT	YTL-KNX.BPE-KS-0001
15	COVER SHAFT LOWER BUSHING	YTL-KNX.BP-KS-0003
16	UPPER COVER SHAFT LOWER BUSHING	YTL-KNX.BP-KS-0004
17	BUSHING HOLDING WASHER	YSC-KNX.BP-LZ-0018
18	SPRING HOLDER BUSHING	YTL-KNX.BP-KS-0010
19	SPRING BINDING SPACER	YTL-KNX.BP-KS-0011
20	LEFT FRONT SHAFT	YSC-KNX.BPE-LZ-0006
21	TAG	M.AKS-ETK-ALM-021
22	COVER SPRING	M.YAY-BP-001
23	RAKOR	JP.M.ELK-RKR-PLS-008
24	DEGREES FAHRENHEIT	JP.M.ELK-EDM-DGT-015
25	572 DEGREE LIMITER	M.ELK-MEK-LMT-018
26	85-450 SINGLE-PHASE THERMOSTAT	M.ELK-MEK-TRM1-002
27	RED SIGNAL LIGHT 110V	M.ELK-LMB-SNY-011
28	OVEN BUTTON	JP.M.AKS-DGM-MUH-005
29	BUTTON SOCKET	M.AKS-DGM-SKT-002
30	TIME CLOCK	JP.M.ELK-MEK-MTM-004
31	(0-1) SWITCH	M.ELK-SLT-KRS-005
32	KULP	JP.M.AKS-KLP-BKL-022
33	METAL LABEL	M.AKS-OZL-MTL-006

I SPARE PARTS LIST- DISASSEMBLED VIEW

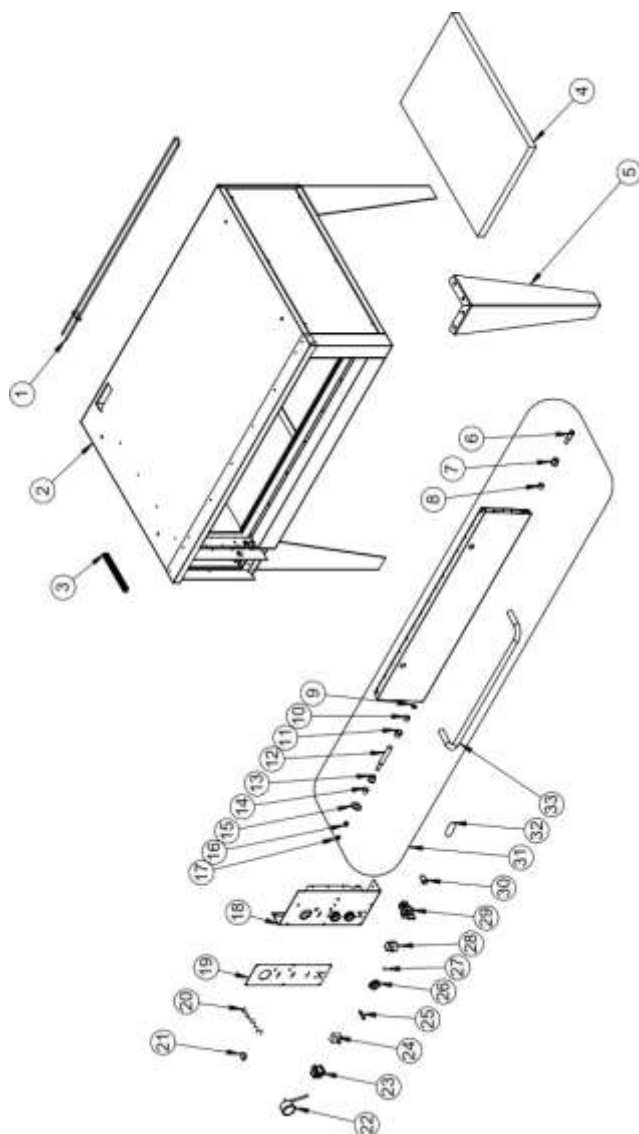

I SPARE PARTS LIST- DISASSEMBLED VIEW

FS66E-1		
NO	NAME OF THE PRODUCT	PRODUCT CODE
1	126122 208V-750W RESISTANCE	M.ELK-RZS-BRU-BPE-001
2	CHASSIS	-
3	THERMOSTAT HOUSING SHEET	YSC-KNX.EPZ-PN-0218
4	STONE (910x610)	M.TAS-FRN-BP-001
5	FOOT STICK	YSC-KNX.BP-LZ-0025
6	COVER DRIVE SHAFT	YTL-KNX.BP-KS-0007
7	COVER SHAFT LOWER BUSHING	YTL-KNX.BP-KS-0003
8	UPPER COVER SHAFT LOWER BUSHING	YTL-KNX.BP-KS-0004
9	PUL	YSC-KNX.BP-LZ-0016
10	UPPER COVER SHAFT LOWER BUSHING	YTL-KNX.BP-KS-0004
11	COVER SHAFT LOWER BUSHING	YTL-KNX.BP-KS-0003
12	COVER SHAFT	YTL-KNX.BPE-KS-0001
13	COVER SHAFT LOWER BUSHING	YTL-KNX.BP-KS-0003
14	UPPER COVER SHAFT LOWER BUSHING	YTL-KNX.BP-KS-0004
15	BUSHING HOLDING WASHER	YSC-KNX.BP-LZ-0018
16	SPRING HOLDER BUSHING	YTL-KNX.BP-KS-0010
17	SPRING BINDING SPACER	YTL-KNX.BP-KS-0011
18	LEFT FRONT SHAFT	YSC-KNX.BPE-LZ-0006
19	TAG	M.AKS-ETK-ALM-021
20	COVER SPRING	M.YAY-BP-001
21	RAKOR	JP.M.ELK-RKR-PLS-008
22	DEGREES FAHRENHEIT	JP.M.ELK-EDM-DGT-015
23	572 DEGREE LIMITER	M.ELK-MEK-LMT-018
24	85-450 SINGLE-PHASE THERMOSTAT	M.ELK-MEK-TRM1-002
25	RED SIGNAL LIGHT 110V	M.ELK-LMB-SNY-011
26	OVEN BUTTON	JP.M.AKS-DGM-MUH-005
27	BUTTON SOCKET	M.AKS-DGM-SKT-004
28	TIME CLOCK	JP.M.ELK-MEK-MTM-004
29	(0-1) SWITCH	M.ELK-SLT-KRS-005
30	KULP	JP.M.AKS-KLP-BKL-022
31	COVER	ARA-KNX.BP-EB-0002
32	METAL LABEL	M.AKS-OZL-MTL-006
33	COVER HANDLE	YBR-KNX.BPE-KS-0002

I SPARE PARTS LIST- DISASSEMBLED VIEW

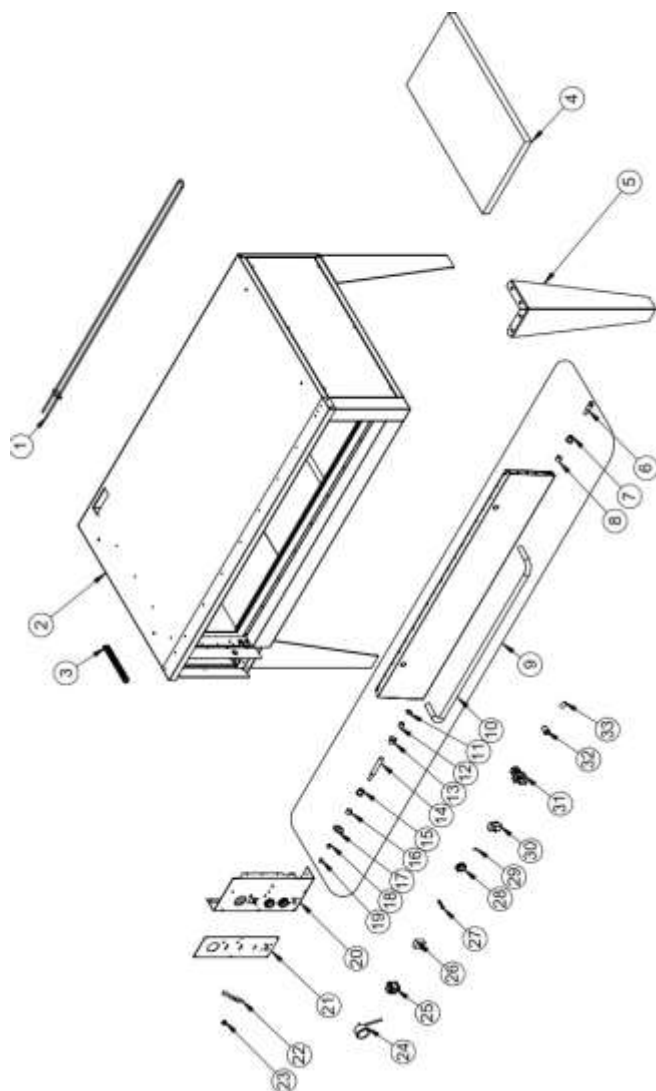

FS78E-1

I SPARE PARTS LIST- DISASSEMBLED VIEW

FS78E-1		
NO	NAME OF THE PRODUCT	PRODUCT CODE
1	208V-870 W RESISTANCE	M.ELK-RZS-BRU-BPE-002
2	CHASSIS	-
3	THERMOSTAT HOUSING SHEET	YSC-KNX.EPZ-PN-0218
4	STONE (507x910)	M.TAS-FRN-BP-002
5	FOOT STICK	YSC-KNX.BP-LZ-0025
6	COVER DRIVE SHAFT	YTL-KNX.BP-KS-0007
7	COVER SHAFT LOWER BUSHING	YTL-KNX.BP-KS-0003
8	UPPER COVER SHAFT LOWER BUSHING	YTL-KNX.BP-KS-0004
9	COVER	ARA-KNX.BP-EB-0003
10	COVER HANDLE	YBR-KNX.BPE-KS-0003
11	PUL	YSC-KNX.BP-LZ-0016
12	UPPER COVER SHAFT LOWER BUSHING	YTL-KNX.BP-KS-0004
13	COVER SHAFT LOWER BUSHING	YTL-KNX.BP-KS-0003
14	COVER SHAFT	YTL-KNX.BPE-KS-0001
15	COVER SHAFT LOWER BUSHING	YTL-KNX.BP-KS-0003
16	UPPER COVER SHAFT LOWER BUSHING	YTL-KNX.BP-KS-0004
17	BUSHING HOLDING WASHER	YSC-KNX.BP-LZ-0018
18	SPRING HOLDER BUSHING	YTL-KNX.BP-KS-0010
19	SPRING BINDING SPACER	YTL-KNX.BP-KS-0011
20	LEFT FRONT SHAFT	YSC-KNX.BPE-LZ-0006
21	TAG	M.AKS-ETK-ALM-021
22	COVER SPRING	M.YAY-EBP-001
23	RAKOR	JP.M.ELK-RKR-PLS-008
24	DEGREES FAHRENHEIT	JP.M.ELK-EDM-DGT-015
25	572 DEGREE LIMITER	M.ELK-MEK-LMT-018
26	85-450 SINGLE-PHASE THERMOSTAT	M.ELK-MEK-TRM1-002
27	RED SIGNAL LIGHT 110V	M.ELK-LMB-SNY-011
28	OVEN BUTTON	JP.M.AKS-DGM-MUH-005
29	BUTTON SOCKET	M.AKS-DGM-SKT-002
30	TIME CLOCK	JP.M.ELK-MEK-MTM-004
31	(0-1) SWITCH	M.ELK-SLT-KRS-005
32	KULP	JP.M.AKS-KLP-BKL-022
33	METAL LABEL	M.AKS-OZL-MTL-006

I ELECTRIC SCHEME

