



**Your Ultimate Choice in
Profitable Cleaning Performance!**

**OPERATING INSTRUCTIONS
FORCE 14
Upright Vacuum**

Sandia Products

15571 Container Lane
Huntington Beach, CA 92649
USA

T: (001) 714-901-8400

F: (001) 714-901-8404

www.sandioplastics.com



Congratulations on your purchase of a Sandia Products.

This machine has been manufactured in the EC under the most stringent manufacturing and quality standards. These Operating Instructions contain all the necessary information relating to the operation and maintenance of the machine. Read these Operating Instructions carefully before you start using the machine or carry out any maintenance activities. You will find that this machine will more than fulfil your needs. You will get the best results with the least cost if you:

- Handle the machine carefully.
- Maintain the machine in accordance with the instructions contained in this booklet.
- Maintain the machine using parts and components supplied or approved by distributor.

You can order all the required materials at our service centers, distributors or subsidiary companies. Make sure you include the type and the serial number of your machine when you place an order.

Three hints to keep your vacuum cleaner happy.

1. To maintain optimum performance, check, change the dustbag and filters in time.
2. If the green light is not light there is a defect in the electric supply or in the cable. If you change the cable, always use the cable-restrain.
3. Keep this vacuum cleaner clean and tidy. .
This vacuum cleaner is for professional use and should reflect that

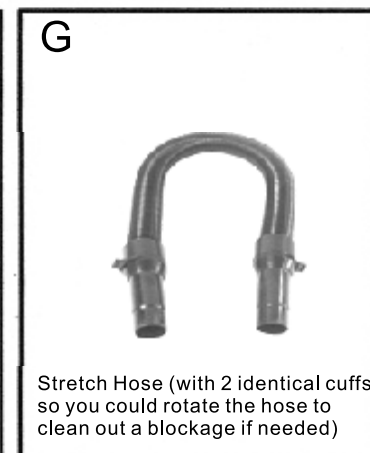
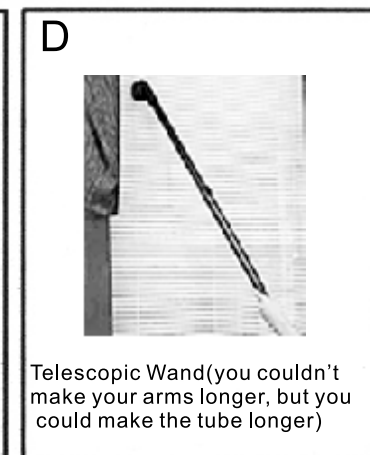
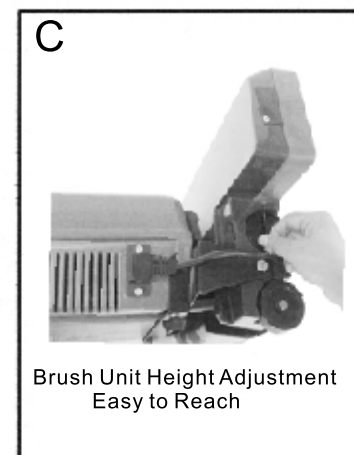
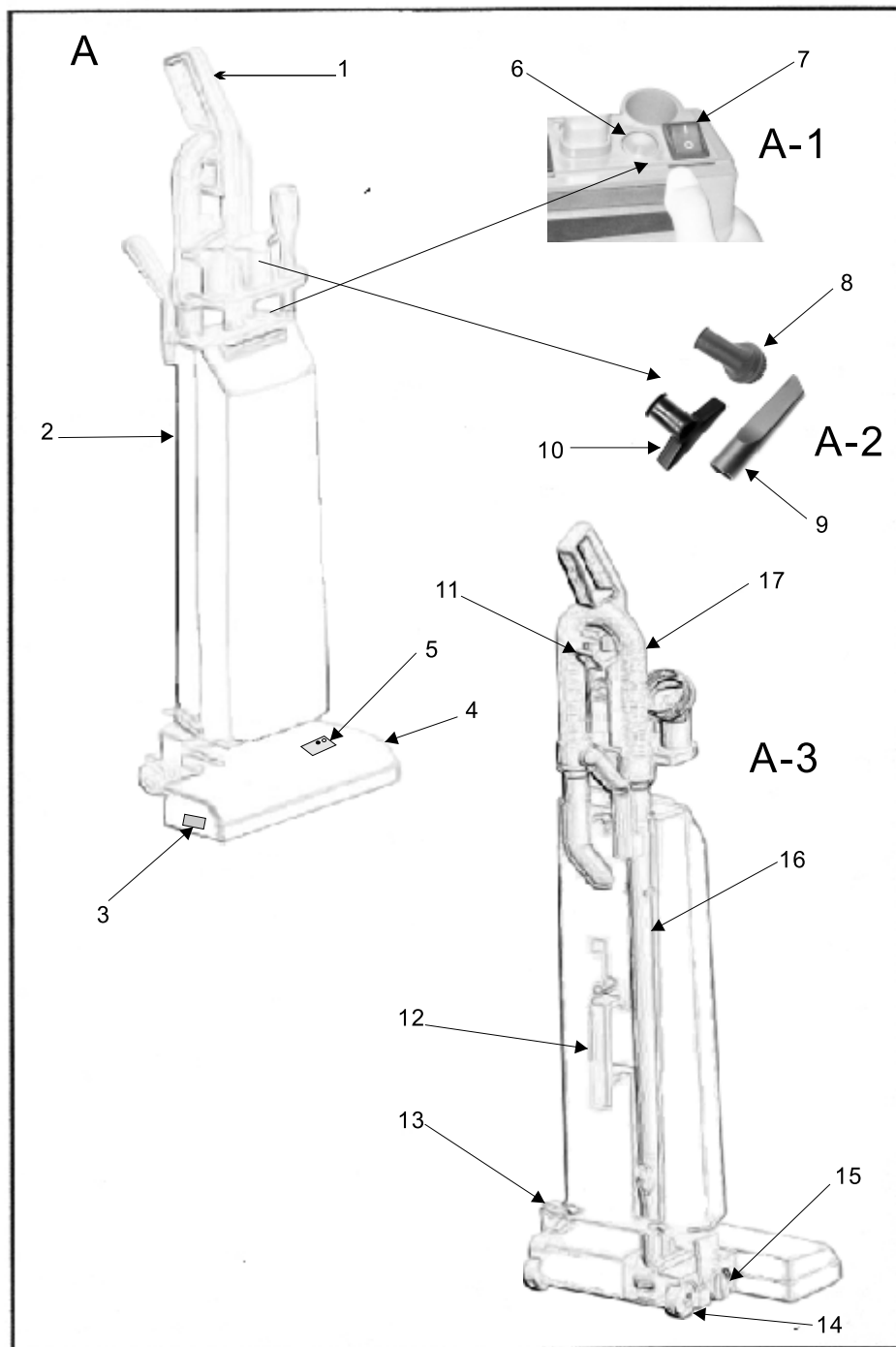

This manual is furnished with each new model. It provides necessary operating and preventive maintenance instructions. Read this manual completely and understand the machine before operating or servicing it.

This machine will provide excellent service. However, the best results will be obtained at minimum costs if:

- The machine is operated with reasonable care.
- The machine is maintained regularly - per the maintenance instructions provided.
- The machine is maintained with **Mercury** supplied or approved parts.

TABLE OF CONTENTS

SAFETY PRECAUTIONS

GENERAL INSTRUCTIONS

MACHINE COMPONENTS

INSTALLATION

PLACING POWER CORD

MACHINE OPERATION

PRE OPERATION CHECKS

UPRIGHT CARPET VACUUM CLEANING

REMOTE VACUUM WAND CLEANING

THE DUST BAG FULL INDICATOR

DUST BAG REMOVAL AND INSTALLATION

ROUTINE CARE AND MAINTENANCE

THERMAL OVERLOAD

CLEANING OR REPLACING INLET FILTER

REPLACING BRUSH

STORAGE INFORMATION

WARRANTY

SPECIFICATIONS

TROUBLE SHOOTING

EXPLOSION VIEWS

EXPLOSION VIEWS ITEM LIST

FREQUENTLY USED PARTS

SAFETY PRECAUTIONS

The following expressions are used throughout this manual as indicated in their description:



WARNING: To warn of hazards or unsafe practices which could result in severe personal injury or death.

FOR SAFETY: To identify actions which must be followed for safe operation of equipment.

USAGE

This machine is suited to pick up dirt and dust in an indoor environment and is not constructed for any other use. The pick up of any liquid or dangerous type of dust is unsuitable and therefore usage of this type is not allowed.

The following information signals potentially dangerous conditions to the operator or equipment. Know when these conditions can exist. Locate all safety devices on the machine. Then, take necessary steps to train machine operating personnel. Report machine damage or faulty operation immediately.

Do not use the machine if it is not in proper operating condition.

FOR SAFETY

1. Do Not Operate, Maintain, or Service Machine:

- Unless Trained And Authorized.
- Unless Operation Manual Is Read And Understood.
- With Damaged Cord Or Plug.

2. When Using Machine:

- Do Not Pick Up Live Ashes Or Cigarette Butts.

3. Before Leaving Or Servicing Machine:

- Turn Off Machine And Unplug Power Cord From Outlet.



WARNING: Hazardous Voltage. Shock Or Electrocution Can Result. Unplug Power Cord Before Working On Machine.



WARNING: Do not store outdoors and avoid getting wet by rain etc.



WARNING: The use of attachments other than those recommended and supplied by the manufacturer may be hazardous.



GENERAL INSTRUCTIONS

Throughout this book references are made to figure numbers. These figures can be found on the page at the end of this manual.

MACHINE COMPONENTS

Refer to Fig.A

- 1.Handle
- 2.Bag Housing
- 3.Power Brush Housing
- 4.Brush Housing
- 5.Electronic Display
- 6.Full Bag Light
- 7.Main Power Switch
- 8.Plumeau Round
- 9.Crevise Tool
- 10.Upholstery Tool
- 11.Upper Cord Hook
- 12.Transport Handle
- 13.Release Handle
- 14.Rear Wheel
- 15.Brush Height Adjustment
- 16.Wand
- 17.Hose

Note: The italicized words in the following sections refer to items in the MACHINE COMPONENTS list. These are only italicized the first time they appear.

INSTALLATION

Carefully check carton for signs of damage. Report damages at once to the carrier.

Unpack the machine and check machine for completeness according to the packing list. Check whether the cord plug installed corresponds to your wall outlet. Complete the machine:

1. Install *handle* by sliding it into the opening in the top of the *bag housing* until it bottoms out. Install and tighten with the M5 thumbscrew.
2. Install the *hose* by pushing one end into the top of the bag housing. Push the other end into the *wand*.
3. Position the open end of wand over the opening of the *power brush housing* and push the wand into the sleeve in the back of bag housing until it snaps into the notch
4. Make sure the dust bag is installed. For instructions refer to the DUST BAG REMOVAL AND INSTALLATION.

5. Snap the upholstery tool and crevice tool into the *option mount*.

6. Plug the *cord pigtail* into the outlet at the back of the vacuum housing.

PLACING POWER CORD

According to your preference you can place the power cord on the machine in two ways:

1. Coil the cord (starting at the machine side to prevent cord turns) and hang it on the *upper cord hook*.
2. Wrap cord around the *upper* and *lower hooks*.

MACHINE OPERATION

NOTE: This machine is suitable for voltages from 230 Volt AC / 50 Hz.

PRE OPERATION CHECKS

1. Check to ensure a dust bag is installed. Replace bag if needed.
2. Check brush area for any thread, string or debris that may be wrapped around the brush.

UPRIGHT CARPET VACUUM CLEANING

1. Plug the power cord into a receptacle.
2. Adjust the brush height knob to suit the carpet thickness you are going to clean. The carpet indicator shows its position

3. Turn the *main power switch* on. The vacuum fan motor will turn. (Refer to figure A-1)
4. While holding the handle depress the red *release handle* pedal (Refer to figure B) and lower the handle to a convenient operating position. When the handle is lowered the brush motor will start turning.

5. Clean the floor using normal vacuuming procedure.

REMOTE VACUUM WAND CLEANING

1. Keep machine in a stable position, preferably an upright position.
2. Plug in the power cord and switch on the machine as described in the UPRIGHT CARPET VACUUM CLEANING.

3. Remove the wand by snapping it out of the retainer clip and pulling it from its inlet. The brush motor will stop automatically when the wand is removed.

4. Attach your choice of either the upholstery or crevice tool to the wand and clean as you like.

5. When finished cleaning replace the tool and wand to their storage positions. Make sure the wand fits tightly into the base inlet so it will not leak.

THE DUST BAG FULL INDICATOR

1. Your machine has a red *full bag* light which will come on when the airflow is obstructed indicating the dust bag is full.
2. If the light comes on switch off the machine, unplug the cord and check the dust bag. Replace the bag when it is full. For instructions see the DUST BAG REMOVAL AND INSTALLATION.
3. If the light comes on and the dust bag is not full there is an obstruction somewhere in the system.

DUST BAG REMOVAL AND INSTALLATION

1. Open the bag housing by pushing on the *door latch*. Fold the ends of the dust bag together and carefully remove the bag. Dump the bag in a disposal container.
2. Always install a new dust bag directly after removing a full one.
3. To install the new dust bag, push the bag onto the inlet of the fan motor as far as it will go. Fold the top down so it will not interfere with the door latch.
4. Close the door ensuring that it latches properly.

ROUTINE CARE AND MAINTENANCE

The maintenance should be carried out by authorised maintenance personnel only. Every year the machine should be safety certified according to local safety standards (UVV). Contact your dealer for the most adequate and best service.



WARNING:
Hazardous Voltage.
Shock or Elec-trocution
Can Result. Unplug Power
Cord Before Working On
Machine.

The machine exterior should be cleaned once a week with a dust towel. A damp towel together with a mild detergent may be used.

DO NOT USE WATER.

Every week
Inspect and clean the filter at the vacuum motor inlet.

Every month
Inspect brush for wear. If brush strips no longer touch the carpet they have to be replaced.

Every year
The carbon brushes in the vacuum and brush motor have to be inspected for wear.

The vacuum cleaner is equipped with an electronic power brush alert: two lights - GREEN and RED. Refer to figure 7.

GREEN LIGHT:
Lower Brush operates properly.

RED & GREEN LIGHT:
Brush drive belt broken.
Refer to Trouble Shooting.

RED LIGHT:

Brush rotation obstructed.
Refer to Trouble Shooting.

These lights alert the operator of problems which must be corrected immediately. Monitor these lights during operation.

THERMAL OVERLOAD

The internal temperature of the vacuum motor is sensed at all times. When the temperature gets too high the sensor shuts off the vacuum motor. Inspect the machine for any air obstruction. The sensor will reset automatically when the sensor and electric motor have cooled sufficiently. The motor can then be re-started.

CLEANING OR REPLACING INLET FILTER

1. Remove the dust bag.
2. Snap the filter retainer from its fitting.
3. Remove the filter and clean by shaking or vacuuming.

Note: Replace the filter if worn or not cleanable.

4. Replace filter in the retainer and snap it into place.

5. Replace dust bag.

CAUTION: Do not operate the vacuum without the inlet filter in place.

REPLACING BRUSH

1. Remove the screw holding the brush access plate and remove plate.
2. Grasp the brush strip and slide it out of the brush extension.
3. Replace the strip with a new one and slide it into place.
4. Replace the access plate and install the screw.

STORAGE INFORMATION

The machine may be stored in any dry area. The machine may be parked either in a horizontal or an upright position.

WARRANTY

Sandia warrants to the original purchaser that products **manufactured by Sandia are free** from defects of work-manship and material, provided such goods are installed, operated and maintained **in accordance with Sandia written** manuals or other instructions.

In case you, as our customer, encounter any trouble with your **machine contact your Sandia representative** who will be obliged to be of service to you and will take care of the warranty settlement.

Sandia representatives are able to service you with detailed warranty conditions as well as periodic maintenance contracts.

written approval of Sandia and use
NOTE: Alterations and charges made to the machine without

of unapproved spare parts will not be covered by warranty.

SPECIFICATIONS

Voltage	115V	
Motor	1.3Hp	
Material	ABS	
Suction Power	74.8"	
Air Speed	99.6CFM	
Sound Level	67 dB	
Weight(product)	19.8lbs	
Height	47.6"	
Cable Length	50 ft	
Capacity(paper bag)	6.3 quarts	
Warranty	2 YEAR	

TROUBLE SHOOTING

Vacuum motor is off.	Machine unplugged.	Plug the machine in.
	Switch in off position.	Switch on machine.
	Sensor temperature too high.	Check for air obstruction. Let the motor cool down.
	Faulty switch.	Replace switch. Request service call.
Brush motor is off.	Machine unplugged.	Plug the machine in.
	Brush switch off.	Switch brush on.
	Wand not installed correctly.	Re-install wand.
RED LIGHT ON.	Brush motor obstructed.	Unplug machine and inspect for obstruction.
		Request service call.
RED & GREEN LIGHT ON.	Brush drive belt broken.	Request service call.
Full bag indicator flashes.	Dust bag full.	Replace dust bag.
	Hose and wand blocked.	Inspect for obstruction.
	Power brush inlet blocked.	Inspect for obstruction.
	Inlet filter blocked.	Clean or replace inlet filter.
	Deflector port sealing in top of housing.	Check for free movement.
Low suction.	Dust bag full.	Replace bag.
	Full bag indicator flashes.	See Full Bag Indicator Flashes.
	Wand not installed correctly.	Re-install wand.
Poor pick up.	Brush not adjusted correctly.	Adjust brush height knob to conform to carpet thickness (pile).
		Request service call.
	Brush worn.	Replace brush.

EXPLODED VIEWS

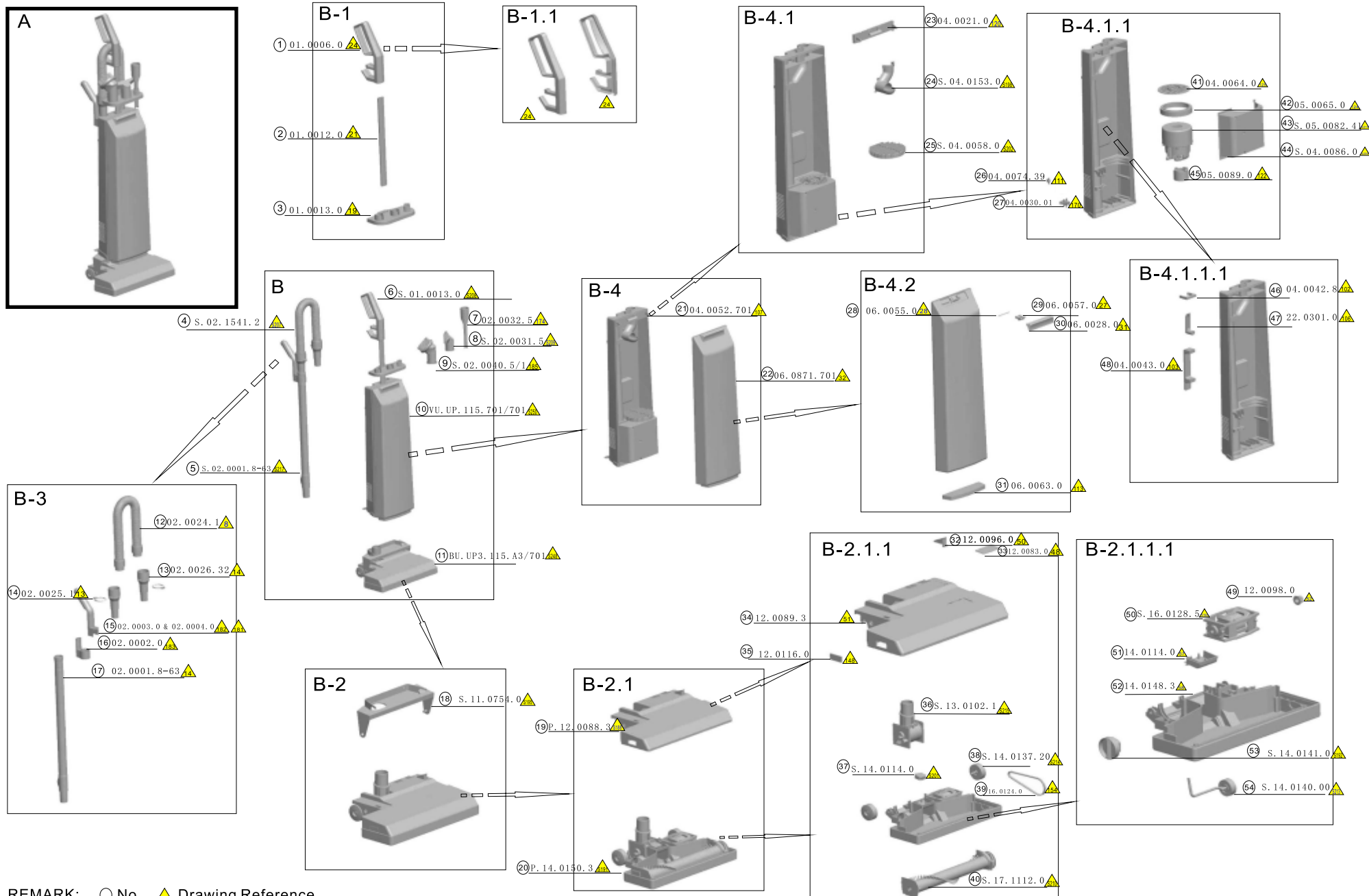

REMARK: ○ No. ▲ Drawing Reference



EXPLODED VIEWS ITEM LIST

No.	ART CODE	DESCRIPTION	DRAWING REFERENCE	QTY.
1.	01.0006.0	HANDLE LEFT AND RIGHT BLACK	24	1
2.	01.0012.0	TUBE OVAL ALUMINIUM	21	1
3.	01.0013.0	ACCESSORY HOLDER ON HANDLE	19	1
4.	S.02.1541.2	HOSE BLA 0.5MTR 32MM (02.0026.32+02.0036.32)	S207	1
5.	S.02.0001.8-63	WAND ASSEMBLY BLACK WITH GRIP	S217	1
6.	S.01.0013.0	HANDLE ASSEMBLY UP BLACK + HOLDER	S208	1
7.	02.0032.5	CREVICE TOOL 32MM	174	1
8.	S.02.0031.5	UPHOLSTERY TOOL 32MM + BRISTLE	S209	1
9.	S.02.0040.5/1	PLUMEAU ROUND 32MM NATUAL HAIR + BRITAL	185	1
10.	VU.UP.115.701/701	VACUUM UNIT UP 115V BLUE FRONT/BLUE BACK	S250	1
11.	BU.UP3.115.A3/701	BRUSH UNIT UP350 115V GREY/BLUE BUMPER	S248	1
12.	02.0024.1	HOSE STRETCH 50CM 32MM BLACK	8	1
13.	02.0026.32	HOSE CUFF 32 MM BLACK	14	2
14.	02.0025.1	HOSE CLIP WITH LIP BLACK	13	2
15.	02.0003.0&02.0004.0	HANDLE WAND	182&181	1+1
16.	02.0002.0	CONNECTOR FOR BRACKET HANDLE WAND	183	1
17.	02.0001.8-63	TELESCOPIC WAND 32MM ALU, LENGTH 63CM	14	1
18.	S.11.0754.0	BRACKET	S195	1
19.	P.12.0088.3	BRUSH COVER ASSEMBLY UP350 GREY	S188	1
20.	P.14.0150.3	BRUSH HOUSING ASSEMBLY UP350 GREY	S191	1
21.	04.0052.701	REAR BODY BLUE	107	1
22.	06.0871.701	FRONT DOOR BLUE	32	1
23.	04.0021.0	ELECTRIC COVER	120	1
24.	S.04.0153.0	PAPER BAG MOUNT	S198	1
25.	S.04.0058.0	DUST HOLDER + FILTER	S202	1
26.	04.0074.39	SWITCH ACTUATOR GREY	111	1
27.	04.0030.01	CONNECTION BRACKET 1P	170	1
28.	06.0055.0	SHAFT LOCKER COVER	28	1
29.	06.0057.0	DOOR LOCKER	27	1
30.	06.0028.0	DOOR OPENER BLACK	31	1
31.	06.0063.0	BUMP CELRUBBER EPDM BLACK ZKL	113	1
32.	12.0096.0	LATCH BREAK	50	1
33.	12.0083.0	LED COVER	48	1
34.	12.0089.3	BRUSH COVER UP350 GREY	51	1
35.	12.0116.0	BRUSH STRIP ACCES	148	1
36.	S.13.0102.1	SWIVEL NECK ASSEMBLY 32 MM	S215	1

REF.	ARTICLE	DESCRIPTION	DRAWING REFERENCE	QTY.
37.	S.14.0114.0	SWITCH HOUSING WITH FELT	S201	1
38.	S.14.0137.20	REAR CASTOR ON SHAFT W/T BEARING	S214	2
39.	16.0124.0	TOOTH BELT 130 XL 031	154	1
40.	S.17.1112.0	ROLLER ASSEMBLY UP350 W/STRIP	S210	1
41.	04.0064.0	MOTOR GRILL	125	1
42.	05.0065.0	TOP RUBBER MOTOR	124	1
43.	S.05.0082.41	MOTOR COMPLETE 1000W 120V W/W	S218	1
44.	S.04.0086.0	MOTOR HOUSING	S206	1
45.	05.0089.0	MOUNTING BLOCK MOTOR	122	1
46.	04.0042.8	WAND LOCKER YELLOW	102	1
47.	22.0301.0	CABLE HOOK EXTERNAL BLACK NEW	106	1
48.	04.0043.0	REAR BODY HANDLE	103	1
49.	12.0098.0	BEARING BUS LONG	52	1
50.	S.16.0128.5	BRUSH MOTOR ASSEMBLY 115V 175W	S190	1
51.	14.0114.0	SWITCH HOUSING W/O FELT	57	1
52.	14.0148.3	BRUSH HOUSING UP350 GREY	58	1
53.	S.14.0141.0	FRONT CASTOR ADJUSTMENT BUTTON	S192	1
54.	S.14.0140.00	FRONT CASTOR UP350 ON SHAFT W/T BEARING	S213	1

FREQUENTLY USED PARTS

Part Number	Description	DRAWING REFERENCE	QTY.
1.	K.1.02.0001.8-63 KIT TELESCOPIC WAND 32MM ALU, LENGTH 63CM [1PIECE]	S217	1
2.	K.02.0032.5 CREVICE TOOL 32MM	174	1
3.	K.10.02.0150.0 KIT PAPER BAG S/F UP350/460 [10 PIECES]	176	10
4.	K.100.02.0150.0 KIT PAPER BAG S/F UP350/460 [100PIECE]	176	100
5.	K.10.02.0150.5 KIT HEPA BAG S/F UP350/460 10PIECES	176	10
6.	K.1.03.0026.200 KIT CABLE USA 3P/18AWG-RED-15MTR-S.C. [1 PIECE]	175	1
7.	S.04.0009.30 LIGHTED SWITH WITH WIRES	66	1
8.	K.1.P.04.0052.701 KIT REAR BODY UP BLUE [1 PIECE]	107	1
9.	K.1.P.06.0871.701 KIT FRONT DOOR UP BLUE [1 PIECE]	32	1
10.	K.1.P.12.0088.3 KIT BRUSH COVER ASSEMBLY UP350 GREY [1 PIECE]	S188	1
11.	K.1.P.14.0150.3 KIT BRUSH HOUSING ASSEMBLY UP350 GREY [1 PIECE]	S191	1
12.	K.1.S.01.0013.0 KIT HANDLE ASSEMBLY UP BLACK + HOLDER [1 PIECE]	19	1
13.	K.1.S.02.0031.5 KIT UPHOLSTERY TOOL 32MM + BRISTLE [1 PIECE]	S209	1
14.	K.1.S.02.1541.2 KIT HOSE BLA 0.5MTR 32MM (02.0026.32+02.0036.32)	S207	1
15.	K.1.S.04.0058.0 KIT DUST HOLDER + FILTER [1 PIECE]	S202	1

Part Number	Description	DRAWING REFERENCE	QTY.
16.	K.1.S.05.0082.41 KIT MOTOR COMPLETE 1000W 120V W/W [1 PIECE]	S218	1
17.	K.1.S.16.0128.5 KIT BRUSH MOTOR ASSEMBLY 115V 175W [1 PIECE]	S190	1
18.	K.1.S.17.1112.0 KIT ROLLER ASSEMBLY UP350 W/STRIP [1 PIECE]	S210	1
19.	K.10.17.0117.0 KIT BRUSH STRIP UP350 BLACK [10 PIECES]	70	10
20.	K.16.0130.5 ELECTRON.BOARD CSA 120 V. 3.0A	159	1
21.	K.5.S.04.0058.0 KIT DUST HOLDER + FILTER [5 PIECES]	S202	5
22.	P.04.0052.701 REAR BODY ASSEMBLY BLUE	S205	1
23.	P.06.0871.701 FRONT DOOR ASSEMBLY BLUE	S203	1
24.	P.12.0088.3 BRUSH COVER ASSEMBLY UP350 GREY	S188	1
25.	P.14.0150.3 BRUSH HOUSING ASSEMBLY UP350 GREY	S191	1
26.	S.01.0013.0 HANDLE ASSEMBLY UP BLACK + HOLDER	S208	1
27.	S.02.0031.5 UPHOLSTERY TOOL 32MM + BRISTLE	S209	1
28.	S.04.0058.0 DUST HOLDER + FILTER	S202	1
29.	S.04.0086.0 MOTOR HOUSING	S206	1
30.	S.05.0082.41 MOTOR COMPLETE 1000W 120V W/W	S218	1
31.	S.16.0128.5 BRUSH MOTOR ASSEMBLY 115V 175W	S190	1
32.	S.17.1112.0 ROLLER ASSEMBLY UP350 W/STRIP	S210	1

