

PORTABLE ELECTRIC SPRAYER 4.5L



Product Information:

Name: Portable Sprayer
 Rated Power: 1400W
 Capacity of the Kit: 4.5 Lit
 Spraying range in static wind: 5-10 meters
 Spraying Rate: 150-260 ml/Min(adjustable)
 Particle size: 10-150 μ m (adjustable)
 Wire Length: 5 meters
 Size: 54*21.5*38cm
 Gross Weight: 3.7 KG
 Material: PP corrosion resistant plastic

Our ultra-low capacity nebulizer can be widely used in disinfection, sanification and other spraying work. This product has many advantages such as easy handling and lightness in use, accurate orientation, long range, spraying rate and drop diameter fine adjustment (in terms of flow rate and spraying).

Operation Instruction:

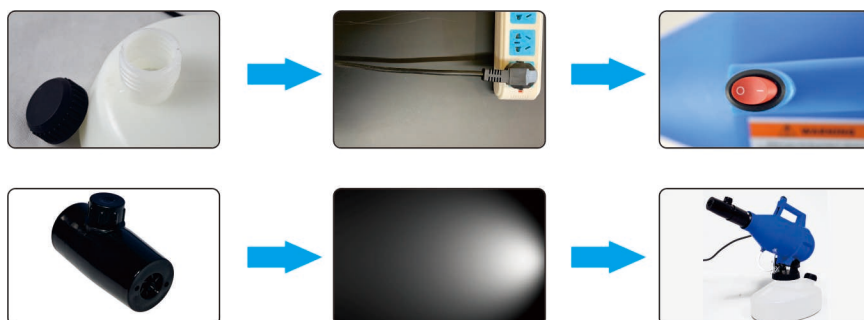

1. Add potion: Open the lid of the kettle and add proper potion, then add water according to proportion, then cover the lid and start the second step (It must be sealed, with gasket before delivery)
2. Connect power supply: Connect the power supply. Before connecting the power supply, it is necessary to check whether there is a leakage device. It is strictly prohibited to work without leakage protection device, in case of electric shock.
3. Turn on the switch: Turn on the switch. The signal **I** shows working state, the **O** shows off.

4. Adjust the flow switch: Before delivery, the flow switch should be set into the largest flow state and the user could adjust the spraying amount according to his needs.

5. Carry out the spraying operation: During the spraying operation, the walking speed should be stable, and the sprinkler cannot swing arbitrarily right or left, up or down, in case of spraying too much or too little on the crops, which will affect the effect even to harm the crops. The operator should always pay attention to the rotating speed of the machine and the gear plate. If the rotating speed reduces, he should stop spraying immediately, clean the nozzle, inspect and maintain. When spraying, according to the wind speed and direction to adjust the spraying direction. Stop spraying when the wind is strong. Operators must wear work clothes, masks, goggles, gloves and hats.

Protection devices :

The operator must wear appropriate individual safety devices (mask, goggles, gloves, overalls, boots).



Notes:

The operation time should be less than 20 minutes.

The operator must pay attention to cleaning the nozzle, to avoid motor problems.

After the operation is finished, the left potion should be poured out, then adding cleaning spray for 2-3 minutes.

The sprayer should be placed away from children.

While spraying, it is prohibited to spray to human and animal directly.

Common faults and solutions:

The nebulizer does not start: check that the cap is tightly closed; check that the motor is running (the button must be positioned on the symbol ); check that it is well connected to the electricity network; check that the flow regulator and / or nozzle are not blocked and / or clogged.