

## EP-3075

*Floor Mount with Cutter for Steel or Poly Strapping*

### *loading instructions*

IT IS THE RESPONSIBILITY OF THE CUSTOMER TO ENSURE THAT  
ALL OPERATORS AND SERVICE PERSONNEL HAVE FULLY READ  
AND UNDERSTOOD THIS DOCUMENT

**READ ALL INSTRUCTIONS BEFORE OPERATING TOOL.  
FAILURE TO FOLLOW ANY OF THESE GUIDELINES COULD  
RESULT IN SERIOUS OR FATAL INJURY**



P (847) 735-8105 | F (847) 735-8297  
sales@encorepack.com | www.encorepack.com



201 Park Avenue, Lake Villa, IL 60046  
P.O. Box 595, Winnetka, IL 60093



## IMPORTANT



PLEASE READ PRIOR TO USAGE

To ensure operator safety, it is important that all personnel use proper safety and handling procedures. This safety booklet is designed to educate operators on the safe use of the EP-3075 Floor Mount with Cutter for Steel or Poly Strapping. All personnel must read and understand this booklet prior to using this product. Failure to follow any of the recommendations in this pamphlet can result in serious injury or death.

### READ PRODUCT SAFETY LABELS

- Read and understand all safety labels on the tool
- Replace all damaged or missing labels

### READ THE INSTRUCTIONS

Before operating this tool, read, and understand all safety, operation, and maintenance information provided in the manual which is packaged with the tool. If you do not have a manual or need extra copies, please contact your Sales Representative. Tool must be inspected for wear and tear on a daily basis with proper daily documentation.



Terms & Conditions are found on our website: <https://www.encorepack.com/legal.php>

Please read our Terms & Conditions carefully prior to using or obtaining any materials, information products or services of **Encore Packaging LLC**, an Illinois limited liability company with a place of business at **201 Park Avenue, Lake Villa, IL 60046**.

P (847) 735-8105 | F (847) 735-8297  
sales@encorepack.com | www.encorepack.com



201 Park Avenue, Lake Villa, IL 60046  
P.O. Box 595, Winnetka, IL 60093

## USAGE INSTRUCTIONS

### Step 1

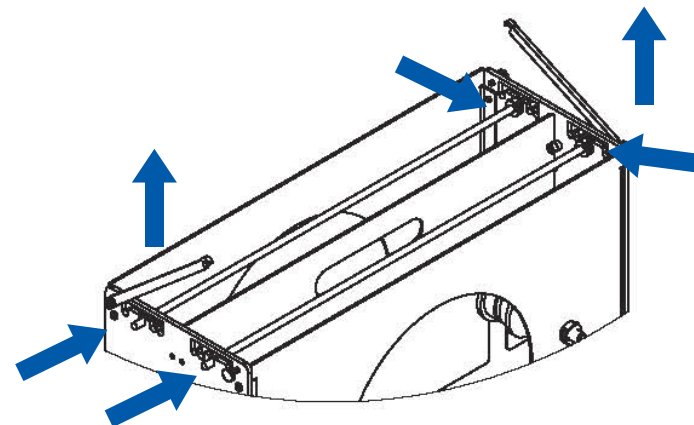

1) Lift bar lock to release retaining rod and move rods into designated notches, depending on the width of the coil roll. Once rods are adjusted, lock them in place by lowering bar lock.

### Step 2

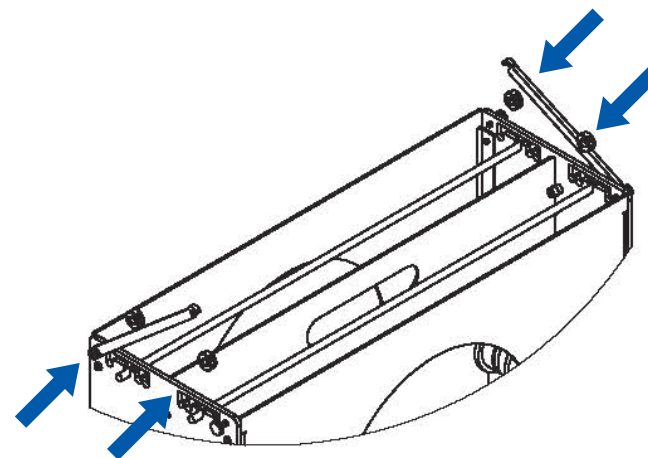

2) Loosen shaft collars on both sides of the polyurethane flanges, using a 9/64 Allen wrench/key. Slide polyurethane flanges to the size coil roll width and hold in place by re-tightening the shaft collars on either side.

### Step 3

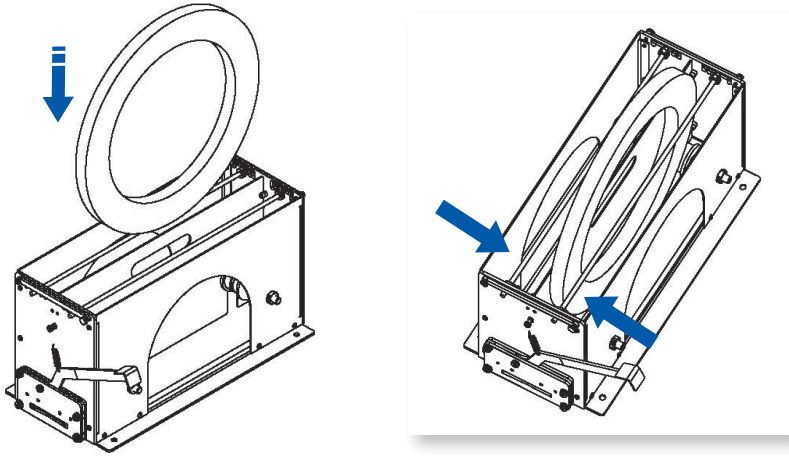

3) Lower coil roll between the retaining rod and center plate so that it sits on top of the polyurethane flanges.

### Step 4

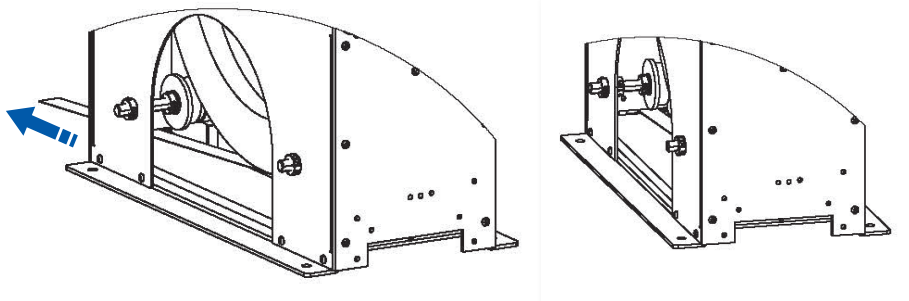

4) Inside the dispenser, slide the end of the coil through the bottom slit in the cutter plate until it is hanging outside the dispenser.

### Step 5

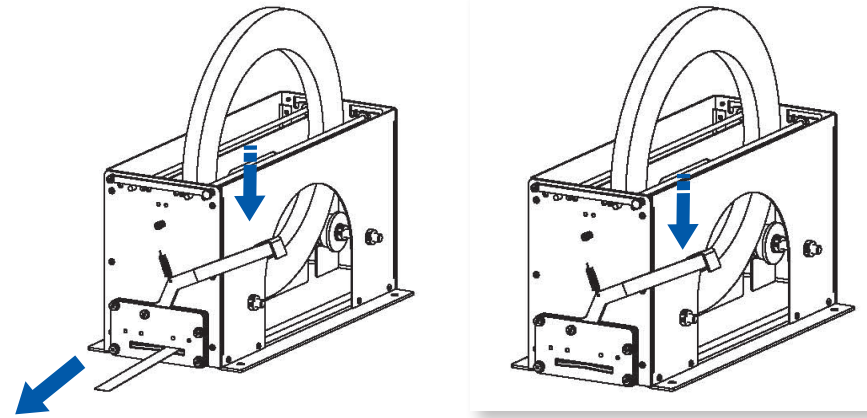

5) From outside of the dispenser, pull coil to desired length, and cut by pushing down on the cutter's handle.

### WARNING

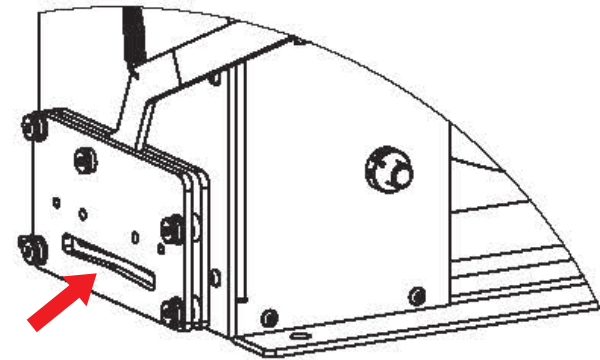

**WARNING: GUILLOTINE BLADE INSIDE CUTTER IS SHARP.  
DO NOT PLACE FINGERS UNDER THE GUILLOTINE BLADE.**

**EP-3075 (Cut Off Dispenser)  
PART LIST**

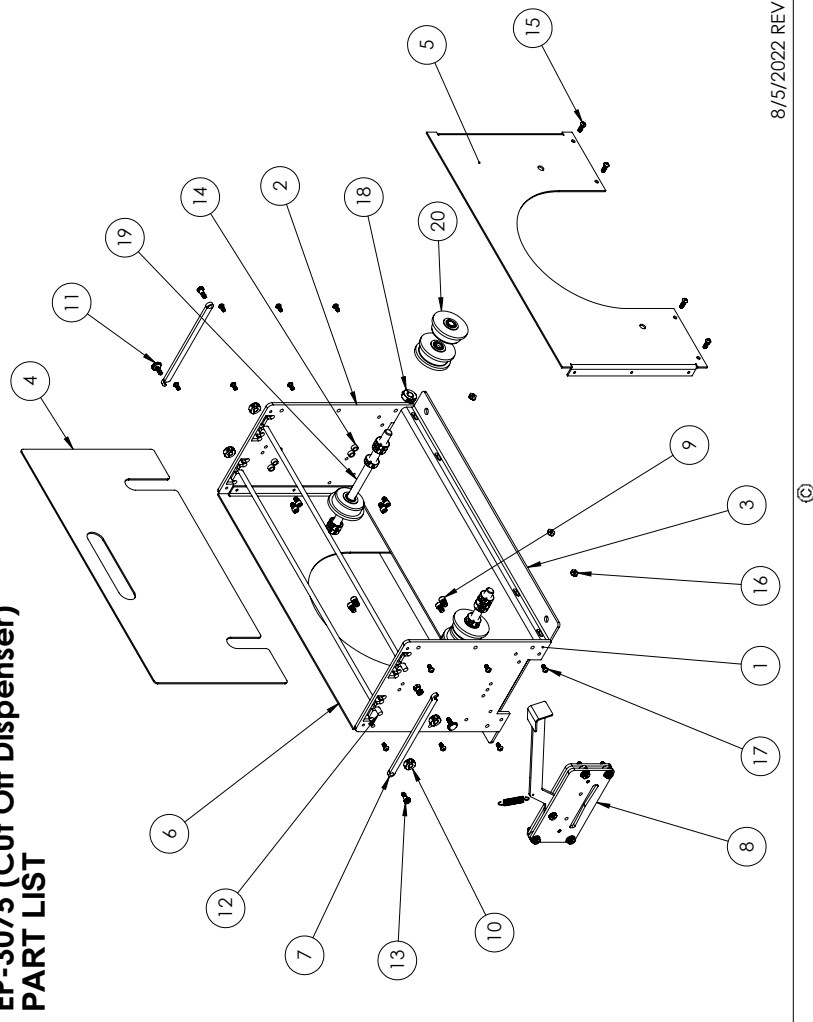

8/5/2022 REV D

ITEM NO.	PART NUMBER	Description	QTY.
1	E3075-01	Main Plate Weldment	1
2	E3075-01-A	Main Plate	1
3	E3075-02	Base	1
4	E3075-03	Center Plate	1
5	E3075-04-R	Right Side Plate	1
6	E3075-04-L	Left Side Plate	1
7	E3075-05	Bar Lock	2
8	E3075-06	Cutter Assembly	1
9	E3075-07	Socket Head Bolt	8
10	E3075-08	Shaft Collar	4
11	E3075-09	Thumb Screw	2
12	E3075-10	Retaining Rod	2
13	E3075-11	Shoulder Bolt	3
14	E3075-12	Spacer	8
15	E3075-13	Socket Cap Screw	8
16	E1225-06-B	1/4" Nylock Hex Nut	8
17	E1620-33	Socket Cap Screw	12
18	E3200-04-H	Shaft Collar	16
19	E6700-09	D-Shaft	2
20	E6700-11	Roller Assembly	8



P (847) 735-8105 | F (847) 735-8297  
sales@encorepack.com | www.encorepack.com



201 Park Avenue, Lake Villa, IL 60046  
P.O. Box 595, Winnetka, IL 60093