

EP-3003

Core Corrector for 16" Cores

usage instructions

IT IS THE RESPONSIBILITY OF THE CUSTOMER TO ENSURE THAT
ALL OPERATORS AND SERVICE PERSONNEL HAVE FULLY READ
AND UNDERSTOOD THIS DOCUMENT

**READ ALL INSTRUCTIONS BEFORE OPERATING TOOL.
FAILURE TO FOLLOW ANY OF THESE GUIDELINES COULD
RESULT IN SERIOUS OR FATAL INJURY**



P (847) 735-8105 | F (847) 735-8297
sales@encorepack.com | www.encorepack.com



201 Park Avenue, Lake Villa, IL 60046
P.O. Box 595, Winnetka, IL 60093



IMPORTANT



PLEASE READ PRIOR TO USAGE

To ensure operator safety, it is important that all personnel use proper safety and handling procedures. This safety booklet is designed to educate operators on the safe use of the EP-3003 Core Corrector for 16" Cores. All personnel must read and understand this booklet prior to using this product. Failure to follow any of the recommendations in this pamphlet can result in serious injury or death.

READ PRODUCT SAFETY LABELS

- Read and understand all safety labels on the tool
- Replace all damaged or missing labels

READ THE INSTRUCTIONS

Before operating this tool, read, and understand all safety, operation, and maintenance information provided in the manual which is packaged with the tool. If you do not have a manual or need extra copies, please contact your Sales Representative. Tool must be inspected for wear and tear on a daily basis with proper daily documentation.

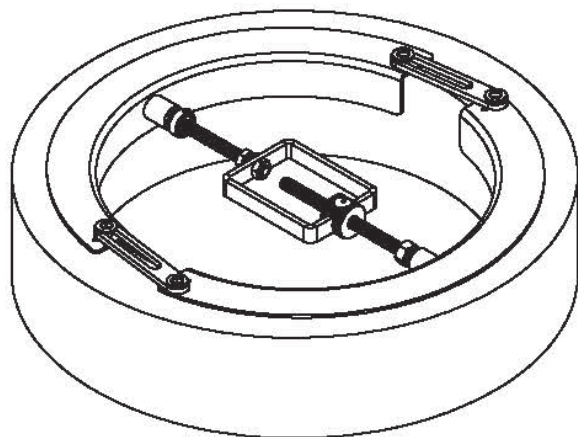

Terms & Conditions are found on our website: <https://www.encorepack.com/legal.php>

Please read our Terms & Conditions carefully prior to using or obtaining any materials, information products or services of **Encore Packaging LLC**, an Illinois limited liability company with a place of business at **201 Park Avenue, Lake Villa, IL 60046**.

P (847) 735-8105 | F (847) 735-8297  201 Park Avenue, Lake Villa, IL 60046
sales@encorepack.com | www.encorepack.com P.O. Box 595, Winnetka, IL 60093

USAGE INSTRUCTIONS

Step 1

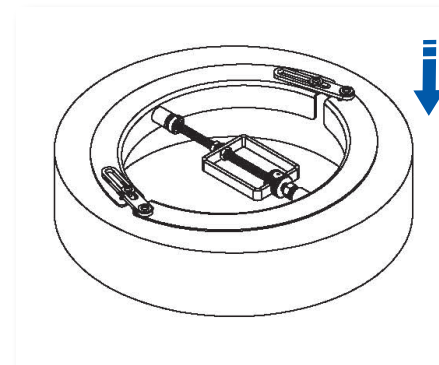
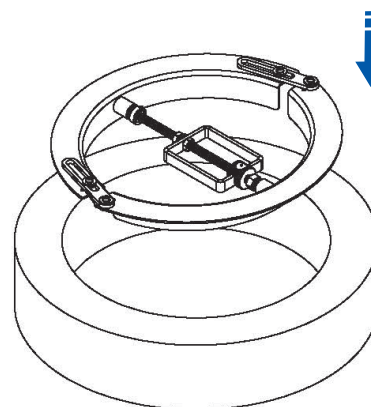

1) Place the EP-3003 within the diameter of the roll so that the forming arms are against the side of the roll.

Step 2

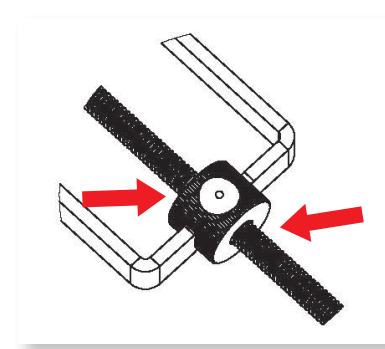
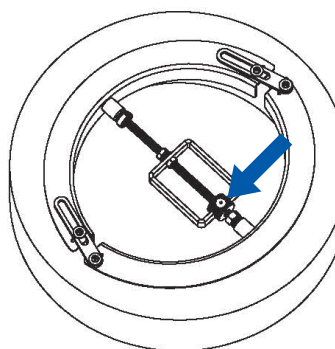

2) Once the forming arms are flat against the roll, press the quick release to extend the forming arm as far as possible to maximize the tension holding the roll.

Make sure to keep your fingers and hands clear of the inside of the adjustment handle and ends where the threaded rod moves when adjusting the size, since **these are pinching points**.

Step 3

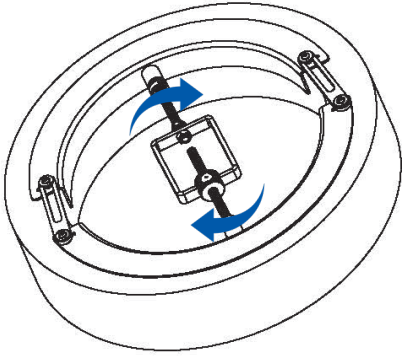

3) After being fully extended, rotate the adjustment handle until the tension is secure.

Step 4

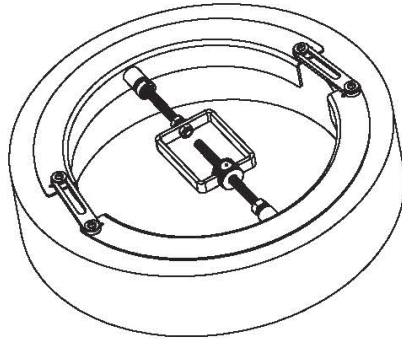

4) The core of the roll is now corrected and portable.

Step 5

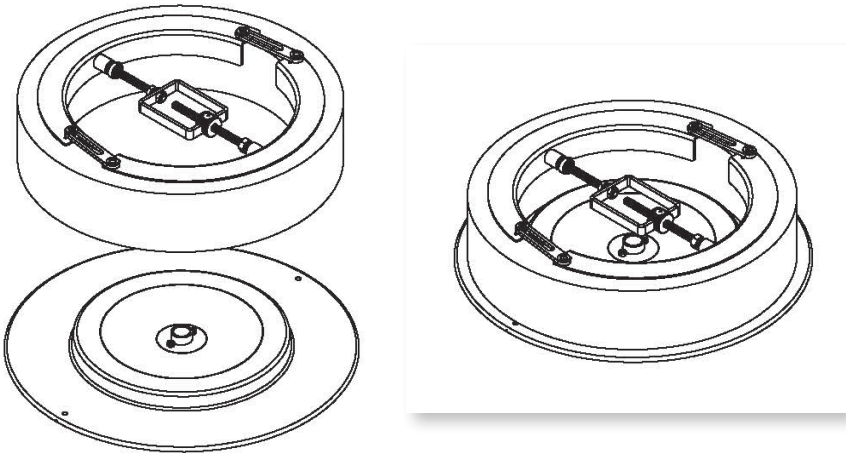

5) Load roll onto flat disk using the EP-3003.

Step 6

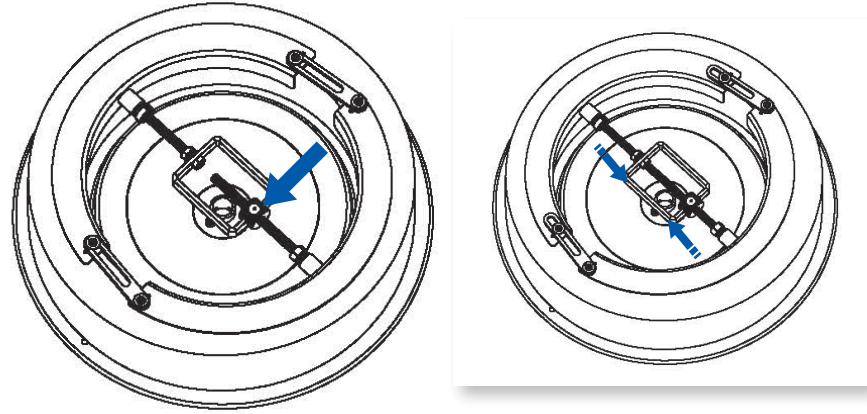

6) Once on top of the disk, press the quick release button and pull the forming arm inward to release the tension from the roll. Make sure to keep fingers and hands clear of the inside of the adjustment handle and ends where the threaded rod moved, since these are pinching points.

Step 7

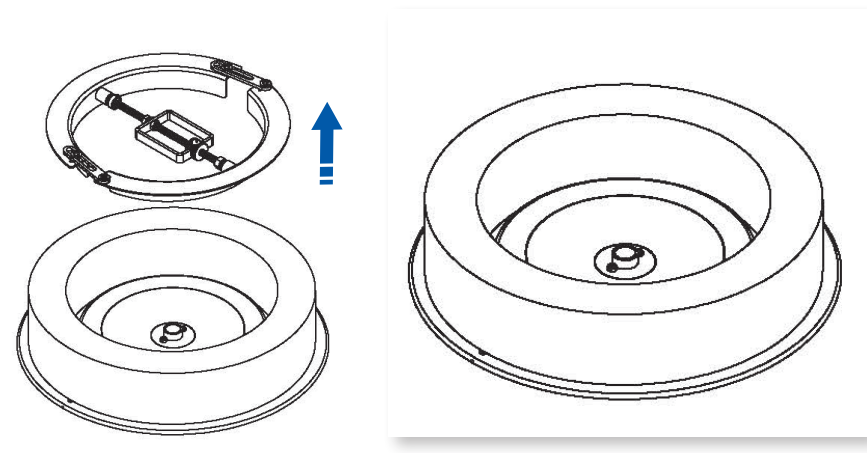

7) Finally, pull the EP-3003 out of the core of the roll as the roll now sits secured on the disk.

EP-3003

PART LIST

ITEM NO.	PART NUMBER	DESCRIPTION	QTY.
1	E3003-01	Forming Arm	2
2	E3003-07	Washer	4
3	E3003-02	Adjustment Handle	1
4	E3003-03	SHCS, 1/2-13 x 6	1
5	E3003-06	Link	2
6	E3003-10	Standoff	4
7	E3003-09	BHCS, 1/4-28 x 5/8	4
8	E800-06-F	Flat Washer	3
9	E800-06-G	Thrust Bearing	1
10	E830-05	Hex Nut	2
11	E6700-42	Lock Washer	2
12	E3003-04	Threaded Shaft Collar	1
13	E3003-08	Lock Washer	4
14	E3003-05	Hex Nut	1
15	E3003-11	Acme Screw	1
16	E3003-02-C	Pin	1
17	E3003-02-D	Spring	1

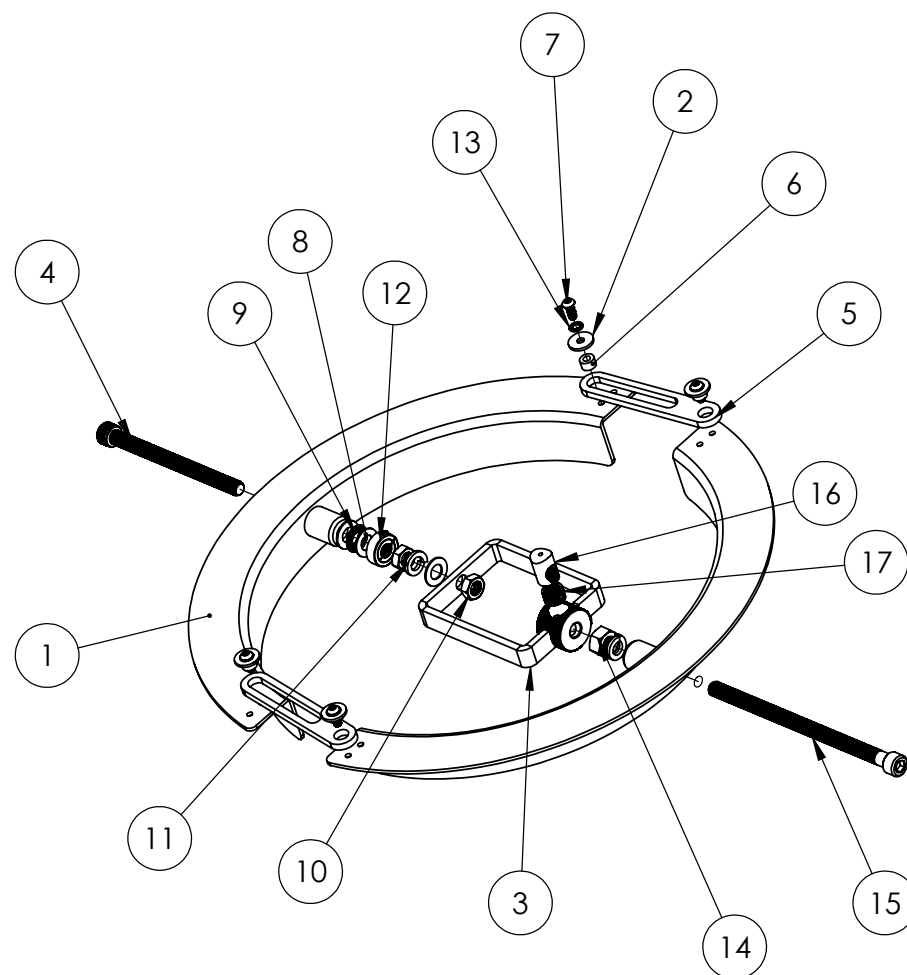

07/12/24 REV. F



P (847) 735-8105 | F (847) 735-8297
sales@encorepack.com | www.encorepack.com



201 Park Avenue, Lake Villa, IL 60046
P.O. Box 595, Winnetka, IL 60093