

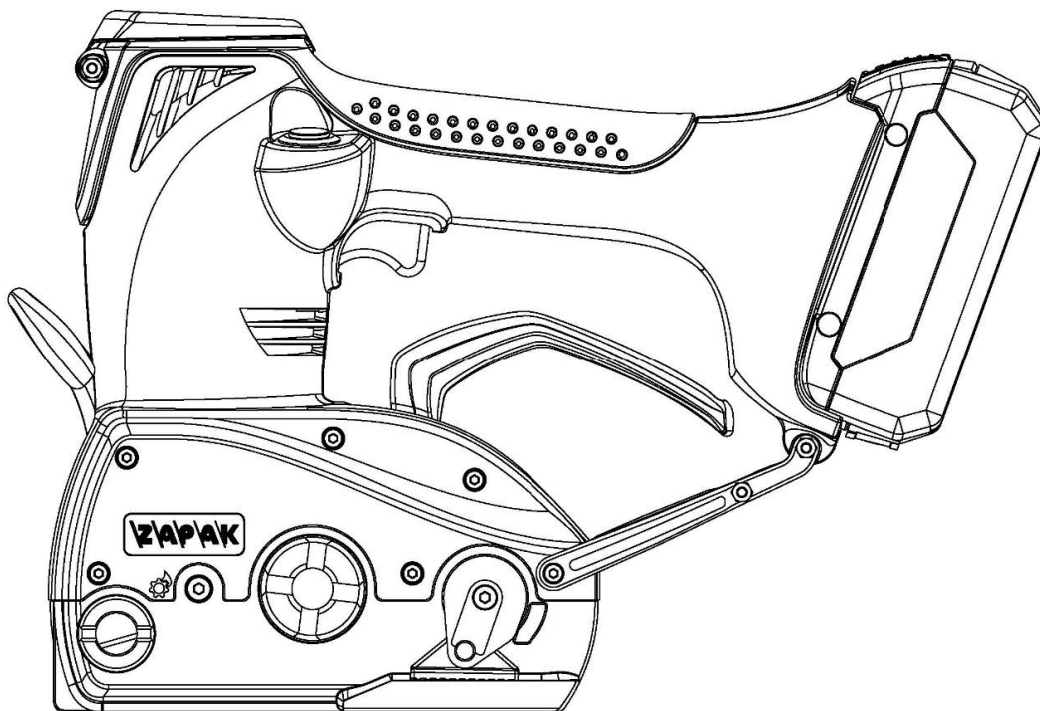

# USAGE INSTRUCTIONS

## EP-1345

**Battery Powered Cord Strap  
Tensioner with Cutter for Cord  
Strapping**



CE RoHS UN38.3 ©

*Edition 08/27/2024*

# ATTENTION (READ USER MANUAL BEFORE USE)

ENCORE PACKAGING MODEL: EP-1345

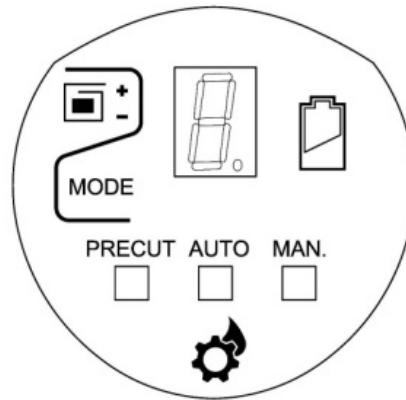

**NEW CONTROL PANEL**  
*(VERSION B)*

## PLEASE READ THE FOLLOWING:

1. Must complete tensioning first before cutting.
2. Cutting is only **ALLOWED** under tension mode setting “AUTO” or “MAN” on Control Panel.
3. “PRECUT” mode is designed particularly for PRECUT straps only.
4. Cutting is **NOT ALLOWED** under “PRECUT” mode.
5. “PRECUT” mode is locked (function off) upon shipment. To unlock (function on), follow User Manual - Chapter 4.3 “Operation Instructions” - “MODE”.
6. Do not cut when straps are loose or not tightened.
7. This tool is not intended to use as scissors. Do not use the operation lever to cut strap only.
8. To cut, you must install Cutter Lever and Cutter. When cutting, push the Cutting Lever gently. Do not overly press the Cutter Lever with strong force.
9. Note the Lubricant Refill. Must use specified Lubricant (32XX-10). Follow Use Manual - Chapter 4.3 “Operation Instructions” - “Lubricant Refill LED”.

ANY VIOLATIONS TO THE ABOVE INSTRUCTIONS MAY SHORTEN SERVICE LIFE OF THE TOOL. ANY DAMAGES CAUSED BY IMPROPER HANDLING OR OPERATION OF TOOL ARE NOT COVERED UNDER WARRANTY.

# INDEX

	PAGE
1. <u>INTRODUCTION OF ENCORE EP-1345</u>	1
1.1 - DESCRIPTION OF MAJOR COMPONENTS	1
2. <u>MODEL/VERSION NUMBERS &amp; SPECIFICATIONS</u>	2
3. <u>SAFETY INSTRUCTION</u>	4
4. <u>SETTING BEFORE OPERATION</u>	10
4.1 - INTRODUCTION OF OPERATION COMPONENTS	10
4.2 - LED LIGHT INDICATORS ON CONTROL PANEL	10
4.3 - OPERATION INSTRUCTIONS OF CONTROL PANEL	11
4.3.1 - CONTROL PANEL COVER	14
4.4 - CHARGING BATTERY	15
4.5 - BATTERY INSTALLATION AND REMOVAL	16
4.6 - SETTING TENSION AND SEALING TIME	17
4.6.1 - TENSION ADJUSTMENT	17
4.6.2 - SELECTING TENSION MODE	19
4.7 INSTALLATION OF HOUSING BRACKET	19
5. <u>OPERATION</u>	20
5.1 - STRAP AROUND THE ARTICLE	20
5.2 - FEEDING LOWER STRAP BENEATH GRIPPER FOOT	21
5.3 - FEEDING UPPER STRAP INTO WINDLASS	21
5.3.1 - WHEN CUTTING IS NOT NECESSARY (APPLICABLE TO PRECUT STRAP ONLY)	21
5.3.2 - WHEN CUTTING IS NECESSARY (APPLICABLE TO COMPOSITE AND WOVEN STRAP)	22
5.3.2.1 - INSTALLATION OF CUTTER & CUTTER SLEEVE	23
5.3.2.2 - INSTALLATION OF CUTTER LEVER	23
5.4 - TENSIONING AND REVERSING (WINDING BACKWARD) ON THE STRAP	24
5.5 - REMOVE THE TOOL FROM STRAPPING	25
6. <u>MAINTENANCE OF GRIPPER FOOT</u>	26
7. <u>MAINTENANCE OF LUBRICANT REFILL</u>	26
8. <u>MAINTENANCE AND SERVICE</u>	27
9. <u>CHANGING WEARING PARTS</u>	27
10. <u>OPTIONAL ACCESSORIES</u>	28
10.1 - LI-ION BATTERY	28
10.2 - LI-ION BATTERY CHARGER	28
10.3 - NOSE PIECE (ROUND PUSHER)	29
10.4 - HANGER	29
11. <u>WARRANTY</u>	30
11.1 - INSPECTION AND PROCESS LOGS	30
12. <u>LIABILITY</u>	30
13. <u>COPYRIGHT NOTICE</u>	30
14. <u>LIMITED WARRANTY</u>	31
15. <u>PARTS LIST</u>	33

# 1. INTRODUCTION OF ENCORE EP-1345

Encore EP-1345 is a high-tension Battery Powered Cord Strap Tensioner, applicable to Composite and Woven cord straps. It is powered by single D/C BRUSH LESS motor to drive the mechanism for tensioning and quick reverse after tensioning.

## 1.1 DESCRIPTION OF MAJOR COMPONENTS

Components as Figure 1 shown:

1. Cutting Lever
2. Control Panel
3. Handle
4. Battery Release Button
5. Impact-resistant Bumper
6. Control Panel Cover
7. Brush less Motor
8. Reverse Button
9. Tension Trigger
10. Li-Ion Battery
11. Cutter
12. Cutter Sleeve
13. Lubricant Filling Hole
14. Windlass
15. Gripper Foot
16. Gripper Foot Shaft
17. Operation Lever
18. Housing Bracket

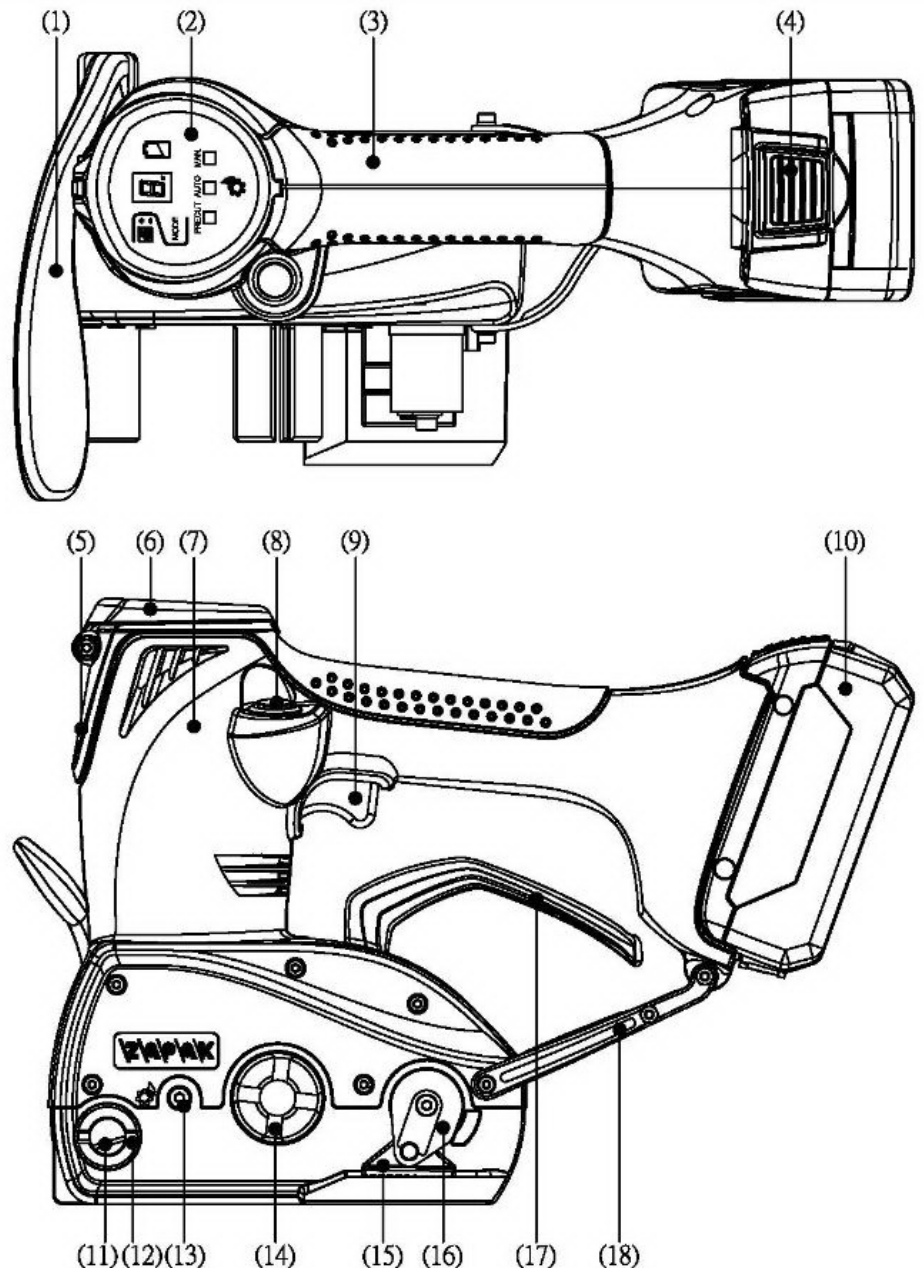

FIGURE 1. EP-1345 MAJOR COMPONENTS DESCRIPTION

## 2. MODEL/VERSION NUMBERS & SPECIFICATIONS

Model/Version	Battery Charger Voltage	Fits Cord Strap	Strap Width		Strap Thickness		Tension Range
			<i>Inch</i>	<i>Mm</i>	<i>Inch</i>	<i>Mm</i>	
EP-1345	100V a.c.	Composite	¾ - 1 ¼	19 - 32	0.033 - 0.065	0.85 - 1.65	661 - 1763 lbs 300 - 800 kgs
	115V a.c.						
	230V a.c.	Woven					
	240V a.c.						

\*Tension performance varies based on strap specification, quality, setting and remaining battery power. Pre-testing before operation is required.

\*Cutting is applicable to both Composite and Woven straps.

<b>A. Dimension (Tool size with battery)</b>	Length: Approx. 11.4" / 290.00 mm Width: Approx. 5.1" / 130.00 mm Height: Approx. 8" / 203.00 mm
<b>B. Weight:</b>	Tensioner: Approx. 6.60 lbs / 3.0 kgs Battery: Approx. 1.32 lbs / 0.6 kg
<b>C. Noise:</b>	Sound pressure level: 76.3dB(A) Sound power level: 87.3dB(A)
<b>D. Vibration:</b>	Hand-arm vibration: 1.5 m / sec <sup>2</sup> (uncertainty K = <2.5m / sec <sup>2</sup> )
<b>E. Tension:</b>	Tension is adjustable from: 661 lbs - 1763 lbs ± 5 % / 300 kgs – 800 kgs ± 5 %  NOTE: Tension performance varies based on strap specification, quality, setting and remaining of battery power. (Please refer to article 4.6.1 "Tension Adjustment")
<b>F. Tension Setting Range:</b>	1 - 6
<b>G. Tension Speed</b>	1.37 in / sec 35 mm / sec
<b>H. Quick Reverse</b>	Under <b>PRECUT</b> Tension Mode: Auto reverse after tensioning. Under <b>AUTO</b> Tension mode: Press reverse button to reverse after tensioning Under <b>MAN.</b> Tension mode: Press reverse button to reverse after tensioning

<b>I. Battery</b>	<ol style="list-style-type: none"> <li>1. The Lithium-Ion Battery (E1260-28-D) may fail to work when ambient temperature is lower than -10°C - 40°C (14°F - 104°F). Please use Li-Ion battery within such temperature range (E1260-28-D Li-Ion battery, 18V d.c. / 4.0Ah Li-Ion)</li> <li>2. Tensioning cycles number for a brand new &amp; fully charged battery: Approx. 350 cycles <b>Tensioning cycles number varies based on strap quality, specification, tension force and mode setting, operation habit, ambient environment, and tensioning distance. (The approx. strapping cycle number was tested on normal quality straps based on a new and fully charged Li-Ion battery, E1260-28-D).</b></li> <li>3. Life cycle: Approx. 2000 charges (based on proper charging &amp; discharging operation and working habits).</li> <li>4. Please refer to “4.4. Charging Battery” regarding usage and storage of battery.</li> <li>5. Storage temperature: 0°C - 50°C (0°C- 20°C would be better)</li> <li>6. Storage humidity: 65% ± 20%</li> <li>7. Ambient temperature: -10°C - 40°C</li> <li>8. Average ambient temperature for charge is 0°C - 45°C, charging efficiency drops if ambient temperature is above 45°C or lower than 0°C which may lead to deterioration in performance and even battery leakage.</li> </ol> <p><b>(Please refer to article 3. “SAFETY INSTRUCTION” and Safety Notes regarding environmental, recycle and safety precautions of battery.) Encore Li-Ion battery E1260-28-D complies with UN38.3 safety requirements.</b></p>
<b>J. Charger</b>	<p>For EP-1345 Encore Battery Charger (E1260-58): Charging time 30 minutes under normal condition.</p> <p><b>(Please refer to user manual of charger for detailed specification and safety precautions.)</b></p>
<b>K. Suitable Cord Straps</b>	<p>EP-1345 is suitable to work with Composite &amp; Woven material cord straps</p> <p><b>(Please refer to Section 2. “MODEL/VERSION NUMBERS &amp; SPECIFICATIONS”).</b></p>

#### Remarks:

1. Each unit is equipped with (1) EP-1345 Battery Powered Cord Strap Tensioner with Cutter for Cord Strapping, (2) E1260-28-D 18V Rechargeable Lithium-Ion Battery, (1) E1260-58 18V Rechargeable Lithium-Ion Battery Charger (with charger manual), (1) Housing bracket, (1) Cutting lever, (1) Cutter & Sleeve Assembly, (2) Lubricant Packs, and (1) Usage Instruction Guide
2. All electrical and mechanical specifications conform to the most major safety standards. Please refer to the label and packaging for detail information.
3. Plug specification of charger varies with different country / areas' request.
4. Most parts of this tensioner are made of recyclable material. Please refer to the recycle mark on each component.
5. Products and specifications subject to change without notice.

**NOTE: FAIL TO FOLLOW INSTRUCTIONS IN THIS MANUAL MAY CAUSE MALFUNCTION TO THE TOOL AND INVALIDATE THE WARRANTY.**



### 3. SAFETY INSTRUCTION

When using this strapping tool, basic safety precautions should always be followed to reduce the risk of fire, leaking batteries and personal injury including but not limited to the followings:  
Read all these instructions before operating this product and save these instructions.

**Labels on the Tool:** Please notice and follow the safety precautions listed on the security label, and manufacture label shown on tool before operation. Please notice the following position of labels on tool.

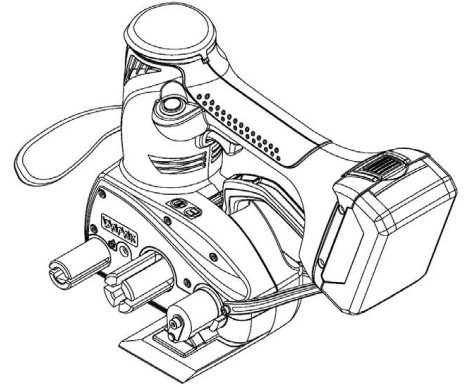

**1. Security Label:** Always wear safety glasses, ear protection and mouth mask to protect yourself from possible exhaust gas, fumes, and dust etc. during operation, failure to wear these protections may result in severe injuries.

Read all instructions carefully before operating this product.

Do not touch Windlass by hand to avoid injury during operation.

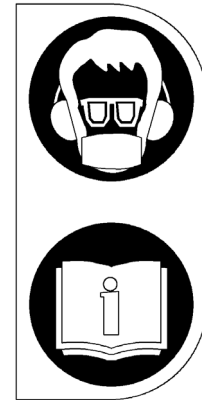

**2. Manufacturer Label:** Contains model number, serial number, country of origin and CE mark. **The EP-1345 is designed to tension strapping and should NOT be used for any other purpose.**



#### Working Environment

- Do not expose and use the tool to wet or dusty environment.
- **Do not expose and use the tool in environment with corrosive chemical fumes or liquids, which may accelerate rust damages on metal & electronic parts and invalidate your warranty.**
- Do not use the tool where is risky to cause fire or explosion or near flammable substances including but not limited to fine dusts and gas.
- Keep your working area clean. Cluttered areas and benches invite injuries.

## Operation Precautions

- Use Tool Properly: please use the tool in accordance to this user manual. Do not use the tool for any unintended purpose.
- Use authentic accessories and components recommended in this manual.
- **Improper or unauthentic accessories components / parts may damage the tool & result in a risk of personal injury & invalidate your warranty.**
- Positioning yourself and keep other personnel at a safe distance from direction of the loosened strap end when operating tool. The loosened strap end might fly and hurt the user and bystanders.
- Maintain proper footing and balance, always, when operating the tool. Do not use the tool when you are in an awkward position.
- Stay alert during operation. Watch what you are doing. Use common sense. Do not operate the tool when you are tired.
- Avoid careless starting or unintentional pulling on the Tension Trigger.
- Avoid long time idle running of motor which may cause damages on the control system and mechanical parts.
- Dress properly. Do not wear loose clothing or jewelry. They can be caught in moving parts. Rubber gloves and non-skid footwear are recommended when working outdoors. Wear protecting hair covering to contain long hair.

## Strap

- Use only recommended strap specifications in this manual. Poor quality strap or improper strap specifications reduces tensioning and causes strap scratches or slippage problem.
- Cord straps are not recommended for re-use. The tension performance will be decreased gradually and have safety concerns with the increased amount of usage
- Replace with new strap whenever strap is damaged; Please check if the strap goes through the buckle and Windlass, and then press under the Gripper Foot correctly before proceeding tensioning.

## Tensioning Precautions

- **WIRE BUCKLES CANNOT BE RE-USED.**
- When tension exceeds strap's breaking strength, strap will be split and may hurt the user and bystanders with flying strap. **Do not set or adjust tension force over the strap's breaking strength to avoid any hazards.**
- Sharp edges or corners of the objects may result in strap breakage during tensioning.
- **Please use edge protectors if the object has sharp edges or corners.** When adjusting the tension higher, please adjust it slightly and gradually if you do not have the correct strap breaking strength information.
- After tensioning is completed, please check if the buckle is securely fastened, and pull the strap by hand to make sure the strap is not loosened or broken; Otherwise, please repeat the tensioning to secure the safety in goods transportation.



## **Environmental, Recycle, Safety Precautions, and Shipping Regulations for Battery**

- Do not dispose battery in household refusal, water, or fire.
- Do not store battery together with metal objects to prevent any hazard of short circuit.
- Do not open up battery cases. Keep it in dry place.
- Never attempt to short-circuit the battery by connecting the positive (+) and negative (-) terminals.
- Remove battery from the tool when tool is not in use to prevent quick power exhaustion. This good habit will extend the life of the battery.
- Remove battery from charger as soon as the charging process is completed.
- A fully charged battery will gradually lose its power naturally in storage. Please activate the battery by a full charge every 6 months.
- When Battery Power LED on Control Panel of tool is flashing in red with continuous “beep” sound alarm, please recharge the battery.
- Use Encore Li-Ion Battery (E1260-28-D) only for EP-1345. No adapter is needed for charging Encore Li-Ion Battery E1260-28-D with Encore Battery Charger (E1260-58), Using improper charger or improper battery may result in risks of electric shock, overheat, explosion, burning or leakage of corrosive liquid from the battery and invalidate your warranty.
- If corrosive liquid contacts your body, please clean and wash it with water immediately.
- The IATA Dangerous Goods Regulations lithium battery mark must be printed – in color – directly on the outer packaging provided there is sufficient contrast between the elements of the lithium battery mark and the color of the packaging material. The size of the package so requires, the dimensions/ line thickness may be reduced to not less than 105 mm wide × 74 mm high.
- All lithium ion cells and batteries (UN 3480 only) must be shipped at a state of charge (SoC) not exceeding 30% of their rated capacity.
- Damaged or recalled batteries and battery-powered devices, are likely to create sparks or generate a dangerous evolution of heat. These batteries cannot be carried aboard an aircraft unless the damaged or recalled battery has been removed or otherwise made safe. The airline may offer further public guidance on transporting individual recalled products.

## **Safety Precautions for Charger**

- Please read and follow the safety instruction of the Encore Battery Charger (E1260-58) user manual before using charger.
- Ensure the battery is clean and dry before plugging into the charger.

## **Maintenance & Service**

- Clean the tool properly with air gun and/or dry cloth.
- **As soon as the lubricant refill LED flashes (article 4.3), refill with one tube of SPECIFIED lubricant (32XX-10) immediately, to ensure normal movements and service life of internal mechanical parts and mechanism structure. Should any damage occurred by failures of refilling lubricants or using other kinds of lubricants, your warranty will be invalid. (ENCORE provides TWO tubes of specified lubricants 32XX-10 for refills with each tool in the tool case package).**
- Good maintenance and keeping the tool clean can ensure a normal operation and a good performance of the tool.
- Please change original spare parts or mount accessories according to this user manual when

necessary. Using non-original spare parts or accessories for replacement may result in considerable danger. If any damage occurred, please send it to manufacturer's authorized dealer for repairing. **Do not repair or replace any parts by yourself, except for those self-changeable wearing parts marked with an asterisk (\*) in the "EP-1345 Wearing Parts List" indicated in Section 9, or your warranty will be invalid.**

- **Do not modify the tool design or any parts by yourselves. It will invalidate your warranty.**
- Check damaged parts. Before further using the tool, any part that is damaged should be carefully checked to determine that it would operate properly and perform its intended function. Check for alignment of moving parts, free running of moving parts, breakage of parts, mounting and any other conditions that may affect its operation. Do not operate tool with broken or worn parts.
- **Please remove battery from tool before any maintenance or replacements of self-changeable wearing parts.**
- Please refer to **Section 8 "MAINTENANCE AND SERVICE"** for detailed information.

### **Storage**

- Store the tool and battery separately in a dry and clean location when not in use. Keep away from reach of children.
- **Only trained personnel should handle tool. Strongly recommended that all visitors should not touch tool and be kept away from work area.**

### **General Safety Rules**

- **WARNING! Read all instructions. Failure to follow all instructions listed below may result in electric shock, fire, and/or serious injury. The term "power tool" in the warnings listed below refers to your battery-operated (cordless) power tool (EP-1345).**

## ***SAVE THESE INSTRUCTIONS***

### **1. WORK AREA SAFETY**

- a) Keep work area clean and well lit. Cluttered or dark areas invite accidents.
- b) **Do not operate power tools in explosive atmospheres, such as in the presence of flammable liquids, gases, or dust.** Power tools create sparks which may ignite the dust or fumes.
- c) Keep children and bystanders away while operating a power tool. Distractions can cause you to lose control.

### **2. ELECTRICAL SAFETY**

- a) Power tool plugs must match the outlet. Never modify the plug in any way. Do not use any adapter plugs with earthed (grounded) power tools. Unmodified plugs and matching outlets will reduce risk of electric shock.
- b) Avoid body contact with earthed or grounded surfaces, such as pipes, radiators, ranges, and refrigerators. There is an increased risk of electric shock if your body is earthed or grounded.
- c) Do not expose power tools to rain or wet conditions. Water entering a power tool will increase the risk of electric shock.
- d) Do not abuse the cord. Never use the cord for carrying, pulling, or unplugging the power tool. Keep cord away from heat, oil, sharp edges or moving parts. Damaged or entangled cords increase the risk of electric shock.
- e) When operating a power tool outdoors, use an extension cord suitable for outdoor use. Use of a

cord suitable for outdoor use reduces the risk of electric shock.

f) If operating a power tool in a damp location is unavoidable, use a residual current device (RCD) protected supply. Use of an RCD reduces the risk of electric shock.

NOTE: THE TERM “RESIDUAL CURRENT DEVICE (RCD)” CAN BE REPLACED BY THE TERM “GROUND FAULT CIRCUIT INTERRUPTER (GFCI)” OR “EARTH LEAKAGE CIRCUIT BREAKER (ELCB)”

### **3. PERSONAL SAFETY**

a) Stay alert, watch what you are doing and use common sense when operating a power tool. Do not use a power tool while you are tired or under the influence of drugs, alcohol, or medication. A moment of inattention while operating power tools may result in serious personal injury.

b) Use personal protective equipment. Always wear eye protection. Protective equipment such as a dust mask, non-skid safety shoes, hard hat or hearing protection used for appropriate conditions will reduce personal injuries.

c) Prevent unintentional starting. Ensure the switch is in the ‘off’ position before connecting to power source and/or battery pack, picking up or carrying the tool. Carrying power tools with your finger on the switch or energizing power tools that have the switch on invites accidents.

d) Remove any adjusting key or wrench before turning the power tool on. A wrench or a key left attached to a rotating part of the power tool may result in personal injury.

e) Do not overreach and keep proper footing and balance at all times. This enables better control of the power tool in unexpected situations.

f) Dress properly. Do not wear loose clothing or jewelry. Keep your hair and clothing away from moving parts. Loose clothes, jewelry or long hair can be caught in moving parts.

g) If devices are provided for the connection of dust extraction and collection facilities, ensure these are connected and properly used. Use of dust collection can reduce dust-related hazards.

h) Do not let familiarity gained from frequent use of tools allow you to become complacent and ignore tool safety principles. A careless action can cause severe injury within a fraction of a second

### **4. POWER TOOL USE AND CARE**

a) Do not force the power tool. Use the correct power tool for your application. The correct power tool will do the job better and safer at the rate for which it was designed.

b) Do not use the power tool if the switch does not turn it on and off. Any power tool that cannot be controlled with the switch is dangerous and must be repaired.

c) Disconnect the plug from the power source and/or remove the battery pack, if detachable, from the power tool before making any adjustments, changing accessories, or storing power tools. Such preventive safety measures reduce the risk of starting the power tool accidentally.

d) Store idle power tools out of the reach of children and do not allow persons unfamiliar with the power tool or these instructions to operate the power tool. Power tools are dangerous in the hands of untrained users.

e) Maintain power tools and accessories. Check for misalignment or binding of moving parts, breakage of parts and any other condition that may affect the power tool’s operation. If damaged, have the power tool repaired before use. Many accidents are caused by poorly maintained power tools.

f) Keep cutting tools sharp and clean. Properly maintained cutting tools with sharp cutting edges

are less likely to bind and are easier to control.

g) Use the power tool, accessories, tool bits, etc. in accordance with these instructions; considering the working conditions and the work to be performed. Use of the power tool for operations different from those intended could result in a hazardous situation.

h) Keep handles and grasping surfaces dry, clean, and free from oil and grease. Slippery handles and grasping surfaces do not allow for safe handling and control of the tool in unexpected situations.

## **5. BATTERY TOOL USE AND CARE**

a) Recharge only with the charger specified by the manufacturer. A charger that is suitable for one type of battery pack may create a risk of fire when used with another battery pack.

b) Use power tools only with specifically designated battery packs. Use of any other battery packs may create a risk of injury and fire.

c) When battery pack is not in use, keep it away from other metal objects, like paper clips, coins, keys, nails, screws or other small metal objects, that can make a connection from one terminal to another. Shorting the battery terminals together may cause burns or a fire.

d) Under abusive conditions, liquid may be ejected from the battery; avoid contact. If contact accidentally occurs, flush with water. If liquid contacts eyes, additionally seek medical help. Liquid ejected from the battery may cause irritation or burns.

e) Do not use a battery pack or tool that is damaged or modified. Damaged or modified batteries may exhibit unpredictable behavior resulting in fire, explosion, or risk of injury.

f) Do not expose a battery pack or tool to fire or excessive temperature. Exposure to fire or temperature above 130 °C / 265 °F may cause explosion.

g) Follow all charging instructions and do not charge the battery pack or tool outside the temperature range specified in the instructions. Charging improperly or at temperatures outside the specified range may damage the battery and increase the risk of fire.

## **6. SERVICE**

a) Have your power tool serviced by a qualified repair person using only identical replacement parts. This will ensure that the safety of the power tool is maintained.

b) Never service damaged battery packs. Service of battery packs should only be performed by the manufacturer or authorized service providers.

## **NOTICE**

- Do not dispose of electrical appliances as unsorted municipal waste, use separate collection facilities.
- Contact your local government for information regarding the collection systems available.
- If electrical appliances are disposed of in landfills or dumps, hazardous substances can leak into the groundwater and get into the food chain, damaging your health and well-being.
- When replacing old appliances with new one, the retailer is legally obligated to take back your old appliance for disposal at least for free of charge.

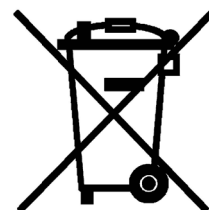

## 4. SETTING BEFORE OPERATION

Read and follow the safety instruction of this manual. Please follow the steps as follows before initial operation.

### 4.1 INTRODUCTION OF OPERATION COMPONENTS

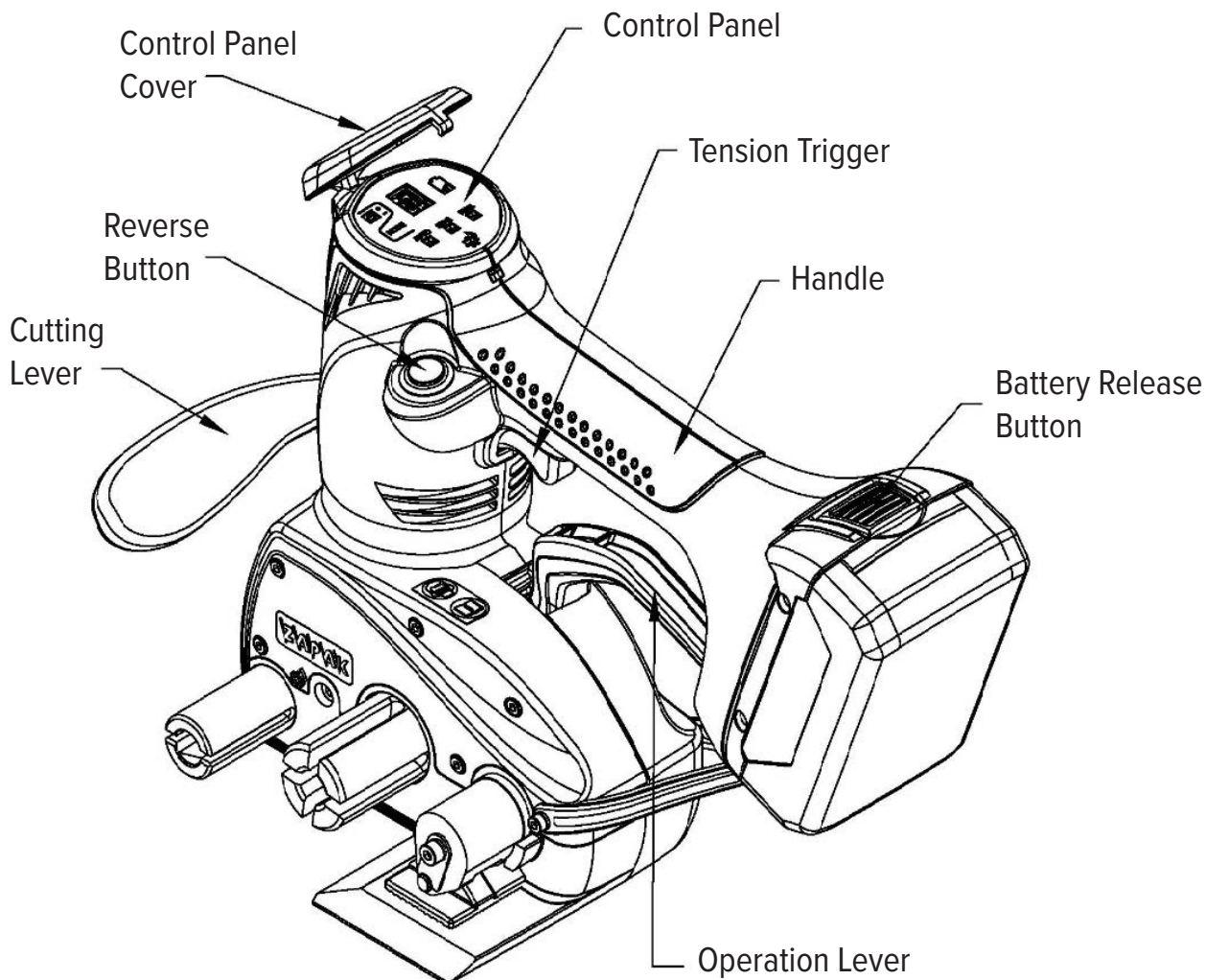

FIGURE 2. EP-1345 INTRODUCTION OF OPERATION COMPONENTS

### 4.2 LED LIGHT INDICATORS ON CONTROL PANEL

DESCRIPTION / TOOL STATUS/ ACTION	LED LIGHT INDICATORS / REMARKS
<b>NO POWER</b>	LED Off
<b>POWER SAVING MODE:</b> Tool power is automatically turned off after 10 minutes of non use idling	LED Off
<b>TURNING ON TOOL</b> Insert battery. Press the Tension Trigger once to turn on the tool.	All LED on the Control Panel flash once with one Beep sound, then the Control Panel displays all previously selected settings (Tension, and Tension Mode) indicating Tool is stand-by mode ready to Tension.



<b>TENSIONING</b>	Pull the tension trigger again to start tensioning based on tension and tension mode setting (Precut, Auto, Manual) Green digit LED inside the window shows the selected Tension setting and tension mode LED flashing Orange during Tensioning.
<b>BATTERY POWER IS LOW</b>	Battery power LED flashing RED with “Beep...Beep” sound, and alarm continues until Battery is removed.
<b>MAINTENANCE – Lubricant Refill</b>	<b>LUBRICANT REFILL LED FLASHING BLUE</b> for 30 seconds upon turning on the tool, when count of use reaches up to 20,000 cycles each time. Refill with ENCORE’s specified lubricant (32XX-10) is needed immediately.
<b>DEVICE ERROR</b> Error Reports in conjunction with the Motor/Control System/Power Electronics.	<p>When Improper Operation or Tool Malfunction occurs, alarm sound “Beep...Beep” may continue until the Battery is removed, and digit LED may turn to letter “E” followed by a “Number” as follows:</p> <ol style="list-style-type: none"> <li>1. “E.2.” - Motor is jammed.</li> <li>2. “E.3.” - Motor is overheating.</li> <li>3. “E.4.” - Motor self-detection of all other motor malfunctions.</li> <li>4. “E.5.” - Either Tension Switch Activator or Reverse Button is faulty.</li> <li>5. “E.9.” - Faulty Motor wiring signals detected during tool operation.</li> </ol> <p>Please press the Reverse Button to halt the operation and remove battery. Consult with your dealer or send it back to the manufacturer’s authorized dealer for further examination and repair.</p>

## 4.3 OPERATION INSTRUCTIONS OF CONTROL PANEL

### INTRODUCTION OF CONTROL PANEL ( FIGURE 3 )

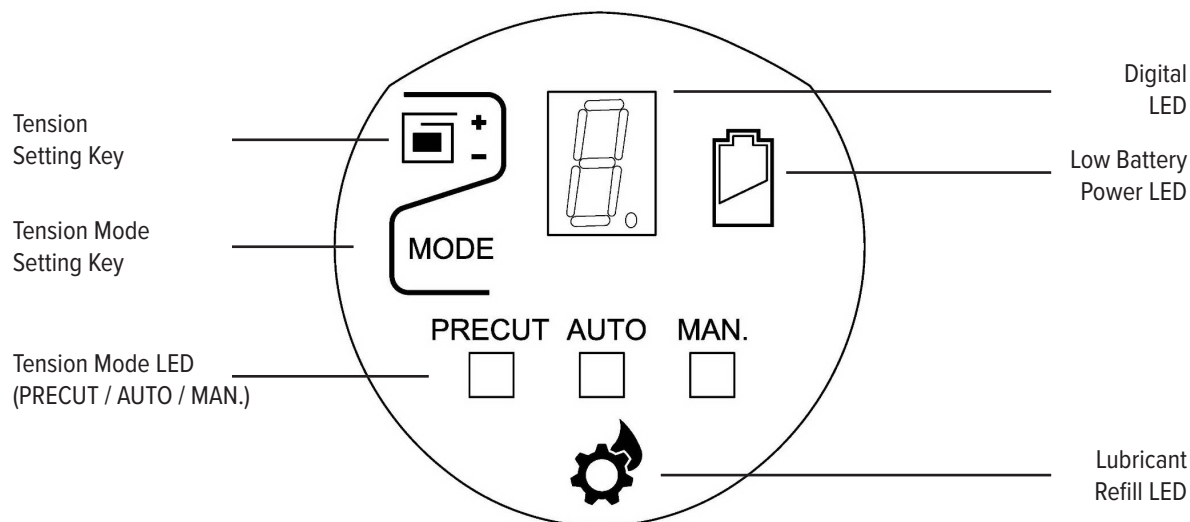
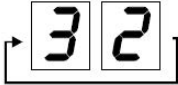

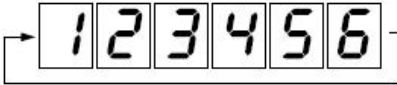

FIGURE 3. EP-1345 INTRODUCTION OF CONTROL PANEL (VERSION B)



DESCRIPTION	OPERATION INSTRUCTIONS OF CONTROL PANEL
ALL THE KEYS	To avoid any mistaken presses or any careless initiations of tool, every key needs to be pressed longer than 1 second before any LED lights starts to react and respond.
MODEL NUMBER DISPLAY	<p>While turning on, Pull and HOLD the Tension Trigger 2 seconds, Digital LED will display Model No. in running numbers, then tool goes back to initial stand-by status.</p> 
<p>TENSION SETTING KEY &amp; DIGITAL LED</p> 	<p><b>STEPS:</b></p> <ol style="list-style-type: none"> <li>Press and hold the key for 2 seconds until the Digital LED flashes and then release.</li> <li>Press key again to select a digit in the digital LED for the tension setting required according to your strap quality and specifications. (digital LED ranges from 1 to 6 for your selection of tension setting, refer to 4.6.1 Tension Adjustment). <ul style="list-style-type: none"> <li>Switch digital LED from 1 up to 6 to increase (+) tension.</li> <li>Switch digital LED from 6 down to 1 to reduce ( - ) tension.</li> </ul> </li> </ol>  <ol style="list-style-type: none"> <li>Release key and wait for 10 seconds and your tension setting is completed or press the <b>“MODE”</b> key to finish your setting quickly. <ul style="list-style-type: none"> <li><b>DURING TENSIONING, NO ADJUSTMENTS OR SETTINGS CAN BE MADE ON CONTROL PANEL.</b></li> </ul> </li> </ol>

## TENSION MODE SETTING KEY

### MODE

### & TENSION MODE LED

UPON SHIPMENT, TOOL IS SET UNDER AUTO MODE.

After tool is turned on, AUTO light is on:

1. Press and hold the “MODE” key for 2 seconds to switch Tension Mode from AUTO to MAN. (refer to 4.6.2 Selecting Tension Mode)
2. Tension Mode LED runs in order of AUTO → MAN. → AUTO → MAN. as shown below.
3. Release key and wait for 1 second. Your setting of tension mode is completed.

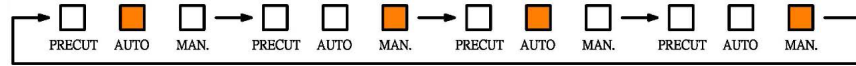

### PRECUT OFF

**NOTE:** PRECUT mode is locked (function off) when Tension Mode is set under AUTO/MAN.

TO UNLOCK PRECUT MODE (FUNCTION ON):

Step 1: Remove the battery and put it back into tool again (Re-set).

Step 2: Press the key of “MODE” and hold the “Tension Trigger” at the same time.

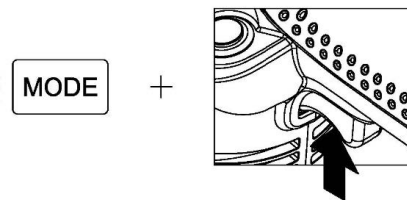

Step 3: Upon the PRECUT LED start flashing, release both “MODE” key and “Tension Trigger” within 10 seconds.

PRECUT LED is on and functions; AUTO & MAN. LEDs are both off and function off.



**NOTE:** When AUTO or MAN. is needed, repeat the above 3 steps to lock the PRECUT mode (PRECUT OFF).

## DIGITAL LED

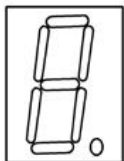



1. To alarm malfunctions, the digit will be changed to show letter “E” followed by numbers with continuous “beep...beep” alarm, indicating malfunctions (refer to 4.2)
2. Check on Count of Use:

Step 1: Remove the battery and put it back into tool again (Re-set)

Step 2: Press both keys  AND  together at the same time.

Step 3: Hold both keys above without release. Then pull and hold the Tension Trigger, all LEDs on the control panel shall be lighted up and you will see digital LED display the count of use by running numbers. When all buttons are released, tool goes back to initial stand-by status.

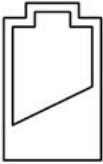

<p><b>LUBRICANT REFILL LED</b></p> 	<p>When count of use reaches 20,000 cycles, the lubricant refill LED will flash 30 seconds upon turning on the tool. (Refer to SECTION 7. “MAINTENANCE OF LUBRICANT REFILL” and find location of Lubricant Refilling Hole.)</p> <p><b>EXCEPTION ALLOWED:</b> When significant drop of Tension Force occurs, re-fill 32XX-10 Lubricant is required, even though signal of Lubricant Refill LED is not turned to flashing BLUE yet.</p> <p><b>After refill, manually release the alarm by following steps:</b>  Step 1: Remove the battery and put it back into tool again (Re-set)  Step 2: Press and hold both Reverse Button and Tension Trigger, until the tool turns on.  Step 3: Upon the lubricant refill LED start flashing, release both Reverse Button and Tension Trigger, then tool goes back to initial stand-by status.</p>
<p><b>LOW BATTERY POWER LED</b></p> 	<p>When battery power gets too low to work, battery LED flashes in RED with “beep...beep” alarm continuously and charging process is required immediately.</p>  <p>LOW BATTERY POWER STATUS</p>

### 4.3.1 CONTROL PANEL COVER

To avoid undesired and careless presses or touches on Control Panel after all settings are completed. A Control Panel Cover is installed on every tool as a protection. Please follow steps and drawings below for replacement, if necessary.

Step 1 : Unscrew (1) M3x0.5x16mm & (2) M3 Washer & (3) M3x0.5mm nut as shown.

Step 2 : Replace with new Control Panel Cover on top of the Control Panel and screw back.

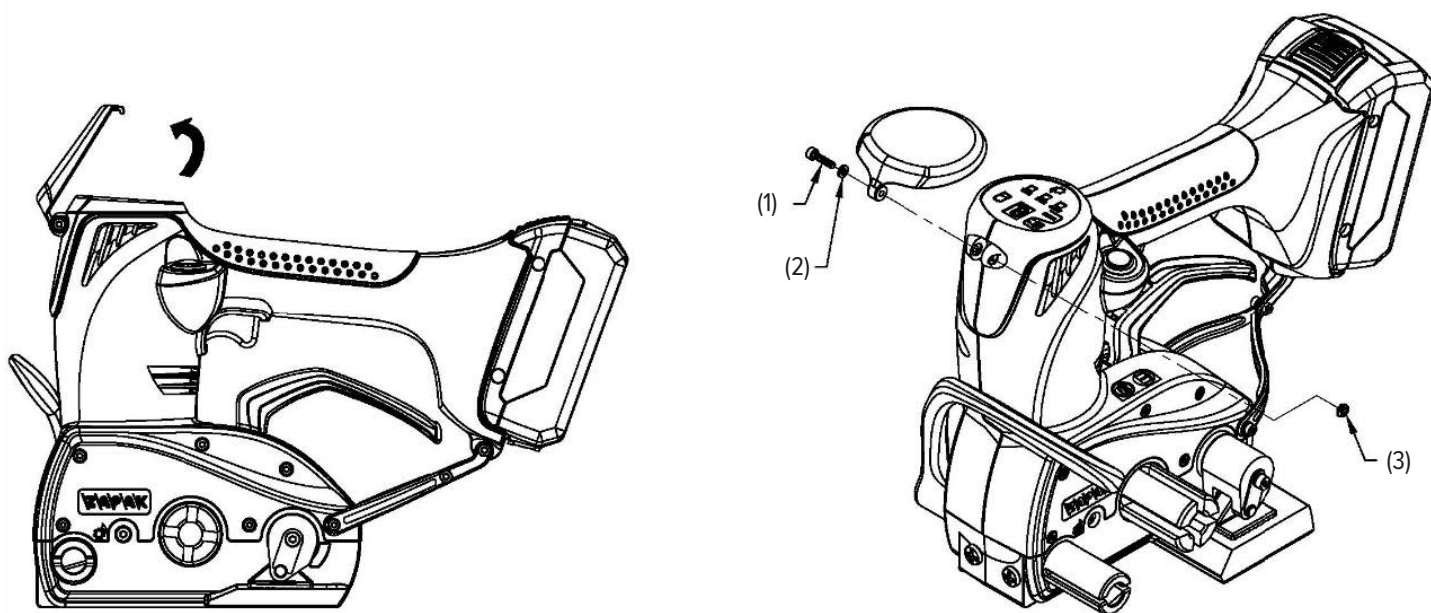

FIGURE 4. EP-1345 REPLACEMENT OF CONTROL PANEL COVER

## 4.4 CHARGING BATTERY

Refer to FIGURE 5 to insert the battery into charger (Please refer and follow the safety instruction and operation of the battery and charger user manual.)

### I. Usage Notice:



- Each ENCORE E1260-28-D Li-Ion Battery is equipped with Charge Level Indicator. Press button to check the status of charge level condition (capacity), as shown on Figure 5.  
(\*For safety reasons, it is only possible to check the charge condition when the tool is at a standstill.)
- When you receive ENCORE E1260-28-D Li-Ion Battery, its capacity may not be sufficient. Please check capacity status and charge fully before use when necessary.
- When three LEDs light up, the capacity is sufficient, no need to charge.
- When only one LED lights up or flashing green, or the Tool's "Battery Power LED" display in flashing red, proceed charging with ENCORE E1260-58 Li-Ion Battery Charger.
- Adapter is NOT required for charging ENCORE E1260-28-D Li-Ion Battery.
- Remove battery from charger upon charging process is completed. Otherwise, it may shorten battery's service life due to over-charging.

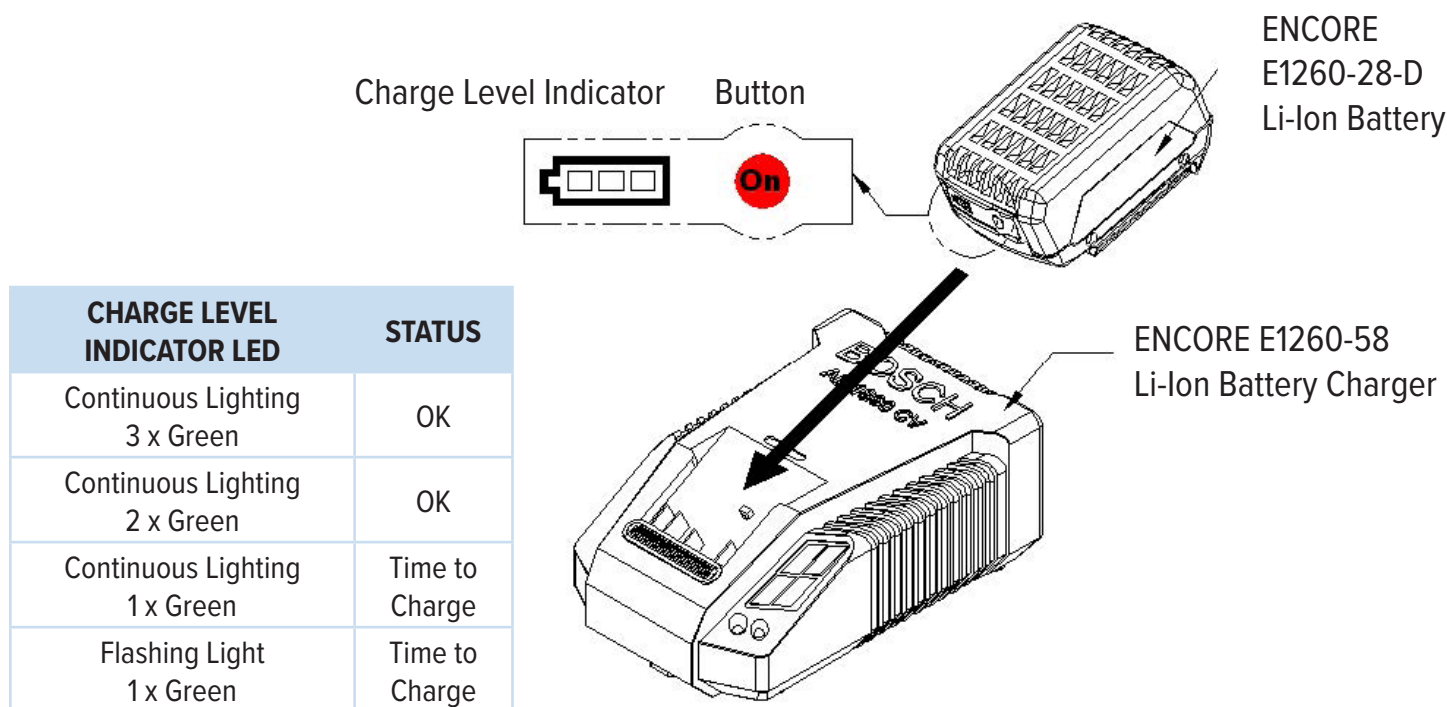

FIGURE 5. ILLUSTRATION OF INSERTING BATTERY ONTO CHARGER

## II. Storage Notice:

- For storage within 6 months under normal temperature and environment, ENCORE E1260-28-D Li-Ion Battery does not require a full charge before storage. However, when the Charge Level Indicator shows low capacity with only one LED light, a 5 -10 min. charge is needed to raise the capacity up to 2 green lights.
- For long time storage or non use over one year or above, Check capacity level every 6 months. When only one LED lights up, please charge 5- 10 minutes until two LEDs light up.

## III. Others:

- In order to achieve the best charging capacity, please wait until the battery has cooled down before recharging.
- Charging time may vary based on the voltage variation of each individual area/country.
- Abnormal temperature of battery and charger will reduce the charging efficiency significantly.
- **Always remove battery from tool when tool is not in use.**
- **Always remove a low-power battery from tool for a recharge process SOON AFTER the “Battery Power LED” blinks in red and continuous “beep...beep” alarm appears. DO NOT wait and leave such battery unattended and un-recharged. Fail to recharge timely will cause quick battery failures due to power being overly output and discharged.**
- Charging the battery: When charging speed becomes abnormally slow due battery temperature is raised abnormally or charger shows abnormal signal, please remove the battery from charger for cooling. Either battery or charger is defective if the battery still cannot be charged. Use another battery to check which is defective.
- ENCORE E1260-58 Li-Ion Battery Charger is installed with protection device to avoid overcharge hazard. Such device will cut off charging process automatically when the battery has been charged fully or reached its maximum voltage level. Even so, for safety reason, please remove battery from charger upon charging process is completed.
- **Remove battery and discontinue charging process if any abnormal situation occurs.**
- **It is required to install a surge protector to protect the charger and minimize the risks and damages caused by surge (a strong and sudden electricity shock).**

## 4.5 BATTERY INSTALLATION AND REMOVAL

Insert a fully charged battery onto the tool as shown (FIGURE 6-1). **Be sure to install the battery all the way down until the release button is popped up as shown (FIGURE 6-2).** Press tension button the first time, all LEDs on control panel should be lighted up and all previous settings come up with “beep” sound simultaneously. These indicate that battery electricity system is ready to work under normal condition.

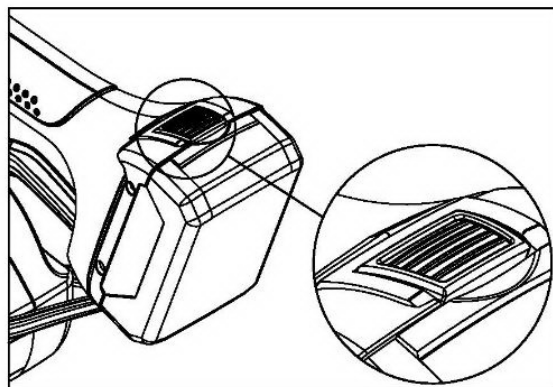
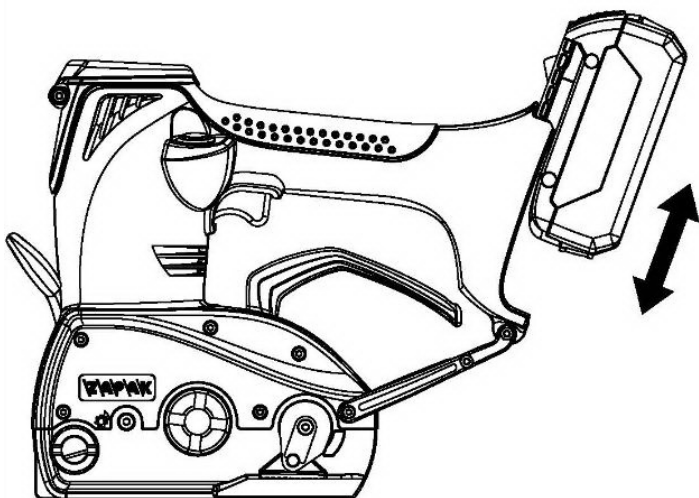

FIGURE 6-1. ILLUSTRATION OF INSERTING AND REMOVAL OF BATTERY  
FIGURE 6-2. ILLUSTRATION OF RELEASE BUTTON POP UP

- When the Battery Power LED on control panel shows “Red flashing,” it means the battery power is too low to work and needs to be re-charged. Then the tool is NOT supposed to be operated under such condition. You will simultaneously hear “Beep...beep...beep” alarm. Please press “Battery Release Button “ on top of battery and pull battery upward to remove it from the tool. The “beep...beep” alarm will continue until the battery is removed. (FIGURE 6-1)
- If the battery release button does not pop up, the tool will likely shut-down during operation, it could create power surge to damage the motor and ECU. This will be treated as improper operation and which invalids the warranty.

## 4.6 SETTING TENSION

### 4.6.1 SETTING TENSION

- EP-1345 tension ranges from 661 lbs - 1763 lbs  $\pm$  5 % / 300kg to 800kg  $\pm$  5%.

Follow and refer to 4.3 Control Panel Operation Instructions, digital LED ranges from 1 - 6 for 6 tension settings for Composite & Woven cord straps. Press “ Tension Setting Key “ to switch digit in the LED, the digit circulates from 1  $\rightarrow$  2  $\rightarrow$  3  $\rightarrow$  4  $\rightarrow$  5  $\rightarrow$  6  $\rightarrow$  1  $\rightarrow$  2  $\rightarrow$  3  $\rightarrow$  4  $\rightarrow$  5  $\rightarrow$  6 for you to increase (1 - 6) or to reduce (6 - 1) your tension setting.

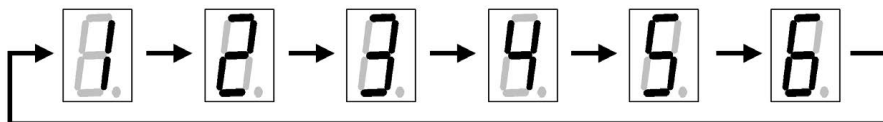

STRAP TYPE	TENSION SETTING RANGE	1	2	3	4	5	6
COMPOSITE	1 - 6	661 - 826 lbs 300 - 375 kg	826 - 992 lbs 375 - 450 kg	992 - 1157 lbs 450 - 525 kg	1157 - 1322 lbs 525 - 600 kg	1322 - 1488 lbs 600 - 675 kg	1488 - 1763 lbs 675 - 800 kg
WOVEN							



- Above tension force chart is for reference only, based on the first tension result tested on brand new straps.
- Tension performance varies based on strap specification, quality, setting, and remaining battery power.
- Tension force may not be fully achieved in the beginning of operation. Full tension force will be achieved after continuous operation till the motor is warmed up.

**NOTE:** Pre-test prior to tension operation is required. Start at a lower tension setting to pre-test and find your best tension setting. Increase tension setting according to your strap quality, specifications, and breakage strength SLIGHTLY and GRADUALLY when necessary. Do not over set tension which may result in damage on the strap or bundled goods or breakage hazards.

**NOTE:** While pre-testing under “AUTO” or “MAN.” tension mode, DO NOT trickle (re-tension) excessively and repeatedly after tension stops.

**NOTE:** Re-using Cord straps is not recommended. Tension performance will be deteriorated and may have safety concerns with the increasing numbers of uses. Do not set at high tension force for re-used straps, or damages on the straps or goods may occur.

**NOTE:** Tension performance might be reduced and affected by insufficient battery remaining Power or re-uses of straps.

#### **WARNING**

- IF ANY ABNORMALITY OCCURS DUE TO IMPROPER OPERATION OR TOOL MALFUNCTION, PRESS THE REVERSE BUTTON TO HALT OPERATION IMMEDIATELY, AND REMOVE THE BATTERY. PLEASE DO NOT TRY TO RE-START THE TOOL BY INSERTING ANOTHER BATTERY. CONTACT AND CONSULT WITH YOUR DEALER OR SEND IT BACK TO MANUFACTURER’S AUTHORIZED DEALER FOR FURTHER EXAMINATION AND REPAIR.



## 4.6.2 SELECTING TENSION MODE

	PRECUT (AUTO REVERSE)	AUTO (AUTO TENSION)	MAN. (MANUAL TENSION)
<b>OPERATION INSTRUCTION</b>	<ul style="list-style-type: none"> <li>One pull on Tension Trigger, Tension stops at your set tension automatically, and then reverse (wind backward) the end tail of strap automatically.</li> <li>Trickle (re-tension) is not allowed.</li> <li>Cutting is not allowed.</li> <li>For tensioning of pre-cut straps only, when cutting is not required.</li> </ul>	<ul style="list-style-type: none"> <li>One pull on Tension Trigger, Tension stops at your set tension automatically.</li> <li>To get more tightness, few trickles (1 - 3 times) on Tension Trigger is allowed.</li> <li>Cutting is allowed after tensioning.</li> <li>Press the Reverse Button to reverse (wind backward) straps when needed.</li> </ul>	<ul style="list-style-type: none"> <li><b>HOLD</b> on Tension Trigger <b>without release</b>, until the tensioning stops by itself.</li> <li>To get more tightness, few trickles (1 - 3 times) on Tension Trigger is allowed.</li> <li>Cutting is allowed after tensioning.</li> <li>Press the Reverse Button to reverse (wind backward) straps when needed.</li> </ul>
<b>EMERGENCY STOP</b>	Press Reverse Button	Press Reverse Button	<ol style="list-style-type: none"> <li>Release the Tension Trigger</li> <li>If the tool is still in action, press Reverse Button to halt movement/operation.</li> </ol>

- Under “PRECUT” or “AUTO” tension mode, just need ONE pull on Tension Trigger, tension will stop automatically upon reaching your set tension.
- Under “AUTO” or “MAN.” tension mode, you may trickle (re-tension) 1 - 3 times to get more tension; DO NOT trickle excessively which may result damage on the strapping objects or cargo or bundled goods.
- When the tension result cannot meet your demand, increase or decrease tension setting SLIGHTLY and GRADUALLY. Do not over set tension in the beginning which may result damage on bundled goods or straps breakage hazards.

## 4.7 INSTALLATION OF HOUSING BRACKET

**REMOVE BATTERY FROM TOOL BEFORE MAINTENANCE OR PARTS REPLACEMENT.**

Assembly Steps: as (FIGURE 7) Shown

Step 1: Remove 2pcs each of screw (M3×14mm) and washer (M3) from left/right housing as (1) & (2) indicated, and then remove the screw (M3×16mm), washer (M3), and Nut (M3) from rear end of housing assembly as (3) indicated.

Step 2: Mount on the Housing Bracket and screw back all original screws, washers, and nut as (1), (2), & (3) indicated in STEP 1, and then fix the Left/right Housing bracket with additional screw (M3×8mm), washer (M3), and Nut (M3) as (4) indicated through central hole of the brackets.

- LEFT AND RIGHT HOUSING BRACKETS MUST NOT BE INTERCHANGED.**

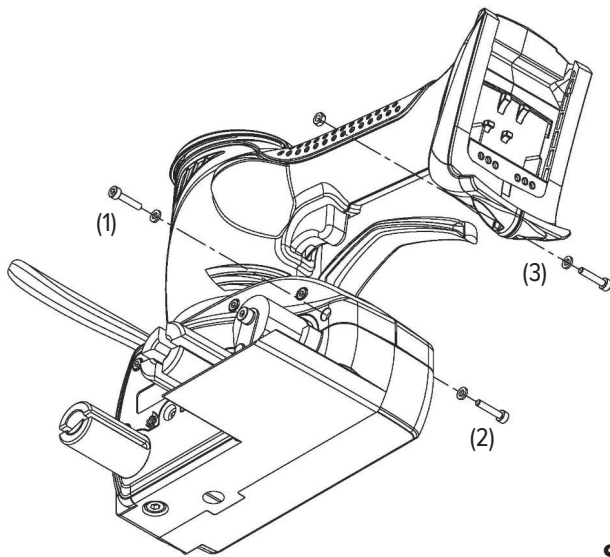

**STEP 1**

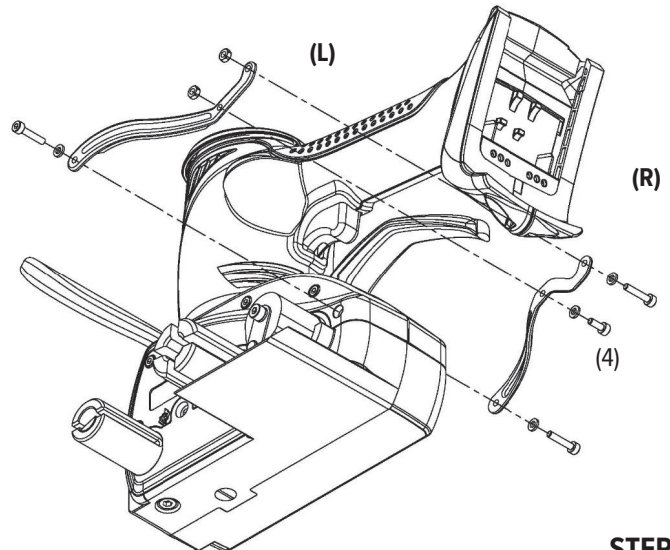

**STEP 2**

*FIGURE 7. INSTALLATION OF HOUSING BRACKET*

## 5. OPERATION

EP-1345 Tensioner is applicable to tensioning of Composite or Woven Straps. Metal Buckle is necessary. ENCORE does not supply straps or buckles in kit, but you can purchase separately.



**PRE-TEST UNDER “AUTO” TENSION MODE PRIOR TO TENSION OPERATION.**



1. Do not operate Tensioner without inserting cord straps.
2. Always use new cord strap and new wire buckle or ladder buckle for the 1st time pre-test; used straps or buckles may affect the testing result and mislead the judgment of tension setting required.
3. **DO NOT RE-USE WIRE BUCKLES.**
4. **DO NOT TOUCH CUTTER, WINDLASS, AND THE GRIPPER FOOT DURING OPERATION TO AVOID INJURY.**

### 5.1 STRAP AROUND THE ARTICLE

- Strap around the article, fasten the strap with a wire buckle or ladder buckle, and tighten the loop by hand to a reasonable tightness, as (FIGURE 8) shown.

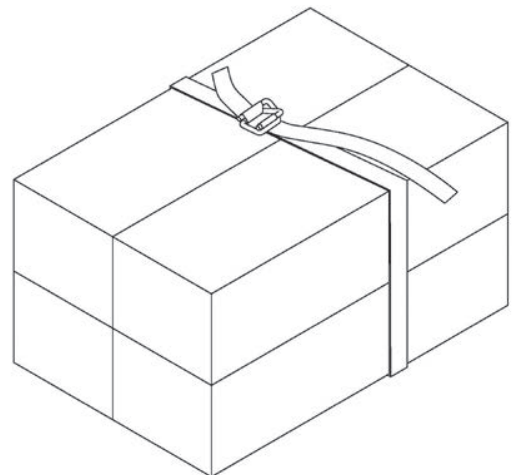

*FIGURE 8.*

## 5.2 FEEDING LOWER STRAP BENEATH GRIPPER FOOT

- Lift the Operation Lever to the top, feed the lower strap under Cutter sleeve, Windlass, and the Gripper Foot.
- **QUICK STRAPS ALIGNMENT:** please use two fingers (thumb and index finger) of your left hand to push straps into the innermost side as (FIGURE 9) shown to get a quick straps alignment. Release the Operation Lever after feeding the strap well.

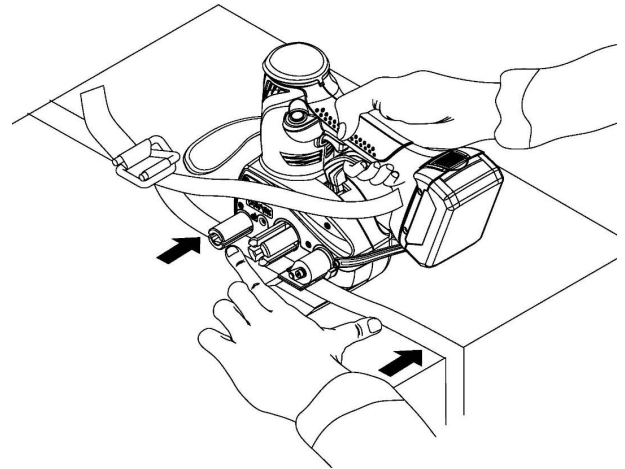

FIGURE 9.

## 5.3 FEEDING UPPER STRAP INTO WINDLASS

### 5.3.1 WHEN CUTTING IS NOT NECESSARY (APPLICABLE TO PRECUT STRAP ONLY)

- **SET UNDER “PRECUT” MODE.** Follow 4.3 “Operation Instructions” – “MODE” – “To unlock PRECUT mode (Function on)”
- It is not necessary to install the Cutter & Sleeve assembly (5.3.2.1) and Cutting Lever (5.3.2.2). If installed, just remove them or the upper strap should go above the Cutter Sleeve and then insert into the slot of Windlass as (FIGURE 10) shown.
- After tensioning, end tail of straps will be automatically reversed (winded backward). Cutting is not allowed.

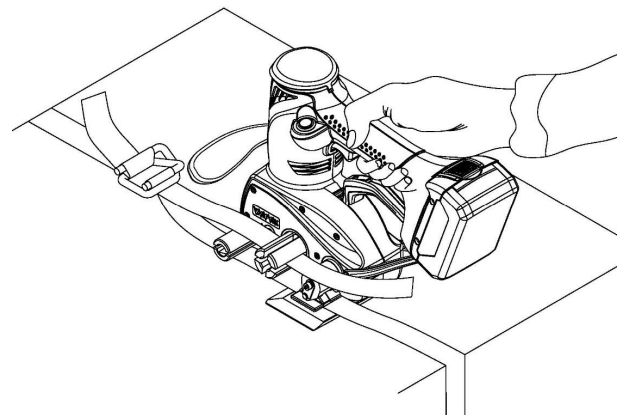

FIGURE 10.

**“PRECUT” MODE IS DESIGNED PARTICULARLY FOR PRECUT STRAPS ONLY. LEAVE STRAP LENGTH LESS THAN 40CM AFTER FASTENING THE BUCKLE.**

### 5.3.2 WHEN CUTTING IS NECESSARY (APPLICABLE TO BOTH COMPOSITE AND WOVEN STRAPS)

**SET UNDER “AUTO” OR “MAN.” MODE.** (If previous setting is under PRECUT mode, need to follow 4.3 “Operation Instructions” – “MODE” – to lock “PRECUT” mode first prior to setting under “AUTO” or “MAN.” mode.)

Install the Cutter, Cutter Sleeve, and Cutting Lever (Step 5.3.2.1 & 5.3.2.2) first. Insert the upper strap into the slot of Cutter sleeve, and then the slot of Windlass.

After tensioning, hold the handle and Operation Lever, then push the Cutting Lever GENTLY to cut the strap as (FIGURE 11) shown.

After cutting, lift the operation lever, remove the tool from straps by raising the tool slightly and move the tool to the right.

To proceed cutting, wearing gloves is suggested, please do not grab the handle alone (like the wrong photo), make sure your fingers hold beneath the operation lever as well (like the correct photo), and then push the Cutting Lever to cut the straps; Otherwise, fingers may be hurt when the Operation Lever is bounced up as (FIGURE 12) shown.

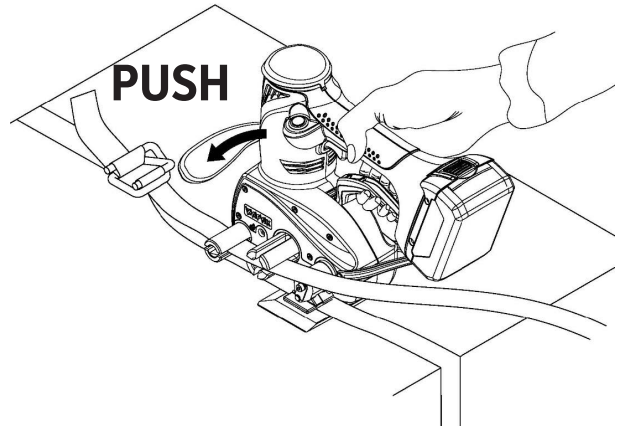

FIGURE 11.

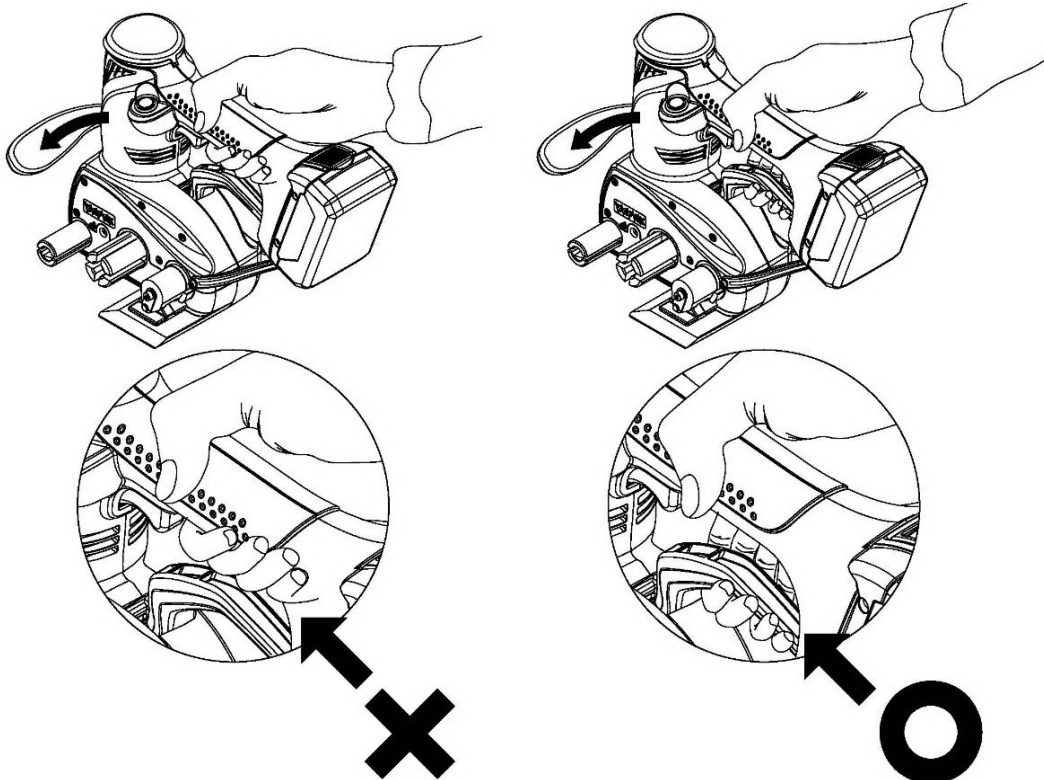

FIGURE 12. PUSH CUTTING LEVER GENTLY TO CUT THE STRAP



- Must complete tensioning first before cutting. **DO NOT CUT WHEN STRAPS ARE LOOSE OR NOT TIGHTENED.**
- When cutting, a gentle push on the Cutting Lever would cut the straps easily. Do not overly press the Cutting Lever with strong force all the way down. Release Cutting Lever as soon as you feel the cutting is done. **OVERLY PRESSING THE CUTTING LEVER WITH STRONG FORCE MAY CAUSE DAMAGES TO RELEVANT MECHANICAL PARTS AND INVALIDATE YOUR WARRANTY.**
- Lift up Operation Lever only for inserting straps or straps alignment. Do not use the Operation Lever to cut straps only. **THIS TOOL SHOULD NOT BE USED LIKE SCISSORS.**

### 5.3.2.1 INSTALLATION OF CUTTER & CUTTER SLEEVE

REMOVE BATTERY FROM TOOL BEFORE INSTALLATION.

- Make sure there's a C-ring fastened to the Cutter;
- Insert the Cutter into rear end of the Cutter sleeve horizontally, then insert the whole cutter assembly into the comparative hole of main frame assembly; Make sure the thread hole of Sleeve face down, and then fix with screw (M5x10mm) and washer (M5) from the bottom of the main frame assembly as (FIGURE 13) shown.

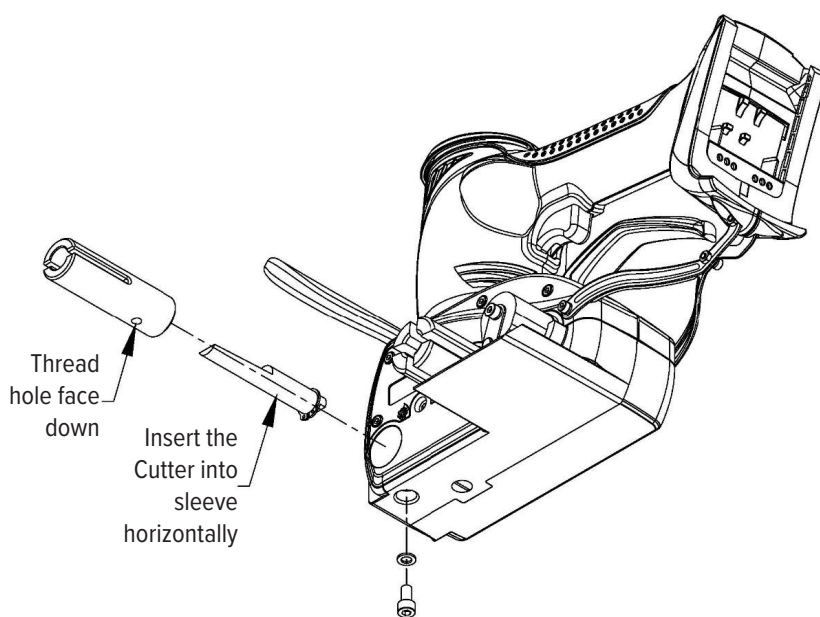

FIGURE 13. INSTALLATION OF CUTTER & SLEEVE ASSEMBLY

- Lubricate the Cutter with Anti rust oil (ex. WD-40) periodically.

### 5.3.2.2 INSTALLATION OF CUTTING LEVER

REMOVE BATTERY FROM TOOL BEFORE INSTALLATION.

- Insert the Cutting Lever into the hexagonal column position, and fix with (1) gasket, (2) M3 washer, and (3) screw M3x12mm as (FIGURE 14) shown.
- The arrow mark on the bottom of cutter lever should be aligned with the groove on hexagonal column.

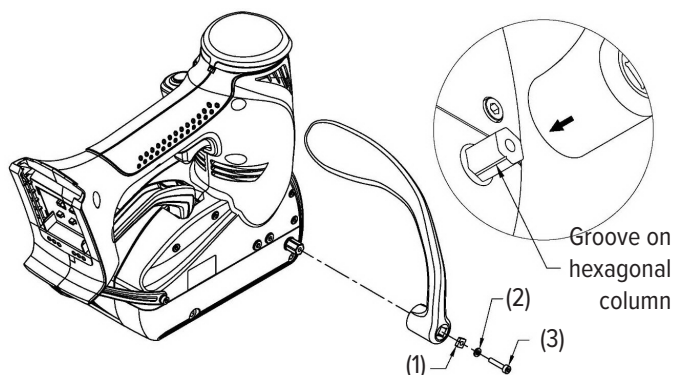

FIGURE 14. INSTALLATION OF CUTTING LEVER



## 5.4 TENSIONING AND REVERSING (WINDING BACKWARD) THE STRAP

When all LED lights are “off”, pull on tension trigger first to wake tool up before further operation. (Refer to “4.2 LED Light Indicators on Control Panel” and FIGURE 15-1). Control Panel shows previous settings.

Refer to “4.6 Setting Tension” to finish all function setting, then pull on tension trigger again to tension (FIGURE 15-1). During Tensioning, if the straps winded around the windlass is not well aligned, press “Reverse Button” to wind back the straps quickly so the tool can be removed from straps and re-alignment of straps can be processed. (FIGURE 15-2).

Tension will be performed based on the Tension Mode you set:

TENSION MODE	PRECUT	AUTO	MAN.
START TO TENSION	One pull on Tension Trigger*	One pull on Tension Trigger*	Pull and HOLD on Tension Trigger*
TENSIONING	Tension stops automatically	Tension stops automatically	Do not release trigger until tension stops
TRICKLE TO INCREASE TIGHTNESS	N/A	OK, trickle 1 to 3 times on Tension Trigger, if needed	OK, trickle 1 to 3 times on Tension Trigger, if needed
CUTTING	N/A	OK***	OK***
STRAP REVERSING	Automatically	Manually, press Reverse Button**	Manually, press Reverse Button**

\* - Refer Figure 15-1, \*\* - Refer Figure 15-2, \*\*\* - Refer Figure 11, Figure 12

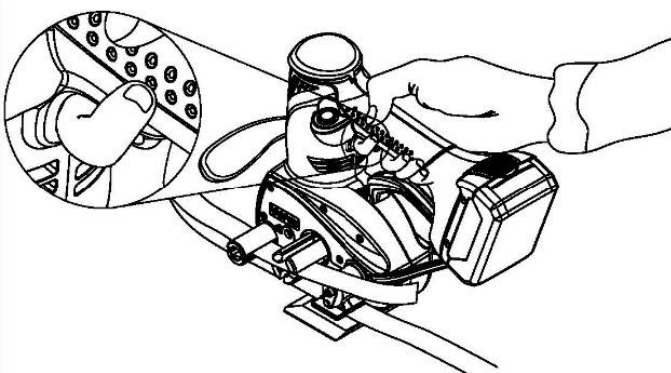

FIGURE 15-1. PULL TENSION TRIGGER

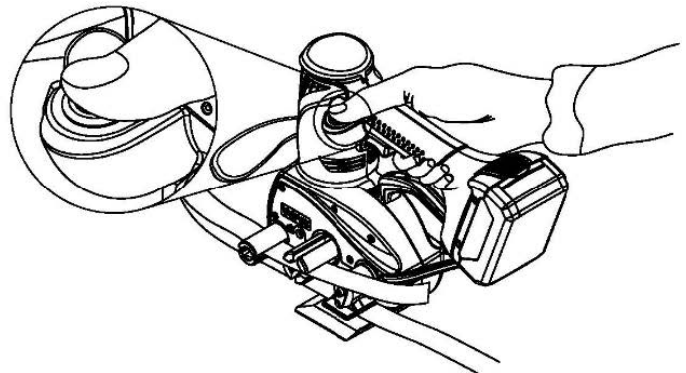

FIGURE 15-2. PRESS REVERSE BUTTON

- Do not lift the Operation Lever during tensioning to avoid strap loosening off.
- If slipping occurs during tensioning, please reduce the set tension force gradually. (Refer to 4.6.1.)
- When slipping occurs during tensioning, strap residues may remain on the Gripper Foot. Strap residues must be removed and cleaned completely before next operation. Otherwise slipping or poor tensioning issues will appear every operation. If slipping problem still exists, please check whether Gripper Foot is worn out. Please change parts when necessary or consult with your dealer.
- Do not pull Tension Trigger to keep motor running continuously over 10 seconds (ex. Start tensioning without strap). This is considered as improper operation and damages caused are not covered under warranty.
- Do not force to pull Tension Trigger too hard, it may damage interior micro device and shorten its service life.

## 5.5 REMOVE THE TOOL FROM STRAPS

- After above actions are completed, lift up the Operation Lever, remove the tool from straps by raising the tool slightly and move the tool to the right side.

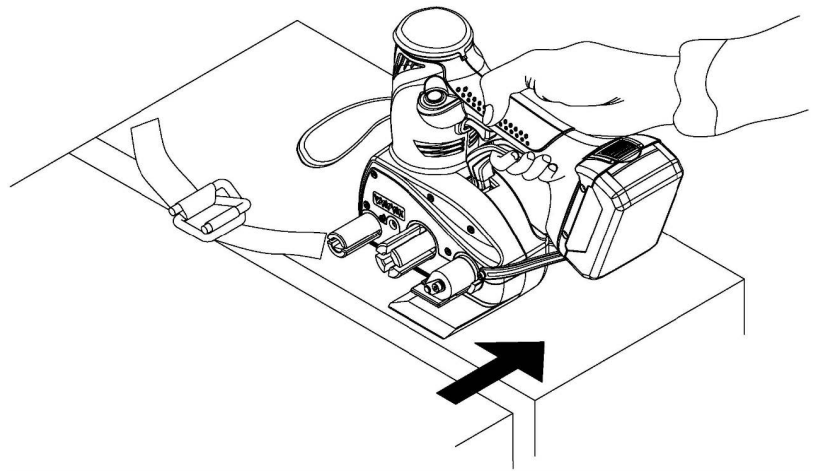

FIGURE 16. REMOVE THE TOOL FROM STRAPS

## 6. MAINTENANCE OF GRIPPER FOOT

When slipping occurs during tensioning, strap residues may remain on the Gripper Foot. Please lift the Operation Lever and use air gun to blow away residues on the Gripper Foot. Otherwise slipping or poor tensioning issues will appear every operation.

- Lubricate the Gripper Foot with Anti-rust oil (ex. WD-40) periodically.

## 7. MAINTENANCE OF LUBRICANT REFILL

- Remove battery from tool before proceeding refill.
- When count of use is accumulated to 20,000 cycles, the Lubricant Refill LED will flash for 30 seconds upon turning on the tool each time. It is necessary to refill with one complete tube of ENCORE's SPECIFIED lubricant 32XX-10 (about 2 ml) immediately. Be sure to follow lubricant refill instruction to maintain service life of tool and related mechanical parts. Do not refill with other lubricants that are not supplied by Encore (ENCORE) to avoid damages to mechanical parts and affect tool's operation and service life. Fail to follow this instruction will invalidate your warranty.
- When refilling lubricant, remove the Hex Screw (M3x1.0mm) and M3 washer next to the symbol of Lubricant Refill, insert the tip of the lubricant tube into the filling hole and squeeze the whole tube of lubricant into the hole completely, then fix back the M3 washer and Hex Screw as (FIGURE 17) shown.

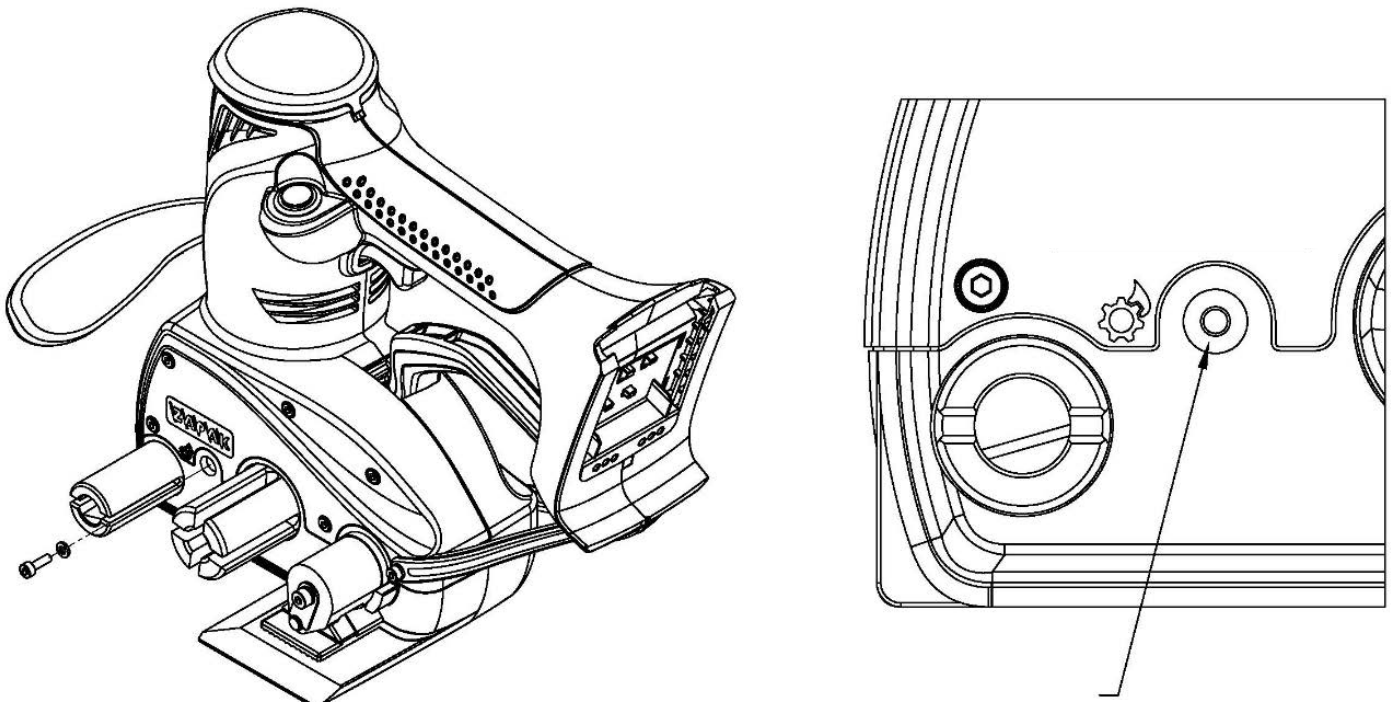

FIGURE 17. MAINTENANCE OF LUBRICANT REFILL

After refill, manually release the LED alarm by following steps:

Step 1: Remove the battery and put it back into tool again (Re-set)

Step 2: Press and hold the Reverse Button. Pull and hold the Tension Trigger, the tool will turn on. Keep pressing both keys without release.

Step 3: Once the lubricant refill LED starts flashing, release both keys right away and allow the tool to return to initial stand-by status.

- After releasing the alarm, the refill LED alert will come up again whenever count of use is accumulated to 20,000 cycles.

## 8. MAINTENANCE AND SERVICE

- Please refer to conditions on warranty proof. To protect your warranty rights, please make sure your dealer had completely filled out your warranty proof and signed on it.
- When tool is damaged, please call your dealer for further instruction and send your tool to manufacturer's authorized dealer for repair service. **DO NOT ATTEMPT TO REPAIR IT BY YOURSELF. THIS WILL INVALIDATE THE WARRANTY.**
- Please clean up the residues remained on Windlass or Gripper Foot with air gun. Regular cleaning will assure efficient working and reduce malfunctions.
- Clean your tool's exterior with only slightly damp cloth. Never use any chemical, gasoline, thinner, turpentine, dry cleaning fluids or liquids which may damage the plastic housing or finishing. Never let any liquid get into the tool and never immerse it into any liquid.

### WARNING

Keep the tool away from magnetic fields, water, and small metal objects or debris within operating surroundings. Fail to follow this instruction or inhalation of metal foreign objects into motor will cause malfunction to the tool and invalidate the warranty.

## 9. CHANGING WEARING PARTS



**Remove battery from tool before maintenance or parts replacement.**

Some wearing parts can be changed by user ( marked \* in below list ) which will not affect your warranty of the tool.

**The warranty excludes all wearing parts.**

## EP-1345 WEARING PARTS LIST

ITEM NO.	DESCRIPTION	REMARK
E1345-29*	Cutter	
E1260-28-D*	18V Rechargeable Lithium-Ion Battery	
E1345-14	Gripper Foot	Maintained by Authorized Dealer
E1345-31	Worm Gear	Maintained by Authorized Dealer

- This tool is designed with user self-changeable wearing parts (only those items marked \* above) including Cutter, and battery, etc. Each self-changeable wearing part is enclosed with a replacement instruction. (provided by authorized dealer), except battery. Other than those \* parts, please send your tool to a manufacturer's authorized dealer for repair service or warranty will be invalidated.
- Lubricate the Cutter and Gripper Foot with Anti rust Oil (ex. WD-40) periodically, if the tool is not used for over a week or store or work under humid environment.

## 10. OPTIONAL ACCESSORIES

### 10.1 18V RECHARGEABLE LITHIUM-ION BATTERY - E1260-28-D

- Recommended to buy more than one or two batteries as spares to meet more frequent strapping job demand. 18V Rechargeable Lithium-Ion Battery - E1260-28-D are only suitable for 18V Rechargeable Lithium-Ion Battery Charger- E1260-58.
- Unit comes with (2) Batteries and (1) Charger per kit.
- (Please refer to article 3. "SAFETY INSTRUCTION" regarding environmental, recycle and safety precautions of battery.)

### 10.2 18V RECHARGEABLE LITHIUM-ION BATTERY CHARGER - E1260-58

Please refer to article 3. "SAFETY INSTRUCTION" regarding safety precautions and the user manual of charger.

All Battery Chargers will be formatted for USA as default. You must request other regions plugs prior to ordering.

VOLTAGE	PLUG	REGIONS
100V a.c.	2 flat pins	Japan
115V a.c.	2 flat pins	USA, Canada, Mexico, North America, Taiwan
230V a.c.	2 round pins	European Countries, China, Middle and South America
240V a.c.	2 diagonal pins	Australia, New Zealand

## 10.3 NOSE PIECE (ROUND PUSHER) (PART NO. 32XX-4N)

Nose piece (round pusher) can be added for strapping curved surfaces or round objects as well as protecting the front portion of Tensioner from excessive wearing or scratches caused by constant collision with the buckle.

### ASSEMBLY STEPS:

1. Remove 2pcs (1) Plastic Phillips Screws (M6x8mm).
2. Insert and screw in the 2pcs each of (2) Hex Screw (M6x12mm) and (3) M6 Washer and into the thread holes of main frame assembly through the nose piece as (FIGURE 18) Shown.

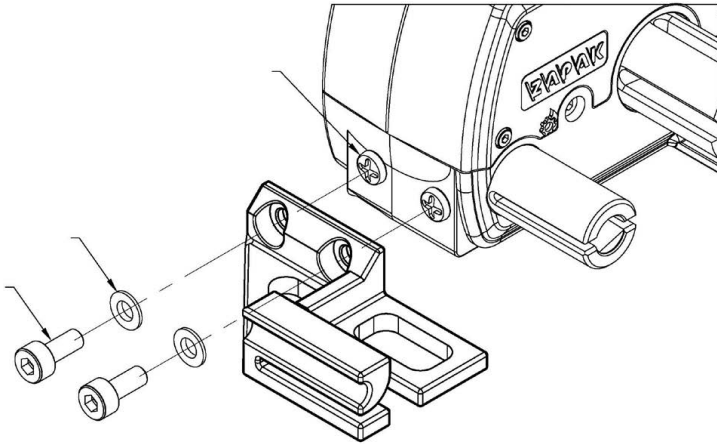

FIGURE 18. ILLUSTRATION OF NOSE PIECE

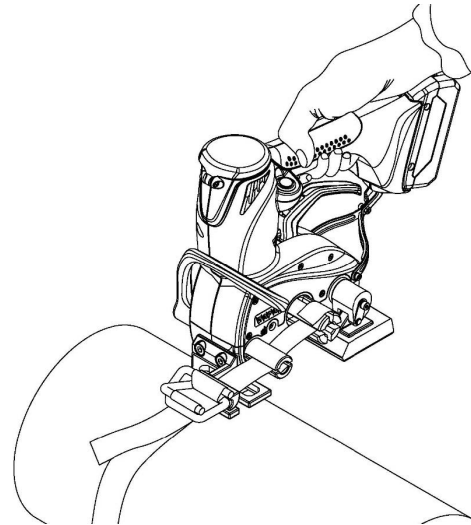

FIGURE 19. APPLICATION OF NOSE PIECE

After removal of two (1) Plastic Phillips Screws (M6x8mm), please keep them well, and screw back to protect the thread holes in front of the mechanism when Nose Piece or Hanger is not installed.

**NOTE:** When Nose Piece is mounted to support strapping, just need insert the strap into slots of both cutter sleeve (or go above the sleeve when cutting is not necessary), and the windlass, NO NEED to feed the strap beneath the Gripper Foot, push the nose against the leg of wire buckle to proceed tensioning, as (FIGURE 19) shown. Make sure the diameter of round object is bigger than the length of wire buckle.

## 10.4 HANGER - E1345-120

You can opt to equip the tool with a hanger at your work station. Hanger is applicable to tensioner with or without the nose piece installed. Follow assembly instruction enclosed with each hanger. Recommend to work with spring balancer which loads minimum 5 kgs up to suspend the tool to reduce the operation fatigue. Please contact your dealer for further details.



## 11. WARRANTY

Encore Packaging, LLC. provides a **90-day limited warranty** from the date of shipment dispatched from Encore Packaging, LLC. The warranty excludes all wearing parts.

### 11.1 INSPECTION & PROCESS LOG

A daily log should be kept recording the usage, cleaning, and inspection processes of the EP-1345. At the end of each day review tool wear and performance, as well as clean tool parts as needed. This will help track the proper performance of the tool.

## 12. LIABILITY

## 13. COPYRIGHT NOTICE

This document is copyrighted in 2024 by Encore Packaging, LLC All rights are reserved. Encore Packaging, LLC, reserves the rights to make improvements to the products described in this manual at any time without notice.

No part of this manual may be reproduced, copied, translated, or transmitted in any form or by any means without the prior written permission of Encore Packaging, LLC Information provided in this manual is intended to be accurate and reliable. However, Encore Packaging, LLC assumes no responsibility for its use, nor for any infringements upon the rights of third parties which may result from its use.

## 14. LIMITED WARRANTY

This information supersedes any other warranty information contained with this new product. This warranty covers any product purchased after August 1st, 2022. Keep this warranty information with your purchase receipt.

The warranty obligations of Encore Packaging LLC., (Encore Packaging) for this product are limited to the terms set forth below:

### WHAT IS COVERED

Encore Packaging warrants that for a period of 3 (three) months from date of shipment for Encore Packaging tools or from date of product sold to Purchaser (Distributor) by Encore Packaging the tool or product will be free from defects in material and workmanship under normal usage.

### WHAT IS NOT COVERED

The limited warranty does not cover any damage, deterioration, or malfunction resulting from any alteration, modification, improper or unreasonable use or maintenance, misuse, abuse, accident, neglect, exposure to excess moisture, fire, improper packing, and shipping (such claims must be presented to the carrier), lighting, power surges, or other acts of nature. This excludes items indicated as (Wear Items or Wear Parts in Encore Packaging manuals) which will be warranted for the first 30 (thirty) days from date of shipment only. This limited warranty does not cover any damage, deterioration, or malfunction resulting from any unauthorized tampering with this product, any repairs attempted by anyone unauthorized by Encore Packaging to make such repairs, or any other cause which is not directly due to a defect in materials and/or workmanship of this product.

During said warranty period, Encore Packaging agrees to replace free of charge any Encore Packaging manufactured or purchased part or component which is determined to be defective. Encore Packaging may require that the defective part or component be sent to Encore Packaging or its designated authorized representative, freight or postage prepaid. If Purchaser requests that Encore Packaging remove and/or replace said part or component, Encore Packaging shall have the right to charge Purchaser for such work at Encore Packaging regular service rates. Repairs to tools and products must be made by an Encore Packaging authorized service representative; or in accordance with repair procedures set forth in the applicable Encore Packaging Product Service Manual. ([www.encorepack.com](http://www.encorepack.com))

Encore Packaging warrants that for a period of 30 (thirty) days from the date of services provided, the tools or products repaired will be free from defects in material and workmanship when under normal and intended use.

This Warranty extends only to the original purchase from Encore Packaging and is not transferable.

Encore Packaging warrants and represents that the tools or products when used in accordance with instructions provided by Encore Packaging will not infringe any patent or other proprietary right of any third party.

### DISCLAIMERS - THESE WARRANTIES ARE EXPRESSLY CONDITIONED ON

- A. Tools repaired by an authorized Encore Packaging service center representative.
- B. Purchaser following the Encore Packaging prescribed maintenance schedule, operating and other instructions, and the Encore Packaging safety manuals documentation.
- C. Tool repair only applies to those parts that are invoiced as part of the repair.

Failure to follow the above express conditions shall void all warranties otherwise applicable to the products, tools or services.

### DISCLAIMER OF FURTHER WARRANTIES

Encore Packaging warranties and representations are specifically limited to those set forth above. Encore Packaging makes no warranties or representations of merchantability or fitness for a particular purpose. Encore Packaging makes no other warranties express or implied. In no event shall Encore Packaging be liable for consequential, incidental, direct, indirect, punitive or special damages (including but not limited to loss of profits, business or goodwill, increased costs of operations, or cost of substitute goods) even if advised of the likelihood of such damages, whether or not based upon Encore Packaging negligence or breach of warranty or strict liability in tort or any other cause of action.

© 2024 Encore Packaging, LLC. All rights reserved.

*This page have been intentionally left blank*

# 15. PARTS LIST

## EP-1345 PARTS LIST

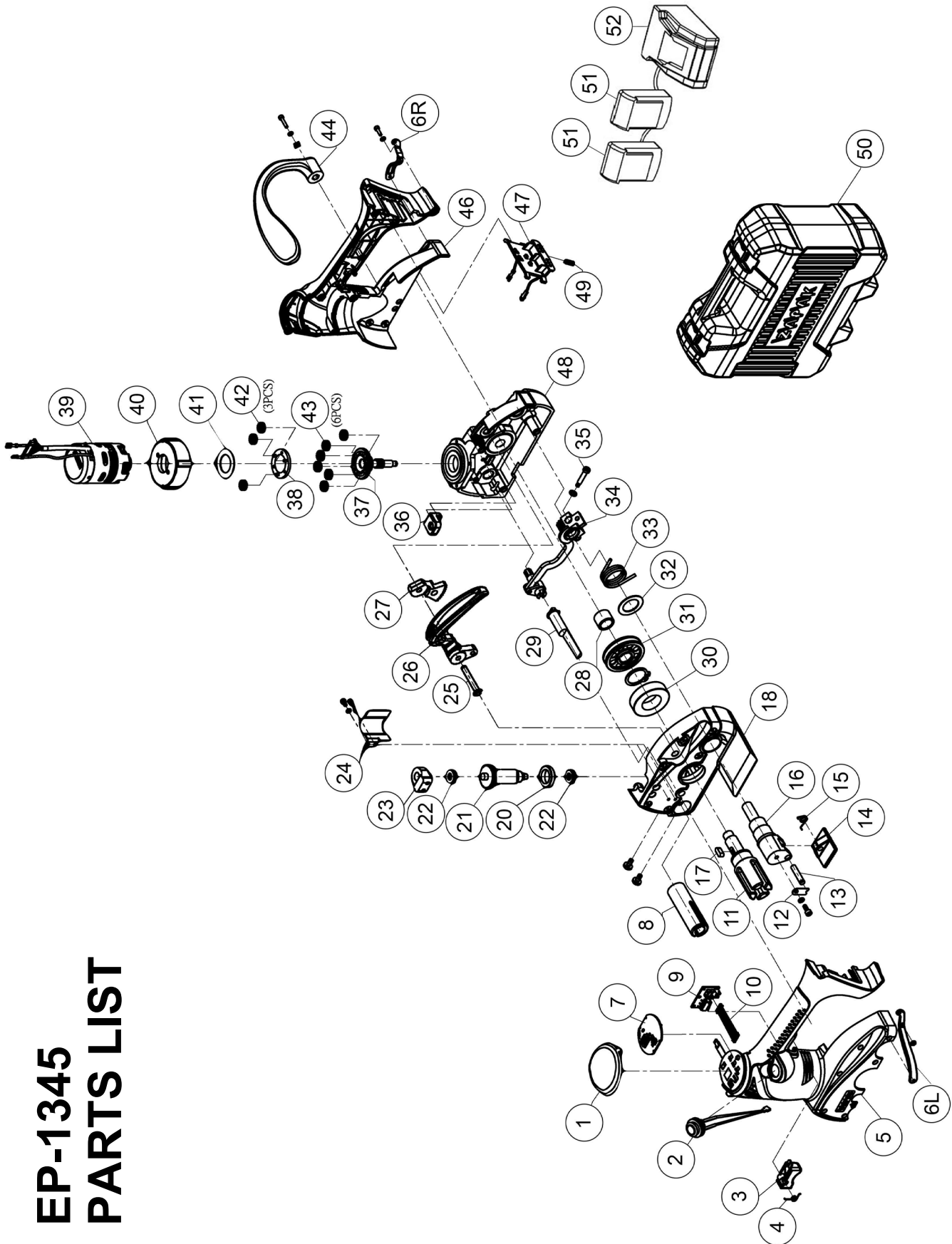

1/11/23 REV. B

# EP-1345 PART LIST

ITEM NO.	Part Number	DESCRIPTION	QTY.
1	E1345-01	Control Panel Cover	1
2	E1345-02	Reverse Button Assembly	1
3	E1345-03	Tension Trigger	1
4	E1345-04	Tension Button Spring	1
5	E1345-05	Left Housing Assembly	1
6L	E1345-06	Housing Bracket Set - Left (Sold as E1345-06 Set)	1
6R	E1345-06	Housing Bracket Set - Right (Sold as E1345-06 Set)	1
7	E1345-07	Electronic Control Unit (ECU)	1
8	E1345-08	Cutter Sleeve	1
9	E1345-09	Tension Switch Activator	1
10	E1345-10	ECU Wires	1
11	E1345-11	Windlass	1
12	E1345-12	Gripper Foot Pin Holder	1
13	E1345-13	Gripper Foot Pin	1
14	E1345-14	Gripper Foot	1
15	E1345-15	Gripper Foot Spring	1
16	E1345-16	Gripper Foot Shaft	1
17	E1345-17	Worm Wheel Position Key	1
18	E1345-18	Main Frame Assembly (Left)	1
20	E1345-20	Worm Bearing	1
21	E1345-21	Worm	1
22	E1345-22	Thrust Bearing	1
23	E1345-23	Worm Fastener	1
24	E1345-24	Worm Protection Cover	1
25	E1345-25	Operation Lever Axis	1
26	E1345-26	Operation Lever Assembly	1

ITEM NO.	PART NUMBER	DESCRIPTION	QTY.
27	E1345-27	Operation Lever Link	1
28	E1345-28	Windlass Sleeve	1
29	E1345-29	Cutter	1
30	E1345-30	Windlass Bearing	1
31	E1345-31	Worm Wheel	1
32	E1345-32	Gripper Foot Shaft Spring Spacer	1
33	E1345-33	Gripper Foot Shaft Spring	1
34	E1345-34	Cutting Drive Set	1
35	E1345-35	Gripper Foot Shaft Pin	1
36	E1345-36	Gear Base Fastener	1
37	E1345-37	Motor Epicyclic Gears Base Assembly	1
38	E1345-38	Deceleration Gears Base	1
39	E1345-39	Mechanism Generator	1
40	E1345-40	Motor Gears Holder Assembly	1
41	E1345-41	Gear Washer	1
42	E1345-42	Motor Epicyclic Gears (3pcs/set)	3
43	E1345-43	Motor Epicyclic Gears (6pcs/set)	6
44	E1345-44	Cutting Lever	1
46	E1345-46	Right Housing	1
47	E1345-47	Battery Contact Plate	1
48	E1345-48	Main Frame Assembly (Right)	1
49	E1345-49	Spring for Battery Contact Plate	1
50	E1345-50	Tool Case	1
51	E1260-28-D	Rechargeable 18v Li-Ion Battery	2
52	E1260-58	Battery Charger for 18v Li-Ion Battery	1

1/11/23 REV. B

*This page have been intentionally left blank*



*This page have been intentionally left blank*



MADE IN THE USA



P (847) 735-8105 | F (847) 735-8297  
sales@encorepack.com | www.encorepack.com

201 Park Avenue, Lake Villa, IL 60046  
P.O. Box 595, Winnetka, IL 60093