

522BPT2KD

# Double Bun Pan Truck

## Assembly Instructions

**PARTS:**

- (A) Base - 1 pc
- (B) Handle - 1 pc
- (C) Side Frames - 2 pcs
- (D) Center Frame - 1 pc
- (E) Casters (Wheels) - 6 pcs

**HARDWARE:**

- (F) M8×15 Bolts - 28 pcs
- (G) M8×35 Bolts - 7 pcs
- (H) M8 Nuts - 33 pcs

**TOOLS NEEDED:**

Wrench or socket (M8)

Verify that all components are included before assembly.

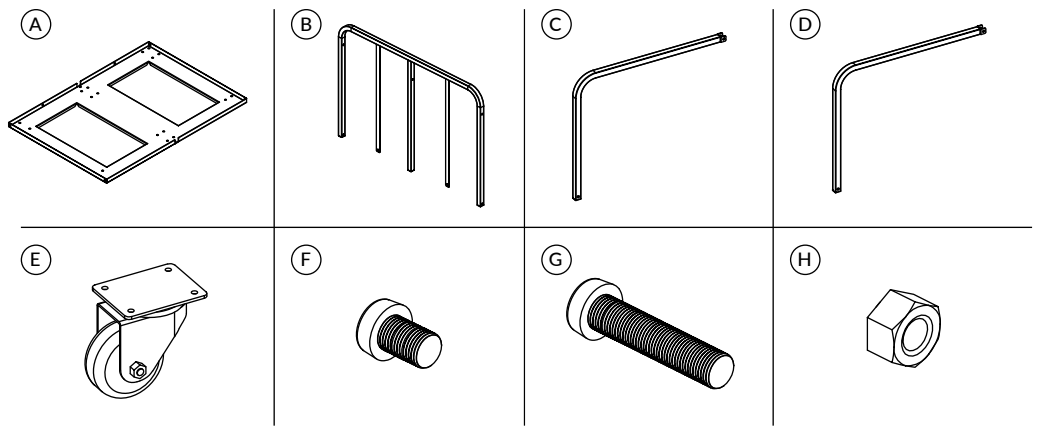
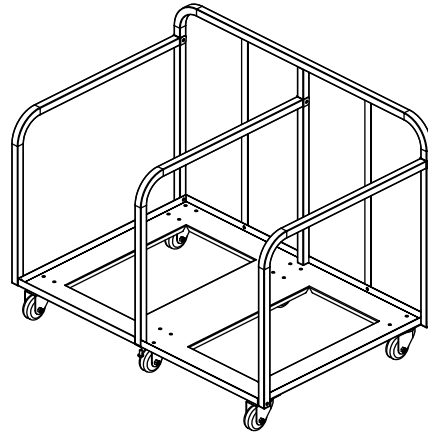

### Step 1: Install Casters on Base

1. Place the base (A) upside down. Locate the non-lipped side of the base. This is where the casters will go.
2. Insert all casters (E) into the designated holes on the base.
3. Secure them firmly by using 4 M8×15 bolts (F) and nuts (H) to lock in place.
4. Repeat Step 2-3 for all 6 casters.

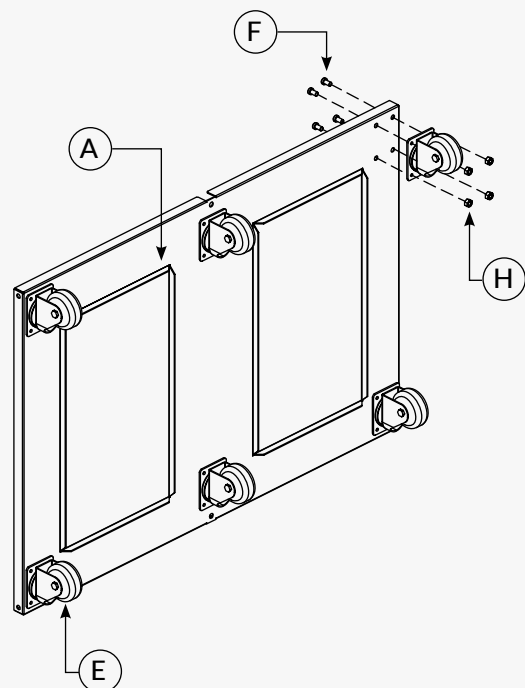

## Step 2: Attach Handle

1. Position the handle (B) at the top of the frame assembly. Align with the mounting points on the base.
2. Secure the front using 2 M8×15 bolts (F) and nuts (H). Secure the sides by using 2 M8×35 bolts (G) and nuts (H). Make sure the bolts for the side are placed facing outward.
3. Tighten evenly to ensure proper alignment.

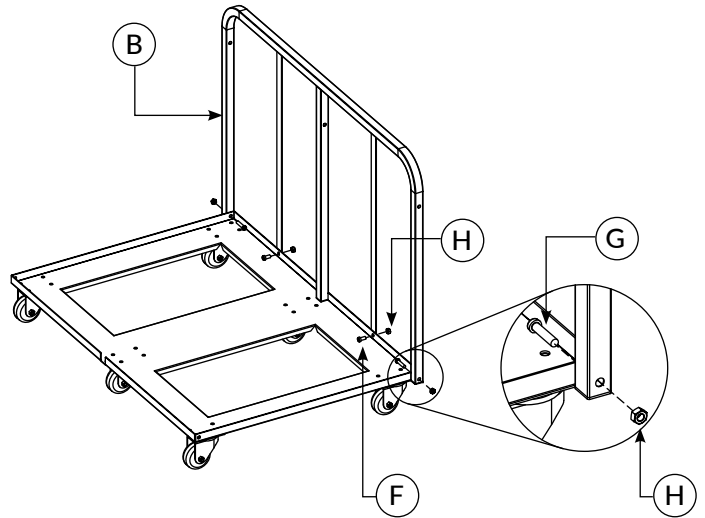

## Step 3: Attach Side Frames and Center Frame

1. Position the 2 side frames (C) and center frame (D) vertically onto the base. Align the mounting holes with the base.
2. Fasten the frames using 5 M8×35 bolts (G) and M8 nuts (H). Make sure the bolts are facing outward when placed.
3. Tighten evenly to ensure proper alignment.

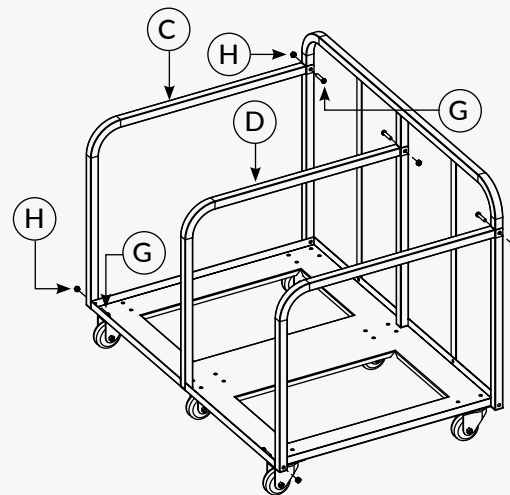

## Step 4: Insert Base Bolts

1. Flip cart on its side with the handle against the floor. Locate the middle casters.
2. Insert an M8×15 bolt (F) below each middle caster to fully secure base.
3. Fully tighten all hardware across the entire assembly.

## Final Assembly Check

- Ensure all bolts and nuts are tightened securely.
- Confirm that all 6 casters rotate freely.
- Check that the frame is square and stable.
- Stand the unit upright and test stability before use.

