

BOM TABLE		
ITEM NO.	DESCRIPTION	B4518001 QTY
1	SUITCASE BASKET, HINGE ROD	5
2	SUITCASE BASKET, COVER	2
3	SUITCASE BASKET, GRID	44
4	SUITCASE BASKET, HANDLE	2
5	SUITCASE BASKET, HINGE ROD SUPPORT TOP	2
6	SUITCASE BASKET, HINGE ROD SUPPORT BOTTOM	1

TABLE		
PART NO.	P/N REV	P/N ECN
B4518001	A	17975

UNLESS OTHERWISE SPECIFIED
DIMENSIONS ARE IN INCHES AND
TOLERANCES ARE:

.XX ± .063

.XXX ± .031

ANGLE ± .5°

NEXT ASSY:

USED ON:

STRE, SRTG

MATERIAL:

304 STAINLESS STEEL

FINISH:

ELECTROPOLISH

PROPRIETARY AND CONFIDENTIAL
THE INFORMATION CONTAINED IN
THIS DRAWING IS THE SOLE
PROPERTY OF PITCO FRIALATOR
INC. ANY REPRODUCTION IN PART
OR AS A WHOLE WITHOUT THE
WRITTEN PERMISSION OF PITCO
FRIALATOR INC. IS PROHIBITED.

Pitco

MagKitch'n

ANETS

PERFECT COMPANY

A DIVISION OF THE MIDDLEBY CORPORATION, P.O. BOX 501, CONCORD, NH 03302-0501

TITLE:

WIRE GOODS, SUITCASE 9 X 15
PRODUCT

PART NO:

SEE TABLE

SIZE

B

DWG NO:

B45-180

REV:

A

NOTES:

1. REMOVE ALL BURRS AND SHARP EDGES
2. WELD ALL PLACES WHERE WIRES INTERSECT
3. HINGE COVERS ARE TO ROTATE FREELY
4. WELD ITEM 4 TO ITEM 2 IN FOUR PLACES EACH

A	17975	J FINNIE	2/1/2018		
REV.	ECN	DRAWN BY	DATE	CHK	APPD
REVISIONS					

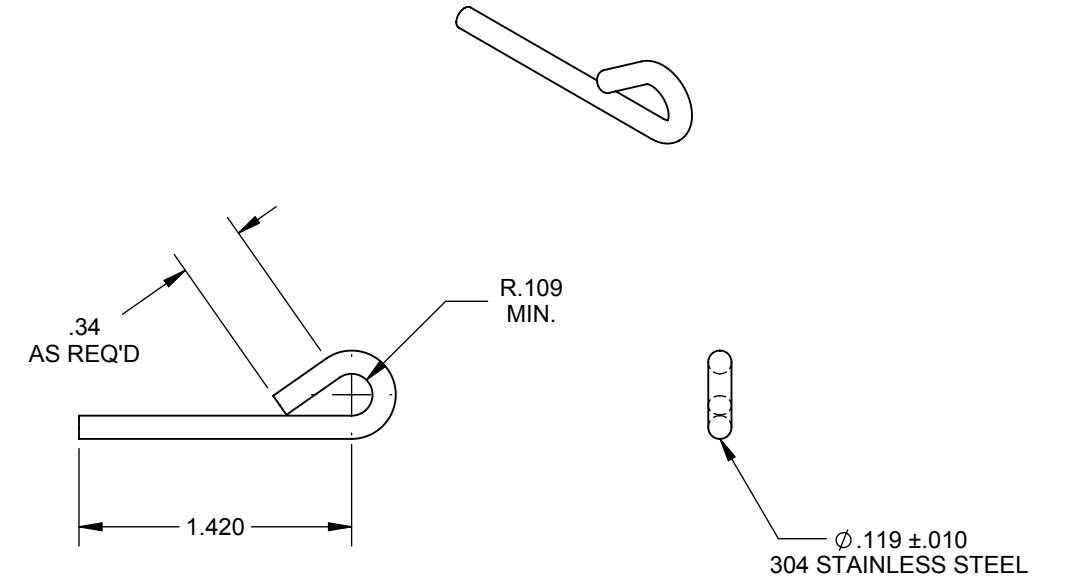
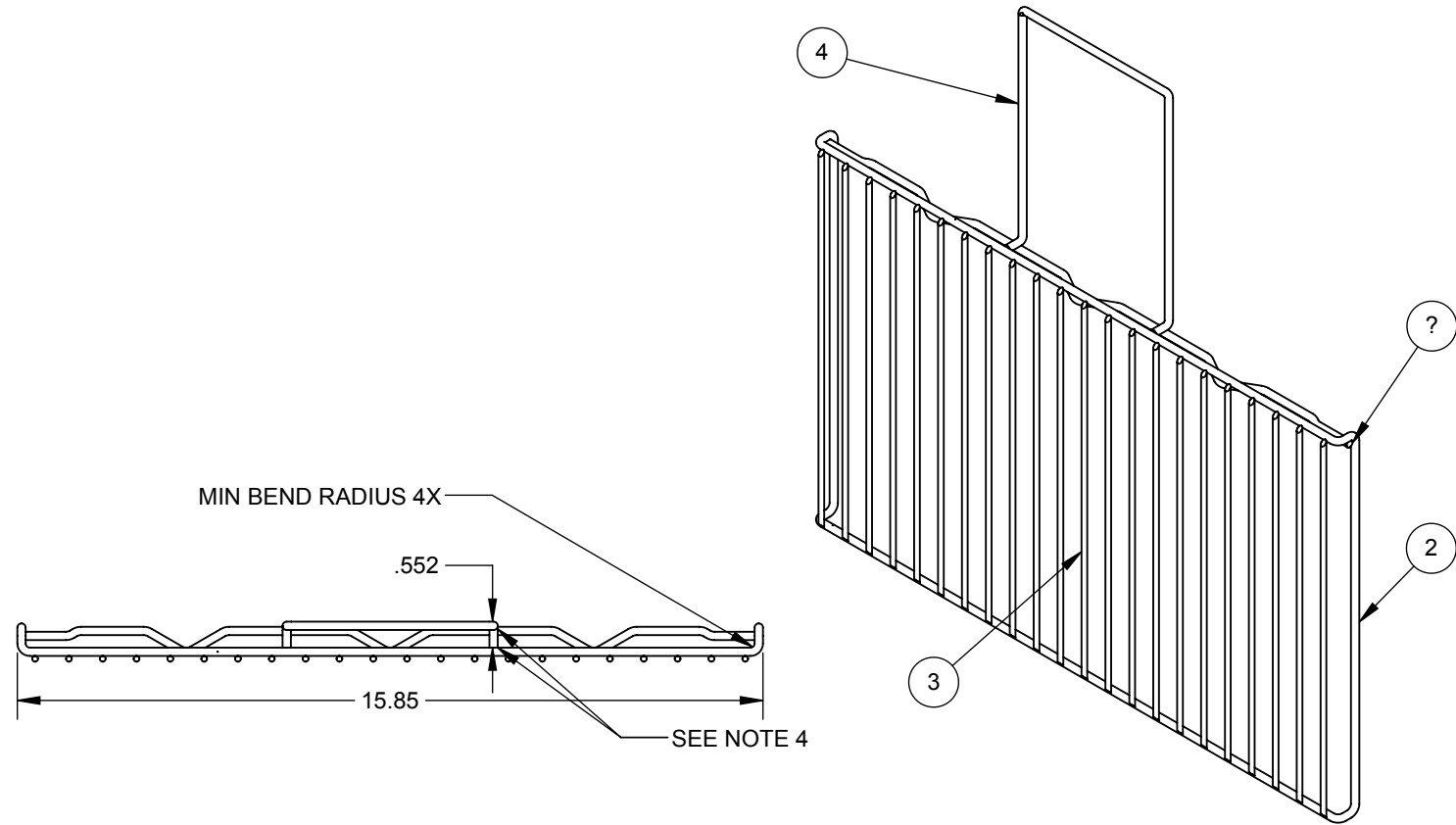

ITEM 1

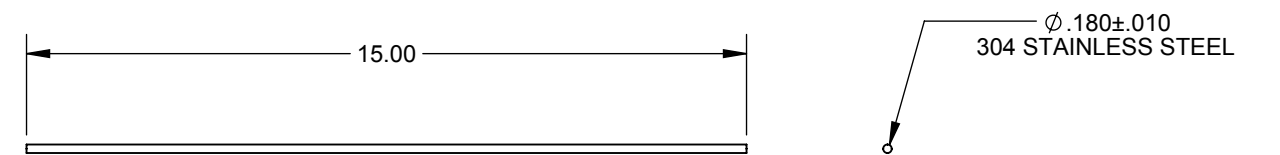
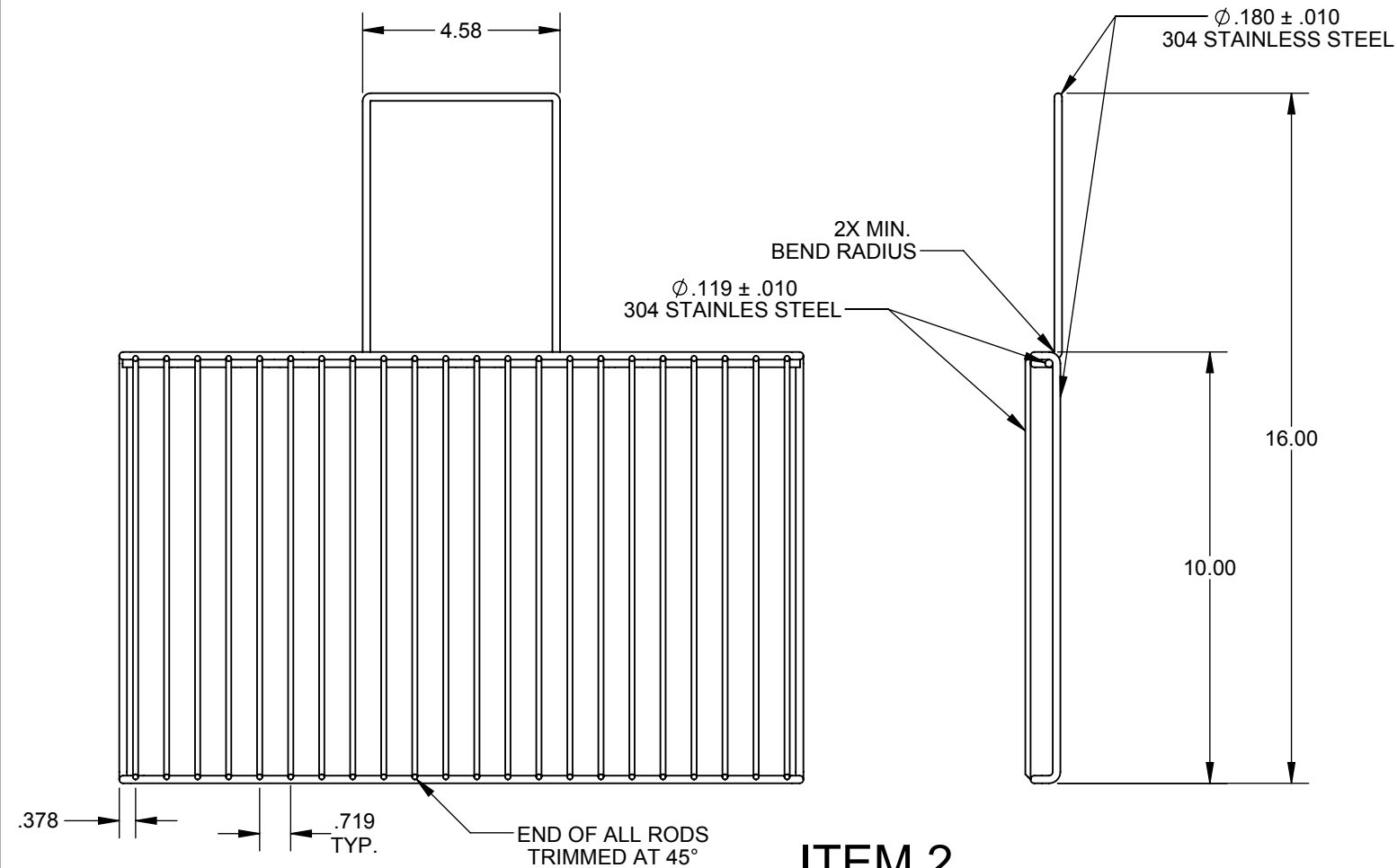

ITEM 6

PART NO: SEE TABLE	SIZE B	DWG NO: B45-180	REV: A
SCALE: 1:4	SHEET: 2 OF 3		

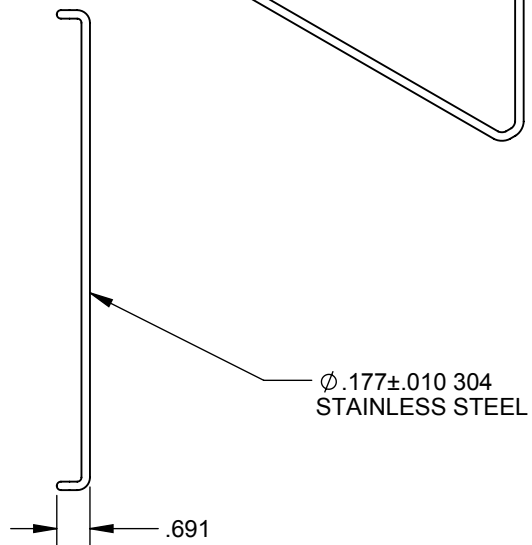
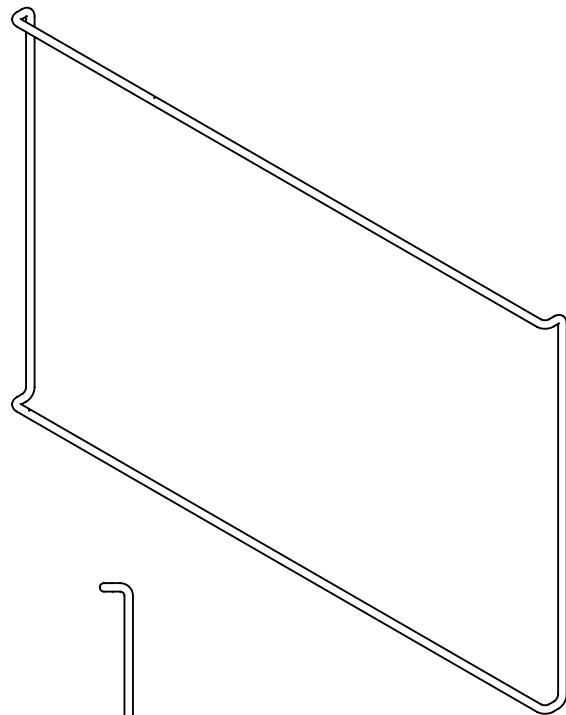
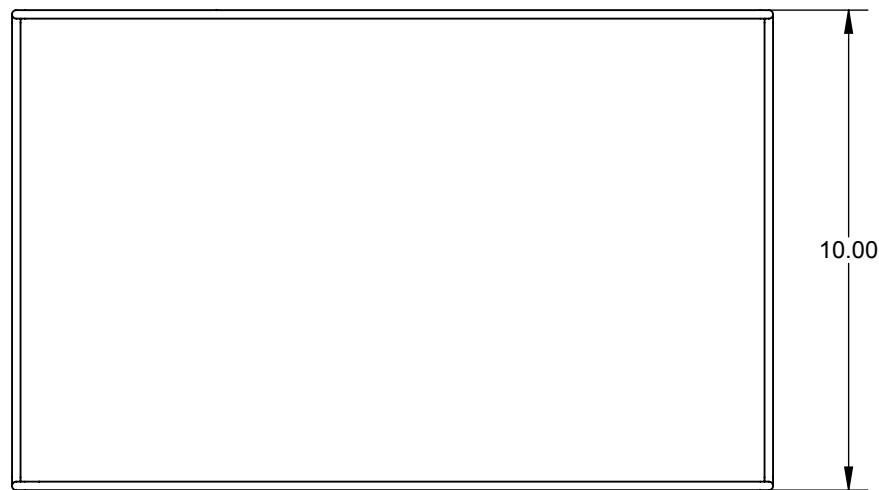
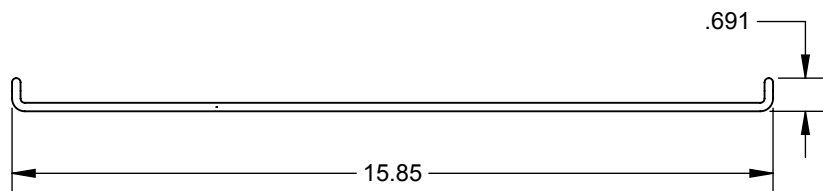

ITEM 2

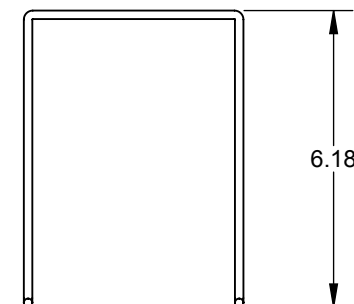
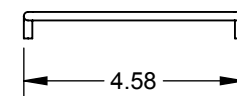

2X MIN BEND
RADIUS

.552

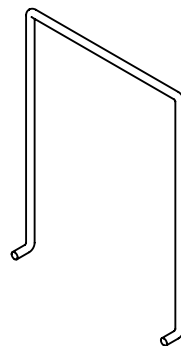

Ø.177±.010 304
STAINLESS STEEL

ITEM 4

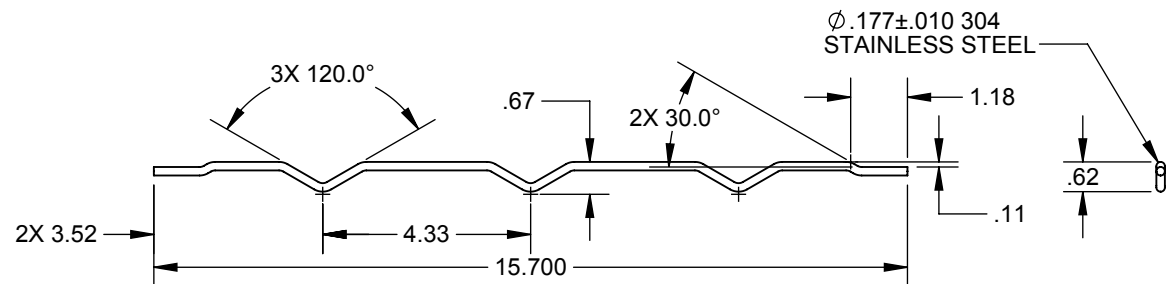

ITEM 5

Ø.120±.010 304
STAINLESS STEEL

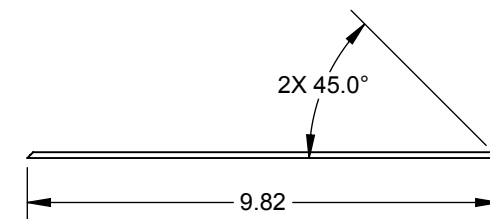

ITEM 3

PART NO: SEE TABLE	SIZE B	DWG NO: B45-180	REV: A
SCALE: 1:4	SHEET: 3 OF 3		