

PART NUMBER	COLOR	PMS COLOR
104973BL	BLUE	PMS 631
104973PR	PURPLE	PMS 682
104973OR	ORANGE	PMS 2023
104973GN	GREEN	PMS 2417
104973RD	RED	PMS 186
104973GY	GREY	PMS 431

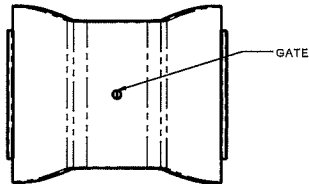

SECTION A-A  
SCALE 1:2

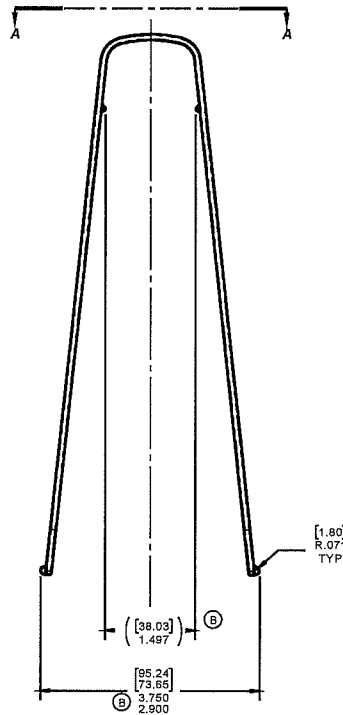

OUTSIDE SURFACE  
TO BE TEXTURED  
MT-11000

[1.57]  
R.062  
TYP

[75.63±.51]  
2.978±.020

[232.60]  
9.157

PARTNUMBER  
'104973' TO BE  
LOCATED AND  
RAISED .005 [0.13]  
AS SHOWN.

'SAN JAMAR' LOGO TO BE  
LOCATED AND  
RAISED .005" [0.13]  
AS SHOWN.

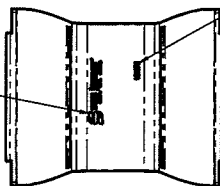

#### NOTES:

- 1.) THE SOLID GEOMETRIC MODEL ASSOCIATED WITH THIS DRAWING MUST BE REFERRED TO FOR FEATURES THAT CANNOT BE DETERMINED BY DIMENSIONS ON THIS DRAWING. TOLERANCE FOR GEOMETRIC FEATURES NOT DEFINED BY DIMENSIONS SHALL BE  $\pm 0.10$  [ $\pm 0.25$ ].
- 2.) OUTSIDE SURFACE TO BE TEXTURED MT-11000 AND SURFACE FINISH SPI #8-3.
- 3.) DIMENSIONS ACROSS A CENTERLINE ARE TO BE SYMMETRICAL ABOUT THAT CENTERLINE WITHIN ONE HALF THE TOTAL TOLERANCE.
- 4.) TOOLING DESIGN AND GATE LOCATION TO BE APPROVED BY SAN JAMAR PRIOR TO TOOL BUILD.
- 5.) PART TO BE FREE FROM BURRS, FLASH AND SHARP EDGES.
- 6.) EJECTOR PIN MARKS ARE NOT ALLOWED ON COSMETIC SURFACES.
- 7.) GATE VESTAGE TO BE TRIMMED FLUSH.
- 8.) UNLESS OTHERWISE SPECIFIED ON DRAWING, A MAXIMUM AMOUNT OF 10% RE-GROUND IS ALLOWABLE FOR MOLDED PARTS THAT ARE OPAQUE COLORS. NO RE-GROUND IS ALLOWABLE ON TRANSPARENT MOLDED PARTS.

#### MATERIAL:

NAME, BRAND, GRADE: POLYPROPYLENE, PRO-FAX, RP448S PP  
COLOR: SEE TABLE

APPROX. PART VOLUME: 5.63 CU.IN. [92.26 CU.CM]

APPROX. PART WEIGHT: 2.63 OZ. [81.65 GRAMS]

SHEET 1 OF 1

(XXX) 000 = INSPECTION DIM

ECN #	REV	REVISION DESCRIPTION	DATE	BY	DESIGNED IN INCHES [XXX] DIMS IN mm
E/L 3426	A	RELEASE FOR TOOLING	21.04.08	HLR	[XXX] DIMS IN mm
E/L 3432	B	UPDATED TOLERANCE PER PSW 784	21.07.08	HLR	[XX] ±.03 ±[9]
0000-00	C	DESC	YY.MM.DD	INT	[XXX] ±.010 ±[25]
0000-00	D	DESC	YY.MM.DD	INT	[XXX] ±.0002 ±[051]
0000-00	E	DESC	YY.MM.DD	INT	[XXX] ±.010 ±[25]
0000-00	F	DESC	YY.MM.DD	INT	[XXX] ±.010 ±[25]

**san jamar**  
smart. safe. sanitary.

**TENT MARKER, CFA**

DATE: 2021.03.19  
BY: HLR  
CHECKED BY: MGY  
DATE: 104973  
REV: B

#### CONFIDENTIAL

THIS DOCUMENT IS THE COPYRIGHTED WORK OF SAN JAMAR AND MAY NOT BE REPRODUCED WITHOUT THE EXPRESS WRITTEN AUTHORIZATION OF SAN JAMAR.  
\*NOTICE: UNCONTROLLED DOCUMENT WHEN PRINTED\*