

SOMERSET

CDR-2020 Dough Roller with Docker OPERATIONS MANUAL



WARNING

DO NOT CLEAN OR SERVICE THE MACHINE WITHOUT PRESSING THE RED BUTTON AND UNPLUGGING THE ELECTRICAL CORD FROM THE POWER SUPPLY. KEEP YOUR FINGERS AND HANDS FROM THE ROLLER AREA WHEN OPERATING OR SERVICING THE MACHINE. DO NOT OPERATE THE MACHINE WITHOUT THE GUARDS IN PLACE. IF THE MACHINE KEEPS RUNNING WITH SAFETY GUARDS REMOVED, IMMEDIATELY PRESS THE STOP BUTTON AND REMOVE THE PLUG FROM THE POWER SOURCE. CALL THE FACTORY OR A QUALIFIED SERVICE REPRESENTATIVE. DO NOT ATTEMPT TO OPERATE THE MACHINE UNTIL PERMITTED BY THE SERVICE TECHNICIAN.

SOMERSET INDUSTRIES INC.
137 PHOENIX AVE • LOWELL, MA. 01852 • USA

TEL: +1-978-667-3355
FAX: +1-978-671-9466

Email: somerset@smrset.com
Web: www.smrset.com

L020-200
REV B
DEC '22

THIS PAGE LEFT INTENTIONALLY BLANK

INSTALLATION INSTRUCTIONS

- a. Check the outside and the inside of the box for possible damage or marks.
- b. If visible or concealed damaged is noticed, contact delivery carrier and Somerset for freight claim and inspection. (Keep all crating materials).
- c. Cut off the fasteners that hold the machine to the base.
- d. Lift the machine from the base and place it on a solid supporting surface.
- e. **DO NOT PLUG THE MACHINE TO POWER AT THIS TIME.**
- f. Clean the machine as specified at “DAILY CLEANING” section.
- g. Plug the machine to the appropriate power as indicated by the nameplate.

PREPARATION AND SET UP.

The machine is calibrated at the factory as follows:

On the top handle, the dial points to the 4th line.

On the bottom handle, dial points to the 2nd line.

The operator can adjust the handles to the desired thickness by moving the handles.

Always verify that the ratio between the top and bottom setting is 2 to 1.

For example if the top dial points to 6th line, the bottom should point to the 3rd line.

For best results, the dough to be rolled should be at room temperature.

The size and shape of the dough ball affects the size and shape of the finished crust. For round crusts, take a round piece of dough and flatten it slightly.

Dust the dough pieces with flour before putting them in the machine.

Press the **GREEN** button, to **START** the machine.

Press the **RED** button, to **STOP** the machine.

For the machine to operate verify:

1. All scrapers are installed & secured properly.
2. The safety cover is closed & secured with the two thumbscrews.
3. The “Emergency stop” (E-Stop) switch is “reset”, (turn clockwise to verify).

OPERATION

Press the “**Emergency Stop**” in case of **emergencies only**.

Step 1:

Insert the dough into the chute, Fig.1

The dough passes through the rollers and exits with an oblong shape, Fig.2.



Fig.1



Fig.2

Step 2:

Rotate the dough 1/4 of a turn (90 degrees) Fig.3

Push it towards the rollers, (second pass) Fig.4



Fig. 3



Fig. 4

Step 3:

Pick up the stretched dough (round shape) Fig. 5



Fig. 5

The dough will exit
this pass docked.

The rollers are easily adjustable to any thickness of pizza dough or crust you may need.

For example, if making a 10 inch diameter of dough, set the top roller to the setting that will produce a 10 inch long piece of dough

Lock the top setting and set the bottom dial to half that of the top. Depending on your dough, you may have to move the bottom roll setting back and forth to achieve the perfect round shape.

**If dough does not slide easily on the discharge trays,
dust the trays with flour.**

If the dough tears or the machine makes a thumping sound, this may be due to a thin roller setting or the dough may be too cold and stiff and may require a longer rest period before use.

!!WARNING!!

- Never operate the machine without the guards, safety cover, or scrapers in place!
- Keep your hands and fingers away from the chute!
- Never force the dough down into the chute with your hands!
- If the dough gets stuck:
 1. Press the red switch to stop the machine.
 2. Unplug the machine from power.
 3. Open the safety cover.
 4. Remove the dough
- Use the **EMERGENCY STOP (E-STOP)** only for **emergencies**
- Never use oil or grease on any of the mechanical parts of the machine

TIP: If your application requires oblong pieces of dough, do not rotate the dough for the second pass.

Cleaning Docker CDR 2020

Removing/Installing Docker Assembly

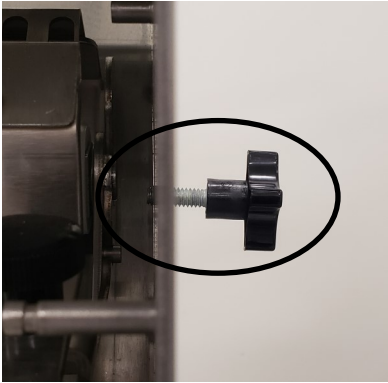

- Loosen (Do not remove) knob.
- Slide Docker Assembly to the right of the machine and lift up.



- Tilt left side of Docker down first to remove from the machine.
- Set Docker Assembly on safe surface. (Be cautious not to drop or damage Assembly.)

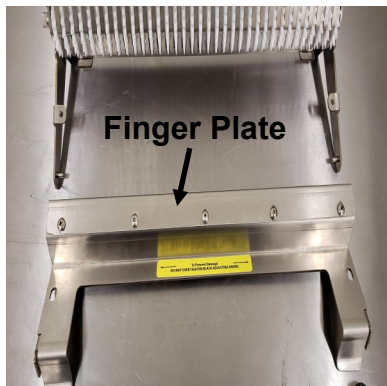

- Locate and remove two black knobs from Finger Plate.
- Lift and remove from Docker.

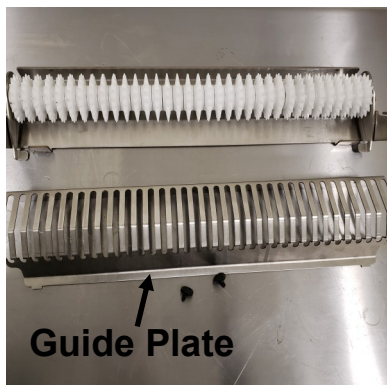

- Remove two small black knobs securing the Guide Plate.
- Lift and remove Guide Plate from Docker.

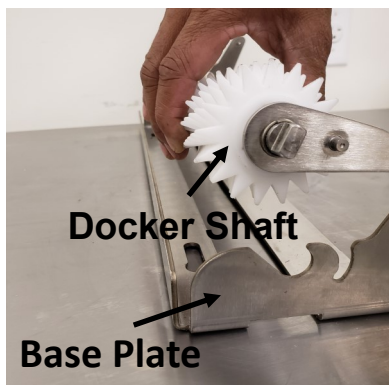
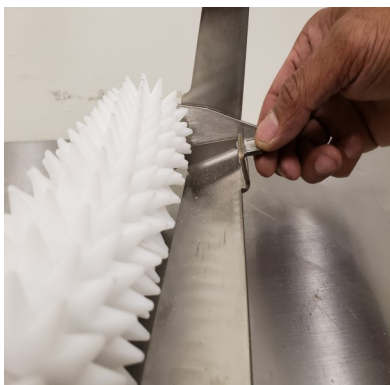

- Unlatch Docker Shaft from the Base Plate.
- Lift and remove Docker shaft.
- Remove all flour and dough build up from Assembly and Parts.



- After cleaning, reinstall Docker Shaft onto the Base Plate.
- Ensure the shaft is locked into place.



- Reinstall Guide Plate. Ensure Guide Plate tabs are aligned as shown.
- Secure Guide Plate to Docker with small knobs.

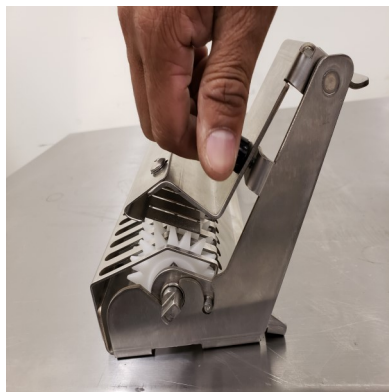

- Reinstall Finger Plate onto the Docker.
- Secure with both Knobs.



- To reinstall Docker Assembly tilt left side down first and then into the machine.
- Place Docker Assembly into machine.

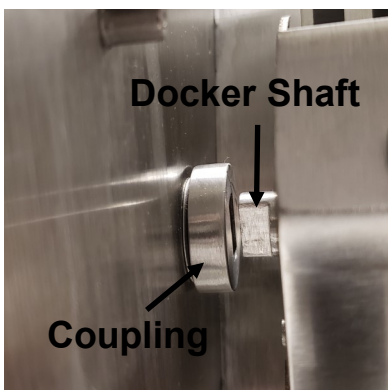

- Ensure that the Docker Shaft is secured into the Coupling of the Machine.
- Retighten knob on the side of the machine. (Do not Overtighten)



- Once all parts have been reinstalled. Run machine to ensure proper operation.

Removing and Installing Scraper Blades

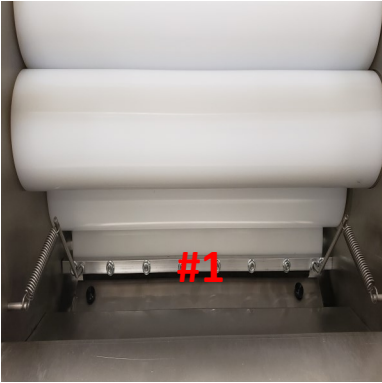

- Locate #1 Scraper blade behind the machine.
- Unhook both springs from the machine's stud. Lift scraper blade out.



- Locate #2 and #3 Scraper blade at the front of the machine.
- Unhook both springs of Scraper #2 from Scraper #3.



- Slide Scraper #3 out.
- Lift the Scraper #2 out of the machine.



- Locate and unhook Scraper #4 springs.
- Lift and remove from Machine.



- Locate studs on machine for Scraper #1 Placement
- Place Scraper #1 in position shown.
- Hook #1 Scraper springs to the long studs.



- Place Scraper #2 on studs of the machine.
- Slide Scraper #3 into place. Align with studs and support up.
- Hook Scraper #2 springs to Scraper #3 studs.



- Scraper #2 and #3 final position as shown in picture.

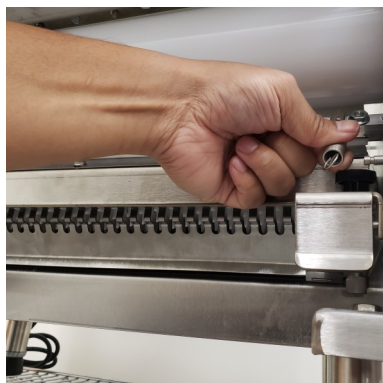

- Place Scraper #4 onto studs of machine.
- Hook both springs to long studs as shown.
- All Blades should be flush to the Rolls they are in contact with. If not, double check positioning or condition of the Blade.

DAILY CLEANING

- After all the Scrapers are removed:
 1. Wipe the rolls with a clean cloth
 2. Apply a thin film of cooking oil with a damp cloth.
 3. Brush or wipe the sides of the machine and the trays
 4. Clean all the scrapers and verify they are not worn
 5. All beveled edges should be smooth and not knicked.
 6. Install the scrapers in the opposite order of removal.
 7. Close the safety cover and secure it with the two thumb screws.
 8. Press the green start switch when the machine is ready to use.

- ♦ Equipment food-contact surfaces should be clean to sight and touch.
- ♦ Equipment food-contact surfaces should be sanitized.

Quick Tips & Troubleshooting

If the machine does not start:

1. Check if the AC Power is available
2. Is the plug connected?
3. Make sure the cover is down securely
4. All scrapers are installed properly

If rolls ever start to squeal due to dryness, remove and clean the scraper blades thoroughly and rub the beveled edge with cooking oil, like vegetable or canola. This technique will remove the squealing sound you get from friction between the roller and a dry scraper.

L065-200 - CDR-2020 PARTS LIST
REV A - 09 DEC 22

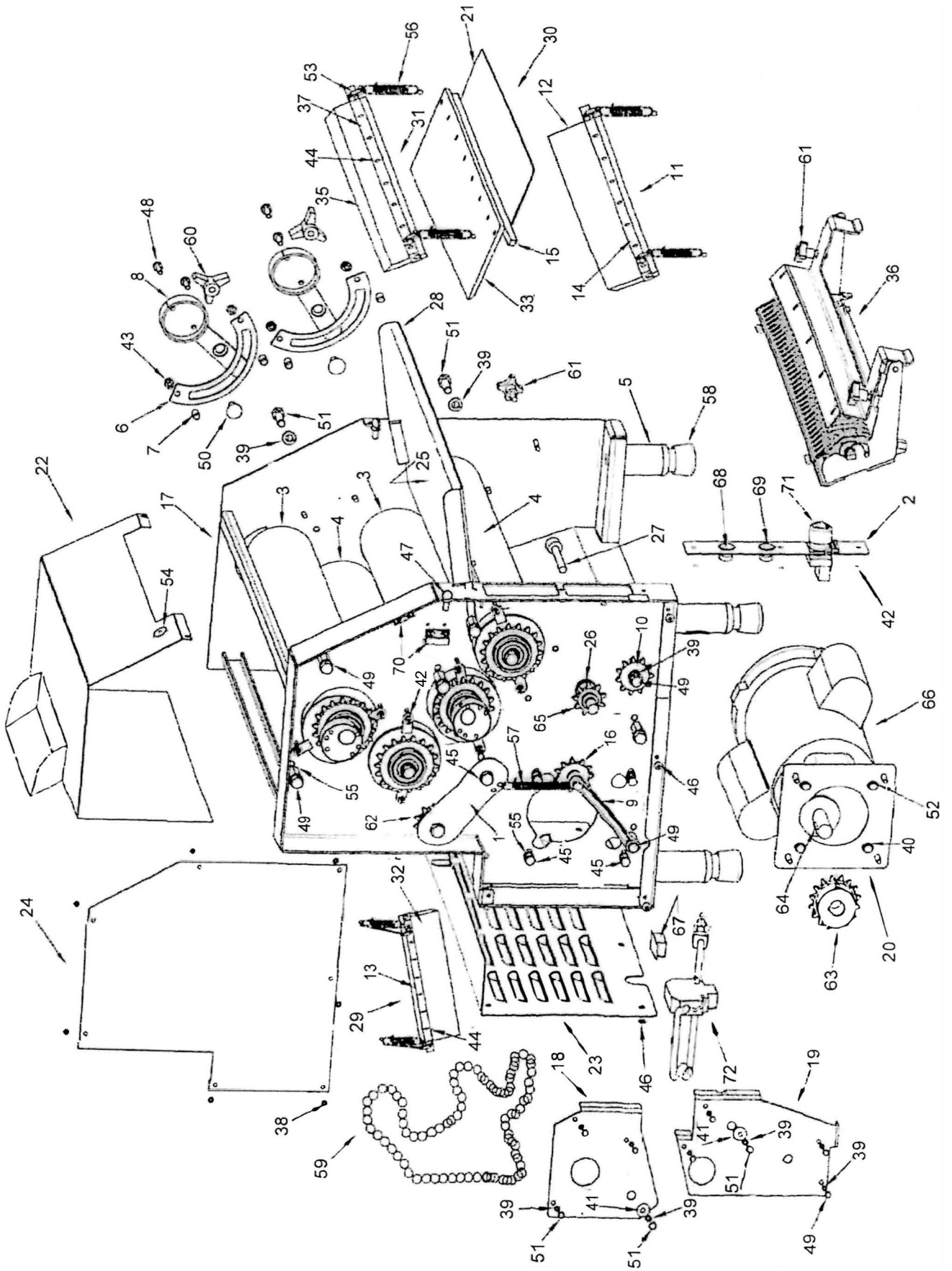

ITEM	P/N	DESCRIPTION	QTY
1	2000-230	PLATE TAKEUP SUPPORT, SST	1
2	2000-335	PLATE, P.B, SWITCH AND E-STOP, SST	1
3	2000-400	ROLL ASM UPPER UHMW 20" (SA)	2
4	2000-402	ROLL ASM MIDDLE UHMW 20"	2
5	2000-415	LEG ASM COMPLETE	4
6	2000-417	PLATE, ADJUSTING	2
7	2000-418	SPACER, TUBING	4
8	2000-423	HANDLE, ROLL ADJUST	2
9	2000-428	ARM, IDLER	1
10	2000-430	SPROCKET 41B11H IDLER	1
11	2000-501	SCRAPER COMPLETE #2 (2000)	1
12	2000-511	SCRAPER #2	1
13	2000-520	SHAFT SCRAPER #1	1
14	2000-521	SHAFT SCRAPER 2000#2, 2100#4	1
15	2000-522	SHAFT SCRAPER #3	1
16	2000-630	SPROCKET IDLER W/ BUSHING	1
17	2020-010	WELDMENT, FRAME CDR-2020 MAIN	1
18	2020-015	TOP ECCENTRIC LATE, SST	1
19	2020-017	ECCENTRIC PLATE, SST	1
20	2020-044	PLATE, MOTOR MOUNT, SST	1
21	2020-046	SCRAPER ROLL GUARD, SST	1
22	2020-120	COVER, SAFETY, COMPLETE, 2020	1
23	2020-301	PANEL, LOUVERED, COMPLETE, 2020, SST	1
24	2020-302	COVER HOUSING, 2020, SST	1
25	2020-304	ASSY, BOARD INTAKE, DRILLED	1
26	2020-430	SPROCKET, MACH, DOCKER	1
27	2020-444	DRIVE COUPLING, DOCKER	1
28	2020-452	WELDMNT, TRAY INTAKE	1
29	2020-500	SCRAPER COMPLETE #1 (2020)	1
30	2020-502	SCRAPER, COMPLETE #3 (2020)	1
31	2020-503	SCRAPER, COMPLETE #4 (2020)	1
32	2020-510	SCRAPER #1 (2020)	1
33	2020-512	SCRAPER #3	1
34	---	RESERVED	1
35	2020-513	SCRAPER # 4	1
36	2020-703	ASSY, DOCKER INSERT	1

ITEM	P/N	DESCRIPTION	QTY
37	2100-520	SHAFT SCRAPER #1,500#2,3,700#2	1
38	3000-101	WASHER, LOCK INT TOOTH #10	8
39	3000-103	WASHER, LOCK SPLIT 3/8	16
40	3000-106	WASHER, LOCK SPLIT 1/4	4
41	3000-201	WASHER, FLAT 3/8	2
42	3000-300	NUT, FLANGE 8-32	15
43	- - - -	RESERVED	-
44	3000-303	NUT, FLANGE 1/4-20	16
45	3000-304	NUT, HEX 1/2-20	2
46	3000-402	SCREW, 10-32 X 3/8 TRUSS PH SST	16
47	3000-403	SCREW, 1/4-20 X 1/2 THUMB W/SHOULDER	2
48	3000-404	SCREW, 1/4-20 X 3/4 HEXHD	4
49	3000-405	SCREW, 5/16-18 X 1/2 HEXHD	14
50	3000-408	SCREW, 3/8-16 X 3/4 CARRIAGE BOLT	2
51	3000-409	SCREW, 3/8-16 X 1 HEXHD SS	6
52	3000-417	SCREW, 1/4-28 X 3/4 HEXHD	4
53	3010-100	STUD, SCRAPER 21/32 BENT	1
54	4000-150	MAGNET, SAFETY	1
55	4000-233	SPACER, HEX .5 X 1.0	3
56	4000-251	SPRING, SCRAPER, 2.25"	2
57	4000-252	SPRING, EXTENSION, 4.0"	1
58	4000-300	LEG TIP RUBBER	4
59	4000-367	CHAIN, 41 RIV 117 INCL C/L (2020)	1
60	4000-400	KNOB, LOCKING	2
61	4000-403	KNOB, DIE SECURING 3/4 STUD	3
62	4000-501	SPROCKET 41B11H TAKEUP	1
63	4000-502	SPROCKET 41B16H X 3/4 W/ KEY	1
64	4000-531	KEY, 3/16" X 3/16" X 7/8" LG	1
65	4000-572	BEARING, FLANGED, 2020 DOCKER	1
66	5000-125	GEARMOTOR, 2/3 HP, 50/60HZ, 115/230VAC	1
67	5000-150	RELAY, 120V	1
68	5000-202	SWITCH, POWER RED MEMBRANE	1
69	5000-203	SWITCH, POWER GREEN MEMBRANE	1
70	5000-225	SENSOR, REED SWITCH	2
71	5000-226	SWITCH, E-STOP	1
72	5000-230	HARNESS, POWER MOLDED	1

ELECTRICAL DIAGRAM CDR-2000, CDR-2500, CDR-2020

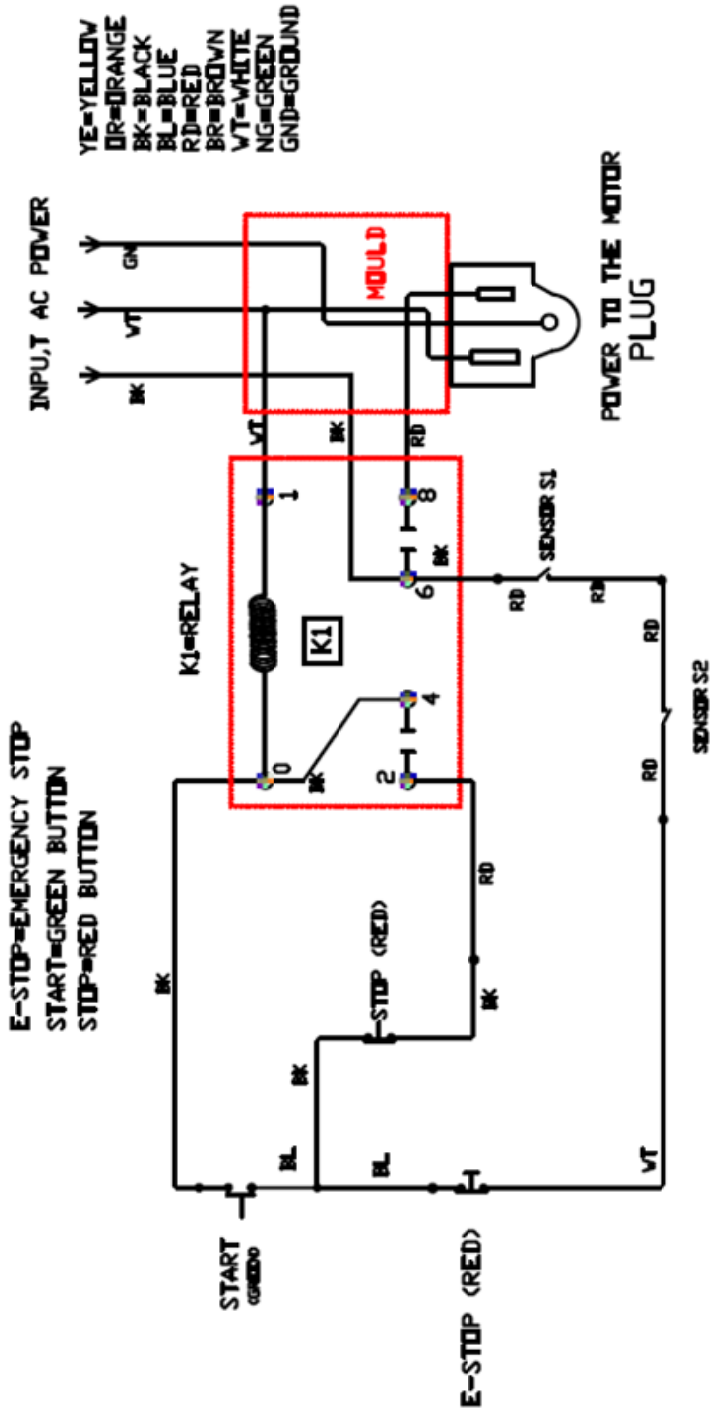

BISON MOTOR

MOTOR CONNECTIONS
FOR 115V 50/60Hz

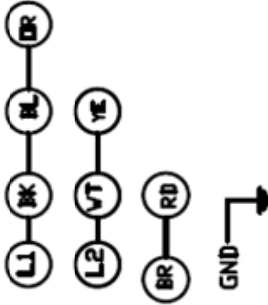

MOTOR CONNECTIONS
FOR 220V 50/60Hz

