

Cashier Stand

ASSEMBLY INSTRUCTIONS



LANCASTER
TABLE & SEATING

CONTENTS

1 Side Board 1/PC

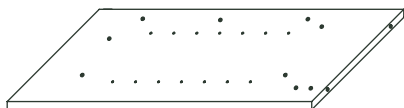

2 Side Board 1/PC

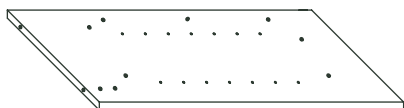

3 Top Board 1/PC



4 Kickplate 1/PC



5 Back Board 1/PC

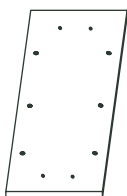

6 Adjustable Shelf 1/PC



7 Bottom Board 1/PC

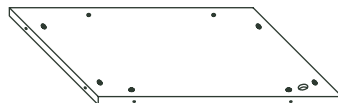

8 Drawer - Bottom Piece 1/PC



9 Drawer - Side Piece 1/PC



10 Drawer - Side Piece 1/PC



11 Drawer - Front Board 1/PC

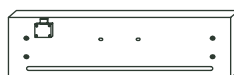

12 Drawer - Back Board 1/PC



13 Drawer Handle 1/PC

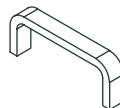

HARDWARE

A Cam Lock Screw 32/PCS



B Cam Lock 32/PCS



C Screws 18/PCS



D Shelf Peg 4/PCS



E Screws for drawer handle 2/PCS



F Drawer Track 2/PCS



G Drawer Lock Catch 1/PC



H Keys 2/PCS



I Grommets 3/PCS



NOTES

1. Inspect all pieces for damage before assembly. Do not assemble if any pieces are broken or damaged. Ensure you have all required pieces before assembly.
2. Recommend: 2 people for assembly. Do not overtighten screws.
3. Weight capacity: top shelf - 55 lb., middle shelf - 55 lb., bottom shelf - 75 lb.
4. Philips head screwdriver required for assembly (not included).

Cashier Stand

ASSEMBLY INSTRUCTIONS



LANCASTER
TABLE & SEATING

STEP 1

Insert grommets (J) into top board (3), adjustable shelf (6), and bottom board (7). Make sure openings are aligned in the same direction on each board.

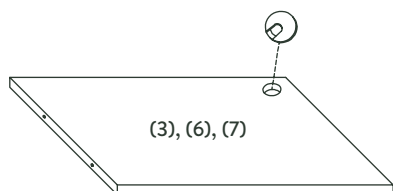

STEP 3

Divide drawer tracks (F) into two parts, F1 & F2.

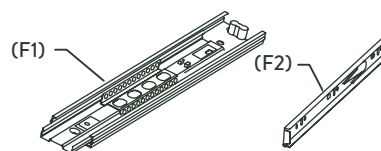

STEP 2

Using a Philips head screwdriver, insert 9 cam lock screws (A) into side boards (1) and (2). Insert 4 cam lock screws (A) into back board (5). Insert 2 cam lock screws (A) into bottom board (7). Using 2 screws (C) attach drawer lock catch piece to predrilled holes on top board (3).

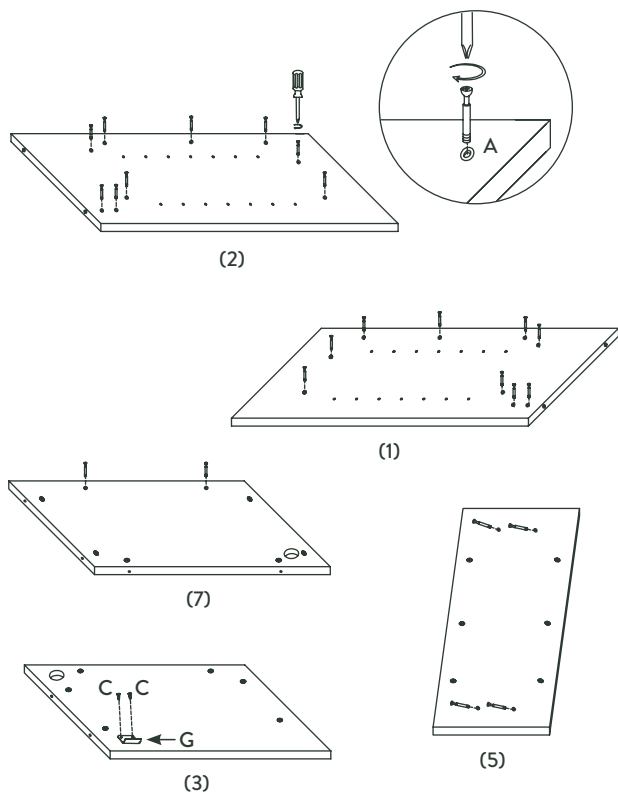

STEP 4

Attach larger piece of drawer track (F1) to predrilled holes in side board (1) using 4 screws (C). Track should be 19 mm in from end of side board (1). Repeat with second drawer track piece (F1) and side board (2).

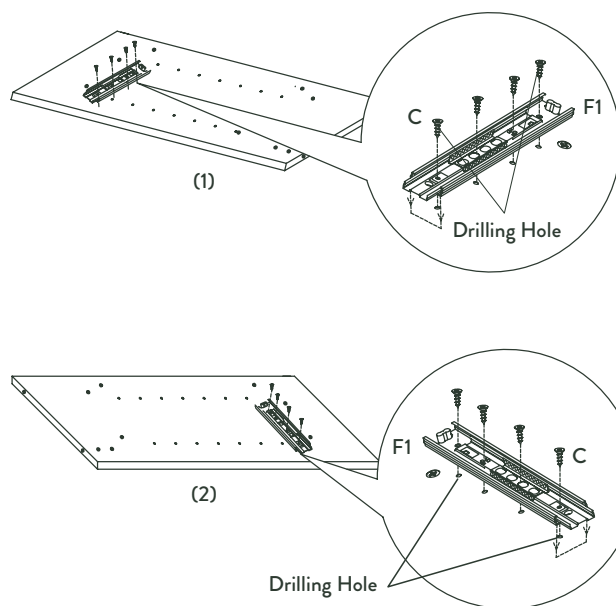

Cashier Stand

ASSEMBLY INSTRUCTIONS



LANCASTER™
TABLE & SEATING

STEP 5

Attach smaller part of drawer track (F2) to the predrilled holes in drawer side piece (9) using 4 screws (C). Edge of track should line up with the edge of the board that has two holes for cam locks. Repeat with second drawer track piece (F2) and drawer side piece (10).

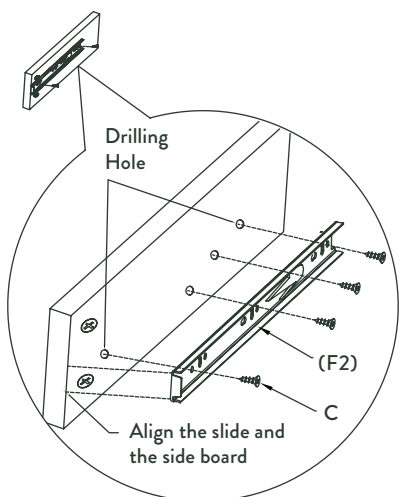

(9)

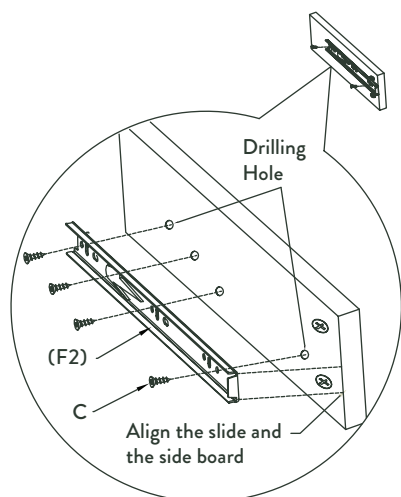

(10)

STEP 6

Insert 6 cam locks (Bx24) each back board (5), top board (3), bottom board (7), and into kick board (4).

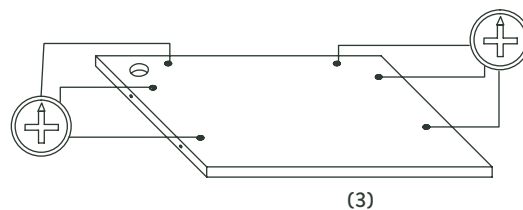

(3)

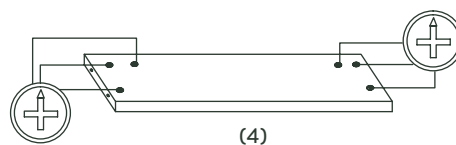

(4)

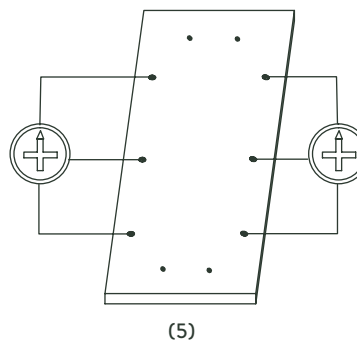

(5)

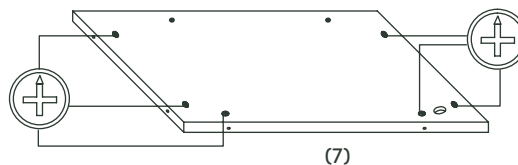

(7)

Cashier Stand

ASSEMBLY INSTRUCTIONS



LANCASTER
TABLE & SEATING

STEP 7

Lay back board (5) flat on ground. Attach top board (3) by lining up two cam lock screws (A) on back board (5) with the 2 cam locks (B) on the top board (3). Cam locks (B) should face bottom of stand. Tighten cam lock (B) with screwdriver. Repeat with bottom board (7), cam locks (B) should face bottom of stand. Attach kick plate by lining up cam locks (B) with the 2 cam lock screws (A) on the bottom side of the bottom board (7), cam locks (B) should face the inside of the stand. Tighten cam locks (B).

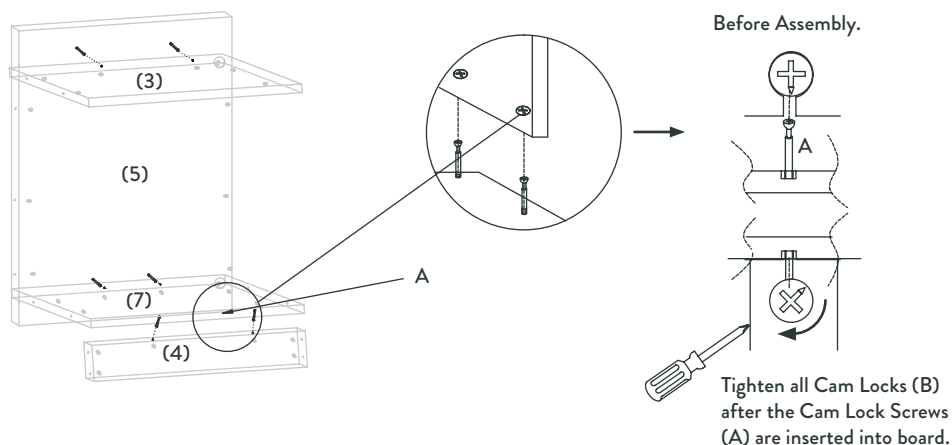

STEP 8

Attach side board (1) to back board (5) assembly by lining up cam lock screws (A) on side board (1) with cam locks (B) on back board (5), top board (3), bottom board (7), and kick plate (4). Tighten cam locks (B) with screwdriver. Repeat for side board (2).

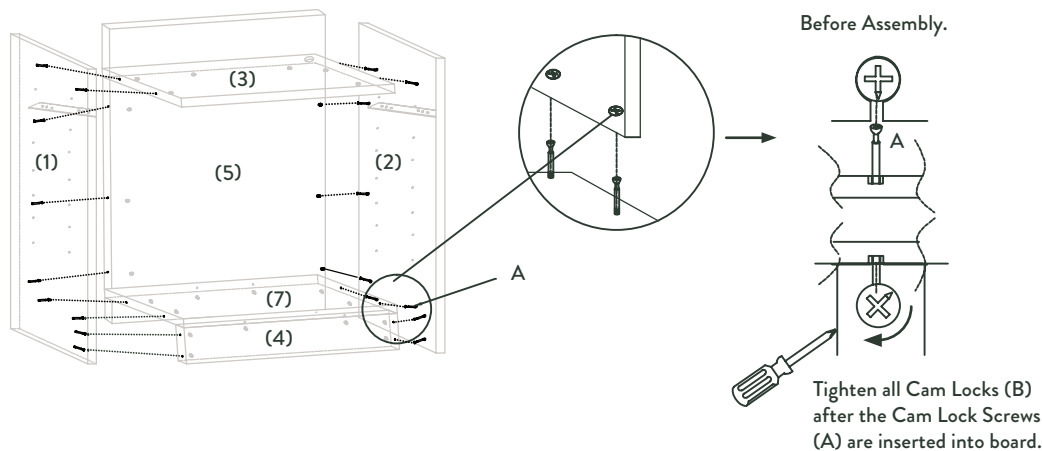

Cashier Stand

ASSEMBLY INSTRUCTIONS



LANCASTER™
TABLE & SEATING

STEP 9

Insert 4 cam locks (B) into drawer back piece (12). Insert 4 cam lock screws (A) in predrilled holes on drawer front piece (11).

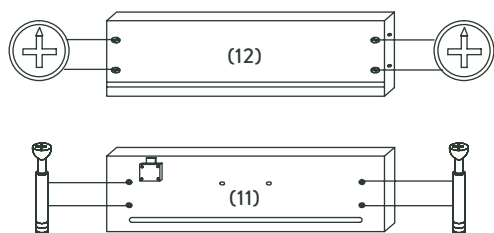

STEP 10

Insert 2 cam lock screws (A) into predrilled holes on drawer side piece (9) on the opposite side of the drawer track. Insert 2 cam locks (B) on the same side as the drawer track. Repeat for drawer side piece (10).

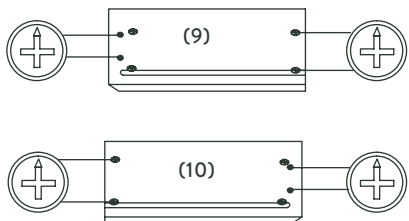
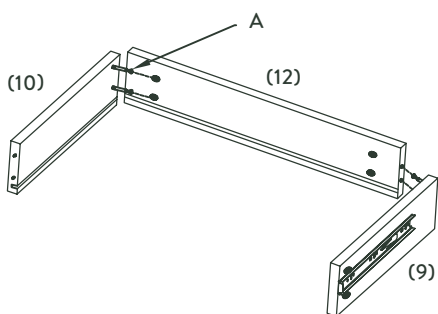

STEP 11

Assemble drawer by lining up cam screws (A) on drawer side piece (10) with drawer back piece (12). Tighten cam locks (B) with screwdriver. Repeat with drawer side piece (9). Slide drawer bottom (8) into grooves on bottom of assembly.

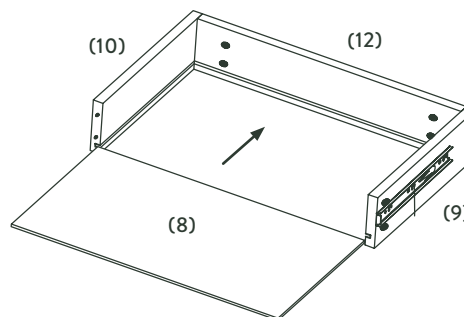
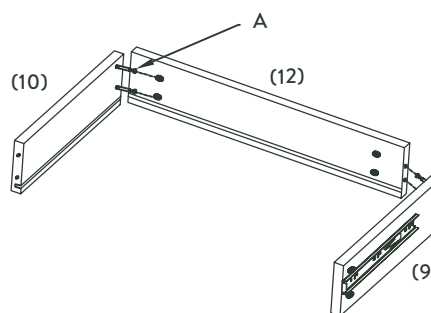

Cashier Stand

ASSEMBLY INSTRUCTIONS



LANCASTER™
TABLE & SEATING

STEP 12

Attach drawer front piece (11) by lining up 4 cam screws (A) to cam locks (B) on drawer sides. Tighten with screw driver.

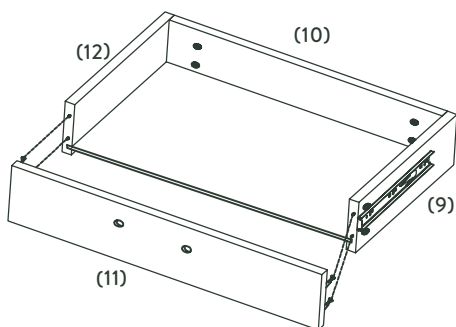

STEP 13

Attach drawer handle by using two screws (E) from the inside of the drawer. Tighten with screwdriver.

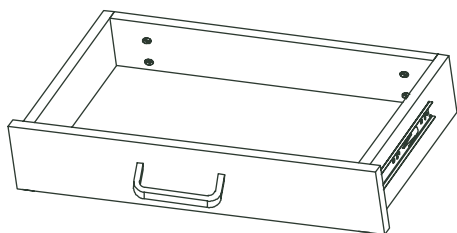

STEP 14

With two people, turn stand right side up. Insert drawer into track. Use 4 shelf pegs (D) to set height of adjustable shelf (6). Place adjustable shelf (6) on top of drawer pegs.

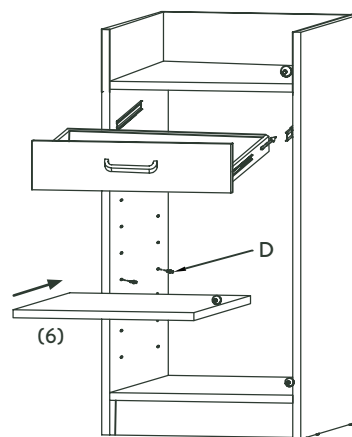

CLEANING AND MAINTENANCE

- Check for damages or loose attachments monthly.
- Clean with a mild cleaner, using a soft, clean cloth. Dry immediately.