

# **BuffetBoost™ LumaLamp Instruction Manual**



## IMPORTANT SAFETY INFORMATION

Read all instructions before use.

**⚠ WARNING – ELECTRICAL SHOCK HAZARD.** Failure to follow these instructions could result in electric shock, serious injury, or death.

- Use only the supplied BuffetBoost AC adapter/charger, approved BuffetBoost battery, and BuffetBoost PowerPack.
- Do not operate if the cord, plug, battery, PowerPack, bulbs, or housing is damaged.
- Do not immerse the heat lamp, battery, PowerPack, or AC adapter/charger in water or liquids.
- Do not operate in wet areas, in rain, or near sinks.
- Always unplug and turn off before cleaning, servicing, or when not in use.
- Do not leave the heat lamp unattended while in operation.

**⚠ WARNING – BURN HAZARD/HOT SURFACE.** Surfaces become very hot during operation. Contact may cause serious burns.

- Do not touch the lamp shade, bulbs, arm, or surrounding metal surfaces while the unit is on or cooling.
- LED illumination indicates the lamp may be hot.
- Allow sufficient cool-down time before adjusting, cleaning, or replacing bulbs.
- Keep cords and other materials away from hot surfaces.

** WARNING – FIRE HAZARD. Failure to follow these instructions could result in fire or property damage.**

- Do not place on or near hot burners, ovens, or other heat sources.
- Keep away from flammable materials.
- Do not cover the lamp shade.
- Avoid direct sunlight during operation.

** WARNING – EXPLOSION HAZARD. Improper use of lithium-ion batteries may result in overheating, fire, or explosion.**

- Do not expose batteries to temperatures above 140°F (60°C).
- Do not use, charge, or store batteries near open flames or heat sources.
- Do not use a swollen, damaged, or overheated battery.
- Allow batteries to cool before charging.

** CAUTION**

- Not for children under 14 years. Close supervision required.
- The heat lamp is not a toy; misuse may cause burns or electric shock.
- Do not use the heat lamp if it malfunctions or has been damaged in any way.

## PRODUCT PURPOSE

The intended purpose of the BuffetBoost LumaLamp is to maintain the temperature of cooked food. It can be powered by AC or an optional battery for portable use.

## PARTS INCLUDED



BuffetBoost  
LumaLamp

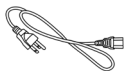

Power Cable



BuffetBoost  
Power Adapter



Two (2)  
shatterproof  
halogen bulbs



Two (2)  
Countersunk  
Screws



Allen Wrench

## OPTIONAL ACCESSORIES (SOLD SEPARATELY)



BuffetBoost Portable Battery



BuffetBoost PowerPack

## ASSEMBLY INSTRUCTIONS

**⚠** Ensure the unit is unplugged and powered off before assembly.

1. Connect the yellow XT60 power connectors from the lamp arm and the support column, ensuring they are securely connected.
2. Align the support column with the base.
3. Insert the two countersunk screws into the mounting holes.
4. Using the included Allen wrench, tighten both screws until fully secured.
5. Ensure the countersunk screws do not protrude beyond the surface of the support column. If they do, additional tightening is required.

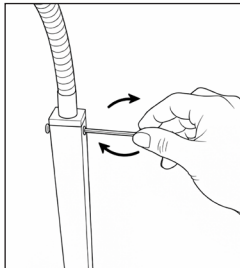
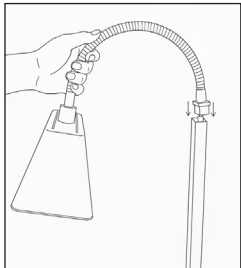

## USING YOUR LUMALAMP WITH AC POWER

- Insert the AC adapter into the charging port and ensure a secure connection.
- AC adapter LED = red while powered.
- Press the black power button once to turn on. A red LED will illuminate.
- Press the power button again to turn off. The red LED will turn off.

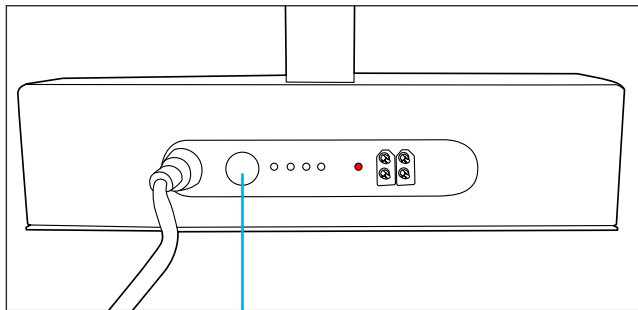

Power Button

## USING YOUR LUMALAMP WITH BUFFETBOOST PORTABLE BATTERY

### Battery Access & Lamp Positioning

Before installing or removing the battery, position the heat lamp so the battery bay is easily accessible.

The heat lamp may be positioned in one of two ways:

1. On its side, with the lamp arm resting against the tabletop.

**OR**

2. Upside down at the edge of a table, allowing the lamp arm to hang freely over the edge.

Ensure the lamp is fully supported and stable before proceeding.

1.

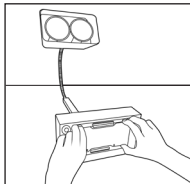

2.

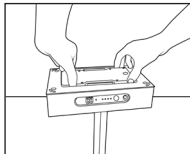

## USING YOUR LUMALAMP WITH BUFFETBOOST PORTABLE BATTERY

### INSTALLING & REMOVING THE BATTERY

#### Installation:

1. Insert the battery into the LumaLamp, aligning the yellow connectors.
2. Push each locking bar inward until it clicks into place.

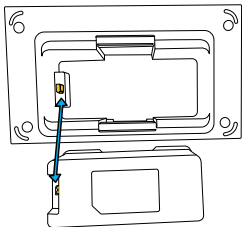

---

#### Removal:

1. Push each locking bar outward to release the battery.
2. Lift the battery upward using the corners.

Removing battery upside down:

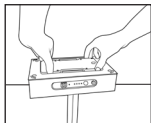

Removing battery on side:

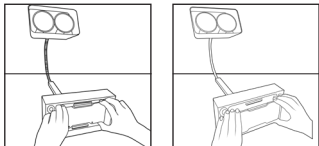

## CHARGING THE BATTERY (PORTABLE HEAT)

### Charging Instructions

- Insert the AC adapter firmly into the charging port.
- AC adapter LED = red while powered.
- Blue LEDs on the LumaLamp indicate charging progress.
- Battery is fully charged when all four blue LEDs are solid.
- Charge time is approximately 2 hours.
- Battery will not charge while the lamp is turned on.

#### Charging

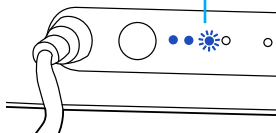

#### Fully Charged

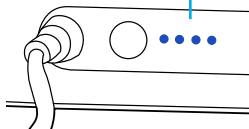

### Temperature Management

- Allow the battery to cool before recharging.
- If the battery is too hot to charge, all four blue LEDs will flash rapidly until cooled.
- Removing the battery may help it cool faster.

## USING THE BATTERY (PORTABLE HEAT)

### Operation

- Press the black power button once to turn on. Blue LEDs will illuminate.
- Press the power button again to turn off.
- Blue LEDs indicate battery level (4 = full, 0 = depleted).

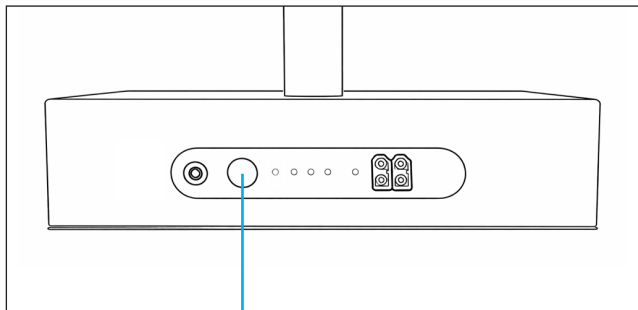

Power Button

### Runtime

- One battery provides up to 90 minutes of runtime.

## USING THE BUFFETBOOST POWERPACK (EXTENDED RUNTIME)

- The PowerPack holds two additional BuffetBoost batteries.
- Refer to page 8 for battery installation and removal instructions.
- Connect the LumaLamp and PowerPack using the provided cable, aligning the 4-pin connectors on each device.
- Once the internal battery in the LumaLamp is depleted, the unit will automatically draw power from the PowerPack.
- Each additional battery provides up to 90 minutes of runtime.
- Maximum runtime with one battery in the LumaLamp and two batteries in the PowerPack is up to 4.5 hours.
- The PowerPack cannot be used to charge batteries.

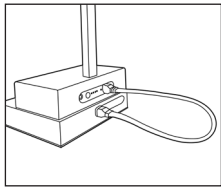
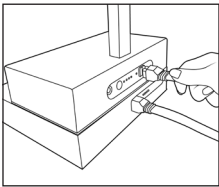
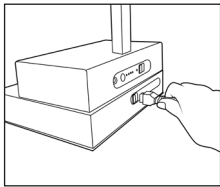

## OPERATIONAL GUIDELINES

### Heat Direction & Adjustment

- The LumaLamp features a swiveling shade (0-90°) and flexible serpentine arm to direct heat where needed.
- The lampshade includes an internal rotation stop to prevent overturning. Do not force rotation beyond its limits.

### Height & Performance Guidelines

- Approx. 14 in. from tray: higher intensity radiant heat for sizzling or crisping results.
- Approx. 20 in. from tray: broader heat coverage for temperature maintenance.

### Food & Vessel Considerations

- Trays, platters, or vessels used beneath the lamp must be heat-resistant and rated for temperatures of at least 300°F (149°C).

### Placement

- Place on a flat, stable, dry, heat-resistant surface.

### LED Indicators

- Red LED = AC power
- Blue LED = battery power
- LED illumination indicates the lamp may be hot – handle with care.

## LIGHT BULB REPLACEMENT

### **WARNING – BURN HAZARD**

- Turn off, unplug, and allow the lamp and bulbs to cool completely before replacing bulbs.
- Use only BBRB2 replacement bulbs (set of two 70 W shatterproof halogen bulbs) with this heat lamp. Use of non-approved bulbs may result in improper operation and may void the warranty.

### **Replacement Instructions:**

1. Ensure power is off and the unit is unplugged.
2. Allow bulbs to cool fully.
3. Remove the old bulbs carefully.
4. Install the new BBRB2 bulbs into the lamp sockets, ensuring they are seated securely.

## CLEANING & MAINTENANCE

### **WARNING – ELECTRICAL SHOCK HAZARD**

Turn off, unplug, and allow the heat lamp to cool completely before cleaning.

### **Cleaning Instructions**

- Wipe exterior surfaces with a damp cloth.
- A light, diluted detergent may be used.
- Do not use high-alkaline detergents.
- Do not submerge or place any components in a dishwasher.

### **Maintenance & Storage**

#### **Heat Lamp Longevity**

- Operating temperature: -4°F to 104°F (-20°C to 40°C).
- Storage temperature: -4°F to 140°F (-20°C to 60°C).
- Store in a cool, dry place.

#### **Battery Longevity**

- Remove batteries for long-term storage.
- Recharge after each use; do not store fully drained.
- If stored long-term, recharge every 3 months.
- Charge in temperatures between 40-100°F (4-38°C).

## BATTERY DISPOSAL

- Remove the battery from the LumaLamp.
- Do not dispose of in household trash.
- Recycle at an approved lithium-ion battery collection site.
- To find a location near you, visit: [www.epa.gov/recycle/used-lithium-ion-batteries](http://www.epa.gov/recycle/used-lithium-ion-batteries).

## FCC REGULATION

This device complies with part 15 of the FCC Rules. Operation is subject to the following two conditions: (1) This device may not cause harmful interference, and (2) this device must accept any interference received, including interference that may cause undesired operation.

Any Changes or modifications not expressly approved by the party responsible for compliance could void the user's authority to operate the equipment.

**Note:** This equipment has been tested and found to comply with the limits for a Class B digital device, pursuant to part 15 of the FCC Rules. These limits are designed to provide reasonable protection against harmful interference in a residential installation. This equipment generates uses and can radiate radio frequency energy and, if not installed and used in accordance with the instructions, may cause harmful interference to radio communications. However, there is no guarantee that interference will not occur in a particular installation. If this equipment does cause harmful interference to radio or television reception, which can be determined by turning the equipment off and on, the user is encouraged to try to correct the interference by one or more of the following measures:

- Reorient or relocate the receiving antenna.
- Increase the separation between the equipment and receiver.
- Connect the equipment into an outlet on a circuit different from that to which the receiver is connected.
- Consult the dealer or an experienced radio/TV technician for help.

The device has been evaluated to meet general RF exposure requirement. The device can be used in portable exposure condition without restriction.

## CERTIFICATIONS

All applicable safety certifications are maintained. For certificate documentation, contact customer service at [info@amnow.com](mailto:info@amnow.com) or 1-800-333-9133.

## WARRANTY

Thank you for choosing the BuffetBoost LumaLamp. We are confident in the quality and durability of our product and are pleased to offer a one-year limited warranty.

**Submitting a Claim:** To submit a warranty claim, contact customer service at 1-800-333-9133 or email [info@amnow.com](mailto:info@amnow.com). Please have your proof of purchase available.

**Proof of Purchase:** Customers must provide proof of purchase to take advantage of the warranty. Please retain your original receipt or invoice.