



## **ADDENDUM**

### **Pump and Charger System - User Instructions and Safety Precautions**

#### **INTRODUCTION**

Thank you for purchasing the Shortening Shuttle® BOSS Cooking Oil Filter®.

BOSS = Battery Operated Shortening Shuttle®. Shortening Shuttle® has designed this pump to the highest quality standards using premium quality materials and workmanship.

**PLEASE READ THIS SAFETY INFORMATION CAREFULLY BEFORE USE.**

Read and retain this instruction manual to assist you in the operation of your new product.



#### **WARNING**

Please read this important information carefully before use.

This product should only be used with intended cooking oils. Contact Shortening Shuttle® as needed.

- Visually inspect pump, charger and battery prior to use for any signs of damage, loose or missing parts. If equipment is worn or damaged, remove it from service (replace if required).
- The BOSS Cooking Oil Filter® must be used strictly in accordance with Shortening Shuttle® terms and conditions.
- 'WARNING' listed throughout this manual to advise of actions which may cause damage to your equipment.

Failure to follow all instructions listed below may result in electric shock, fire, serious injury and/or damage to the power tool. The term "power tool" in all of the warnings listed refers to your battery operated (cordless) pump.

- Make sure all operators have adequate access to the following instructions.



#### **GENERAL SAFETY**

**DO NOT** operate power tools in explosive areas, e.g. close to flammable liquids, gases or dust.

**Only use "ORIGINAL" Shortening Shuttle® replacement parts.**



#### **ELECTRICAL SAFETY**

- Never modify electrical connections.
- **DO NOT** expose power tool to rain or wet conditions.
- **DO NOT** use The BOSS if it is damaged or the switch does not turn the pump on.



## BATTERY and CHARGER SAFETY

- If “battery-pack” case is damaged **DO NOT** use - Danger of electric shock or electrocution.
- Battery charger **MUST ONLY** be used for charging the rechargeable batteries supplied with the BOSS.
- **DO NOT** operate charger if charger, power cord or plug is damaged - replace immediately.
- **DO NOT** disassemble charger or battery.
- **DO NOT** store battery pack in locations where the temperature may reach or exceed 40°C/104°F.
- **DO NOT** use charger on any other voltage than designated on the charger.

### DISCLAIMER

Your product is designed to use with non-flammable cooking oils only. Usage with different fluids may cause performance degradation and render the warranty void. Improper use of liquid may lead to machine failure and malfunction.

Use of any flammable fluids can cause sparks to explode and create a fire hazard. Shortening Shuttle® bears no liability to the consequence of fluid misuse by customers.



## WARNING

- Keep plastic bag away from babies and children.
- Do not lift the power head with locking lever. Handle power head with care. **DO NOT DROP.**
- Make sure the power head is securely connected/attached to the stem.
- Do not leave the power head sitting on top of the stem unlocked.
- Stop operating the pump if any leaking at the joints is noticed.
- Do not modify the pump in any way.
- Only use the genuine BOSS wand.
- Ensure all quick-connects are fully seated and sealed. Pull hoses after insertion to verify fully seated and sealed. Check for any signs of leakage before use.
- Do not use flammable fluid in this product. Only use fluid specified in this instruction manual.
- Wear appropriate PPE for protection.
- Do not use the product in potentially explosive atmosphere.
- Do not expose the product to fire and source of heat.
- Use product in well ventilated area.
- Never leave your wand unattended with the pump ON. Always ensure the switch is in OFF position after dispensing the oil.
- Use pump in adequate lighting condition for safe operation. Do not use the product under poor illumination.
- Avoid spillage of oil near water drains as it may be harmful to the environment.
- When using BOSS, check area for spillage and clean up any liquid on floor as this will cause a slippery hazard
- Only use genuine BOSS battery and chargers with this product.
- Battery pack, charger and power head should be protected from water.



## CAUTION

- \* Do not expose the power head to a nearby magnet as its performance will be adversely affected.
- The battery operated pump should always be used in a vertical position.
- The Wand should always be pointed away from people when dispensing fluid.
- **Do not run the BOSS pump dry.** If the noise level changes when running the BOSS pump, check the BOSS tank level. **If the BOSS tank is empty, stop the pump immediately.**

## BATTERY DISPOSAL

**NOTE:** Dispose of old batteries properly. The battery contains rechargeable Lithium-ion and must be recycled or disposed of properly. Please refer to the local authorities for the correct method of battery disposal.

**DO NOT** incinerate the battery pack. The battery can explode in a fire

**DO NOT** attempt to disassemble any battery.

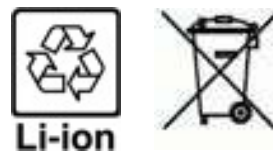

## CHARGE BATTERY

1) Insert battery

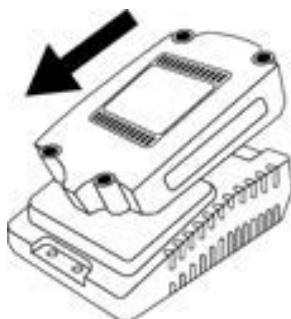

2) Power on  
(green light only)

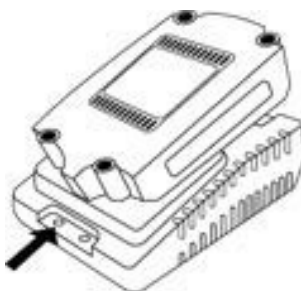

3) Battery charging  
(red light only)

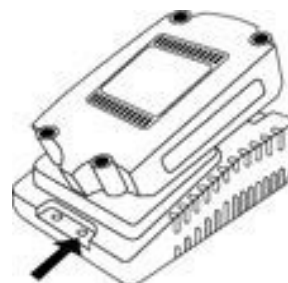

4) Battery charged  
(green light only)

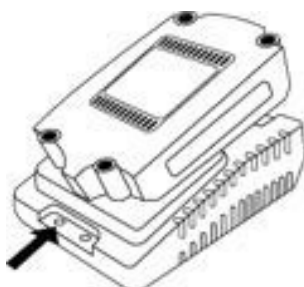

Note: Red light flashes when battery voltage is low  
(trickle charging to prevent battery damage)

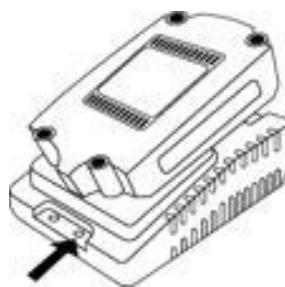

## INSERT / REMOVE BATTERY

1) Insert battery  
a) lift handle  
b) push down

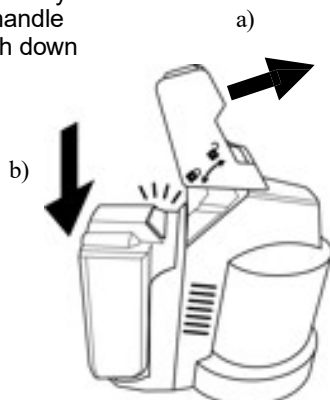

2) Remove battery  
a) lift handle  
b) press button  
c) pull up

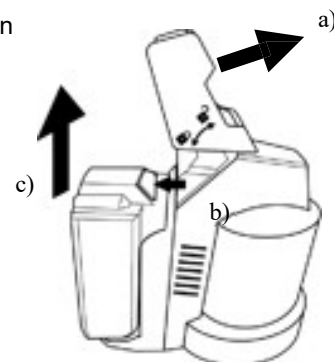

## DIAPHRAGM AND SPRING REPLACEMENT

1) Turn anti-clockwise,  
remove drive gear

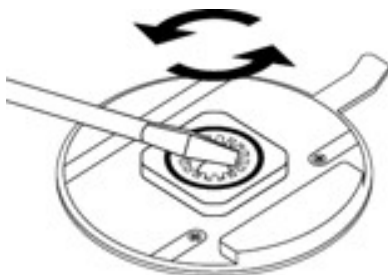

2) Remove 3 screws, pump cover  
and dispensing gun hanger

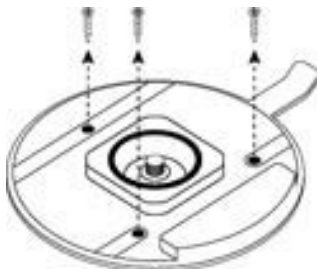

3) Remove 2 screws.



4) Remove assembly.

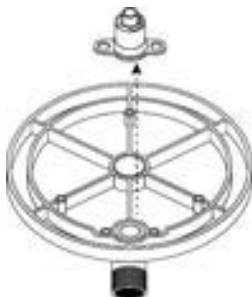

5) Remove circlip.



6) Replace spring.



7) Re-fit circlip.



8) Remove old diaphragm.



9) Fit new diaphragm.  
(ensure correct orientation)

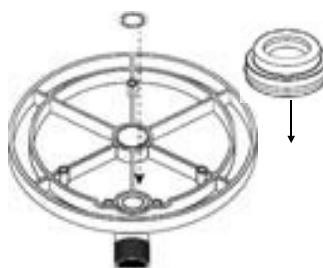

10) Fit valve switch assembly.

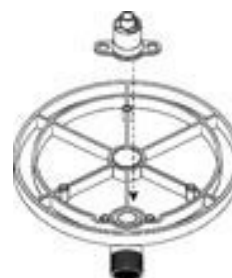

11) Fit 2 screws.



12) Fit pump cover and dispensing  
gun hanger, using 3 screws.

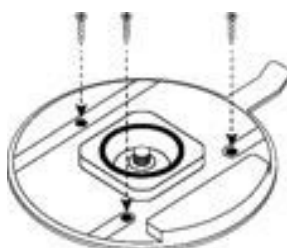

13) Fit drive gear, turn  
clockwise to secure.

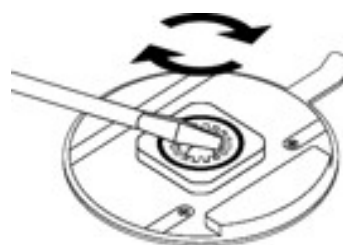

## IMPELLER AND O'RING REPLACEMENT

1) Unscrew adapter



2) Remove o'ring.



3) To assist in the removal of the impeller carefully use a small flat edged screwdriver in the small groove

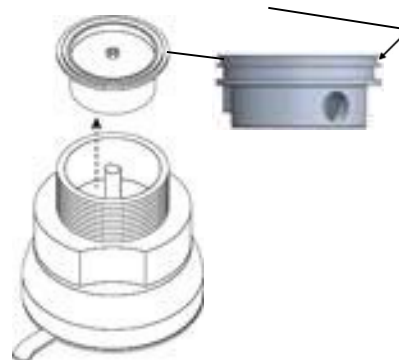

4) Remove o'ring.



5) Carefully remove and replace impeller.

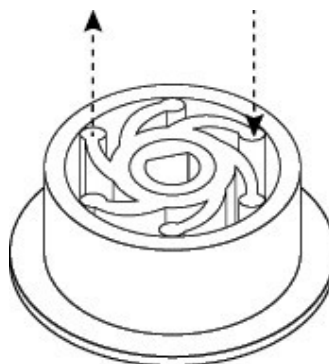

**Note: Impeller must be lubricated with oil or grease during assembly.**

6) Replace o'ring.

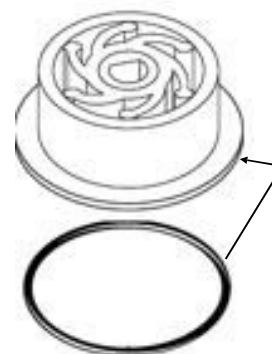

7) Carefully insert impeller housing.  
(Note correct orientation of grooves)

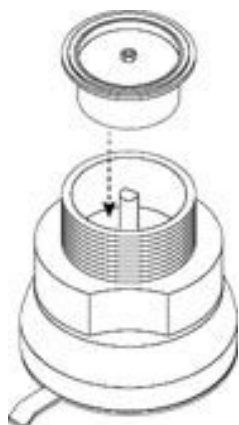

8) Replace o'ring.

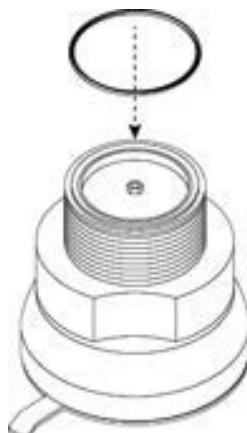

9) Firmly hand tighten pump tube.





### **MBC-US – US Battery Charger**

This battery charger has been tested & verified by ETL Intertek to meet OSHA required safety standard.



### **FCC:**

This device complies with Part 15 of the FCC Rules. Operation is subject to the following two conditions:

- (1) this device may not cause harmful interference, and (2) this device must accept any interference received, including interference that may cause undesired operation.

Warning: Changes or modifications to this unit not expressly approved by the party responsible for compliance could void the user's authority to operate the equipment.

NOTE: This equipment has been tested and found to comply with the limits for a Class B digital device, pursuant to Part 15 of the FCC Rules. These limits are designed to provide reasonable protection against harmful interference in a residential installation. This equipment generates, uses and can radiate radio frequency energy and, if not installed and used in accordance with the instructions, may cause harmful interference to radio communications. However, there is no guarantee that interference will not occur in a particular installation. If this equipment does cause harmful interference to radio or television reception, which can be determined by turning the equipment off and on, the user is encouraged to try to correct the interference by one or more of the following measures:

- Reorient or relocate the receiving antenna.
- Increase the separation between the equipment and receiver.
- Connect the equipment into an outlet on a circuit different from that to which the receiver is connected.
- Consult the dealer or an experienced radio/ TV technician for help.



101 Crawford Street  
Leominster, MA 01453  
Contact: Customer Service  
Phone: 508.757.5169

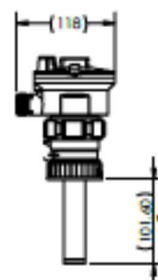
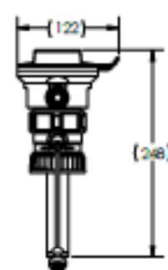
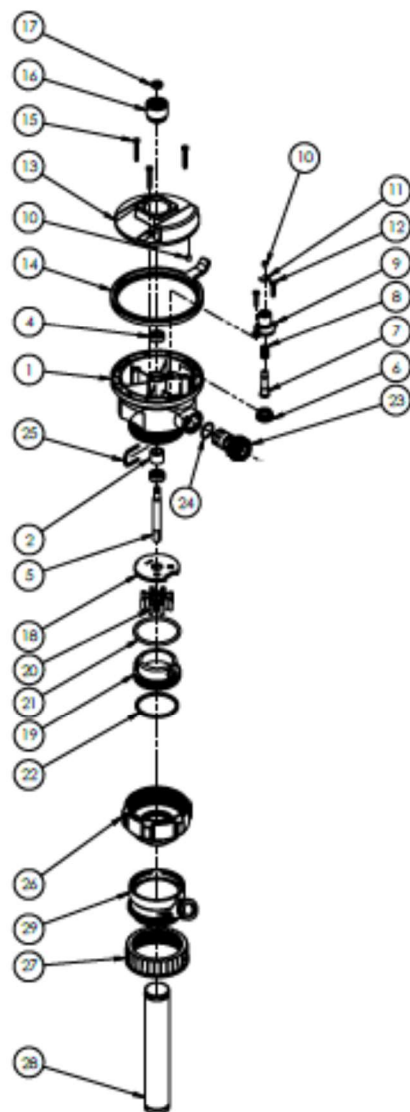

### PRODUCT OVERALL DIMENSIONS

ITEM NO.	Pump Kit BP-1K (A)	QTY.	DESCRIPTION
1		1	HOUSING - PUMP STEM
2		1	BEARING - NEEDLE ROLLER 8X14X12
3		1	OIL SEAL TC 8X16X6 - NBR
4		1	BEARING - BALL 6X15X5
5		1	DRIVE SHAFT
6	A	1	DIAPHRAGM
7	A	1	PLUNGER - PRESSURE
8	A	1	SPRING
9		1	HOUSING - PRESSURE SWITCH
10	A	2	MAGNET - NEODYMIUM CYLINDER 4X5
11	A	1	CIRCLIP E-CUP
12		2	SCREW - PHILLIPS PAN HEAD PT 3.5X16
13		1	COVER - PUMP STEM - TOP
14		1	HOOK-DISPENSING GUN
15		3	SCREW - PHILLIPS PAN HEAD PT 3.5X25
16		1	CONNECTOR - STEM SPLINE
17		1	NUT - M6 ISOH35
18	A	1	COVER-IMPELLER CHAMBER
19	A	1	HOUSING-IMPELLER CHAMBER
20	A	1	8-BLADE FLEXIBLE IMPELLER
21	A	1	O-RING
22	A	1	O-RING
23		1	CONNECTOR - DISPENSING GUN
24	A	1	O/RING NITRILE
25		1	U-CLIP
26		1	NUT - PUMP STEM
27		1	BUNG ADAPTOR - TYPE C
28		1	SUCTION TUBE EXTENDABLE
29		1	DRAIN BACK ADAPTOR

**Not For Manufacture**

					3RD ANGLE PROJECTION DO NOT SCALE	VOL. 001 SHEET 001 DATE 01/01/2024 DRAWN BY 001 CHECKED BY 001 ALL UNITS	DESIGNER MM 28/11/2024 1 OF 1 SCALE N.T.S.	<b>Shortening Shuttle®</b> STEM ASSY	A2
					DIMENSION IN mm U.N.O.	DATE: REFER TO INDIVIDUAL DRAWING MASS: - FINISH:	SHEET 1 OF 1 PARTIAL	Model No.	REV 0
					THIS DRAWING IS THE PROPERTY OF Shortening Shuttle. AND IS NOT TO BE COPIED IN WHOLE OR PART WITHOUT THEIR WRITTEN AUTHORITY <b>COPYRIGHT RESERVED</b>				
ISSUE	C.NO	REVISION / CHANGE	DRN	DATE					