

Table Base Installation Measurement

* Screw Mounting Area in Grey

* 3/4" to 1" Length Wood Mounting Screws Only

* Installation of Third Party's Table Bases At your Own Risk

ATP3060 / ATP3072

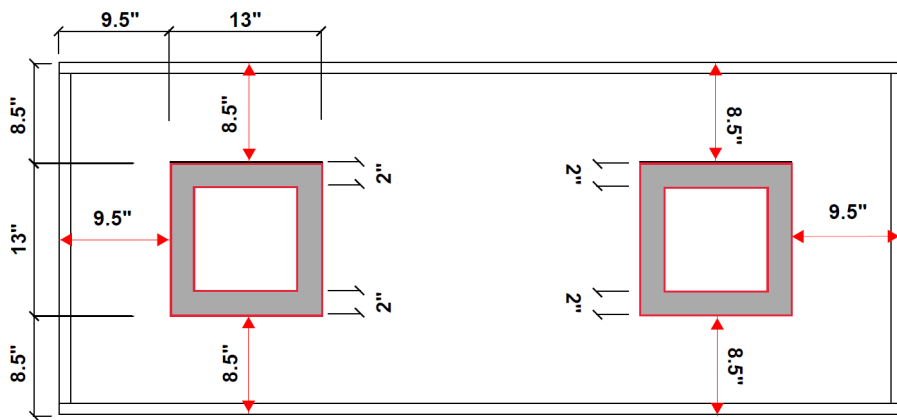

ATP36

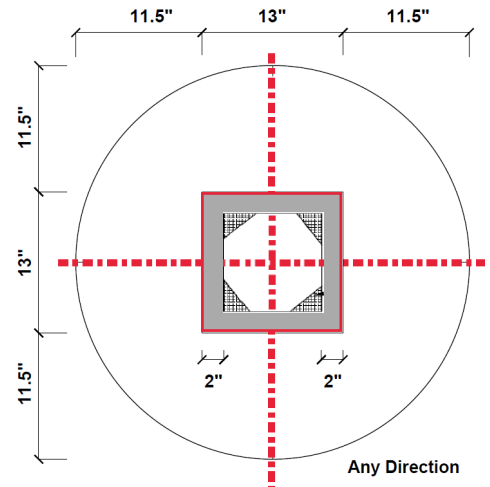

ATP3636

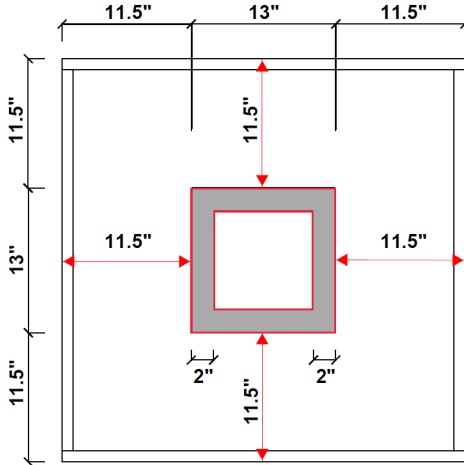

ATP3030

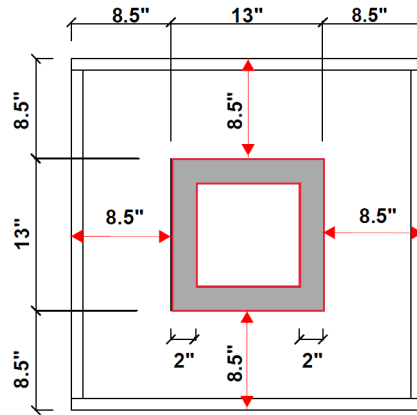

ATP30

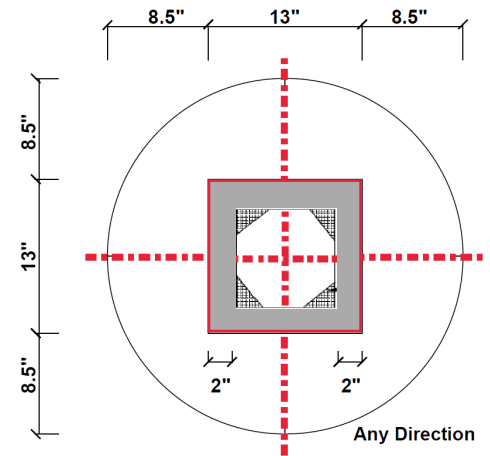

ATP3048

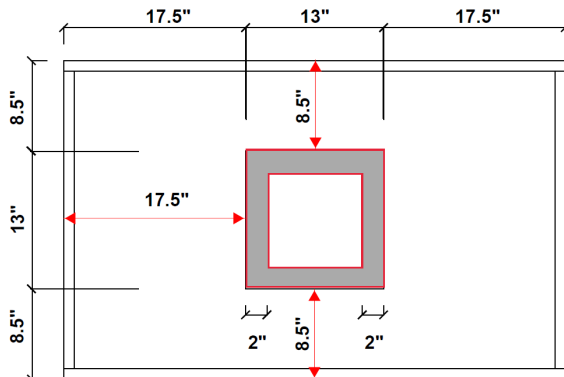

ATP3045

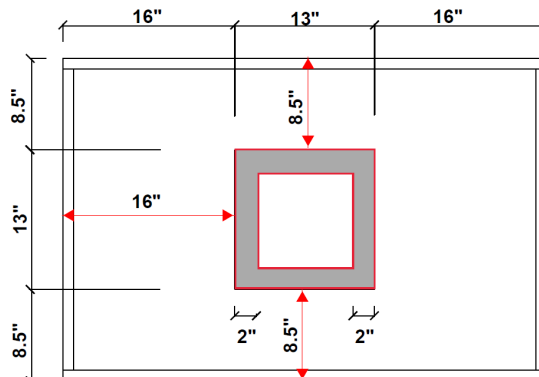

ATP2430

