



Vertical Contact Toaster

Model VCT-2000

Owner's Manual

Manufacturing Numbers:
9210112



Table of Contents

| | |
|--|-----------|
| Overview | 2 |
| Before Use | 2 |
| In Case of Damage | 2 |
| Website | 2 |
| Service/Technical Assistance | 2 |
| Equipment Information to Save | 2 |
| Authorized Service Agency | 2 |
| Safety Information | 3 |
| Operation | 3 |
| Maintenance | 3 |
| Service | 3 |
| Specifications | 5 |
| Dimensions | 5 |
| Electrical Ratings | 5 |
| Electrical Cord & Plug Configurations | 5 |
| Model & Mfg. No. | 5 |
| Description | 5 |
| Configuration | 5 |
| Installation | 6 |
| Unpacking | 6 |
| Equipment Setup | 6 |
| Assembling the Unit | 6 |
| Operation | 8 |
| Operating Instructions | 8 |
| Temperature Adjustments | 8 |
| Recommended temperatures | 8 |
| Temperature control panel | 9 |
| Platen heater temperature adjustment | 9 |
| Auxiliary Air heater temperature adjustment | 9 |
| Hi-Limit Reset Button | 10 |
| Fault Messages | 10 |
| Maintenance | 12 |
| Daily | 12 |
| Replacing the Black and Silver Release Sheet (Every 4–6 Weeks) | 13 |
| Replacing the Belt Wraps (Every 3–6 Months) | 13 |
| Checking the Conveyor Belt Chains (Every 3–6 Months) | 14 |
| Replacing conveyor belt Chains | 14 |
| Checking the Roller Tensioners (every 3–6 months) | 15 |
| Troubleshooting | 16 |
| Replacement Parts | 20 |
| Wiring Diagram | 26 |
| Limited Warranty | 28 |

Overview

The Vertical Contact Toaster Model VCT-2000 is designed for contact toasting of buns. The toaster design allows the operator to place buns on both sides of the heated platen at the same time. Buns are placed into the top of the toaster and uniform, golden brown, warm buns are then retrieved at the base of the unit.

Before Use

This manual contains safety, installation, and operating procedures for the VCT-2000. Read and understand it completely before installing or operating the toaster. Keep this document for reference. If the toaster changes ownership, this manual must accompany it.

Immediately upon receipt, inspect the toaster for damage. Report any shipping damage or incorrect shipment to the delivery agent.

Record the model number, serial number, and installation date of your toaster and keep this information for future reference.

In Case of Damage

If the toaster arrives damaged, file a claim with the carrier immediately. Save all packing materials when filing a claim. Freight damage claims are the responsibility of the purchaser and are not covered under warranty.

Website

www.antunes.com

Service/Technical Assistance

If any parts are missing or damaged, contact Antunes Customer Service immediately at +1-877-392-7856 (toll free).

If there are problems with the installation or operation of this product, contact Antunes Technical Service toll free at +1-877-392-7854.

Fill in the information in the next section and have it handy when calling for assistance. The serial number is on the specification plate located on the system.

Equipment Information to Save

Purchased from:

Date of purchase:

Model number:

Serial number:

Manufacturing number:

Authorized Service Agency

Name:

Phone No:

Address:

Safety Information

Operation

Use the following guidelines for safe operation of the toaster.

⚠WARNING Electrical shock hazard. Failure to follow these instructions could result in serious injury or death.

- Read all instructions before using equipment.
- For your safety, the equipment is furnished with a properly grounded cord connector. Do not attempt to defeat the grounded connector.
- Install or locate the equipment only for its intended use as described in this manual. Do not use corrosive chemicals in this equipment.
- Do not operate this equipment if it has a damaged cord or plug, if it is not working properly, or if it has been damaged or dropped.
- Do not block or cover any openings on the toaster.
- Do not immerse cord, unit, or plug in water.
- Keep cord away from heated surfaces.
- Do not use an extension cord with this device.
- Do not allow cord to hang over edge of table or counter.

NOTICE: Turning off the power switch does NOT turn off all power to the toaster.

- The equipment should be grounded according to local electrical codes to prevent the possibility of electrical shock. It requires a grounded receptacle with separate electrical lines, protected by fuses or circuit breaker of the proper rating.
- All electrical connections must be in accordance with local electrical codes and any other applicable codes.

Maintenance

- Do not use abrasive materials; they can damage the toaster's stainless steel finish.
- Chlorides or phosphates in cleaning agents (e.g., bleach, sanitizers, degreasers, and detergents) can permanently damage stainless steel equipment. The damage is usually in the form of discoloration, dulling of the metal surface finish, pits, voids, holes, or cracks. This damage is permanent and is not covered by warranty.
- Always use a soft, damp cloth for cleaning. Rinse with clear water and wipe dry. When required, always rub in the direction of metal polish lines.
- Routine cleaning should be performed daily with dish detergent and water using a clean cloth.
- Rub off finger marks and smears using soap and water.
- Do not clean the toaster with a water jet.

Service

- Inspection, testing, and repair of electrical equipment must be performed only by qualified service personnel.
- Have the toaster serviced only by qualified personnel. Contact Antunes Technical Service for adjustment or repair.
- Turn the power off, allow the toaster to cool down, and unplug the power cord before performing any service or maintenance.
- If the supply cord is damaged, it must be replaced by the manufacturer, its service agent, or a similarly qualified person in order to avoid an electrical hazard.

Specifications

Dimensions

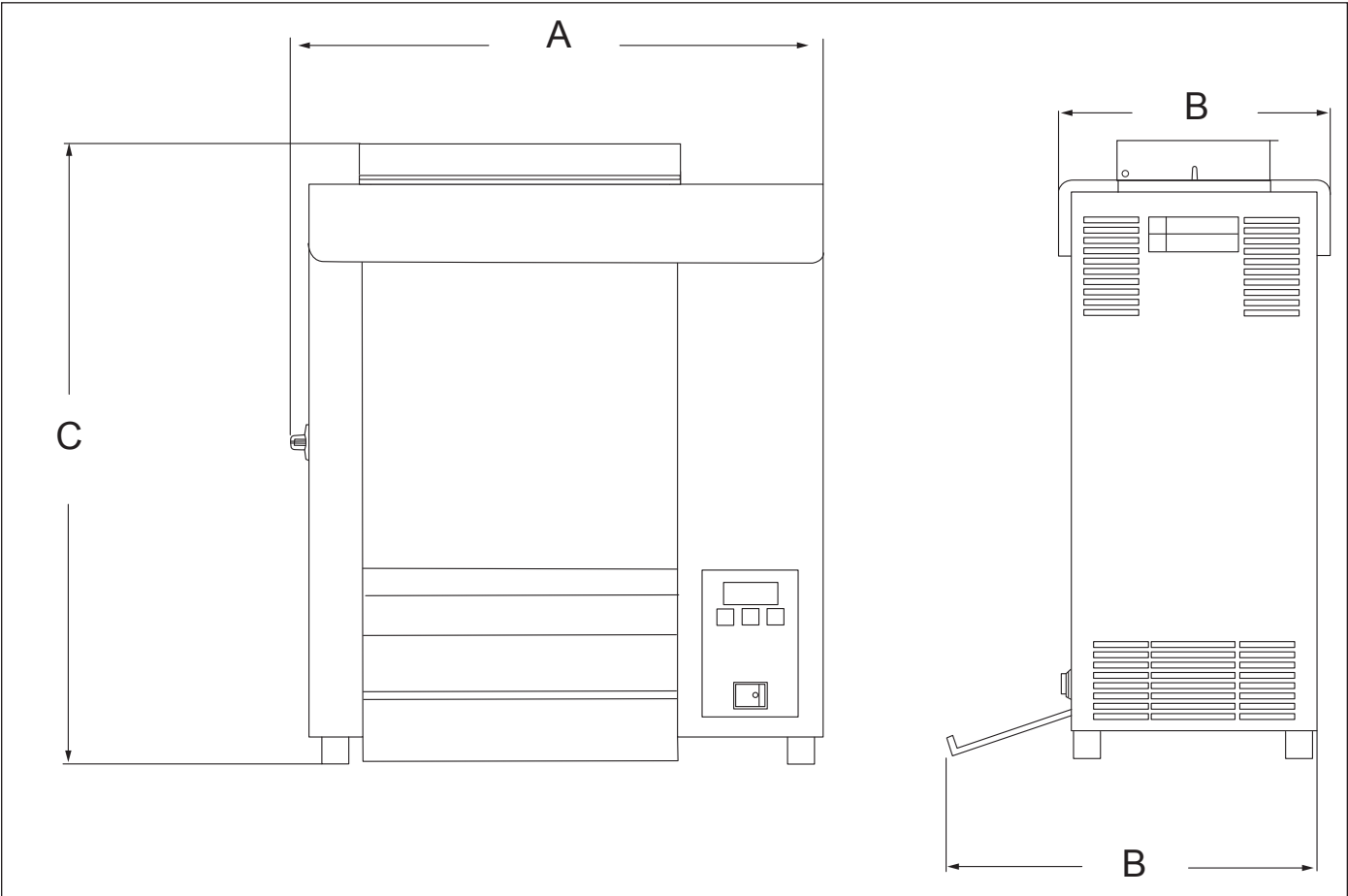

Electrical Ratings

| Model & Mfg. No. | Width (A) | Depth (B) | Height (C) |
|------------------|------------------|------------------|------------------|
| VCT-2000 9210112 | 21 1/4" (540 mm) | 15 1/4" (387 mm) | 23 3/4" (603 mm) |

| Model & Mfg. No. | Volts | Watts | Amp. | Hz. |
|------------------|-------|-------|------|-----|
| VCT-2000 9210112 | 208 | 3291 | 15.8 | 60 |

Electrical Cord & Plug Configurations

| | |
|-------------|--------------------------|
| Speed Spec: | 14 Seconds (approximate) |
|-------------|--------------------------|

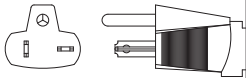
| Model & Mfg. No. | Description | Configuration |
|------------------|---------------------------------------|---|
| VCT-2000 9210112 | 6-20P, 20 Amp., 250 Volt, Non-Locking |  |

Unpacking

1. Remove the unit and all packing materials from shipping carton.
2. Open the included large box. It should contain the following:
 - Bun Chute (some models only)
 - Bun Feeder (some models only)
 - Two Release Sheets
 - Owner's Manual
 - Maintenance Card (some models only)
3. Remove all shipping tape and protective coverings from the unit and parts.

NOTICE: If any parts are missing or damaged, contact Antunes Customer Service IMMEDIATELY at +1-877-392-7856 (toll free).

Equipment Setup

Before placing the toaster into service, pay attention to the following guidelines:

- Make sure power is off and the toaster is at room temperature.
- Do NOT block or cover any openings on the unit.
- Do NOT immerse cord or plug in water.
- Keep cord away from heated surfaces.
- Do NOT allow cord to hang over edge of table or counter.
- Connect the unit to the proper power supply. Refer to the specification plate for the proper voltage.



CAUTION

Bread may burn. Therefore toasters must not be used near or below curtains or other combustible walls and materials. Failure to maintain safe operating distances may cause discoloration or combustion.

NOTICE: The factory has pre-installed a Release Sheet over the Platen (Figure 1). Verify that it is properly in place before proceeding.

Remove Bun Chute and Bun Feeder from the box and install (Figure 1).

NOTICE: As of March 2017, the Interlock Switch was removed from use. If your toaster has the Interlock Switch, you will need to place the Heat Shield onto the toaster in order for the conveyors to turn. If your toaster does not have an Interlock Switch, the conveyors will turn as long as the unit is on.

CAUTION

Failure to use Release Sheets may result in damage to the unit and loss of warranty coverage.

WARNING

ELECTRICAL SHOCK HAZARD. FAILURE TO FOLLOW THE INSTRUCTIONS IN THIS MANUAL COULD RESULT IN SERIOUS INJURY OR DEATH.

- **Electrical ground is required on this appliance.**
- **Do NOT modify the power supply cord plug. If it does not fit the outlet, have a proper outlet installed by a qualified electrician.**
- **Do NOT use an extension cord with this appliance.**
- **The toaster should be grounded according to local electrical codes to prevent the possibility of electrical shock. It requires a grounded receptacle with separate electrical lines protected by fuses or a circuit breaker of the proper rating.**
- **Check with a qualified electrician if you are in unsure if the appliance is properly grounded.**

CAUTION

All electrical connections must be in accordance with local electrical codes and any other applicable codes.

Installation

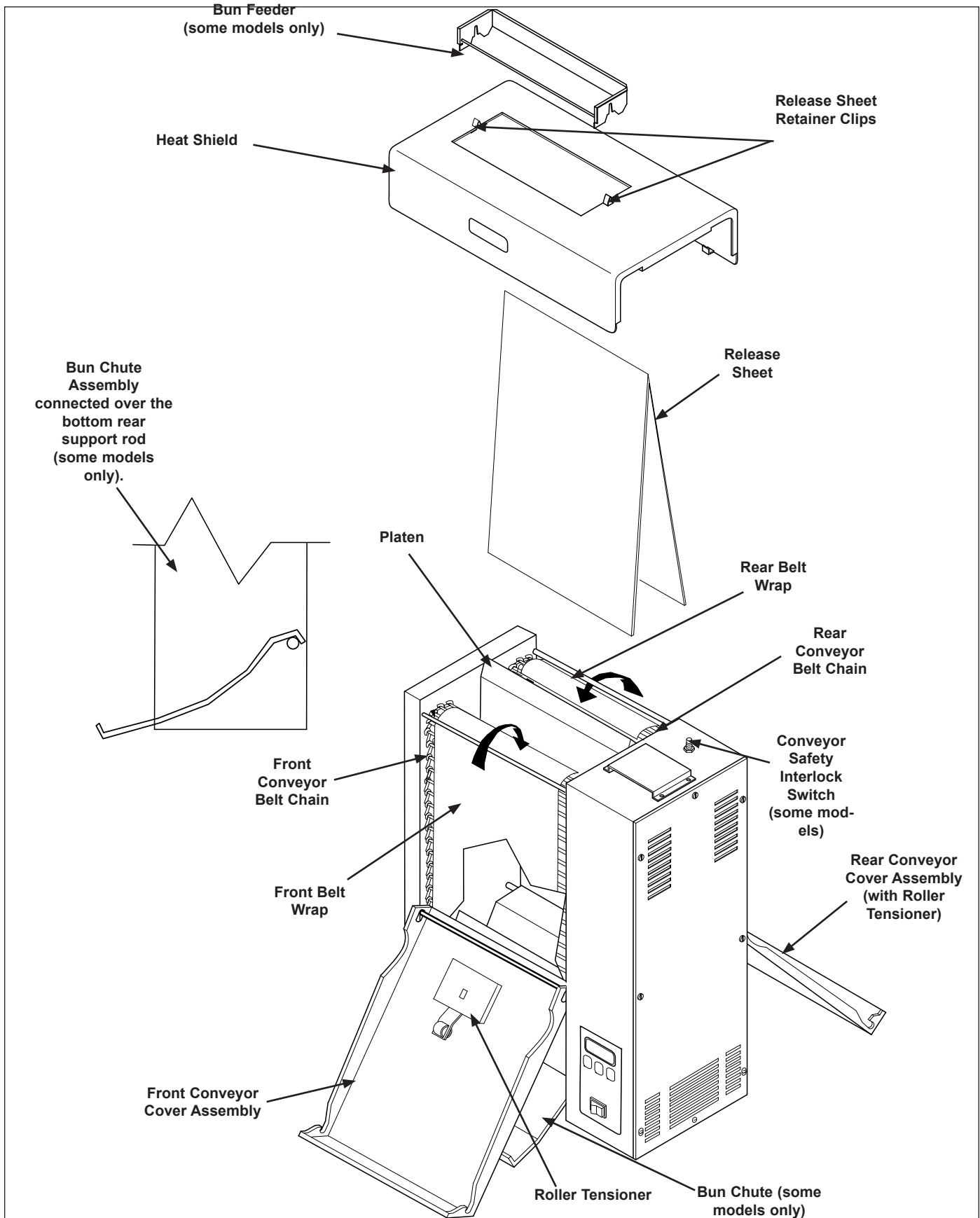

Figure 1. VCT-2000 Toaster

Operating Instructions

1. Set the Bun Thickness Adjustment Controls (Figure 3).

NOTICE: Recommended settings are #6 for Crowns and #4 for Heels.

2. Turn the power on and allow the toaster to warm up for 30 minutes before proceeding.

NOTICE: The temperature display (Figure 2) will flash “LO” until the toaster reaches its preset operating temperature. When the toaster approaches the preset temperature of 585°F (307°C), “USE” appears in the temperature display and the unit is ready to toast buns. If “USE” does not appear in the window after approximately 30 minutes, contact your Authorized Service Agency.

3. Drop Crowns and Heels into the slot (Figure 2).

NOTICE: Cut sides of Heels and Crowns must face each other.

4. Toasted buns will drop into the Bun Landing Area (Figure 2) in approximately 10 seconds.
5. Test at least four buns before putting the toaster into service.
6. Turn the power off when finished toasting for the day and proceed with the **Daily Cleaning** as outlined in the Maintenance section of this manual.

Temperature Adjustments

The VCT-2000 uses a Platen Heater and two Auxiliary Air Heaters. The Platen Heater consists of a heating element built into the Platen to toast the cut side of the bun. The two Auxiliary Heaters assist in providing additional heat to the buns. The first Auxiliary Air Heater is located between the conveyor in the front of the toaster. The second Auxiliary Heater is located between the conveyor at the rear of the unit.

Recommended temperatures

Recommended temperature setting for the Platen heater is 585°F (307°C).

Recommended temperature setting for the Auxiliary Air Heaters is 400°F (204°C).

NOTICE: The toaster is tested and shipped with the heaters set at the above recommended temperatures.

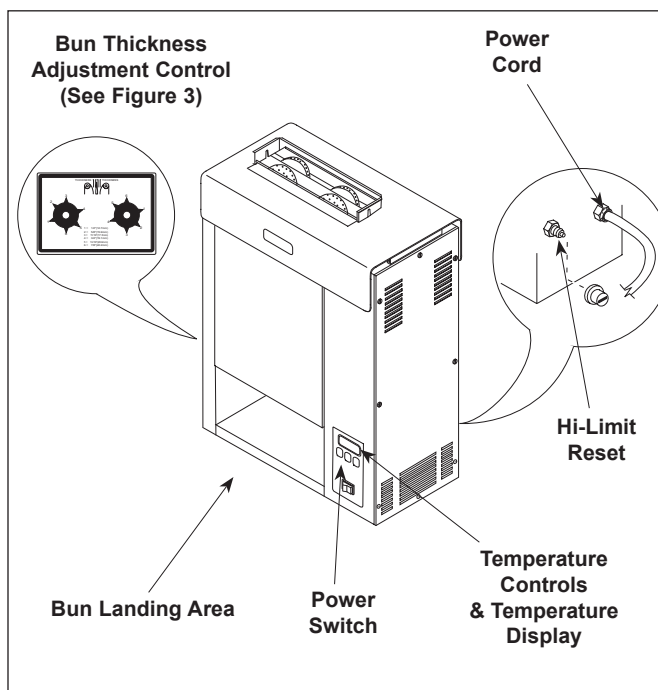

Figure 2. VCT-2000 Toaster

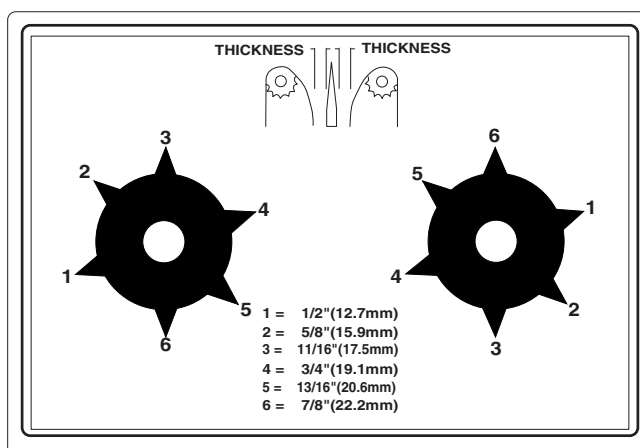

Figure 3. Bun Thickness Adjustment Controls

Temperature control panel

NOTICE: The term “setpoint temperature” refers to the desired temperature setting.

To display the actual Platen temperature—providing it is over 440°F (227°C)—press the **TEMP UP** button.

To display the actual Auxiliary Air Heater temperature—providing it is over 360°F (182°C)—press the **TEMP DOWN** button.

To switch the temperature display between Fahrenheit (°F) and Celsius (°C), press and hold the **TEMP SCALE** button for 5 seconds.

Platen heater temperature adjustment

1. Turn the power on and wait for the Temperature Display to finish the power-up sequence (Figure 4).
2. Press and hold the **TEMP UP** and **TEMP DOWN** buttons for over 1 second until the display flashes the Platen setpoint temperature (Figure 5), then release.
3. Press the **TEMP UP** button to raise the setpoint temperature or press the **TEMP DOWN** button to lower the setpoint temperature.

NOTICE: The Platen can be programmed to a maximum setpoint temperature of 600°F (316°C). If no change in temperature is made within 5 seconds, the display reverts back to the previous setpoint temperature.

4. Release the button when the desired setpoint temperature is displayed.

Auxiliary Air heater temperature adjustment

1. Turn the power on and wait for Temperature Display to finish the power-up sequence (Figure 4).
2. Press and hold the **TEMP UP** and **TEMP SCALE** buttons for over 1 second until the display flashes the setpoint temperature (Figure 6), then release.
3. Press the **TEMP UP** button to raise the setpoint temperature or press the **TEMP DOWN** button to lower the setpoint temperature.

“Heat On” LED will blink on/off during warm-up and when either platen or auxiliary air heaters are calling for heat.

NOTICE: The maximum Auxiliary Air Heater setpoint temperature is 400°F (204°C).

4. Release the button when the desired setpoint temperature is displayed.

NOTICE: If no change in temperature is made within 5 seconds, the display reverts back to the previous setpoint temperature.

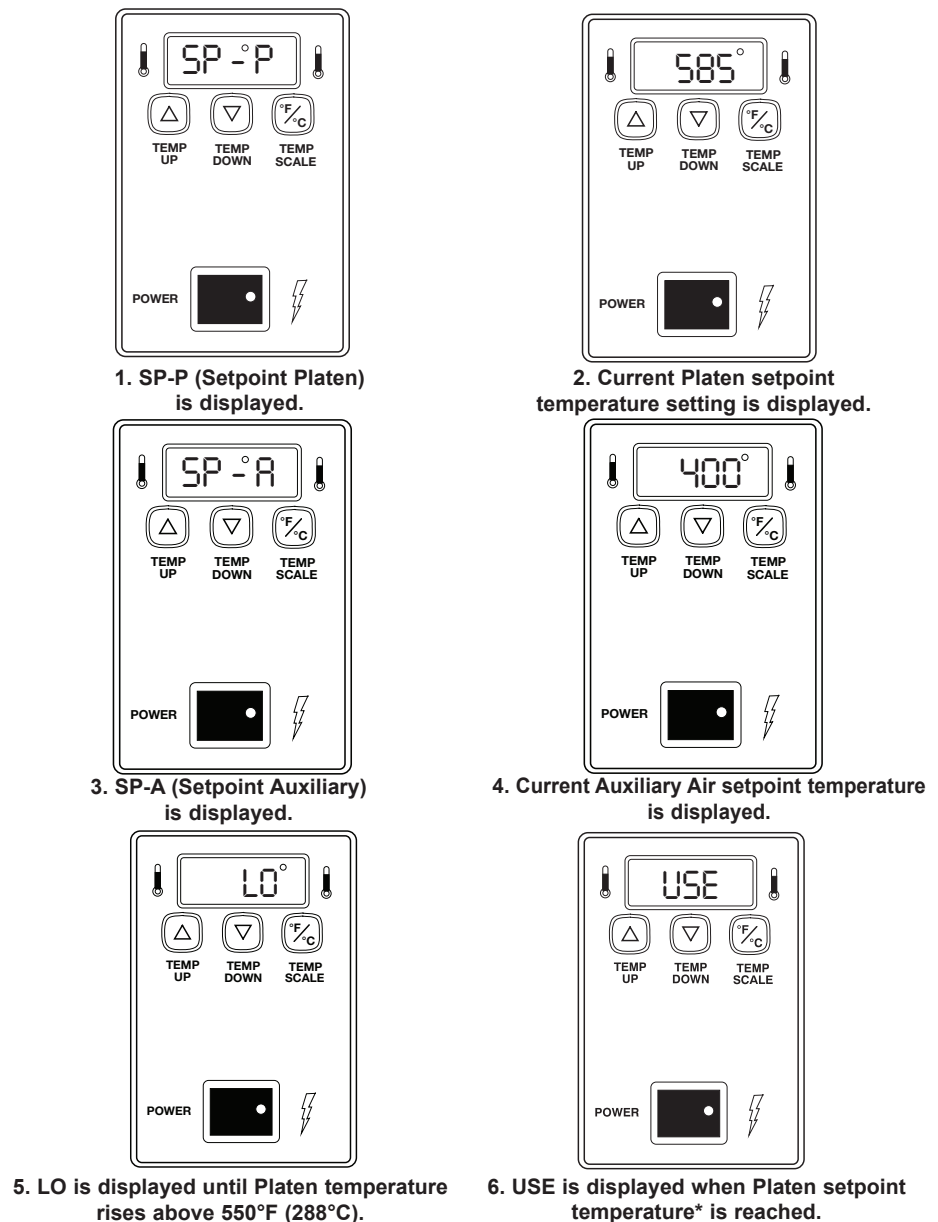

* Platen setpoint temperature must be between 460°F (238°C) and 585°F (307°C).

Figure 4. Temperature Power-Up Sequence

P/N 1011213 Rev. F 06/18

Safety Features

Hi-Limit Reset Button

A Hi-Limit Control turns off electrical power to the heater and control circuits if the platen overheats. To reset the control, allow 10-15 minutes for the unit to cool, then locate the Reset Button at the rear of the unit. Remove the black protective cap, press the Reset Button, and reinstall the protective cap (Figure 2).

NOTICE: If the Hi-Limit requires continuous resetting, contact your Authorized Service Agency.

Fault Messages

The Control Display will flash fault messages when there is a problem with the unit.

“HI” will flash if the platen temperature exceeds 620°F (327°C) or if the platen thermocouple is disconnected or open.

“HI” and **“USE”** will flash (Figure 5) if the auxiliary heater’s temperature exceeds 440°F (227°C) or if the auxiliary thermocouple is disconnected or open.

“CHEC” will flash (Figure 6) when the control compartment ambient temperature is excessive: 140°F (60°C) to 180°F (82°C). All heaters will shut off.

“PO” will flash (Figure 7) if the incoming power drops below 190 Volts. The toaster will shut down.

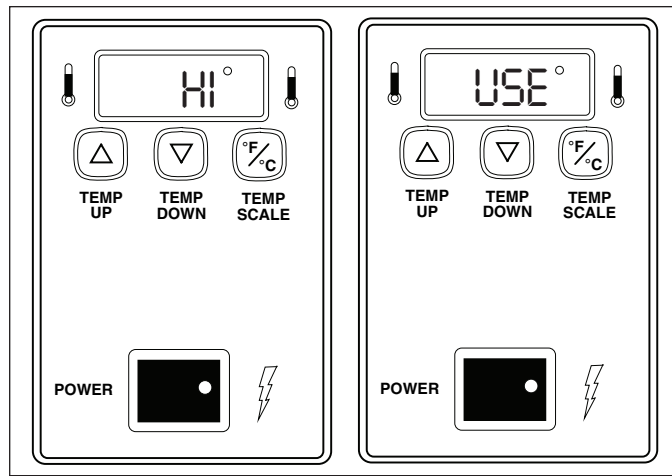

Figure 5. “HI” and “USE” Fault Message

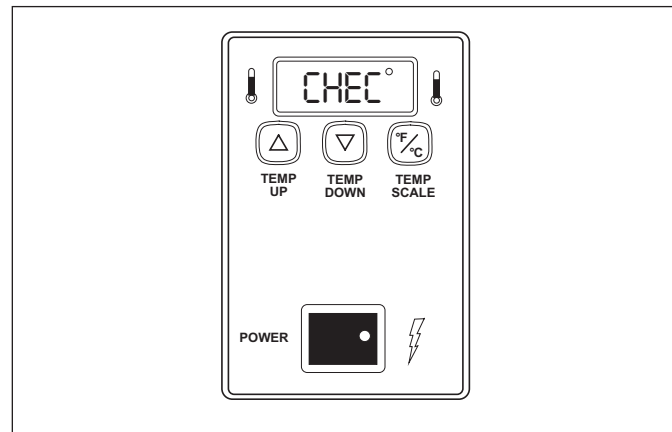

Figure 6. “CHEC” Fault Message

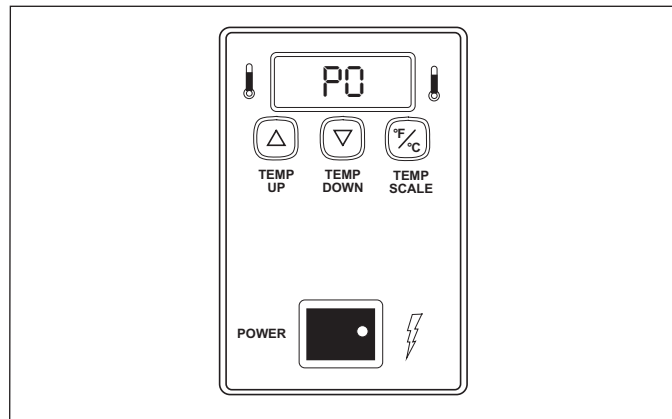

Figure 7. “PO” Fault Message



Vertical Contact Toaster | VCT-2000



VCT-2000

For more than 25 years, the Vertical Contact Toaster has been a staple in foodservice operations, building a reputation for quality, performance, and reliability throughout the world.

The Vertical Contact Toaster gives buns a consistent, golden brown finish so they don't soak up the juices of the ingredients, helping the sandwich stay firm and delicious. With a dual-sided platen, the Vertical Contact Toaster has more capacity than conventional single-sided toasters, allowing operations to quickly serve fresh products to customers without making them wait.

The VCT-2000 features a digital controller for making precise adjustments to the quality of the toast. A built-in auxiliary heater warms the top sides of the buns to help keep the assembled sandwich warmer for longer. This unit also utilizes belt wraps to minimize bun marking.

To ensure your toaster operates properly in your restaurant, please use the recommended settings listed below.

RECOMMENDED SETTINGS

Bun Thickness Settings

Crowns - #6

Heels - #4

Temperature Settings

Platen Heater - 585°F (370°C)

Auxiliary Heaters - 400°F (204°C)



Antunes delivers a complete range of countertop cooking equipment and water filtration solutions to foodservice operations around the world. Learn more about Antunes and its products at www.antunes.com.

Corporate Headquarters

Carol Stream, Illinois
Phone: (630) 784-1000
Toll Free: (800) 253-2991
Fax: (630) 784-1650

China Facility

Suzhou, China
Phone: 86-512-6841-3637
Fax: 86-512-6841-3907



Maintenance

⚠ WARNING ⚠

Turn the power off, unplug the power cord, and allow the unit to cool down 30 minutes before performing any service or maintenance.

⚠ CAUTION ⚠

To prevent damage to the unit, do NOT use abrasive cleaners on the Release Sheet or Belt Wrap.

⚠ CAUTION ⚠

Failure to use Release Sheets may result in damage to the unit and loss of warranty coverage.

Daily Maintenance

Tools Required:

- Heat-Resistant Gloves
- Clean Towels
- Multipurpose Detergent Solution
- Sanitizer Solution

1. Turn the power off, unplug the power cord, and clean the Release Sheet and Belt Wraps while they are warm.
2. Put on heat-resistant gloves and remove the Butter Wheel (if equipped), Pan, and Heat Shield (Figure 1).
3. Wash the Butter Wheel, Pan, and Heat Shield in a sink and wipe them with a damp sanitized towel and allow them to air dry.
4. Remove the Release Sheet and place it on a clean, flat dry surface.
5. Wipe the silver side of the Release Sheet with a **clean** towel dampened with Multipurpose Detergent Solution immediately followed by a second clean towel dampened with sanitizer and allow it to air dry before continuing.

6. Once the silver side is dry, repeat Step 5 on the black side of the Release Sheet.
7. Open the front Conveyor Cover and firmly wipe the Belt Wrap from left to right and top to bottom with a clean towel dampened with Multipurpose Detergent Solution immediately followed by a second clean towel dampened with sanitizer.
8. Close the front Conveyor Cover, open the rear Conveyor Cover, and clean the Belt Wrap as described in Step 7.
9. Close the rear Conveyor Cover. Reinstall the Heat Shield, plug in the power cord, turn the unit on, count 15 seconds, then turn the unit off and unplug the unit.
10. Open the rear Conveyor Cover again and clean the newly exposed section of the Belt Wrap in the same manner as before. Close the Conveyor Cover.
11. Open the front Conveyor Cover again and clean the newly exposed section of the Belt Wrap in the same manner as before.
12. Close the front Conveyor Cover and wipe down the outside of the toaster with a clean, damp, sanitized towel.
13. Install the Release Sheet by draping it over both sides of the Platen with the crease centered on the Platen.

NOTICE: To prolong the life of the Release Sheet, rotate it from the black side to the silver side on a daily or weekly basis.

14. Install the Bun Chute so the hooks are installed over the lower rear yellow Support Rod.
15. Install the Heat Shield with the Release Sheet retainer clips securely over the Release Sheet and Platen.
16. Reinstall the Butter Wheel and Pan, and plug in the unit.

NOTICE: Make sure the Heat Shield is activating the Conveyor Safety Interlock Switch. The conveyors will not rotate unless the Heat Shield is in place and the Conveyor Safety Interlock Switch is activated.

NOTICE: Check the Release Sheet to make sure it is not caught in the Conveyor. Additional Release Sheets can be purchased through your Authorized Service Agency under P/N 7000249 (3-Pack) or 7000250 (10-Pack).

Replacing the Black and Silver Release Sheet

(Every 4–6 Weeks)

NOTICE: Depending on toaster usage and on how well it is cleaned daily, the black and silver Release Sheet should last between 4–6 weeks.

1. Remove and discard the Release Sheet.
2. Lay a new Release Sheet on a clean, dry surface and fold it in half lengthwise and gently crease it at the fold using only your fingers (Figure 8).
3. Install the Release Sheet just as you would after Daily Cleaning.

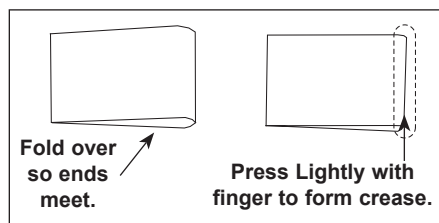

Figure 8. Folding the Release Sheet

Replacing the Belt Wraps

(Every 3–6 Months)

NOTICE: Depending on toaster usage and how well they are cleaned daily, the Belt Wraps should last between 3–6 months. Additional Belt Wraps may be purchased from your Authorized Service Agency.

1. Turn the power off, unplug the power cord, and allow the unit to cool.
2. Remove the Bun Feeder, Butter Wheel, Pan, and Heat Shield (Figure 1) and set the Bun Thickness Compression Knobs to 6 & 6.
3. Open both Conveyor Covers and pull the Belt Wrap Pin out of the zipper (Figure 9).

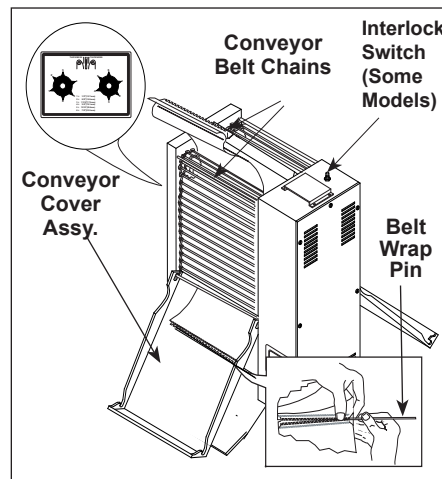

Figure 9. Removing Belt Wrap

4. Remove and discard the old Belt Wrap(s).
5. Clean both Conveyor Belt Chains just as you would clean the Belt Wraps during Daily Cleaning.
6. Install the new Belt Wraps around the Conveyor Belt Chains inside the Upper and Lower Support Rods with the zipper flap exposed and hanging down (Figures 10 & 11). Attach Belt Wrap clips (if present) to large links evenly.
7. Close the Conveyor Cover(s), set the Bun Thickness Compression Knobs back to their normal settings and reinstall the Heat Shield, Butter Wheel, Pan, and Bun Feeder.

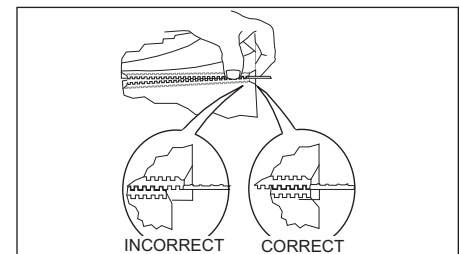

Figure 10. Aligning Belt Teeth

⚠ CAUTION ⚠

Align the ends of the Belt Wrap properly (Figure 11) or the Belt Wrap may be damaged.

⚠ CAUTION ⚠

Position the Belt Wrap between the Upper and Lower Support Rods or damage to the unit may occur.

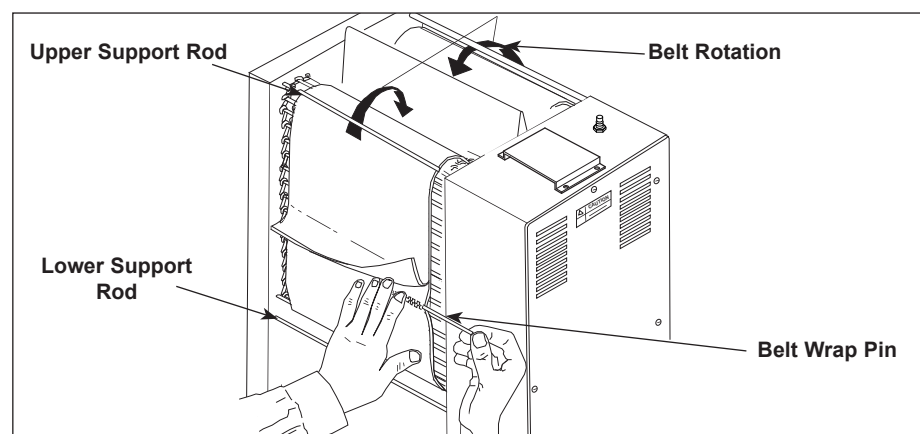

Figure 11. Installing Belt Wrap

Checking the Conveyor Belt Chains

(Every 3–6 Months)

NOTICE: The Bun Thickness Compression Knobs (Figure 3) must be set to “6 & 6” prior to measuring or removing or reinstalling the Conveyor Belt Chains.

Measuring Conveyor Belt Chains

1. Turn the unit off, unplug the power cord, and allow the unit to cool.
2. Remove the Bun Feeder, Butter Wheel, Pan, and Heat Shield (Figure 1) and set the Bun Thickness Compression Knobs to 6 & 6.
3. Open both Conveyor Covers and pull the Belt Wrap Pin out of the zipper (Figure 9).
4. Remove the Belt Wrap.
5. Facing the toaster, locate the approximate center-point of the Conveyor Chain.
6. Pull the Conveyor Chain away from the edge of the toaster (Figure 12).
7. Stand a U.S. Dime on end between the frame and the chain (Figure 12).
8. If the gap is significantly wider than the coin, REMOVE links as described below.
9. Disconnect the Conveyor Belt Chain by squeezing any two links together and unhooking both ends one link (Figure 13). Needle-nose pliers may be used.

NOTICE: There are two small 1/2” links on each side of the Conveyor Belt Chain. The rest are large 3/4” links.

10. Remove one 1/2” link from the belt.
11. Reassemble the Conveyor Belt Chain onto the sprockets as described in Replacing Conveyor Belt Chains.

12. Measure the gap again to ensure it is not too tight.
13. Check the opposite side of the toaster using the same steps.

NOTICE: If the Conveyor Belt Chain is too tight to be reassembled, remove an additional small 1/2” link and install a large 3/4” link in its place. This will increase the length of the Conveyor Belt Chain by 1/4” overall.

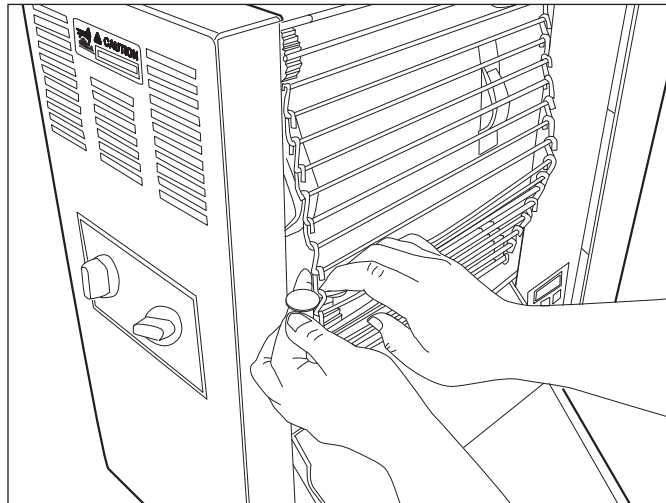

Figure 12. Measuring Conveyor Belt Chain

Replacing conveyor belt Chains

1. Turn the power off, unplug the power cord, and allow the unit to cool.
2. Remove the Butter Wheel, Pan, and Heat Shield and set the Compression Control Knobs to 6 & 6.
3. Open both Conveyor Covers and pull the Belt Wrap Pin out of the zipper.
4. Remove and discard the old Belt Wrap(s).
5. Disconnect the Conveyor Belt Chain by squeezing any two links together and unhooking both ends of one link (Figure 13).
6. Place the replacement Conveyor Belt Chain on the top sprockets with hook ends down.

NOTICE: The ends of the hooks must point down (Figure 13).

7. Wrap the Conveyor Belt Chain around the top and lower sprockets and connect by hooking both ends together.

NOTICE: Make sure the Conveyor Belt Chain is installed between the Upper Support Rod and the Lower Support Rod.

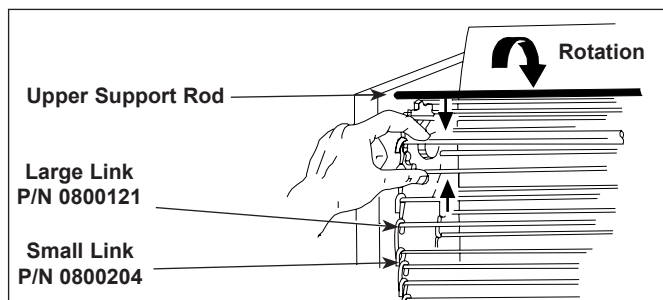

Figure 13. Removing Conveyor Belt Chain

Checking the Roller Tensioners

(Every 3–6 months)

Measuring the Roller Tensioners

1. Measure the Roller Tensioner on both inner Conveyor Covers (Figure 14) using a U.S. Nickel.
2. The space between the inner Conveyor Cover and bottom of the Tensioner wheel should be $13/16"$ (2.1 cm) or the height of a U.S. Nickel.
3. Adjust or replace any damaged ones as recommended.

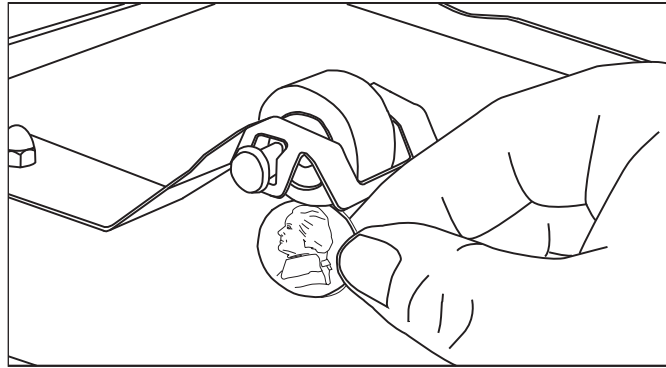

Figure 14. Measuring Roller Tensioner

Replacing the Roller Tensioners

1. Push down on retaining tab of the tensioner.
2. While keeping pressure on the retaining tab, slide the tensioner out of the guide plate.
3. Replace the tensioner by sliding the new one into the retainer plate.

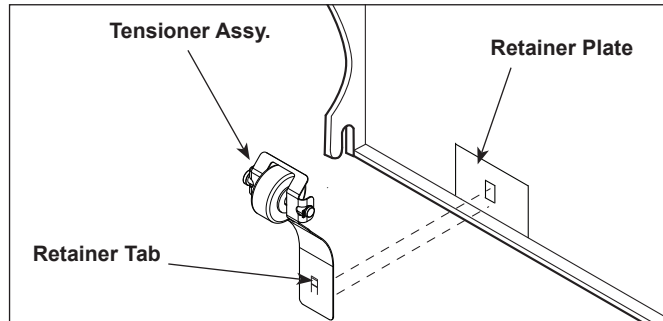

Figure 15. Replacing Roller Tensioner Assy.

Troubleshooting

⚠ WARNING ⚠

To avoid possible personal injury and/or damage to the unit, inspection, test and repair of electrical equipment should be performed by qualified service personnel. The unit should be unplugged when servicing, except when electrical tests are required. Use extreme care during electrical circuit tests. Live circuits will be exposed.

| Problem | Possible Cause | Corrective Action |
|--|---|---|
| Control Display flashes “ LO ” continuously. Buns not toasting properly. | Platen temperature is below 440°F (226°C). | Allow the unit to warm up for 30 minutes and then recheck. If the Control Display still reads “ LO ”, contact your maintenance person or Authorized Service Agency for service. |
| Control Display flashes “ LO ” continuously. Buns burn. | Failed Platen Thermocouple. | Contact your maintenance person or Authorized Service Agency for service. |
| | Failed Control Board. | |
| Control Display flashes “ PO ” continuously. | The power to the unit is below 190 volts. | Turn the power off and then on. If the display still shows “ PO ”, check the power cord, plug, and outlet for damage. |
| | Failed Control Board. | Reset the Circuit Breakers. |
| | Failed Transformer. | Contact your maintenance person, Authorized Service Agency, or electrician for service. |
| Control Display flashes “ CHEC ” continuously. | Control Compartment temperature is above 140°F (60°C). | Verify side vents on toaster are unblocked and not near other heating appliances. If problem still persists, contact your maintenance person or Authorized Service Agency for service. |
| | Failed Cooling Fan. | |
| | Failed Control Board. | |
| Control Display flashes “ HI ” continuously. Buns burn. | Failed Platen Solid State Relay. | Contact your maintenance person or Authorized Service Agency for service. |
| | Failed Control Board. | |
| | Failed Platen Thermocouple. | |
| Control Display flashes “ HI ” continuously. Buns not toasting properly. | Loose Platen Thermocouple connection on Control Board or the Platen Thermocouple is open. | Resecure the Platen Thermocouple connection to the Control Board. If the Control Display still reads “ HI ”, check the Thermocouple for continuity. |
| | Failed Control Board. | Contact your maintenance person or Authorized Service Agency for service. |
| Control Display flashes “ HI ” and “ LO ” at cold start up, then “ HI ” and “ USE ” after 20–30 minutes. | Loose Auxiliary Thermocouple connection on Control Board or Thermocouple is open. | Resecure the Auxiliary Thermocouple connection to the Control Board. If the Control Display still reads “ HI ” and “ LO ” or “ HI ” and “ USE ”, check Thermocouple for continuity. Contact your maintenance person or Authorized Service Agency for service. |
| No Control Display. | Unit not plugged in. | Plug unit into the proper electrical outlet. |
| | Hi-Limit control has tripped. | Allow unit to cool and reset the Hi-Limit control. If it trips again, contact your maintenance person or Authorized Service Agency. |
| | Circuit Breakers turned off or tripped. Damaged electrical outlet, plug, or cord. Power Switch damaged. | Reset Circuit Breakers. If they trip again, check the cord, plug, and outlet for damage. Contact your maintenance person, Authorized Service Agency, or electrician. |

Troubleshooting Continued

| Problem | Possible Cause | Corrective Action |
|-------------------------------|--|--|
| Conveyor does not turn. | Safety Interlock Switch (some models) is not activated. | Reposition the Heat Shield properly. If the Interlock Switch has failed, order kit 7001436 to remove and bypass the Interlock Switch. |
| | Heat Shield is bent or damaged. | Replace Heat Shield (See Replacement Parts) |
| | Damaged or Missing Roller Tensioner(s). | Adjust or replace Roller Tensioner(s). |
| | Conveyor Belt/Chain has stretched. Chain skipping on sprockets. | Measure and adjust the Conveyor Belt Chains as described in the Maintenance section of this manual. |
| | Motor Drive Chain came off Sprocket(s). | Reinstall Drive Chain. |
| | Drive Chain needs lubrication. | Lubricate chain with P/N 2190152. |
| | Drive Motor has overheated. | Allow unit to cool and check Conveyor(s) for obstructions or binding at sprockets. Measure and adjust Conveyor Belt(s) as described in the Maintenance section of this manual. |
| | Drive Motor has failed. | Contact your maintenance person or Authorized Service Agency for service. |
| Buns not toasting adequately. | Compression Settings are incorrect. | Use the recommended settings. Set Heel to 4 and Crown to 6. |
| | Temperature Setting is incorrect. | Verify that the Platen (SP-P) is set to 585°F (307°C) and the Auxiliary (SP-A) is set to 400°F (204°C). For making changes to the setpoint temperature, see the Installation section of this manual. |
| | Release Sheet is worn or needs cleaning (replace every 4–6 weeks). | Inspect Release Sheet for cleanliness, worn spots, tears, or wrinkles. Clean or replace Release Sheet as described in the Maintenance section of this manual. |
| | Belt Wraps are worn or need cleaning (replace every 3–6 months). | Replace or clean Belt Wraps as described in the Maintenance section of this manual. |
| | Belt Wraps are not tacky/sticky. | Clean or replace Belt Wraps as described in the Maintenance section of this manual. |
| | Buns do not meet specifications. | Contact your bun supplier. |
| | Non OEM Release Sheets used. | Use only OEM Release Sheets (P/N 7000249 & 700250). |

Troubleshooting Continued

| Problem | Possible Cause | Corrective Action |
|---|---|--|
| Crowns and/or Heels must be forced into the toaster. Buns sticking and burning. | Belt Wraps not being cleaned properly. | Clean Belt Wraps as described in the Maintenance section of this manual. |
| | Conveyor Belt Wraps are not tacky/ sticky (replace every 3–6 months). | Clean Belt Wraps. If the Belt Wraps are too worn, replace them as described in the Maintenance section of this manual. |
| | Belt Wraps are dirty, worn, or damaged (replace every 3–6 months). | Clean or replace Belt Wraps as described in the Maintenance section of this manual. |
| | Release Sheet is not being cleaned properly. | Clean both sides of the black and silver Release Sheet as described in the Maintenance section of this manual. |
| | Release Sheet is not being reversed as required. | Reverse the Release Sheet or replace Release Sheet as described in the Maintenance section of this manual. |
| | Release Sheet is dirty, worn, or damaged (replace every 4–6 weeks). | Clean or replace Release Sheet as described in the Maintenance section of this manual. |
| | Conveyor Belt Chains are skipping on Sprockets. | Measure and adjust the Conveyor Belt Chains as described in the Maintenance section of this manual. |
| | Conveyor Safety Interlock Switch (some models) is not being activated by the Heat Shield. | Heat Shield is ajar. Reposition Heat Shield. |
| | | Heat Shield is damaged. Replace if necessary. If the Interlock Switch has failed, order kit 7001436 to remove and bypass the Interlock Switch. |
| | Belt Wraps slipping over Conveyor Belt Chains. | Remove Belt Wraps and clean the Conveyor Belt Chain links and Belt Wraps as described in the Maintenance section of this manual. |
| | Roller Tensioner(s) damaged or missing. | Reinstall or replace Roller Tensioner(s) as described in the Maintenance section of this manual. |
| | Drive Motor stalls intermittently. | Contact your maintenance person or an Authorized Service Agency for service. |
| | Compression Settings are incorrect. | Use the recommended settings. Set Heel to 4 and Crown to 6. |
| | Buns are not inserted into the toaster properly. | Buns must be inserted with the cut sides facing each other on the correct Heel or Crown side. |
| | Non OEM or damaged Belt Wraps used. | Use only OEM Belt Wraps (P/N 7000416). |
| New Conveyor Belt Wraps do not fit. | Compression Settings are incorrect. | Set Compression Knobs to 6 and 6 when replacing Belt Wraps or when adjusting Conveyor Belt Chains. |
| | Belt Wraps not installed correctly. | Install Belt Wraps inside the Support Rods with the zipper flap exposed and hanging down. |
| | Non OEM or damaged Belt Wraps used. | Use only OEM Belt Wraps (P/N 7000416). |

Troubleshooting Continued

| Problem | Possible Cause | Corrective Action |
|-------------------------------|--|--|
| Toaster makes unusual sounds. | Compression Settings are too tight. | Set Compression Settings to the correct (or larger) setting. |
| | Conveyor Belt Wrap is installed incorrectly. | Belt Wraps must be installed as described in the Maintenance section of this manual. |
| | Belt Wrap Pin rubbing on housing. | Center the Pin in the Belt Wrap zipper. |
| | Roller Tensioner(s) bent or missing. | Measure, adjust, or replace the Roller Tensioner(s) as described in the Maintenance section of this manual. |
| | Conveyor Belt Chains have stretched. | Measure and adjust the conveyor Belt Chains as described in the Maintenance section of this manual. |
| | Conveyor Belt Chains adjusted incorrectly. | |
| | Sugar and/or carbon has accumulated inside the Conveyor Belt Wrap and between the Conveyor Belt chain and Tensioner Slide Rails. | Remove Belt Wraps, clean conveyor Belt Chain links just as you clean the Belt Wraps daily, and then clean the Slide Rails on the Tensioners. Next, clean the Belt Wrap on both sides before reinstalling it. |
| | Motor Drive Chain needs lubrication. | Lubricate the Drive Chain carefully with P/N 2140152 at least once a year. |
| | A Conveyor Shaft bearing is binding. | Contact your maintenance person or Authorized Service Agency for service. |

Replacement Parts

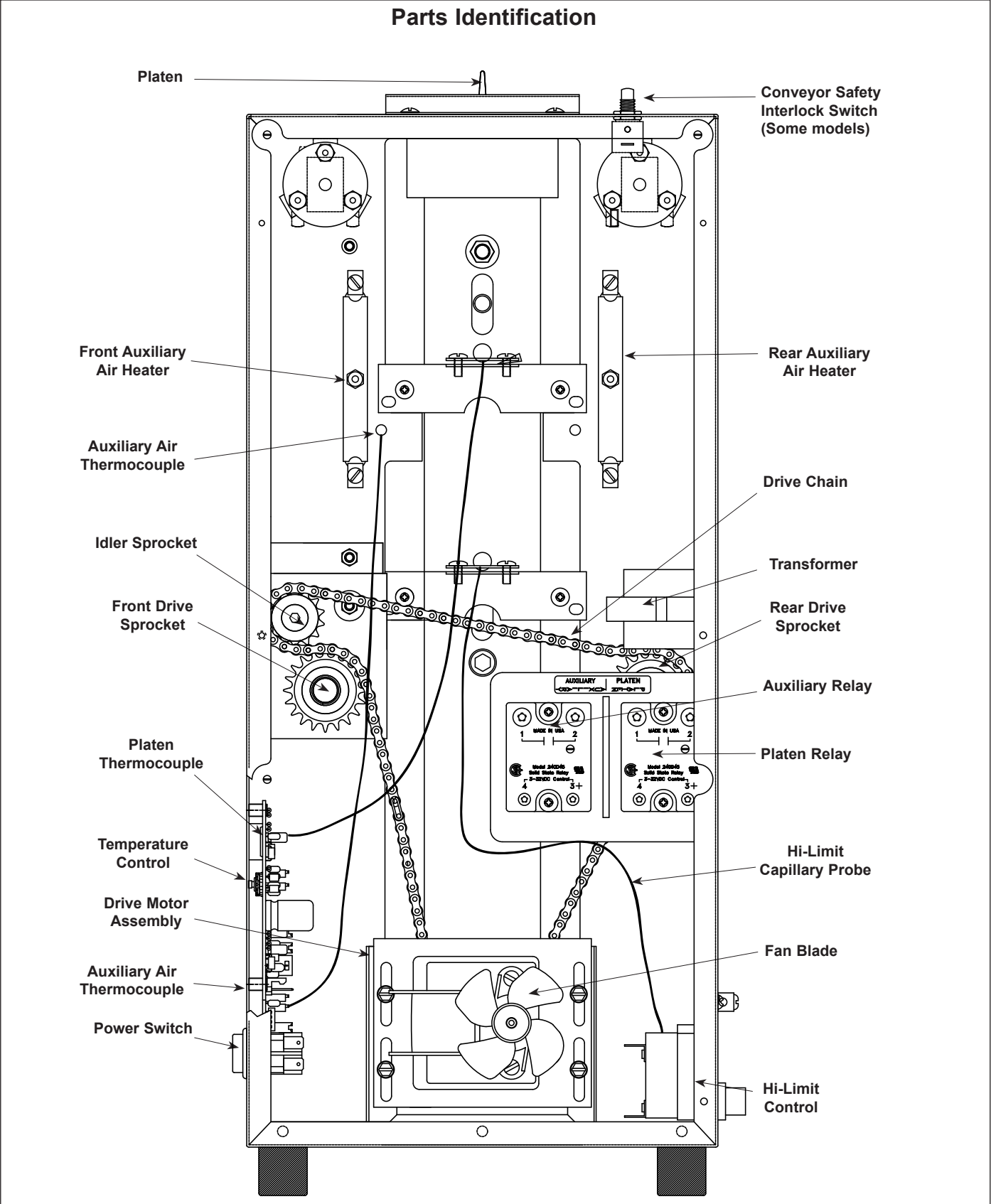

Replacement Parts Continued

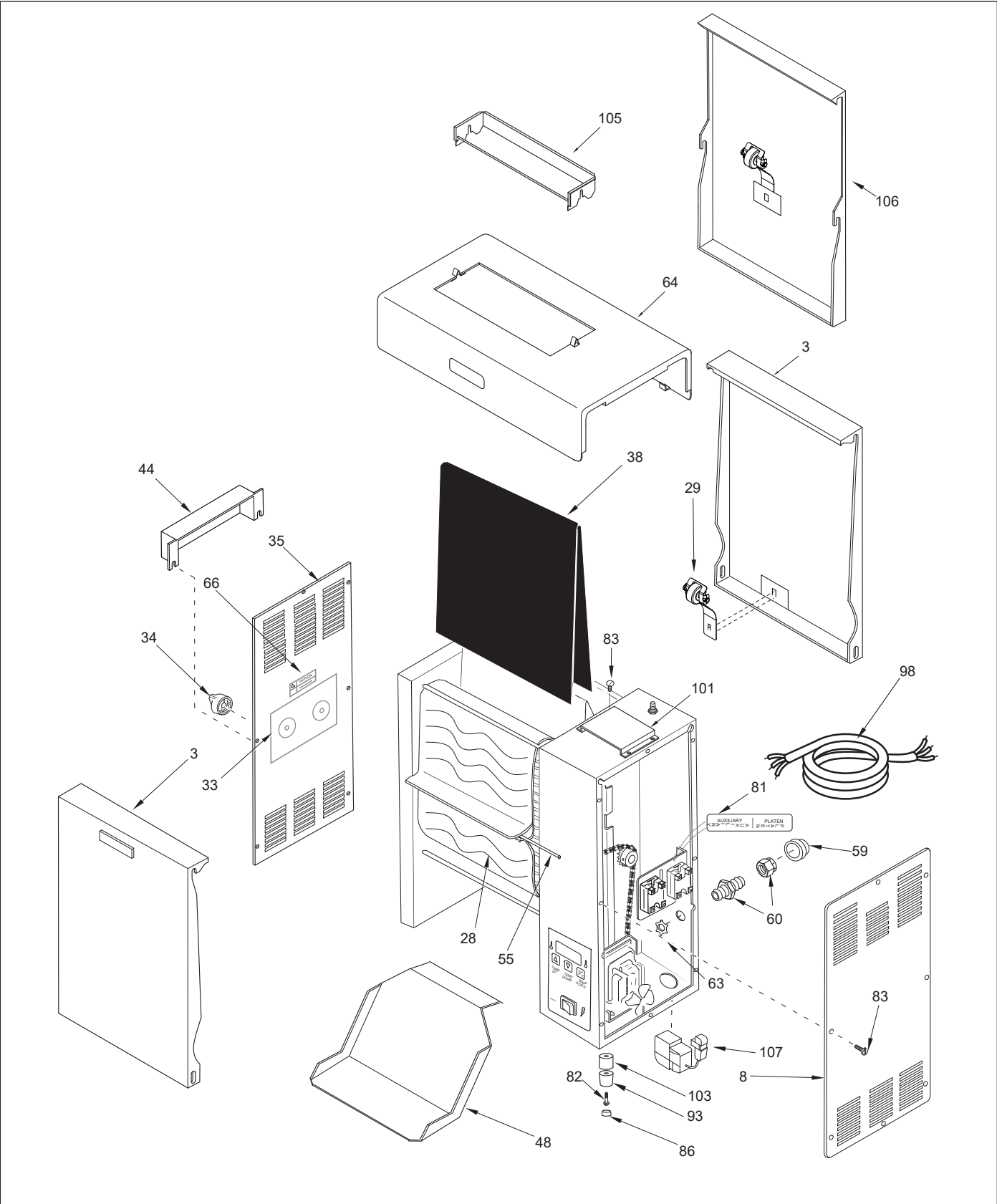

Replacement Parts Continued

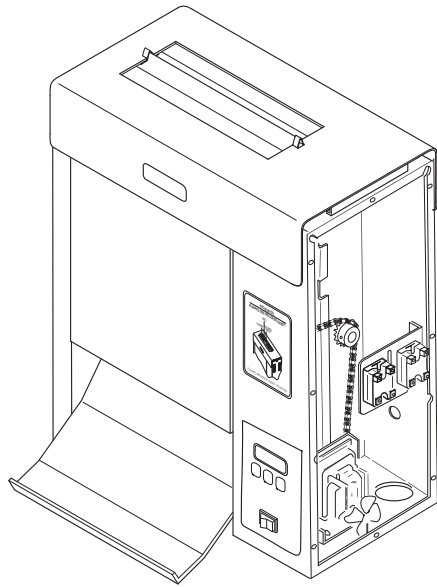

NOTICE: As of March 2017, the Interlock Switch (item 97) is discontinued from use. If your toaster has the Interlock Switch and it fails, order kit 7001436 to remove and bypass the Interlock Switch.

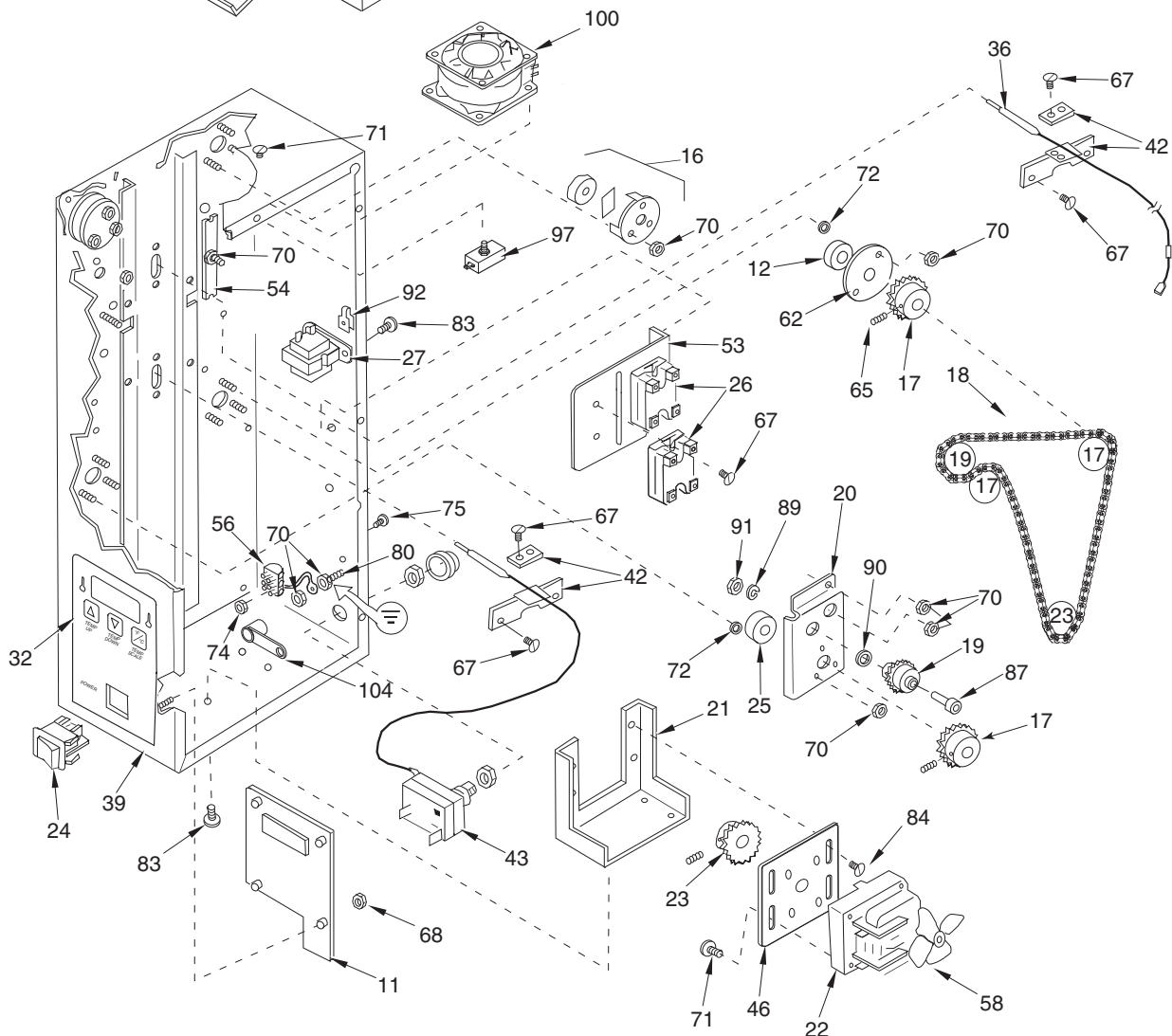

[illegible]

Replacement Parts List

NOTICE

Use only genuine Antunes replacement parts in this egg station. Use of parts other than those supplied by the manufacturer will void the warranty.

| Item No. | Part # | Description | QTY. |
|----------|---------|---|------|
| 1 | 0011266 | Conveyor Belt (Incl. items below) | 2 |
| | 0800204 | 1/2" Pitch Link, Small | 2 |
| | 0800121 | 3/4" Pitch Link, Large | 38 |
| 2 | 2150117 | Idler Shaft | 2 |
| 3 | 7000322 | Conveyor Cover Assy. (Incl. #29, 52, 61, 76) | 2 |
| 4 | 0010475 | Tensioner Assy. (Incl. #40, 76, 85) | 4 |
| 5 | 7000644 | Rod, Conveyor Cover | 4 |
| 6 | 7000207 | Sprocket w/ set screw | 8 |
| 7 | 7000199 | Spacer Kit | 1 |
| 8 | 0011444 | Control Housing Cover Assy. | 1 |
| 9 | 2150118 | Drive Shaft | 2 |
| 11 | 7000287 | Control Board | 1 |
| 16 | 7000167 | Bearing & Retainer Kit | 6 |
| 16a | 7000224 | Bearing & Retainer Kit (Incl. Six of #16) | 1 |
| 16b | 7000539 | Bearing & Spacer Kit (Incl. #11, 12, & 16) | 1 |
| 17 | 2150109 | Drive Sprocket | 2 |
| 18 | 2150290 | Drive Chain | 1 |
| 19 | 0011299 | Idler Sprocket & Bearing | 1 |
| 20 | 0011300 | Bracket, Idler Sprocket Assy (Incl. #91, 89, 90, 19, 87) | 1 |
| 21 | 0503589 | Bracket, Motor Mounting | 1 |
| 22 | 7000240 | Drive Motor Kit, Dual Fre- quency 50/60 Hz (Incl. #58) | 1 |
| 23 | 2150267 | Sprocket w/Setscrew | 1 |
| 24 | 7000542 | Rocker Switch, On/Off (250 VAC) | 1 |
| 25 | 7000296 | Ball Bearing (2-Pack) | 1 |
| 26 | 7000652 | Relay, Solid State | 2 |
| 27 | 4010187 | Transformer | 1 |
| 28 | 7000964 | Black Wavy Belt W/ Clips (2-Pack) | 1 |
| 29 | 0013373 | Roller Tensioner Assy. | 2 |
| 30 | 0503496 | Tensioner Bracket, Right | 2 |
| 31 | 0503497 | Tensioner Bracket, Left | 2 |
| 32 | 1001006 | Label, Control | 1 |
| 33 | 1001069 | Label, Dial Compression | 1 |
| 34 | 2100253 | Knob, Control | 2 |
| 35 | 0011445 | End Housing Cover Assy. | 1 |
| 36 | 4050214 | Thermocouple Platen Assy. | 1 |
| 37 | 0021170 | Weldment, End Housing | 1 |

| Item No. | Part # | Description | QTY. |
|----------|----------|--|------|
| 38 | 7000249 | Release Sheet (3-Pack) | - |
| | 7000250 | Release Sheet (10-Pack) | - |
| 39 | 0021169 | Control Housing | 1 |
| 40 | 7000121 | Slide Rail Kit (Includes two Slide Rails for Tensioners & #85) | 2 |
| 41 | 0021207 | Conveyor Cam | 2 |
| 42 | 7000176 | Thermocouple Retainer Kit | 2 |
| 43 | 4030332 | High Limit Control | 1 |
| 44 | 0503544 | Guard, Knob | 1 |
| 45 | 0503455 | Tension Spring, Inner | 4 |
| 46 | 0503590 | Bracket, Motor | 1 |
| 47 | 0700580 | Wire Set (not shown) | 1 |
| 48 | 0503677 | Bun Chute | 1 |
| 49 | 4030349 | Auxiliary Heater, 675W/208V | 2 |
| 50 | 7000165 | Auxiliary Thermocouple Kit | 1 |
| 51 | 7000288 | Platen (208V) | 1 |
| 52 | 2100252 | Tape | 3 |
| 53 | 0503359 | Bracket, Relay | 1 |
| 54 | 0503150 | Heater Clip | 2 |
| 55 | 303P127* | Hinge Pin, Belt Wrap | 2 |
| 56 | 4060355 | Terminal Block | 1 |
| 57 | 0503533 | Bracket, Auxiliary Thermocouple | 1 |
| 58 | 4000170 | Fan Blade, Motor | 1 |
| 59 | 2180128 | 7/8" Hole Plug | 1 |
| 60 | 040K251 | Strain Relief (Incl. #63) | 1 |
| 61 | 05P2199* | Spacer | 3 |
| 62 | 0500464 | Retainer, Bearing | 1 |
| 63 | 040P138* | Locknut, 1/2" | 1 |
| 64 | 0012330 | Heat Shield Assy. with Dampers | 1 |
| 65 | 325P163* | Setscrew, 1/4-28 x 5/16" | 8 |
| 66 | 1001192 | Label, Caution Hot | 1 |
| 67 | 308P183* | Screw, Hex, #8-32 x 3/8" | 2 |
| 68 | 304P105* | Nut, #4-40, "KEPS" | 4 |
| 69 | 406P107* | Cable Tie | 1 |
| 70 | 308P143* | Nut, #8-32, "KEPS" | 6 |
| 71 | 310P103* | Screw, Hex, #10-32 x 1/4" | 4 |
| 72 | 310P157* | Washer, #10 | 6 |
| 73 | 308P101* | Nut, #8-32 | 3 |
| 74 | 306P101* | Nut, Hex, #6-32 | 2 |
| 75 | 306P123* | Screw, #6-32 x 7/8" | 2 |
| 76 | 308P145* | Nut, Hex Acorn, #8-32 | 12 |
| 77 | 100P900* | Label, Service | 1 |
| 78 | 325P104* | Washer, 1/4" | 4 |
| 79 | 325P109* | Screw, 1/4-20 x 1/2" | 4 |

Replacement Parts List Continued

| Item No. | Part # | Description | QTY. |
|--------------------------------|----------|---------------------------------------|------|
| 80 | 308P124* | Screw, 1-Way, #8-32 x 1/2" | 1 |
| 81 | 10P1022* | Label, Heaters | 1 |
| 82 | 310P180* | Screw, #10-32 x 1-3/4" | 4 |
| 83 | 308P133* | Screw, #8-32 x 1/4" | 1 |
| 84 | 308P157* | Screw, Tap, #8-32 x 3/8" | 20 |
| 85 | 308P181* | Screw, Flat Hd., #8-32 x 3/8" | 4 |
| 86 | 218P145* | Cover, Leg, Bumper | 4 |
| 87 | 331P103* | Shoulder Bolt, 5/16-18 x 1" | 1 |
| 88 | 306P105* | Screw, #6-32 x 1/2" | 8 |
| 89 | 331P106* | Lockwasher, 5/16" | 1 |
| 90 | 212P118* | Flat Washer, 5/16" | 1 |
| 91 | 331P101* | Nut, Hex, 5/16 x 18" | 1 |
| 92 | 300P102* | Nut, Tinnerman | 2 |
| 93 | 210K230 | Bumper, Recess Leg, 1" (Qty. of 4) | 1 |
| 94 | 0503495 | Retainer, Tensioner Bracket, RH | 1 |
| 95 | 0503507 | Retainer, Tensioner Bracket, LH | 1 |
| 96 | 2100259 | Slide Bar | 4 |
| 97 | 7000400 | Interlock Switch (Some Models) | 1 |
| 98 | 0700452 | Power Cord | 1 |
| 99 | 306P104* | Screw, #6-32 x 1/4" | 6 |
| 100 | 4000138 | Fan | 1 |
| 101 | 0503775 | Duct, Fan | 1 |
| 102 | 1001056 | Label, Crown & Heel | 1 |
| 103 | 2120147 | Leg Spacers | 4 |
| 104 | 4060374 | Ground Lug | 1 |
| 105 | 7000292 | Bun Feeder Kit | 1 |
| 108 | 2140152 | Lubricant (not shown) | 1 |
| * Sold only as packages of 10. | | | |

Wiring Diagram

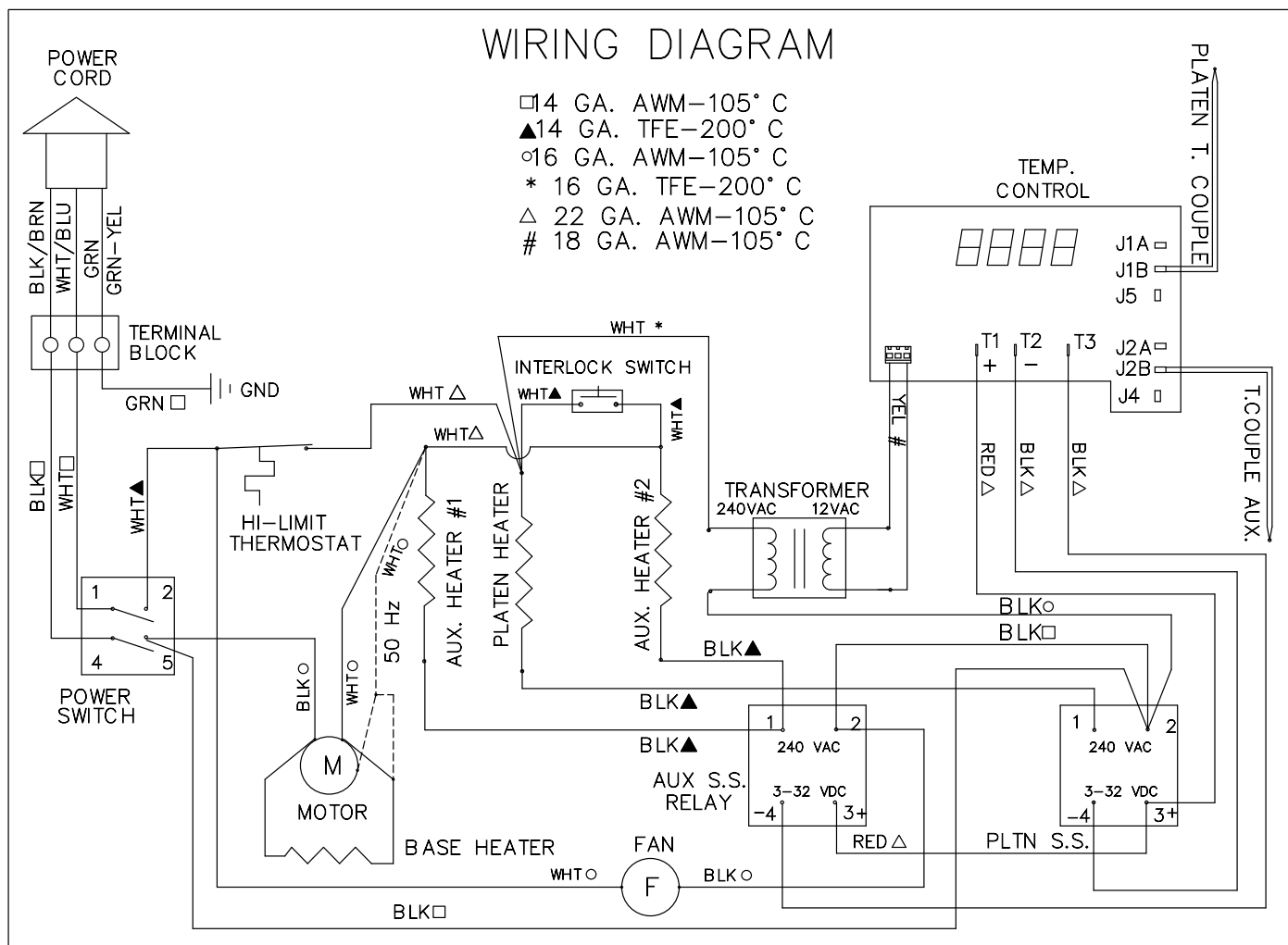

*Motor connections: 50hz requires male to male adapter (not included).

Wiring Diagram Continued

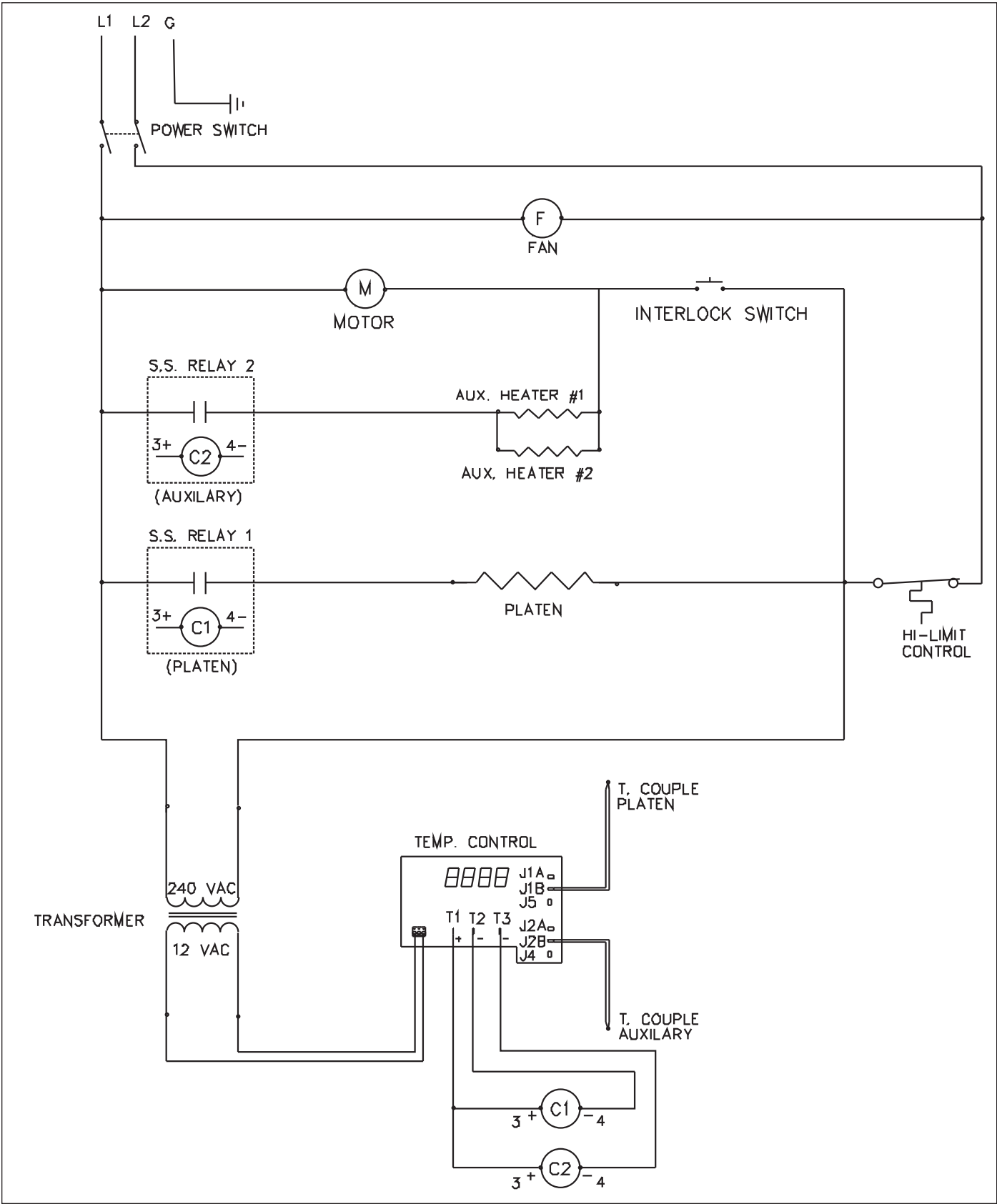

Limited Warranty

Equipment manufactured by Antunes has been constructed of the finest materials available and manufactured to high quality standards. These egg stations are warranted to be free from electrical and mechanical defects for a period of one (1) year from date of purchase under normal use and service, and when installed in accordance with manufacturer's recommendations. To insure continued operation of the egg stations, follow the maintenance procedures outlined in the Owner's Manual. During the first 12 months, electromechanical parts, non-overtime labor, and travel expenses up to 2 hours (100 miles/160 km), round trip from the nearest Authorized Service Center are covered.

This warranty does not cover cost of installation, defects caused by improper storage or handling prior to placing of the Equipment. This warranty does not cover overtime charges or work done by unauthorized service agencies or personnel. This warranty does not cover normal maintenance, calibration, or regular adjustments as specified in operating and maintenance instructions of this manual, and/or labor involved in moving adjacent objects to gain access to the equipment. This warranty does not cover consumable/wear items. This warranty does not cover damage to the Load Cell or Load Cell Assembly due to abuse, misuse, dropping of egg station/shock loads or exceeding maximum weight capacity (4 lbs). This warranty does not cover water contamination problems such as foreign material in water lines or inside solenoid valves. It does not cover water pressure problems or failures resulting from improper/incorrect voltage supply. This warranty does not cover Travel Time & Mileage in excess of 2 hours (100 miles/160 km) round trip from the nearest authorized service agency.

Antunes reserves the right to make changes in design or add any improvements on any product. The right is always reserved to modify equipment because of factors beyond our control and government regulations. Changes to update equipment do not constitute a warranty charge.

If shipment is damaged in transit, the purchaser should make a claim directly upon the carrier. Careful inspection should be made of the shipment as soon as it arrives and visible damage should be noted upon the carrier's receipt. Damage should be reported to the carrier. This damage is not covered under this warranty.

Warranty charges do not include freight or foreign, excise, municipal or other sales or use taxes. All such freight and taxes are the responsibility of the purchaser.

THIS WARRANTY IS EXCLUSIVE AND IS IN LIEU OF ALL OTHER WARRANTIES, EXPRESSED OR IMPLIED, INCLUDING ANY IMPLIED WARRANTY OR MERCHANTABILITY OR FITNESS FOR A PARTICULAR PURPOSE, EACH OF WHICH IS HEREBY EXPRESSLY DISCLAIMED. THE REMEDIES DESCRIBED ABOVE ARE EXCLUSIVE AND IN NO EVENT SHALL ANTUNES BE LIABLE FOR SPECIAL CONSEQUENTIAL OR INCIDENTAL DAMAGES FOR THE BREACH OR DELAY IN PERFORMANCE OF THIS WARRANTY.

The warranty does not extend to:

- Damages caused in shipment or damage as result of improper use.
- Installation of electrical service.
- Installation, calibration, or adjustment.
- Normal maintenance outlined in this manual.
- Malfunction resulting from improper service or maintenance.
- Damage caused by improper installation, abuse, or careless handling.
- Damage from moisture getting into electrical components.
- Damage from tampering with, removal of, or changing any preset control or safety device.
- Damage caused by parts or components not provided by Antunes



Corporate Headquarters

Carol Stream, Illinois
Phone: +1 (630) 784-1000
Toll Free: +1 (800) 253-2991
Fax: +1 (630) 784-1650

China Facility

Suzhou, China
Phone: +86-512-6841-3637
Fax: +86-512-6841-3907