



## 1000W Commercial Microwave



**Model:** 180MW1000D

05/2017

***Please read and keep these instructions. Indoor use only.***

## IMPORTANT SAFETY INSTRUCTIONS

**When using electrical equipment, basic safety precautions should be followed to reduce the risk of burns, electrical shock, fire, or injury to persons.**

**READ all of the instructions before using this equipment.**

1. This equipment **MUST BE GROUNDED**. Connect only to properly **GROUNDED** outlet. See "GROUNDING INSTRUCTIONS" on page 3 for further details.
2. Use this equipment **ONLY** for its intended use as described in this manual. This type of oven is specifically designed to heat, cook or dry food. It is not designed for industrial or laboratory use.
3. **DO NOT** heat items able to explode in this microwave, such as: eggs, sealed containers, glass jars, etc.
4. **DO NOT** operate this equipment if the cord, plug and/or door is damaged, if it is not working properly or if it has been damaged or dropped.
5. This equipment, including power cord, must be serviced **ONLY** by qualified service personnel. Contact the nearest authorized service facility for examination, repair, or adjustment.
6. **DO NOT** cover or block filter or other openings on equipment.
7. **DO NOT** store this equipment outdoors.
8. **DO NOT** use this product near water or immerse the cord and/or plug in water.
9. Keep cord **AWAY** from **HEATED** surfaces.
10. **DO NOT** let cord hang over edge of table or counter.
11. **DO NOT** overcook food as to avoid fire in oven cavity.
12. If materials inside the oven ignite, keep oven door **CLOSED**, turn oven off and disconnect the power cord, or shut off power at the fuse or circuit breaker panel.
13. **DO NOT** use the cavity for storage.
14. Do not overheat liquids.
15. After heating, allow the container to stand in the microwave oven for a short time before removing the container.
16. **DO NOT** operate equipment without load or food in oven cavity.
17. **DO NOT** use metal utensils in oven.
18. **NEVER** use paper, plastic, or combustible materials that are not intended for cooking.
19. Clean oven regularly and remove any food deposits.
20. For commercial use only.

**SAVE THESE INSTRUCTIONS**

**To avoid risk of electrical shock or death, this oven must be earthed.**

**To avoid risk of electrical shock or death, do not alter the plug.**

## OPENING YOUR NEW OVEN

1. Inspect oven for any damage such as cracks or dents in door or inside oven cavity.
2. Remove all materials from oven interior.
3. Remove all plastic wrap and packaging material before use.
4. Do not install oven next to or above source of heat, such as pizza oven or deep fat fryer. This could cause the microwave oven to operate improperly and could shorten life of electrical parts.
5. Install oven on a level countertop surface.
6. Outlet should be located so that the plug is accessible when oven is in place.

## GROUNDING INSTRUCTIONS

Oven **MUST** be grounded. Grounding reduces risk of electric shock by providing an escape wire for the electric current, if an electrical short occurs. This oven is equipped with a cord having a ground wire with a grounding plug. The plug must be plugged into an outlet that is properly installed and grounded. Do not use an extension cord.

## DIAL OPERATION

### Instructions

1. Open oven door, place food in oven, and close oven door.
2. Turn time entry knob clockwise to desired time.
  - Cooking time can be set up to 6 minutes.
  - Oven begins operation and time counts down.
3. When cooking time has elapsed, microwave energy stops and oven signal sounds.

### Interrupting Operation

Open oven door to interrupt operation or turn time entry knob counterclockwise to "0".

When cooking is interrupted by opening door, oven automatically resets to zero time.

To resume microwave oven operation, close door and re-enter desired time by turning knob clockwise.

### Changing Time and Canceling Mistakes

Heating time can be changed at any time while the oven is operating. Turn knob to desired new setting. To set cooking time to zero, turn knob counterclockwise to "0". Setting the time to zero cancels the set cooking time and turns the oven off.

#### Menu Guide

30-35 Sec Small Sandwich	1-2 Min Large Sandwich
1:30-2 Min Small Casserole	5-6 Min Large Casserole
7-12 Sec Roll or Pastry	1-2 Min Hamburger
25-35 Sec Hotdog	1:30-2 Min Cup of Soup
35-40 Sec Slice Of Pizza	

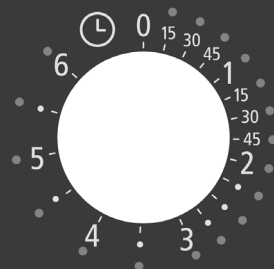

To operate:  
1: Rotate dial to set time.  
2: Open door to interrupt cooking.

## CARE AND CLEANING

**To avoid electrical shock which can cause severe personal injury or death, unplug power cord or open circuit breaker to oven before cleaning or removing light bulb.**

- Cleaning the interior and exterior will require a mild detergent, water and a soft sponge or cloth.
- Do not use cleaners that include ammonia or citrus.
- Do not use water pressure cleaning systems on your microwave.
- Inspect air vents monthly and clean using a damp cloth.

## TROUBLESHOOTING

COMPLAINT	POSSIBLE CAUSE	REMEDY
Dim oven light	Cooking at low power level	This is normal
Steam forms on oven door	When cooking foods in a microwave steam is generated.	This is normal
Hot air expelled from vents	Foods cooking in a microwave may release heat	This is normal
Oven does not start	Power cord not plugged in correctly	Plug cord into outlet correctly
	Fuse blown or circuit breaker open	Replace fuse (should be repaired by authorized servicer) or reset breaker
	Malfunctioning outlet	Test outlet with other electrical appliance
	Door not closed	Close door

## WARRANTY

### 6 MONTH REPLACEMENT WARRANTY

- This warranty is effective from the time of purchase.
- This warranty is not effective if damage occurs because of accident, carelessness, improper installation, lack of proper set – up, supervision when required or if the equipment is installed or operated in any manner contrary to the installation and operating instructions.
- Work performed by unauthorized personnel or unauthorized service agencies voids this Warranty
- This warranty does not apply to, and Solwave is not responsible for any warranty claims on products sold or used outside of the contiguous United States.
- This equipment is intended for commercial use only. Warranty is void if equipment is installed in anything other than commercial applications.

# AVA TOAST

COMMERCIAL TOASTERS

## USER MANUAL



## Adjustable Speed Conveyor Toaster

184T3300B 208V - 3300W (10" Wide Belt)

184T3300D 208V - 3300W (10" Wide Belt)

184T3600B 208V - 3600W (14½" Wide Belt)

184T3600D 208V - 3600W (14½" Wide Belt)

184T140 120V - 1750W (10" Wide Belt)

# INDEX

---

Important Safety Information .....	<b>2</b>
Circuit Diagram .....	<b>3</b>
Discharge Assembly .....	<b>4</b>
Before Using Your Conveyor Toaster .....	<b>5</b>
Using Your Conveyor Toaster .....	<b>5</b>
Cleaning & Maintenance .....	<b>6</b>
Specifications .....	<b>7</b>
Limited Warranty .....	<b>8</b>

# SAFETY

---

**When using electrical appliances, basic safety precautions should always be followed, including the following:**

1. Read all instructions carefully and completely.
2. For commercial use only.
3. DO NOT touch hot surfaces.
4. Protect against electrical shock by keeping all cords, plugs, and other electrical components away from water or other liquids.
5. Unplug this unit when not in use and before cleaning.
6. Allow the unit to cool before putting on or taking off parts.
7. DO NOT operate this or any appliance with a damaged electrical cord or plug.
8. DO NOT operate this or any appliance after it has malfunctioned or has been damaged in any way.
9. DO NOT use outdoors.
10. DO NOT place on or near a hot gas or electric burner.
11. Attach plug to appliance first, then plug electrical cord into the wall outlet.
12. Disconnect the unit by removing the electrical plug from the wall outlet.
13. DO NOT use appliance for any application other than intended use.
14. DO NOT insert metal utensils or oversized foods into this unit, as they may cause a fire and heighten the risk of electrical shock.
15. DO NOT store any item on top of this unit when in operation.
16. DO NOT allow this oven to touch or to be covered by flammable material, such as curtains, draperies, walls, etc., when in operation.
17. DO NOT clean with metal scouring pads, as pieces can break off and touch electrical components, heightening the risk of electrical shock.
18. Never place materials such as paper, cardboard, plastic, etc. in this oven.
19. DO NOT cover interior of this unit with metal foil, as it may cause the oven to overheat.
20. Avoid scratching the surface or nicking the edges of this unit. If the oven is damaged or broken, contact customer service before use.
21. Turn off the appliance by removing the plug from the wall outlet.
22. Note that the use of accessories not recommended by the manufacturer may result in injury.
23. Children should be supervised to ensure that they DO NOT play with the oven.
24. This appliance is not intended for use by persons (including children) with reduced physical sensory or mental capabilities, or lack of experience and knowledge, unless a person responsible for their safety has given them supervision or instruction concerning use of the appliance.
25. When using the appliance in shops, snack bars, hotels etc., check the voltage and outlet to make sure the appliance is correctly connected with power.
26. Place unit on a flat surface that is well ventilated. The appliance must be supervised during operation. DO NOT leave appliance without powering off.

**NOTE: Save these instructions for future reference.**



# CIRCUIT DIAGRAM

LEGEND	DESCRIPTION
XL	25A/300V
HL1	120V
QS	16A/250V
EH1, EH2	710W, 1040W/120V
∞	12x12/120V
M	120V/60Hz
R	30W/150
θS	90°C 16A/250V
D	IN5408/4A

## WIRING DIAGRAM

MODEL: CONVEYOR TOASTER  
184T140  
1.75kW/120VAC/50-60Hz

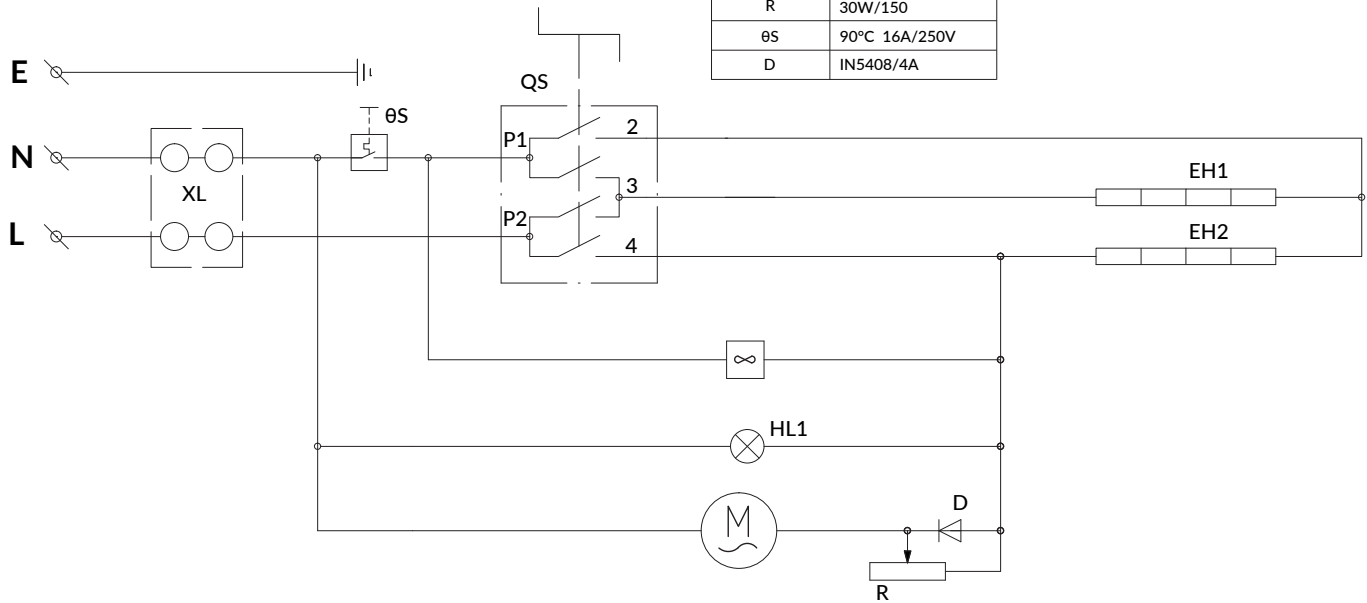

## WIRING DIAGRAM

MODEL : CONVEYOR TOASTER  
184T3300B 208V - 184T3600B 208V

LEGEND	DESCRIPTION
ER	ENERGY REGULATOR
E1 / E3	TOP ELEMENT - 1650W / 208V (1800W / 208V)
E2 / E4	BOTTOM ELEMENT 1650W / 208V (1800W / 208V)
H1	CONTROL PILOT LIGHT 240V
M 1	CONVEYOR MOTOR 208V
CF	COOLING FAN 240V
SC	CONVEYOR SPEED CONTROL

184T3300D 240V - 184T3600D 240V

LEGEND	DESCRIPTION
ER	ENERGY REGULATOR
E5 / E7	TOP ELEMENT - 1650W / 240V (1800W / 240V)
E6 / E8	BOTTOM ELEMENT 1650W / 240V (1800W / 240V)
H1	CONTROL PILOT LIGHT 240V
M	CONVEYOR MOTOR 240V
CF	COOLING FAN 240V
SC	CONVEYOR SPEED CONTROL

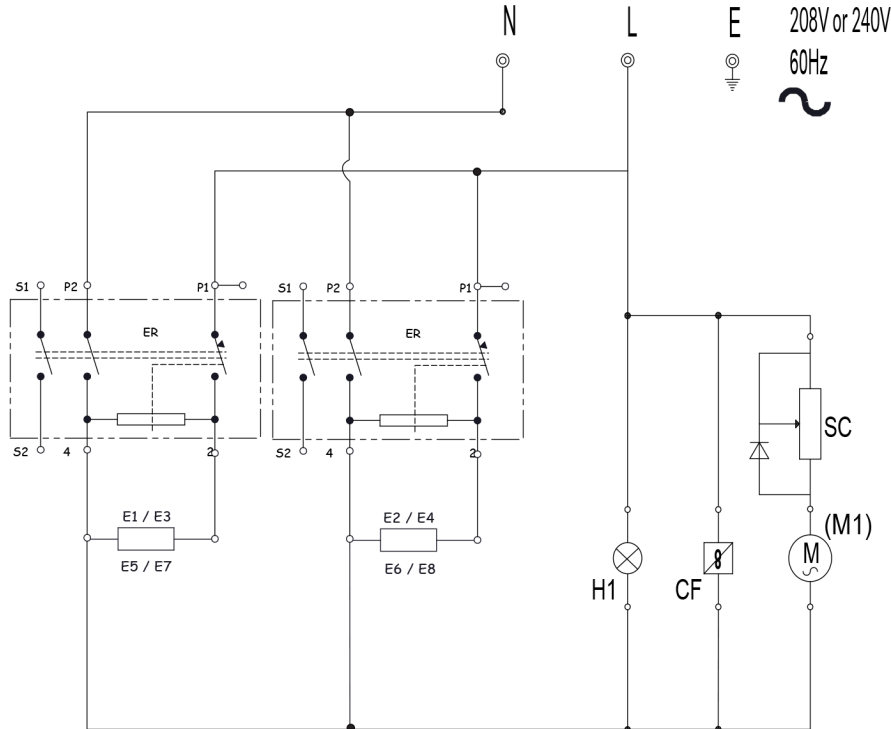



# DISCHARGE ASSEMBLY

As detailed in the diagrams below, the unit can either be assembled with front or rear discharge depending on installation position and preference.

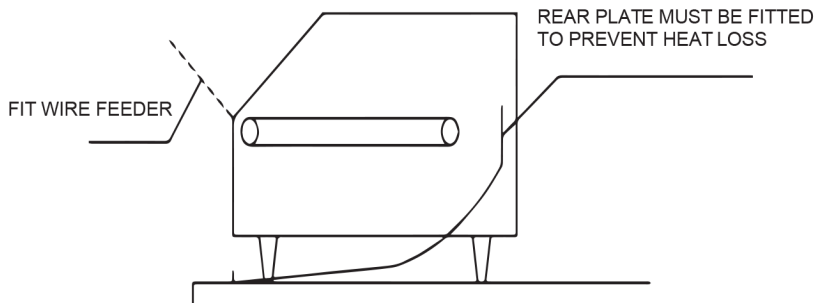

## FRONT DISCHARGE

1. Pull metal plate up to the closed position and latch. This will direct food to the bottom of the toaster.
2. Pick up the longer of the two chutes.
3. Slide the flanged end of the chute up underneath the toaster.
4. Rest the flanged end of the chute onto the interior ledge.

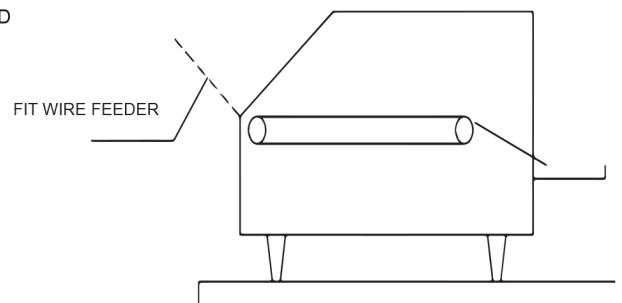

## REAR DISCHARGE

1. Push the metal plate down to the open position. This will direct food to the back of the toaster.
2. Loosen the two rear screws.
3. Pick up the smaller of the two chutes.
4. Slide the two keyholes on the chute behind the loosened screws. If the chute does not fit all the way down, loosen the screws more.
5. Tighten the screws to secure the chute to the toaster.

## STACKING KIT #184STK10 - 10" WIDE #184STK145 - 14½" WIDE

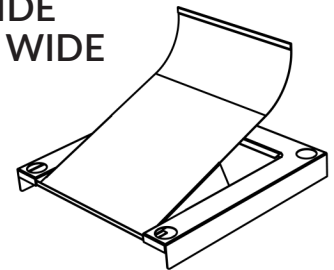
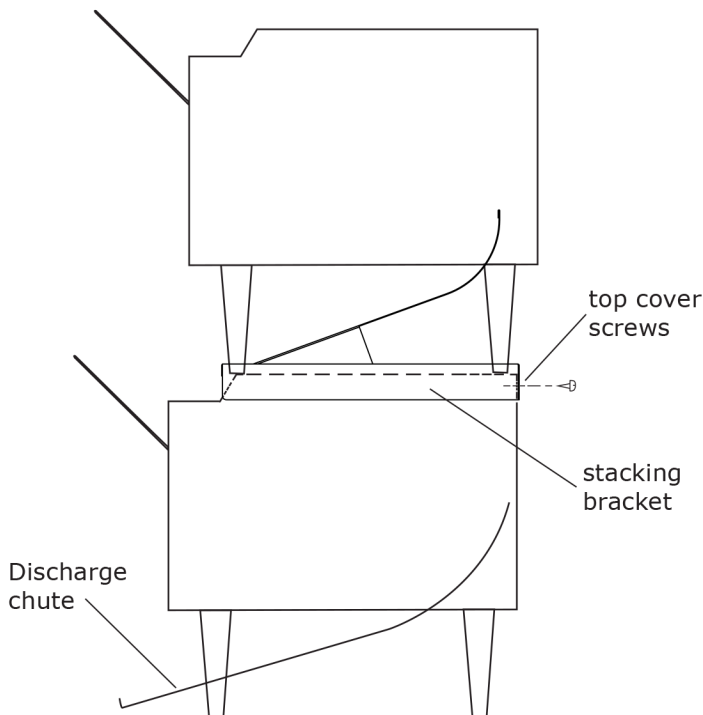

The optional stacking kit attachment can be used to mount one toaster on top of another.

1. To mount, set up both toasters for front discharge.
2. Remove the two rear top cover screws from the bottom toaster.
3. Place the stacking bracket onto the top cover of the toaster.
4. Replace the two top cover screws, securing the stacking bracket in place.
5. Remove the discharge chute from the toaster to be placed on top.
6. Place the toaster onto the bracket, ensuring the leveling feet locate into the holes in the stacking bracket.

# BEFORE USING YOUR TOASTER

Before cooking anything in your oven for the first time, please follow these simple instructions:

1. This conveyor toaster has been designed to continuously produce toasted bread or buns. The desired toasted color of the product can be adjusted by changing the belt speed of the conveyor. Depending on installation position, the toasted product can be discharged to the front or rear of the unit.
2. Ensure the support feet are assembled to the unit before commencing operation.
3. Thoroughly clean as described in the cleaning section of this manual (page 6).
4. For best results, allow the unit to preheat for 20-25 minutes before use so that the correct operating temperature can be reached.

## USING YOUR TOASTER

### 184T140

The unit has two controls.

1. **Speed/color control**  
Determines the length of time the toast or product is in the heating chamber.  
The slower the speed, the longer the exposure and the darker the product.
2. **Heat control switch has 4 settings.**  
“OFF” - In this position, the unit is off.  
“STANDBY” - In this position, the conveyor belt will run and both top and bottom elements will operate at 25% capacity. This mode is designed to keep the unit warm in quiet periods to reduce start-up time and conserve energy.  
“BREAD” - In this position, both top and bottom elements operate at full capacity.  
This is the ideal mode for toasting bread.  
“BUNS” - In this position, only the top element operates at full capacity.  
This is the ideal setting for toasting one side only of a bun.

### 184T3300B • 184T3300D • 184T3600B • 184T3600D

These units have three controls.

1. **Speed/color control**  
Determines the length of time the toast or product is in the heating chamber.  
The slower the speed, the longer the exposure and the darker the product.  
The top and bottom heating elements are independently controlled.
2. **Heat Control Top Element is infinitely adjustable.**  
“0” is the off position. “6” is the hottest setting. “1” is the lowest setting.
3. **Heat Control Bottom Element is infinitely adjustable.**  
“0” is the off position. “6” is the hottest setting. “1” is the lowest setting.

As described above, product appearance or color is dependent on conveyor speed and type of product. These other factors may also affect the toasting color:

- i. Moisture content of the product.
- ii. Sugar content of the product.
- iii. Initial product temperature.

# CLEANING & MAINTENANCE

**CAUTION:** THIS APPLIANCE SHOULD NOT BE IMMERSSED IN WATER. USE ONLY A DAMP CLOTH OR SPONGE DIPPED IN SOAPY WATER. DO NOT USE STEEL WOOL AS IT WILL DAMAGE THE BRIGHT STAINLESS STEEL FINISH.

## EXTERIOR & CRUMB TRAY

1. Unplug the power cord from the wall outlet.
2. Wait for the oven to cool.
3. Wipe off the unit with a dry cloth and wait at least half an hour before reconnecting to the power outlet.
4. Remove the crumb tray from the unit by pulling forward. Dispose of the crumbs and clean the tray with a damp cloth or sponge dipped in soapy water. Refit the tray before reusing the unit.

## CONVEYOR BELT

1. Turn off the toaster and allow the unit to cool down.
2. Turn the unit on and set to Standby Mode, adjust the belt to slow speed.
3. Using an abrasive pad, wipe the conveyor belt in a back and forth motion (ie: side to side) to remove baked-on product.
4. Finally, clean the belt with a damp cloth in the same manner described in number 3.



## SUGGESTED CLEANER

Noble Chemical QuikSan Food Contact & Surface Sanitizer

# DIMENSIONS

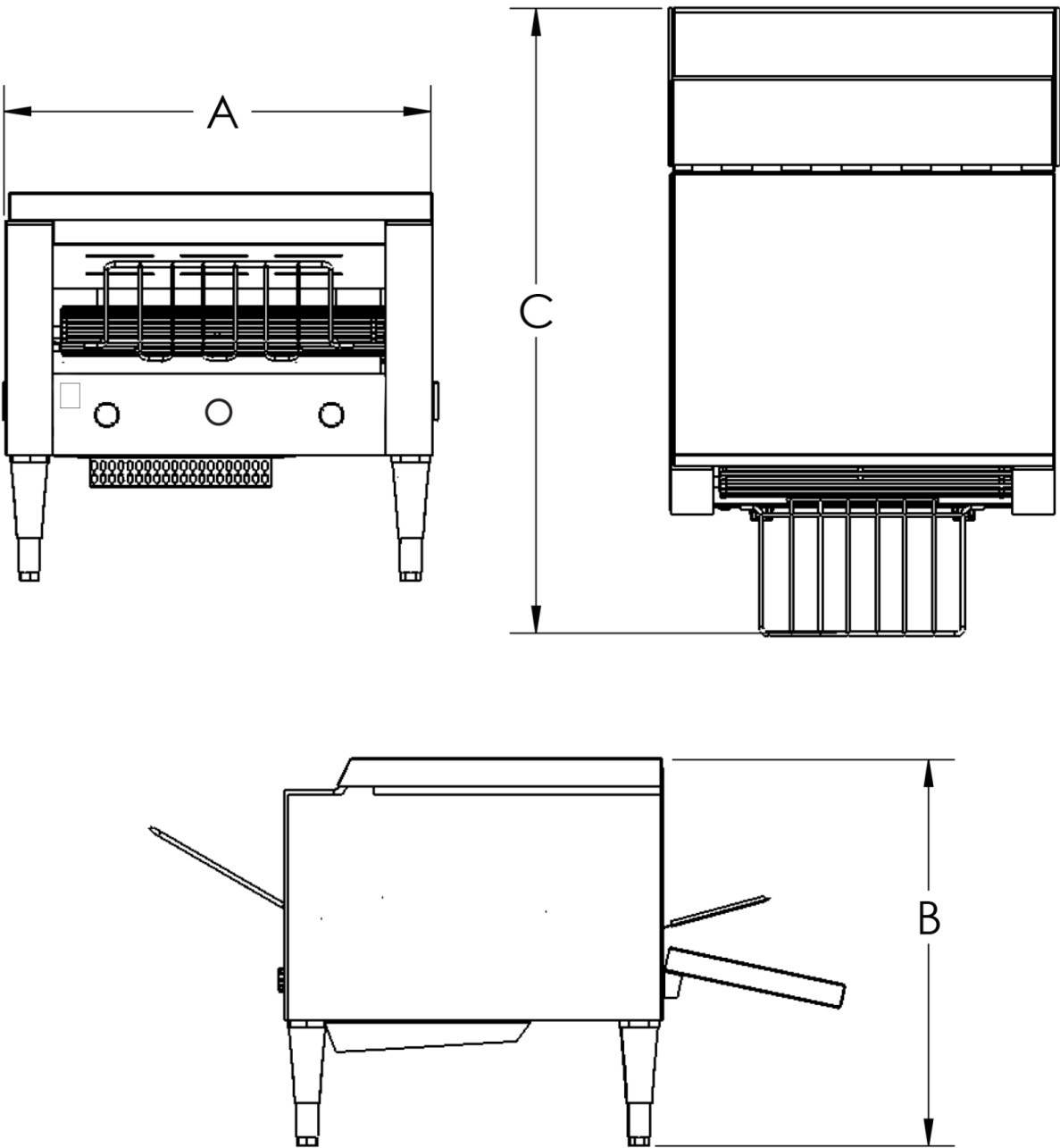

MODEL	A	B	C
184T3300B / 184T3300D	14.5"	16.5"	17"
184T3600B / 184T3600D	18.5"	16.5"	18"
184T140	14.5"	16.5"	30"

# EQUIPMENT LIMITED WARRANTY

---

Avatoast warrants its equipment to be free from defects in material and workmanship for a period of 1 year. This is the sole and exclusive warranty made by Avatoast covering your Avatoast brand equipment. A claim under this warranty must be made within **1 year** from the **date of purchase** of the equipment. Only the equipment's original purchaser may make a claim under this warranty. Avatoast reserves the right to approve or deny the repair or replacement of any part or repair request. The warranty is not transferable. Avatoast Equipment installed in/on a food truck or trailer will be limited to a period of **30 days** from the original date of purchase.

## To Make a Warranty Claim:

For Warranty Inquiries contact the location where you purchased the product:

- **WebstaurantStore.com:** Contact [help@webstaurantstore.com](mailto:help@webstaurantstore.com). Please have your order number ready.
- **The Restaurant Store:** If you purchased this unit from your local store, please contact your store directly.
- **TheRestaurantStore.com:** Online purchases, call 717-392-7261. Please have your order number ready.

Failure to contact the designated location prior to obtaining equipment service may void your warranty.

Avatoast makes no other warranties, express or implied, statutory or otherwise, and **HEREBY DISCLAIMS ALL IMPLIED WARRANTIES, INCLUDING THE IMPLIED WARRANTIES OF MERCHANTABILITY AND OF FITNESS FOR A PARTICULAR PURPOSE.**

## This Limited Warranty does not cover:

- Equipment sold or used outside the Continental United States
- Use of unfiltered water (if applicable)
- Avatoast has the sole discretion on wearable parts not covered under warranty
- Equipment not purchased directly from an authorized dealer
- Equipment used for residential or other non-commercial purposes
- Equipment that has been altered, modified, or repaired by anyone other than an authorized service agency
- Equipment where the serial number plate has been removed or altered.
- Damage or failure due to improper installation, improper utility connection or supply, and issues resulting from improper ventilation or airflow.
- Defects and damage due to improper maintenance, wear and tear, misuse, abuse, vandalism, or Act of God.

Any action for breach of this warranty must be commenced within 1 year of the date on which the breach occurred. No modification of this warranty, or waiver of its terms, shall be effective unless approved in a writing signed by the parties. The laws of the Commonwealth of Pennsylvania shall govern this warranty and the parties' rights and duties under it. Avatoast shall not under any circumstances be liable for incidental or consequential damages of any kind, including but not limited to loss of profits.



## High Wattage Strip Warmer

**Models:** 423SWT18, 423SWT18CP, 423SWT24, 423SWT24CP, 423SWT30, 423SWT30CP, 423SWT36, 423SWT36CP, 423SWT42, 423SWT42CP, 423SWT48, 423SWT48CP, 423SWT54, 423SWT54CP, 423SWT60, 423SWT60CP, 423SWT72, 423SWT72CP, 423SWI18, 423SWI18CP, 423SWI24, 423SWI24CP, 423SWI30, 423SWI30CP, 423SWI36, 423SWI36CP, 423SWI42, 423SWI42CP, 423SWI48, 423SWI48CP, 423SWI54, 423SWI54CP, 423SWI60, 423SWI60CP, 423SWI72, 423SWI72CP, 423SWTD24, 423SWTD36, 423SWTD48, 423SWTD60, 423SWID24, 423SWID36, 423SWID48, 423SWID60

Please read and keep these instructions. Indoor use only.

09/2020

**Table of Contents**

Introduction .....3

Requirements and Safety Instructions..... 3

Overview ..... 4-5

Operation..... 6

Installation..... 6

Cleaning ..... 6

Parts Diagram..... 7-8

Wiring Diagram..... 9

Limited Warranty.....10



# **Introduction, Requirements and Safety**

## **Introduction**

1. Please read instructions before using this appliance. This appliance is for commercial use only.
2. When using electrical appliances, basic precautions should always be followed to reduce the risk of fire, electric shock and injury.
3. Clean machine thoroughly before and after each use following the cleaning instructions provided below.

## **Safety Instructions**

### **WARNING!**

All power must be disconnected at power source before any service procedure is performed.

1. This appliance is hot when in use. To avoid burns, do not let bare skin touch hot surfaces. Keep combustible materials, such as drapes and other furnishings, away from appliance.
2. Extreme caution is necessary when any appliance is used by or near children and whenever the appliance is left unattended.
3. Always unplug appliance when not in use and before cleaning, adjusting or maintaining this machine. To disconnect appliance, turn switch off and remove plug from power source.
4. Do not operate any appliance with a damaged cord or plug, after the appliance malfunctions, has been dropped or damaged. Return appliance to an authorized service facility for examination, electrical or mechanical adjustment or repair.
5. Do not use outdoors. This appliance is not intended for wet or moist locations. Never locate appliance where it may fall into water.
6. Connect to properly grounded outlets only. Avoid the use of extension cords. Do not run cord under carpeting, runners or the like. Arrange cord away from traffic area and where it will not create a tripping hazard.
7. This appliance is equipped with a power cord with a three blade plug. Plug **ONLY** into a matching three blade outlet. **DO NOT** cut or break off the third blade or attempt to use with a two blade extension cord.
8. To prevent a possible fire, it is recommended that the unit is placed on a non-combustible surface.
9. This appliance has electrical parts. Do not use it in areas where gasoline, paint, or flammable liquids are used or stored.

## Overview

### Toggle Hardwired

MODEL #	OVERALL DIMENSIONS	POWER SUPPLY	TYPE
423SWT18	18"L x 6.1"W x 2.6"H	120V, 350W	Single
423SWT24	24"L x 6.1"W x 2.6"H	120V, 500W	Single
423SWT30	30"L x 6.1"W x 2.6"H	120V, 650W	Single
423SWT36	36"L x 6.1"W x 2.6"H	120V, 850W	Single
423SWT42	42"L x 6.1"W x 2.6"H	120V, 1050W	Single
423SWT48	48"L x 6.1"W x 2.6"H	120V, 1200W	Single
423SWT54	54"L x 6.1"W x 2.6"H	120V, 1425W	Single
423SWT60	60"L x 6.1"W x 2.6"H	120V, 1550W	Single
423SWT72	72"L x 6.1"W x 2.6"H	120V, 1750W	Single
423SWTD24	24"L x 15.2"W x 2.6"H	120V, 1000W	Double
423SWTD36	36"L x 15.2"W x 2.6"H	120V, 1700W	Double
423SWTD48	48"L x 15.2"W x 2.6"H	120V, 1900W	Double
423SWTD60	60"L x 15.2"W x 2.6"H	120V, 2200W	Double

### Infinite Hardwired

MODEL #	OVERALL DIMENSIONS	POWER SUPPLY	TYPE
423SWI18	18"L x 6.1"W x 2.6"H	120V, 350W	Single
423SWI24	24"L x 6.1"W x 2.6"H	120V, 500W	Single
423SWI30	30"L x 6.1"W x 2.6"H	120V, 650W	Single
423SWI36	36"L x 6.1"W x 2.6"H	120V, 850W	Single
423SWI42	42"L x 6.1"W x 2.6"H	120V, 1050W	Single
423SWI48	48"L x 6.1"W x 2.6"H	120V, 1200W	Single
423SWI54	54"L x 6.1"W x 2.6"H	120V, 1425W	Single
423SWI60	60"L x 6.1"W x 2.6"H	120V, 1550W	Single
423SWI72	72"L x 6.1"W x 2.6"H	120V, 1750W	Single
423SWID24	24"L x 15.2"W x 2.6"H	120V, 1000W	Double
423SWID36	36"L x 15.2"W x 2.6"H	120V, 1700W	Double
423SWID48	48"L x 15.2"W x 2.6"H	120V, 1900W	Double
423SWID60	60"L x 15.2"W x 2.6"H	120V, 2200W	Double

## Toggle Cord & Plug

MODEL #	OVERALL DIMENSIONS	POWER SUPPLY	TYPE
423SWT18CP	18"L x 6.1"W x 2.6"H	120V, 350W	Single
423SWT24CP	24"L x 6.1"W x 2.6"H	120V, 500W	Single
423SWT30CP	30"L x 6.1"W x 2.6"H	120V, 650W	Single
423SWT36CP	36"L x 6.1"W x 2.6"H	120V, 850W	Single
423SWT42CP	42"L x 6.1"W x 2.6"H	120V, 1050W	Single
423SWT48CP	48"L x 6.1"W x 2.6"H	120V, 1200W	Single
423SWT54CP	54"L x 6.1"W x 2.6"H	120V, 1425W	Single
423SWT60CP	60"L x 6.1"W x 2.6"H	120V, 1550W	Single
423SWT72CP	72"L x 6.1"W x 2.6"H	120V, 1750W	Single

## Infinite Cord & Plug

MODEL #	OVERALL DIMENSIONS	POWER SUPPLY	TYPE
423SWI18CP	18"L x 6.1"W x 2.6"H	120V, 350W	Single
423SWI24CP	24"L x 6.1"W x 2.6"H	120V, 500W	Single
423SWI30CP	30"L x 6.1"W x 2.6"H	120V, 650W	Single
423SWI36CP	36"L x 6.1"W x 2.6"H	120V, 850W	Single
423SWI42CP	42"L x 6.1"W x 2.6"H	120V, 1050W	Single
423SWI48CP	48"L x 6.1"W x 2.6"H	120V, 1200W	Single
423SWI54CP	54"L x 6.1"W x 2.6"H	120V, 1425W	Single
423SWI60CP	60"L x 6.1"W x 2.6"H	120V, 1550W	Single
423SWI72CP	72"L x 6.1"W x 2.6"H	120V, 1750W	Single

## Operation

1. Plug cord into grounded electrical outlet of the correct voltage. Electrical shock can occur if appliance is not grounded.
2. Flip the switch to the 'On' position.
3. Place food products directly under the elements for best results.
4. Turn unit off when not in use.
5. To disconnect appliance, turn switches off and remove plug from power source.

## Installation

1. For strip warmers of high wattage (18-25 watts per inch). 10-16" is the recommended mounting height
2. Do not install strip warmers above or around combustible surfaces.
3. Strip warmers can be mounted to the underside of a shelf with a minimum gap of 1" to protect electrical system.
4. Remove the two center screws from end plates. Align the holes on the bracket with the mounting holes on the end plate. Use the screw to secure the bracket.
5. Drill 4 holes on the underside of a shelf, use fasteners to install the brackets to the underside of the shelf.
6. A qualified electrician must install hardwired models or warranty will be void.

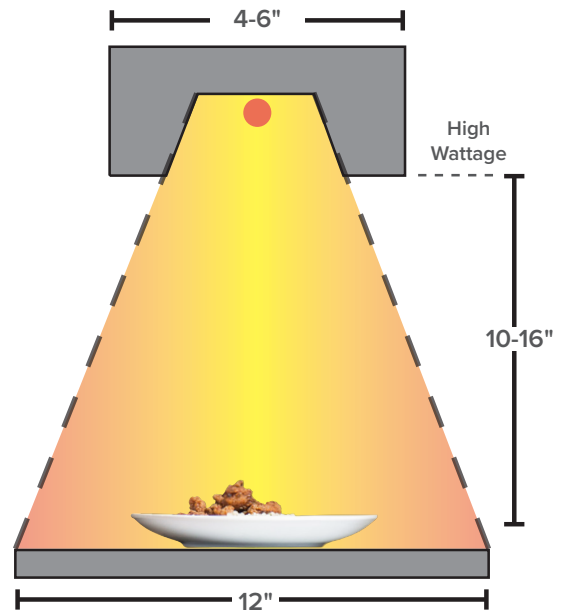

## Cleaning

1. Unplug the cord and let warmer cool before cleaning or moving.
2. This unit can be cleaned with a damp sponge and mild soap. Rinse with clean water and wipe dry.
3. Do not immerse in water or other liquid.

## Parts Diagram - Toggle Control

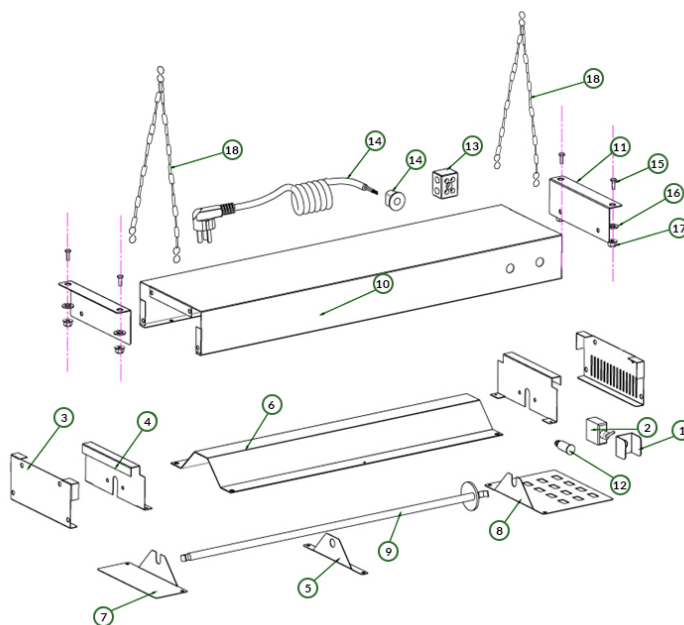

NO.	Description	Replacement Part#	Pcs.
1	Switch Guard	423PSW01 (423SWT18/24/30/36/42/48/54/60/72, 423SWT18/24/30/36/42/48/54/60/72CP, 423TD24/36/48/60)	1
2	Toggle Switch	423PSWSWITCH (423SWT18/24/30/36/42/48/54/60/72, 423SWT18/24/30/36/42/48/54/60/72CP, 423TD24/36/48/60)	1
3	End Plates		2
4	Element Guard	423PSWGUARD (423SWI18/24/30/36/42/48/54/60/72, 423SWT18/24/30/36/42/48/54/60/72, 423SWT18/24/30/36/42/48/54/60/72CP, 423TD24/36/48/60)	1
5	Element Support (Mid)	423PSWELEM1 (423SWT18/24/30/36/42/48/54/60/72, 423SWT18/24/30/36/42/48/54/60/72CP, 423TD24/36/48/60)	1
6	Reflector		1
7	Element Support (Left)	423PSWELEM2 (423SWT18/24/30/36/42/48/54/60/72, 423SWT18/24/30/36/42/48/54/60/72CP, 423TD24/36/48/60)	1
8	Cover Plate		1
9	Element	423PSWELEM24 (423SWT24/T24CP/I24/I24CP/TD24), 423PSWELEM36 (423SWT36/T36CP/TD36), 423PSWELEM48 (423SWT48/T48CPTD48), 423PSWELEM60 (423SWT60/T60CPTD60), 423PSWELEM72 (423SWT72/T72CP/I72), 423PSWELEM18 (423SWT18/T18CP), 423PSWELEM30 (423SWT30/T30CP), 423PSWELEM42 (423SWT42/T42CP/I42), 423PSWELEM54 (423SWT54/T54CP)	1
10	Housing		1
11	Mounting Brackets	423PBRACKET (423SWT18/24/30/36/42/48/54/60/72, 423SWT18/24/30/36/42/48/54/60/72CP, 423TD24/36/48/60)	2

## Toggle Control, cont.

NO.	Description	Replacement Part#	Pcs.
12	Indicator Light		1
13	Terminal Block	423PSWTB (423SWT18/24/30/36/42/48/54/60/72, 423SWT18/24/30/36/42/48/54/60/72CP, 423TD24/36/48/60)	1
14	Cord and Plug Set	423PSWCORD15 (423SWT18/24/30/36/42/48/54/60/72, 423SWT18/24/30/36/42/48/54/60/72CP, 423TD24/36/48/60)	1
15	Screw		1
16	Washer		1
17	Nut		1
18	Support Chains	423PSWCHAIN (423SWT18/24/30/36/42/48/54/60/72, 423SWT18/24/30/36/42/48/54/60/72CP, 423TD24/36/48/60)	2

## Parts Diagram - Infinite Control

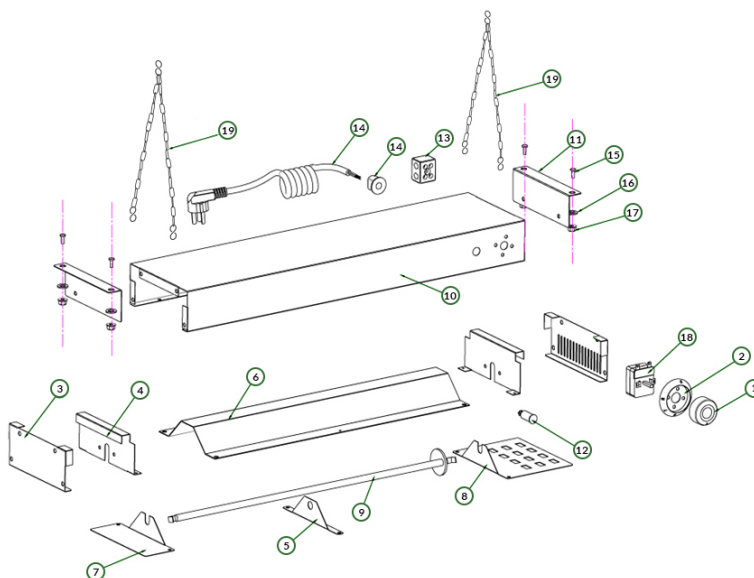

NO.	Description	Replacement Part#	Pcs.
1	Knob	423PSWKNOB (423SWI18/24/30/36/42/48/54/60/72, 423SWI18/24/30/36/42/48/54/60/72CP, 423ID24/36/48/60)	1
2	Knob Base		1
3	End Plates		2
4	Element Guard	423PSWGUAUD (423SWI18/24/30/36/42/48/54/60/72, 423SWI18/24/30/36/42/48/54/60/72CP, 423ID24/36/48/60)	1
5	Element Support (Mid)	423PSWELEM1 (423SWI18/24/30/36/42/48/54/60/72, 423SWI18/24/30/36/42/48/54/60/72CP, 423ID24/36/48/60)	1
6	Reflector		1

NO.	Description	Replacement Part#	Pcs.
7	Element Support (Left)	423PSWELEM2 (423SW118/24/30/36/42/48/54/60/72, 423SW118/24/30/36/42/48/54/60/72 CP, 423ID24/36/48/60)	1
8	Cover Plate		1
9	Element	423PSWELEM24 (I24/I24CP/ID24), 423PSWELEM36 (I36/I36CP/ID36), 423PSWELEM48 (I48/I48CP/ID48), 423PSWELEM60 (I60/I60CP/ID60), 423PSWELEM72 (I72/I72CP)	1
10	Housing		1
11	Mounting Brackets	423PBRACKET (423SW118/24/30/36/42/48/54/60/72, 423SW118/24/30/36/42/48/54/60/72CP, 423ID24/36/48/60)	2
12	Indicator Light		1
13	Terminal Block	423PSWTB (423SW118/24/30/36/42/48/54/60/72, 423SW118/24/30/36/42/48/54/60/72CP, 423ID24/36/48/60)	1
14	Cord and Plug Set	423PSWCORD15 (423SW118/24/30/36/42/48/54/60/72, 423SW118/24/30/36/42/48/54/60/72 CP, 423ID24/36/48/60)	1
15	Screw		1
16	Washer		1
17	Nut		1
18	Infinite Heat Control	423PSWTERM (423SW118/24/30/36/42/48/54/60/72, 423SW118/24/30/36/42/48/54/60/72 CP, 423ID24/36/48/60)	1
19	Support Chains	423PSWCHAIN (423SW118/24/30/36/42/48/54/60/72, 423SW118/24/30/36/42/48/54/60/72 CP, 423ID24/36/48/60)	2

## Wiring Diagram - Toggle Control

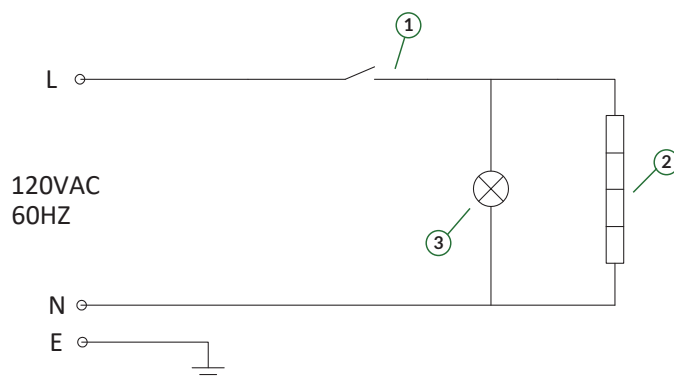

NO.	Description
1	Switch
2	Heater
3	Indicator



## Wiring Diagram - Infinite Control

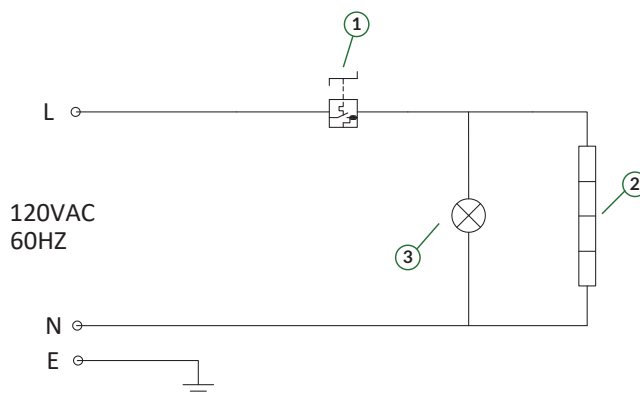

NO.	Description
1	Energy Regulator
2	Heater
3	Indicator

# **Strip Warmer 2 Year No Hassle Replacement Warranty**

ServIt Strip Warmers are backed by an industry-leading 2 year “no hassle” replacement warranty. When you buy a ServIt Strip Warmer, you are entrusting it with the quality and safety of your food, which is ultimately your customers' experience. If it goes down, you can be sure that ServIt will quickly and easily make replacing it a breeze, getting a new unit out to you in as little as 24 hours. Don't wait for a service technician to come out and fix it, simply swap out and get back to business.

This is the sole and exclusive warranty made by ServIt covering your ServIt branded strip warmers. A claim under this warranty must be made within 2 years from the date of purchase of the equipment. Only the equipment's original purchaser may make a claim under this warranty. ServIt reserves the right to approve or deny any replacement request. The warranty is not transferable. ServIt Equipment installed in/on a food truck or trailer will be limited to a period of 30 days from the original date of purchase. This warranty only covers ServIt Strip Warmers and does not cover other products or product lines under the ServIt brand.

## **To Make a Warranty Claim:**

For Warranty Inquiries contact the location where you purchased the product:

- WebstaurantStore.com: Contact [help@webstaurantstore.com](mailto:help@webstaurantstore.com). Please have your order number ready.
- The Restaurant Store: If you purchased this unit from your local store, please contact your store directly.
- TheRestaurantStore.com: Online purchases, call 717-392-7261. Please have your order number ready.

Failure to contact the designated location prior to obtaining equipment service may void your warranty.

ServIt makes no other warranties, express or implied, statutory or otherwise, and HEREBY DISCLAIMS ALL IMPLIED WARRANTIES, INCLUDING THE IMPLIED WARRANTIES OF MERCHANTABILITY AND OF FITNESS FOR A PARTICULAR PURPOSE.

This Limited Warranty does not cover:

- Equipment sold or used outside the Continental United States
- Use of unfiltered water (if applicable)
- ServIt has the sole discretion on wearable parts not covered under warranty
- Equipment not purchased directly from an authorized dealer
- Equipment used for residential or other non-commercial purposes
- Equipment that has been altered, modified, or repaired by anyone other than an authorized service agency
- Equipment where the serial number plate has been removed or altered.
- Damage or failure due to improper installation, improper utility connection or supply, and issues resulting from improper ventilation or airflow.
- Defects and damage due to improper maintenance, wear and tear, misuse, abuse, vandalism, or Act of God.

Any action for breach of this warranty must be commenced within 2 years of the date on which the breach occurred. No modification of this warranty, or waiver of its terms, shall be effective unless approved in a writing signed by the parties. The laws of the Commonwealth of Pennsylvania shall govern this warranty and the parties' rights and duties under it. ServIt shall not under any circumstances be liable for incidental or consequential damages of any kind, including but not limited to loss of profits.