



INSTRUCTION MANUAL



READ ENTIRE MANUAL BEFORE USE

11" TRIPLE BRUSH MANUAL FLOOR SWEEPER #794LAVFD03

07/2020

COMPONENTS

- A Handle
- B Pole (x3)
- C Bristle Cleaning Tool
- D Sweeper Head

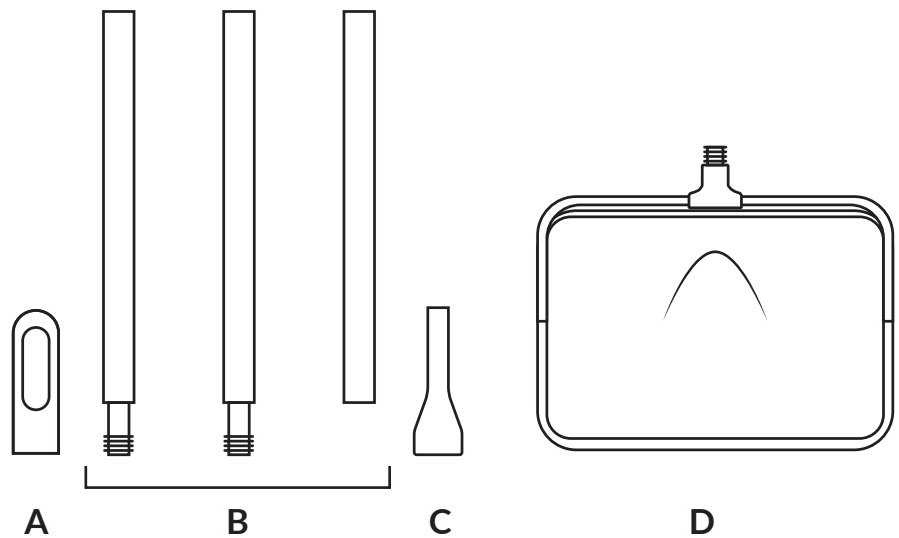

SAFETY INSTRUCTIONS

- Do not allow unsupervised children to use this unit.
- Do not wash this unit or expose to water.
- Keep unit away from fire.

ASSEMBLY

1. Ensure that all components are included before attempting assembly.
2. Connect handle components, then fasten to the head. Ensure that all connections are securely tightened.
3. Place the bristle cleaning tool where the handle and head meet. (Fig. 1)

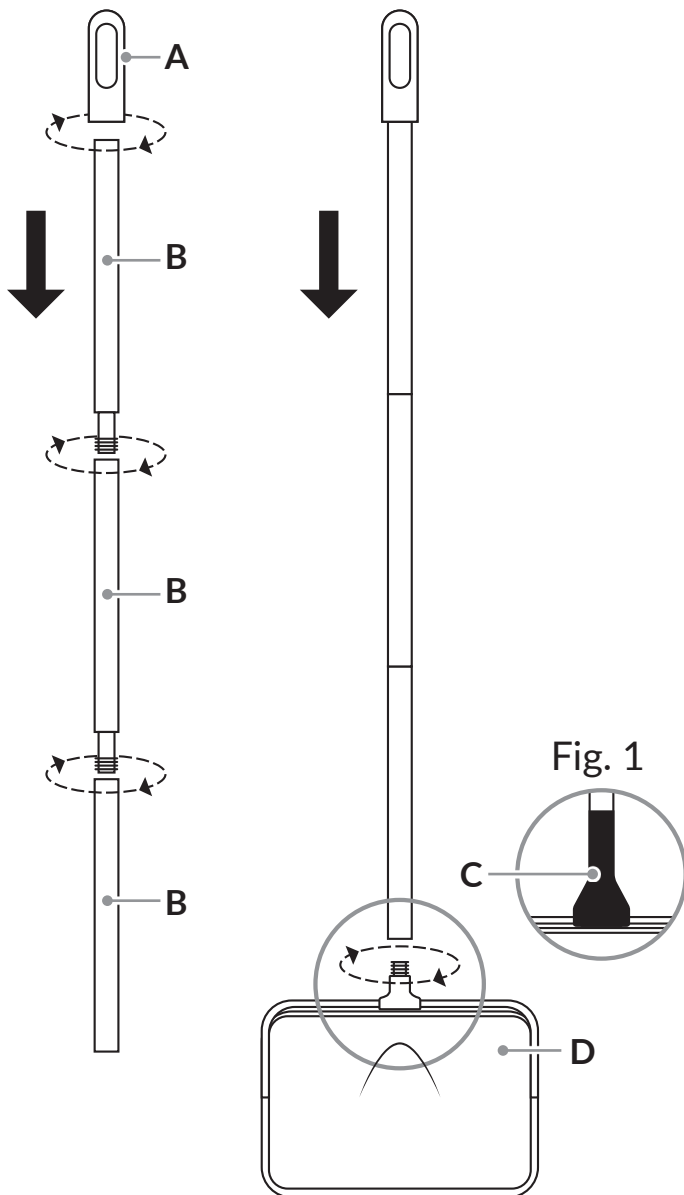

USE INSTRUCTIONS

1. Push unit either forward or backward over any dust or debris to easily collect garbage.

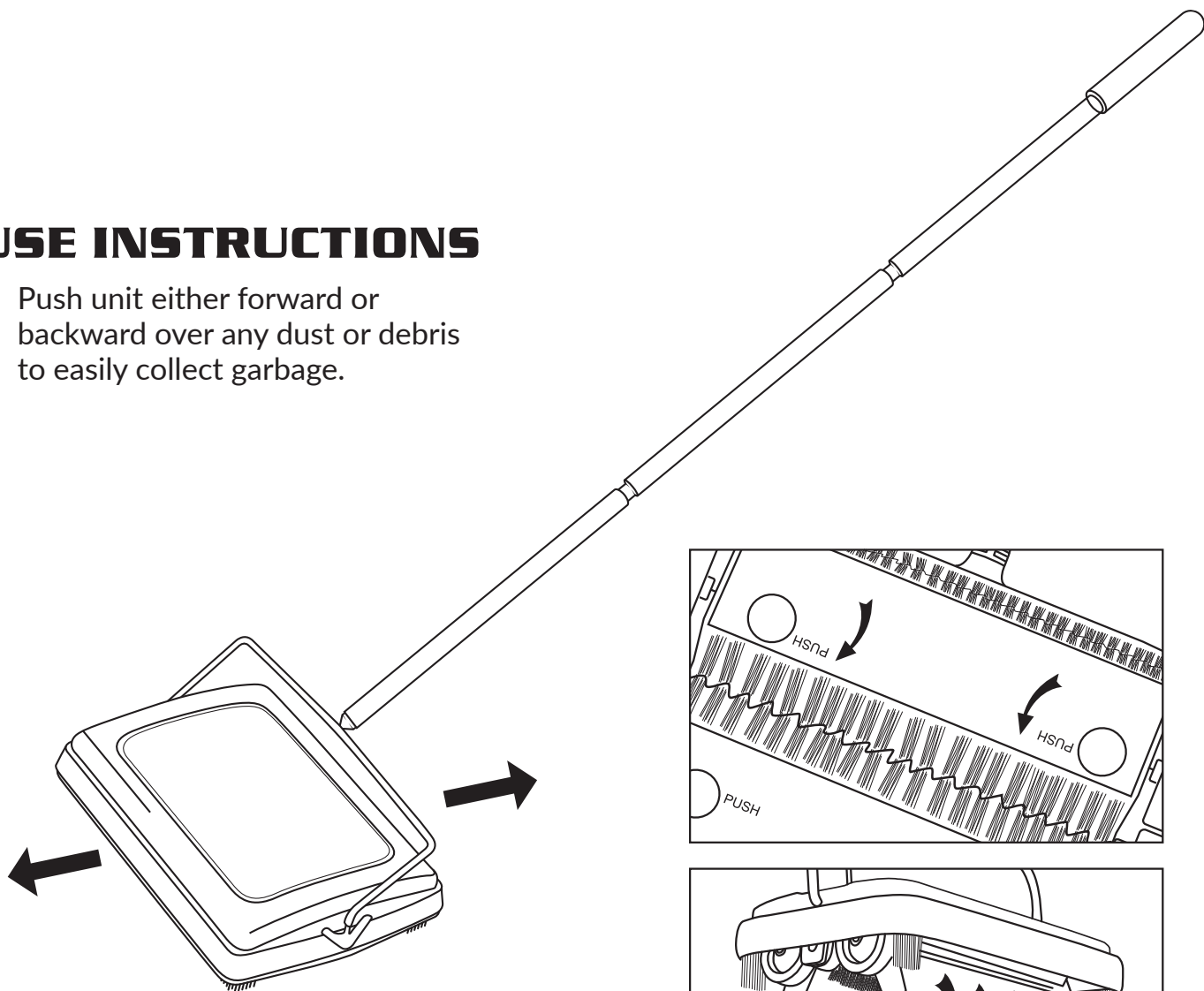

EMPTYING INSTRUCTIONS

1. Lift up on tab located on the top of the sweeper's head. This will lift the retaining fins so that dirt and debris can be emptied.
2. After the bin is empty, release the tab, and the fins will return to their regular position.