



176 MITTEL DRIVE, WOOD DALE, IL 60191

7900 Bag-N-Box Pump Manual

Models 7900RCA-___, 7900LA-___, 7900GMA-
7900-RCE-___, 7900LE-___, 7900GME

120 Volt
Single Phase, 60 Cycle

100/120 Volt
Single Phase, 50/60 Cycle

230 Volt
Single Phase, 50 Cycle

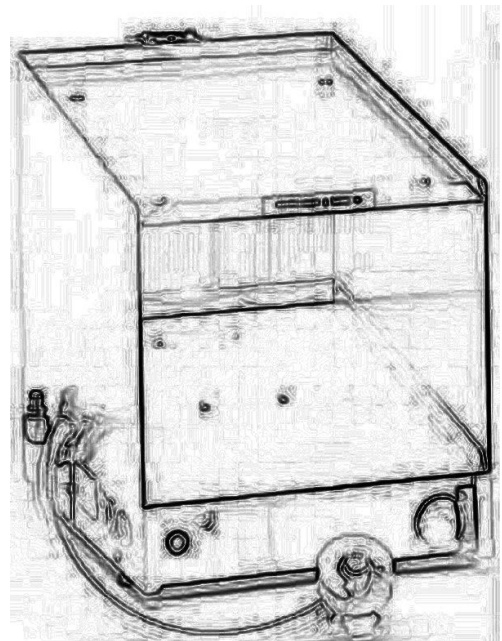

READ and **UNDERSTAND** these servicing, and safety instructions before servicing this popcorn machine

Part Number Configuration: 7900 Bag-N-Box Oil Pump

7900	RC	A	-	S	X
-------------	-----------	----------	----------	----------	----------

Model

7900 – 7900 Bag-N-Box Pump

Control

RC - Remote Control

L – Salt/Sugar (LOG Control)

GM - Remote Control (Gold Medal Plug)

Voltage

60 Hz. (North America)

A - 120/1/60

50 Hz

E - 230/1/50

Japan

F - 100/1/50

Oil Connection

S - Side Oil Line Connections (Standard)

F - Front / Rear Oil Line Connections

Options

X - No Custom Features

C - Custom Features

H - Heated Tubes

EH - 30" Heated Tubes

Z - Other

I. SAFETY ALERT SYMBOL

The symbol shown below is used to call your attention to instructions concerning your personal safety and the safety of others. Watch for this symbol. It points out important safety precautions and procedures. It means **ATTENTION! Become Alert! Your personal safety is at risk!** Read the message that follows and be alert to the risk of personal injury or death.



II. SAFETY FIRST



The information in this manual is essential for safe installation and service of your Cretors machine. The manual must be read and understood before installing, or maintaining equipment, or equivalent training must be provided.



"The employer must instruct each employee in the recognition and avoidance of unsafe conditions, regulations applicable to his work environment to control and eliminate any hazards or other exposure to illness or injury".
Ref.: 29 CFR 1926.20 (b)(4)(a)(2)



It is understood that safety rules within individual companies vary. If a conflict exists between the safety procedures contained in this manual and the rules of a using company, the more stringent rule should take precedence.

III. INTRODUCTION

This manual is filled with time-saving and money-saving information regarding your Cretors machine. There is nothing, however, more important than the safety aids and warnings that are found throughout this document. The Safety Alert Symbol is used to identify topics of primary safety concern wherever they appear. A separate section has been included which deals exclusively with operation and accident prevention.

If, after reviewing this manual, anything is unclear or technical problems are encountered, contact the distributor from whom you purchased your machine. For assistance and if there are any additional questions, feel free to contact our Customer Service Department at the address and/or phone number listed on the last page of this manual. Always have the model and serial number of your machine available to assist in obtaining the correct information.

IV. SPECIFICATIONS

A. ELECTRICAL SPECIFICATIONS:

Electrical configurations:

120 Volt, Single Phase, 60 Hz

100/120Volt, Single Phase, 50/60 Hz

230 Volt, Single Phase, 50 Hz.

B. SIZE SPECIFICATIONS:

MODEL 7900	7900 AUTOMATIC OIL PUMP MODEL
Capacity:	(2) 35 lb. boxes of oil.
Electrical:	120 volt, 60 cycle, single phase, 250 watts, 2.1 amps.
Dimensions:	16-1/2" H x 18-1/4" D x 14-3/4" W
Net Weight:	30 lbs.
Shipping Weight:	39 lbs.

MODEL 7900	7900 AUTOMATIC OIL PUMP MODEL
Capacity:	(2) 35 lb. boxes of oil.
Electrical:	230 volt, 50 cycle, single phase, 250 watts, 1.1 amps.
Dimensions:	16-1/2" H x 18-1/4" D x 14-3/4" W
Net Weight:	30 lbs.
Shipping Weight:	39 lbs.



7900 Bag-In-Box Oil Pump



Part Number	Voltage	Wattage	NEMA Plug
**7900X(X)X-X	120v (60Hz); 230v (50Hz)	250	5-15

Shipping Weight: 35 lbs/ Shipping Dimensions: 22in x 18in x 19in
Metric Shipping Weight: 16 kg/ Shipping Dimensions: 56cm x 44cm x 49cm

**Actual dimensions available in technical drawing below*

***Actual part number dependant on machine features*

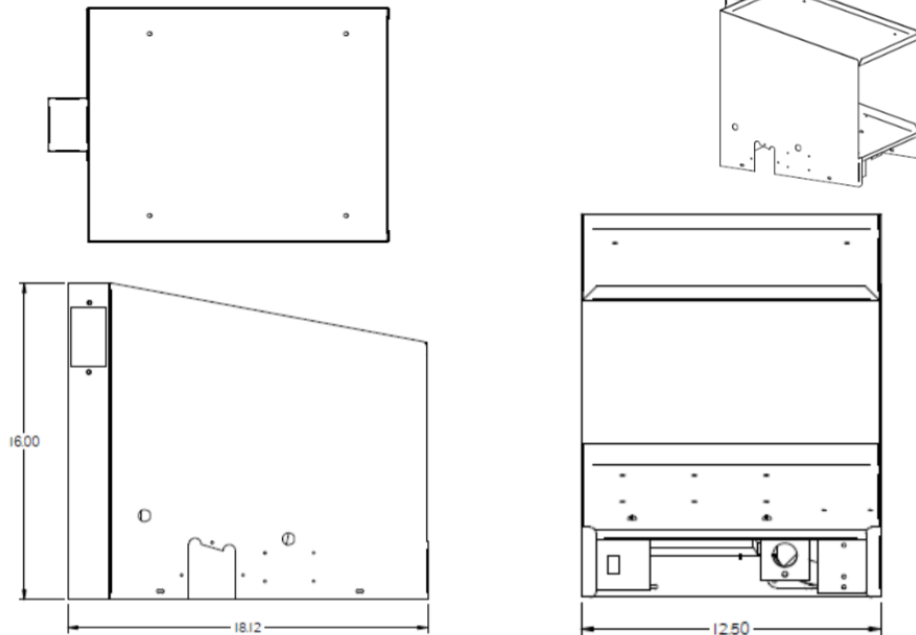

V. PURPOSE OF MANUAL

This instruction manual is intended to familiarize owners with the servicing and safety procedures associated with your Cretors machine.

This manual should be kept available to maintenance personnel.

VI. INSTALLATION INSTRUCTIONS

A. Location

Choose a location for your Cretors machine that maximizes the ease of operation and maintenance procedures. Be sure to check your local building and fire codes for location restrictions.

B. Power Supply

1. The 7900 Oil Pump is provided with either 120 volt components, which requires a 120 volt circuit for proper operation or 230V components. Check the nameplate to determine the required power supply.



Connect your popcorn machine and oil pump only to the correct power source. Failure to do so may result in personal injury or death and may damage your popper.

2. C. Cretors and Company recommends dedicated circuits for the 7900 Model Cretors Oil Pump. The 7900 Model Cretors Oil Pump requires a dedicated circuit to avoid a voltage drop in the supply wiring. Check your local electrical codes regarding fuse or circuit breaker requirements.



Make certain your machine is properly grounded. Failure to do so may result in damage to your equipment or present a shock hazard.

C. Connecting Oil Pump to the Power Supply

1. Make certain that the power supply circuit breakers are in the off position.



Perform work only on de-energized circuits. Failure to do so may result in damage to your equipment or present a shock hazard.

2. Make certain all switches on the popcorn machine are in the off position before plugging in your 7900 Model Cretors Oil Pump.
3. Plug your popcorn machine and oil pump into the correct type of outlet, turn on the circuit breaker and then turn on the machine switches. If the motor groans, the receptacle in the wall may have been improperly wired. Contact an electrician.

D. Pump Installation

1. Make certain the pump switch on the control panel is in the off position.
2. Receiving a 7900 pump as a replacement for 7700 or earlier models.
 - a. The units equipped with wood bases, remove the (2) screws on back flange of oil pail tray (P/N 1349) and remove tray. This tray is not needed for 7900 model.
 - b. Replace existing plastic hose (#1223) (7" on Diplomat, 19" on President) with 20" or 24" plastic hose respectively. The existing hose clamps (#1609) and socket (#5216) are still used. If existing hose length was shortened so the socket (#5216) does not have sufficient length to connect to the plug (#5217) on the pump, replace the entire length - 110" (for Merchant and Profiteer).



Use proper lifting techniques when removing the pump assembly to avoid injury to back.

3. The 7900 model weighs approximately 30 lbs., so use proper lifting techniques and slide pump into cabinet. Allow at least 3" from the front edge of pump to the back side of door. This will ensure that the door, when closed, will not interfere with the properly connected bag connector.
4. Connect hose (#1223) simply by pushing socket (#5216) into plug (#5217) and make sure that it has snapped into place. Test engagement by pulling up on the hose near connection, fittings will not disengage.
5. Connect pump cord and plug to pump receptacle located on the top or on the back of the model 7900 pump.
6. While using proper lifting techniques, load one box into bottom tray and one on top. Following the instructions on the box itself, connect the bag connector to the Bag-N-Box nozzle. You are now ready to adjust the pump as outlined in Pump Adjustment.



Make sure that the popper heat switch is in the off position during all pump adjustments. Failure to do so may result in serious burns.



WARNING! If either shelf is not occupied by the Bag-N-Box oil, use caution around these surfaces as they will be hot! Failure to do so may result in serious burns.

E. Pump Adjustment

1. Make sure that the pump power switch and the auxiliary switch located on the popper are on.
2. Check the output of the pump by placing the kettle in the dumped position and hold the oil measuring cup under the oil delivery tube. With the pedestal mounted units (i.e. Giant/President), disconnect the oil tube from the kettle and dispense the oil into the measuring cup.



WARNING! Never hold the oil measuring cup under the oil delivery tube if the kettle is in the up position. **The kettle maybe hot!** Failure to do so may result in serious burns.

3. Press the delivery button or One Pop button and wait for the pump to cycle. Dispose of the oil, and cycle the pump again.
4. After three cycles, the amount of oil delivered will be consistent. Check this amount with the measuring cup.
5. If the amount of oil is not correct, it may be adjusted. For a Salt/Sugar machine, the timer is located in the popper. To adjust the pump:
 - a. Turn off the pump switch.
 - b. To set the amount of oil being delivered:
 - i) Remove the snap out plug on the front side of the bottom cover to expose the timer.
 - ii) Check to make sure the timer has good contact by pushing down lightly onto the timer base, making certain not to push any of the switches.
 - iii) Switches 1 through 10 are each assigned a certain amount of seconds of run time. Each successive switch doubles the run time for the switch before it. The amount of run time is written at the top, along the Open/Off line (i.e. 1,2,4,8, etc.)
 - iv) The switch must be in the Up position along the Open/Off line for the run time to apply. For example, to make the pump run for three seconds, the timer would have the switch corresponding to 1 on the Open/Off line up along with the switch corresponding to 2 on the Open/Off line.

To turn the dip switches ON the dip switch needs to be pressed down to the number side opposite of the open side. Open is off.

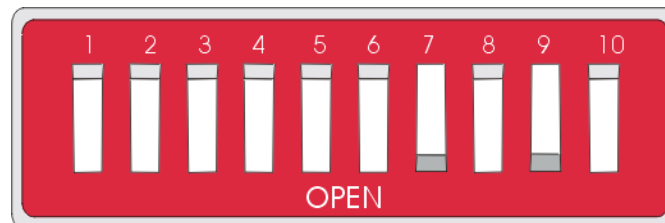

- Switch #1 = 1 seconds
 #2 = 2 seconds
 #3 = 4 seconds
 #4 = 8 seconds
 #5 = 16 seconds

Example: If you turn #3 and #4 on, the time delay will be 12 seconds.

<u>Machine</u>	<u>Recommended Amount of Oil</u>	<u>Set Timer to Number of Seconds (Your results may vary.)</u>
PT14	4.5 oz.	3 seconds

MR16	5.5 oz.	4 seconds
DI20	6.5 oz.	5 seconds
PR20	6.5 oz.	5 seconds
EG20	6.5 oz.	5 seconds
DI32	10.5 oz.	9 seconds
PR32	10.5 oz.	9 seconds
EG32	10.5 oz.	9 seconds
GG32	10.5 oz.	9 seconds
EG48	16 oz.	12 seconds
EG60	20 oz.	16 seconds

- c. Turn on the pump switch and re-check the oil output using steps 1-5 in the Pump Adjustment Section.
- d. Install snap out plug.

F. Bag-N-Box Connector

1. Prepare the box for use by breaking the perforated opening on the box and bending back the corrugated tab. Reach inside and grasp the bag spout. Place the ring of the spout into the box slot and lock it into place with the corrugated tab.
 - a. Place the Bag-N-Box in the appropriate shelves. Next remove the travel cap from the spout. The travel cap prevents the dirt and dust from coming in contact with the internal slider for sanitary hook-up.
 - b. Snap the locking plate over the bag spout. The tapered probe on the connector is then pushed into the bag spout and it locks into place. This bi-directional locking action does two things. One, it eliminates any possibility of accidental disconnect, giving the user a “fool proof” positive connection and two, it opens the channel allowing product to follow.
 - c. When the Bag-N-Box container is empty, disengage the connector by snapping the connector probe into the out position and remove it from the bag spout. This disconnects and reseals the bag. All product contact surfaces are protected ensuring a sanitary situation.
 - d. Repeat steps a-c to properly re-connect Bag-N-Box to the pump.

NOTE: Prior to each attachment of the Bag-N-Box connector, ensure that the probe has not been contaminated. If this has occurred, clean the connector as described in the **Sanitation Instructions**.

VIII. OPERATING INSTRUCTIONS



Do not attempt to operate your Cretors popcorn machine or oil pump until you have read and understood this manual. Failure to do so may result in serious injury or death.



Do not attempt to operate your Cretors popcorn machine or oil pump unless the installation instructions have been strictly adhered to. Failure to do so may result in serious injury or death.



Operate your oil pump only if it is in good sanitary condition (See **SANITATION INSTRUCTIONS**). Failure to do so may result in illness to your customers.



Always turn the kettle heat switch off when not popping corn. Failure to do so will cause oil to stain the kettle, possibly resulting in an unsanitary condition. It may also cause a “flash” fire if oil is added to a kettle left unattended with the heat on, resulting in serious burns or death.

A. Operate only after “Installation Instructions” in the Service Manual have been followed.

B. To operate your Cretors 7900 oil pump:

1. Turn on the pump switch, located on the popper, to the on position.
2. Pre-heat the popping oil until liquid, if necessary.
3. Push the oil pump or the One-Pop button to dispense oil. If too much or too little oil is being dispensed, see “Pump Adjustment” in the Service Manual.
4. Exchange boxes by disconnecting bag connector from bottom and connecting to top.
5. Follow the recommended sanitation procedures.

IX. SANITATION INSTRUCTIONS



Be certain the machine is turned off and power is unplugged before sanitizing this machine unless a specific cleaning procedure requires power to the machine. Failure to do so could result in injury or death.



Do not clean heated surfaces until they have been given sufficient time to cool. Failure to do so may result in serious burns or scalds.

The 7900 pump is designed as a closed system and should remain aseptic.

If you believe your pump system is contaminated, then you will need to clean the system.

The pump is cleaned using the following steps:

1. Remove the Bag-N-Box connector.
2. Place the end of the oil tube into hot soapy water in a pail.
3. Cycle pump sufficiently to flush system. Be sure to have a container to catch the water at the discharge tube near the kettle.
4. Move the oil tube to clean hot water and cycle pump to flush hot soapy water from the system.
5. **IMPORTANT:** When system is clean, you must then cycle the system with oil to prevent any damage to the pump. **Never leave the pump wet with water only.** Mineral oil may be used.

To Clean Bag-N-Box Connector:

1. Remove from tubing.
2. Remove probe body from clamp by spreading clamp body tabs and sliding probe body out.
3. Remove probe spout adapter from probe body by unscrewing stem from probe body.
4. Remove seal body and spring from stem and nut assembly by unsnapping seal body from stem.
5. Clean all parts in accordance to NSF and local requirements (hot, soapy water, and rinse). Do not use petroleum base cleaning agents or abrasive cleaners. Damage to sealing surfaces may occur and jeopardize the sanitary integrity of the connector.
6. Inspect the three "O" rings for damage or imbedded particles. Replace as required.
7. Reassemble by reversing steps 1-4.

Sanitation of your popcorn machine and oil pump is imperative for production of an appetizing product. Failure to follow proper sanitation procedures for food contact surfaces or usage of contaminated ingredients (salt, oil, seasonings) could result in poor product quality and may cause illness to your customers.

Your Cretors oil pump is National Sanitation Foundation (NSF) listed, and can be easily cleaned to assure a high quality product. Use pure ingredients, always emphasize machine sanitation, and follow the sanitation procedures outlined in this manual to protect the welfare of your customers.

X. TROUBLE SHOOTING



In the case of improper operation, only a qualified person should perform the following diagnostic checks, and, if necessary, corresponding adjustments and repairs. Many of the following procedures may present an electrical shock hazard and can cause serious injury or death.



Perform work only on de-energized circuits. Failure to do so may lead to electrical shock resulting in personal injury or death.

PROBLEM	POSSIBLE CAUSE	ACTION
Nothing works.	Is the pump plugged in?	Plug in.
	Is the switch turned on?	Turn on the switch on the popper.
Pump not heating.	Check element.	Use an ammeter to diagnose. Replace if bad.
Motor hums, but will not turn.	Debris in pump.	Clean out pump.
	The motor burned out, because it cannot turn.	Replace motor. Check for the correct alignment between the motor and the pump.
Pump runs all the time.	Timer set incorrectly.	Reset. (See Pump Adjustment)
	Bad timer.	Replace timer.
Motor runs, but does not dispense oil.	Check for oil in the box.	Exchange.
	Pump sucking plastic bag, not oil by the nozzle.	Move connector.
	Is the line clogged?	Assure lines do not have hardened oil blocking the line and heated lines are warm
Amount of oil delivered is not consistent.	Check oil tubing for leakage and for restrictions.	Fix or replace clamps on tubing.
	Bag-N-box connector improperly installed.	Re-install connector.
	Oil is not in liquid state.	Wait till oil is liquid.

Do not attempt to operate pump if the Bag-N-Box is in the upright position.

This manual is filled with time-saving and money-saving information regarding your Cretors Bag-N-Box Oil Pump. There is nothing, however, more important than the safety aids and warnings found throughout this document.

If you have any questions, contact your local distributor and if there are any additional questions, feel free to contact the Customer Service Department at C. Cretors and Company.

Additional copies of this manual can be obtained from C. Cretors and Company at the address listed below. Please provide model and serial number when requesting additional copies of this manual. There will be a nominal charge for additional copies.

Cretors guarantees this machine to be free of defects in parts, materials and workmanship for two years. Please take this time to fill out the factory registration card and return it to Cretors to activate your warranty. If you have any questions concerning the Cretors' warranty, please contact your local distributor or the Customer Service Department at C. Cretors and Company.



C. CRETORS AND COMPANY
176 MITTEL DRIVE
WOOD DALE, IL 60191
PHONE (773) 588-1690, (800) 228-1885, FAX (847) 616-6970

WEB SITE: <http://www.cretors.com> Email: postmaster@cretors.com

7900 - PUMP - 120V
 BEGINNING SERIAL: 99080000

DOC: 79003001

7900-A-3.0-A
 9/99

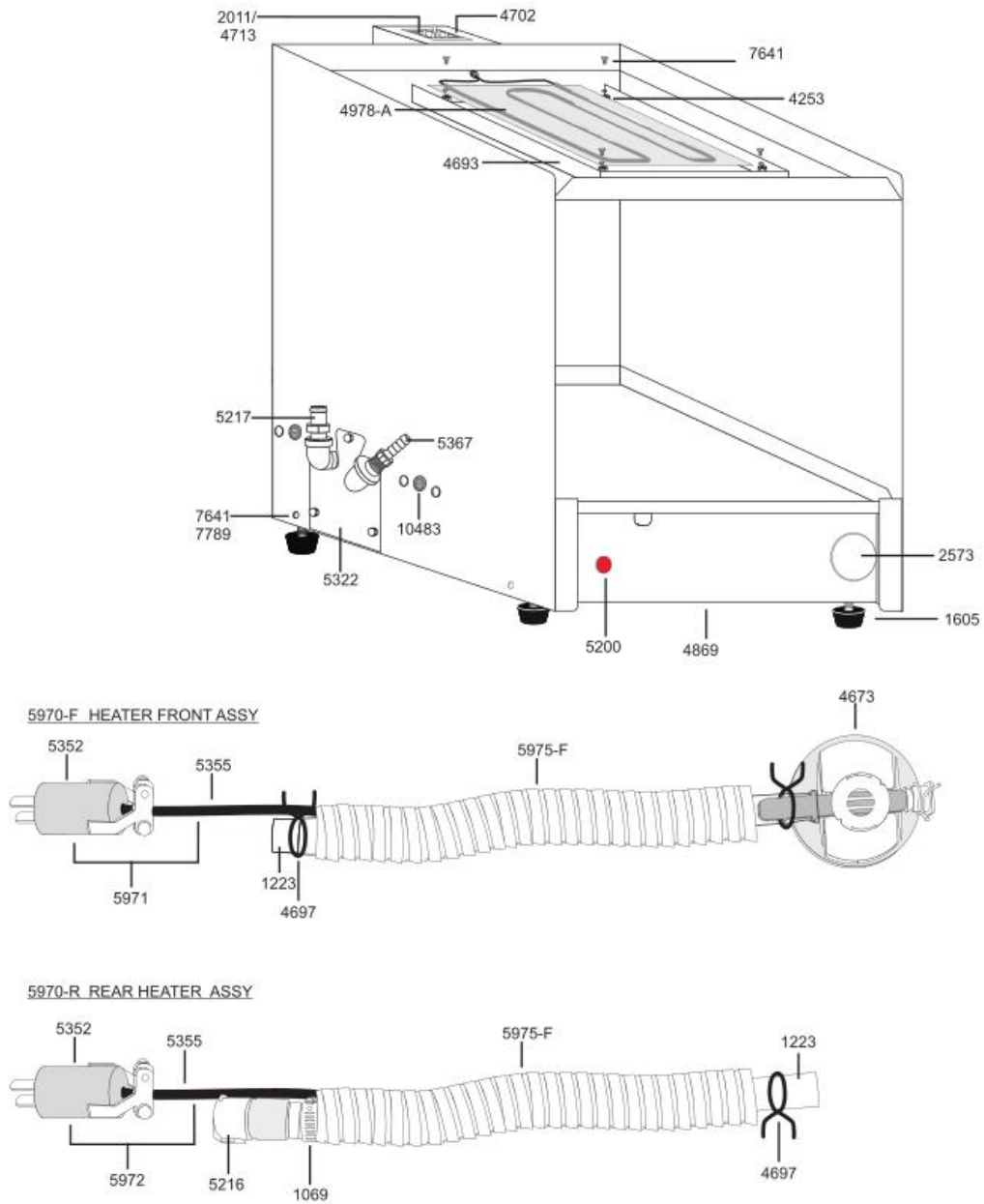

C. CRETORS AND COMPANY

7900 - PUMP - 120V
 BEGINNING SERIAL: 99080000

DOC: 79003001

7900-A-3,0-A
 9/99

1605	RUBBER FOOT W/ HARDWARE
2011	RECEPTACLE
2573	HOLE COVER "O" RING
4253	8-32 x 1/2 SPACER HEX
4693	ELEMENT CORNER
4702	TOP ENDWIRE BOX
4713	RECEPTACLE-GOLD METAL
4869	BOTTOM COVER
4978	HEAT PAD
5200	INDICATOR LIGHT
5217	PLUG - QUICK DISCONNECT
5322	COVER PLATE SIDE DISCHARGE
5367	HOLE BARB
5970-F	HEATED TUBE ASSEMBLY FRONT (Parts Also Sold Separately)
5352	PLUG
5355	HEATER - ROPE 18"
5971	HEATER FRONT ASSEMBLY
5975-F	SLEEVE - STAINLESS STEEL - FRONT
1223	TUBING - NALGENE - CLEAR PER FOOT
5970-R	HEAT TUBE ASSEMBLY REAR (Parts Also Sold Separately)
1069	HOSE CLAMP
5352	PLUG
5355	HEATER - ROPE 18"
5972	REAR HEATER ASSEMBLY
5975-F	SLEEVE - STAINLESS STEEL - REAR
1223	TUBING - NALGENE - CLEAR PER FOOT
7641	8-32 x 1/4 SS TRUSS HEAD
7789	#8 STARWASHER
10483	RECEPTACLE ASSY

7904 WARMER - 120V
 BEGINNING SERIAL: 98074678

DOC: 79043001

7904-A-3.1-A
 9/98

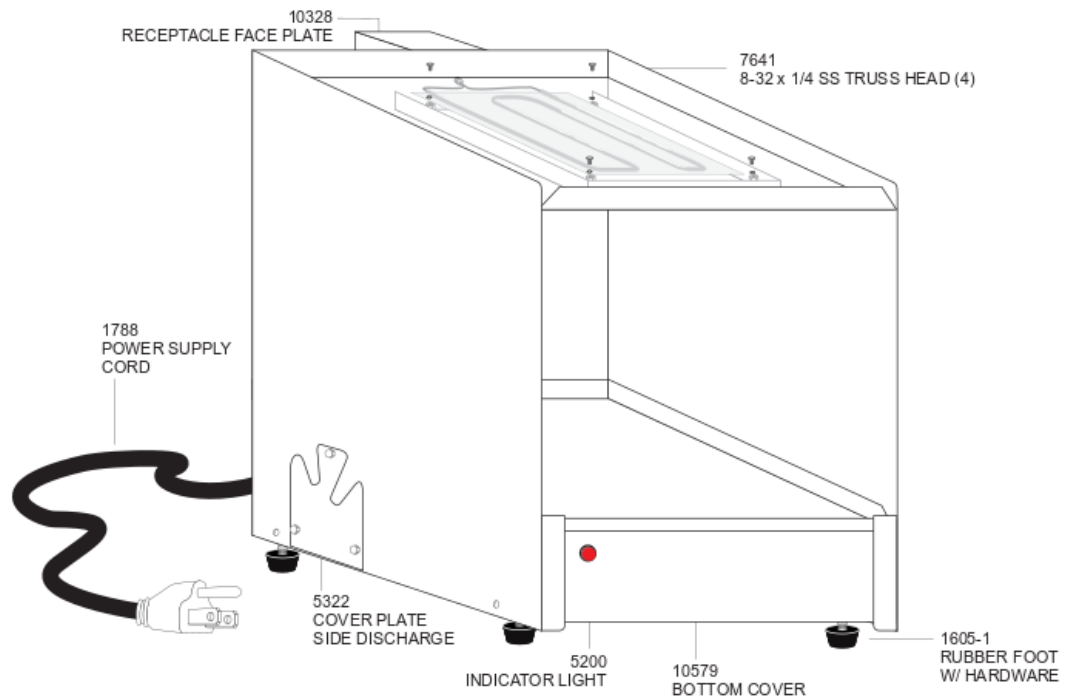

C. CRETORS AND COMPANY

7904 WARMER - 100-120V
 BEGINNING SERIAL: 06104678

DOC: 79043002

7904-A-3.1-B
 10/06

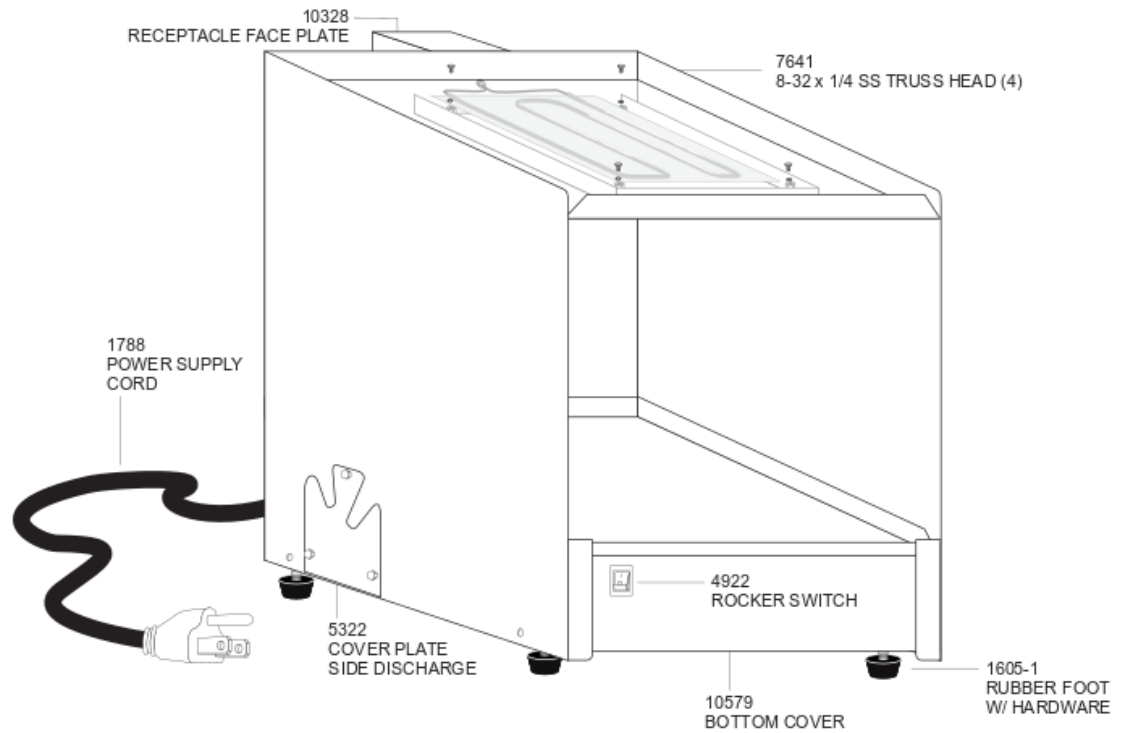

C. CRETORS AND COMPANY

7900 BAG-N-BOX PUMP 120V/230V-HEATED

DOC: 79003004

7900-A-3.1-B
12/18

BOTTOM VIEW
BEGINNING SERIAL: 0504

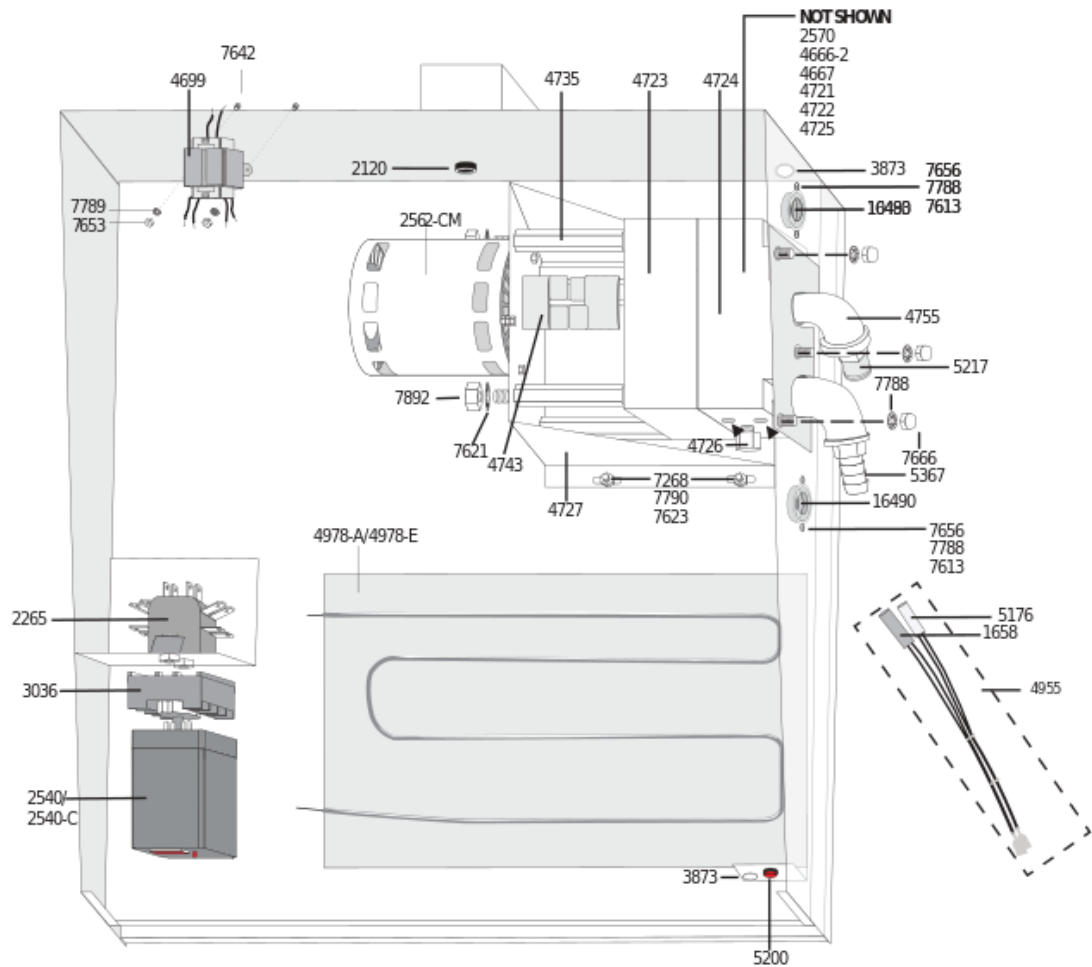

4750 - DUAL CDC PUMP COMPONENTS ASSEMBLED

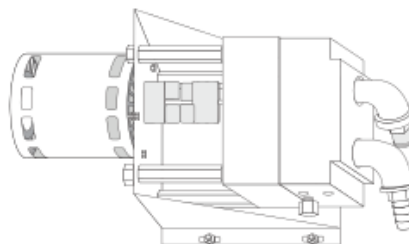

C. CRETORS AND COMPANY

7900 BAG-N-BOX PUMP 120V - HEATED

DOC: 79003004

7900-A-3.1-B
12/18

BOTTOM VIEW

BEGINNING SERIAL: 0504

1658	HEATER - TUBULAR	
2120	BUSHING - HEYCO	
2265	TERMINAL BLOCK 2-PIN	
2540-C	TIMER PLUG-IN - 120V	
3036	RELAY BAS E - 8 PIN	
3873	HOLE COVER 5/8	
4699	TRANSFORMER 40VA - 120/208/240 CLAS	S 2 - 240 V OUTPUT
4723	PUMP BODY W/ SEAL	
4724	VALVE BODY	
4726	STOP PLUG & PIN	
4727	BRACKET	
4735	SPACER	
4734	MOTOR (8D262)	
2562-CM	COUPLING	
4755	ELBOW - 90 DEGREE	
4750	CDC PUMP COMPONENTS	
4978-A/4978-E	HEAT PAD-120V	
5200	INDICATOR LIGHT	
5217	PLUG-QUICK DISCONNECT	
5176	THERMOSTAT - TYPE J	
5367	HOSE BARB	
7268	10-32 x 1/2 SLTD TR HD	
7613	6-32 x 5/16 x 7/64 HEX NUT	
7621	1/4" INTERNAL TOOTH LOCKWASHER	
7623	10-32 HEX NUT	
7642	8-32 X 3/8 SS TRUSS HEAD	
7653	8-32 HEX NUT	
7656	6-32 x 3/8 BINDING HEAD	
7666	6-32 CAP NUT	
7788	#6 LOCKWASHER	
7789	#8 STAR LOCKWASHER	
7790	#10 STAR LOCKWASHER	
7892	1/4-20" x 1 1/64" HEAVY JAM NUT	
16490	RECEPTACLE ASSEMBLY	

NOT SHOWN

2570	PUMP IDLER GEAR (SHORT)
4666-2	SHUTTLE
4667	SPRING
4721	"O" RING
4722	SEAL
4725	GEAR & SHAFT
4721	O RING

C. CRETORS AND COMPANY

176 MITTEL DRIVE

WOOD DALE, IL 60191

PHONE: (847)616-6900, (800)228-1885, FAX: (847)616-6971

WEB SITE: <http://www.cretors.com> Email: postmaster@cretors.com

7900 BAG-N-BOX PUMP 240V - HEATED
 BOTTOM VIEW
 BEGINNING SERIAL 0504XXXX

DOC: 79003006

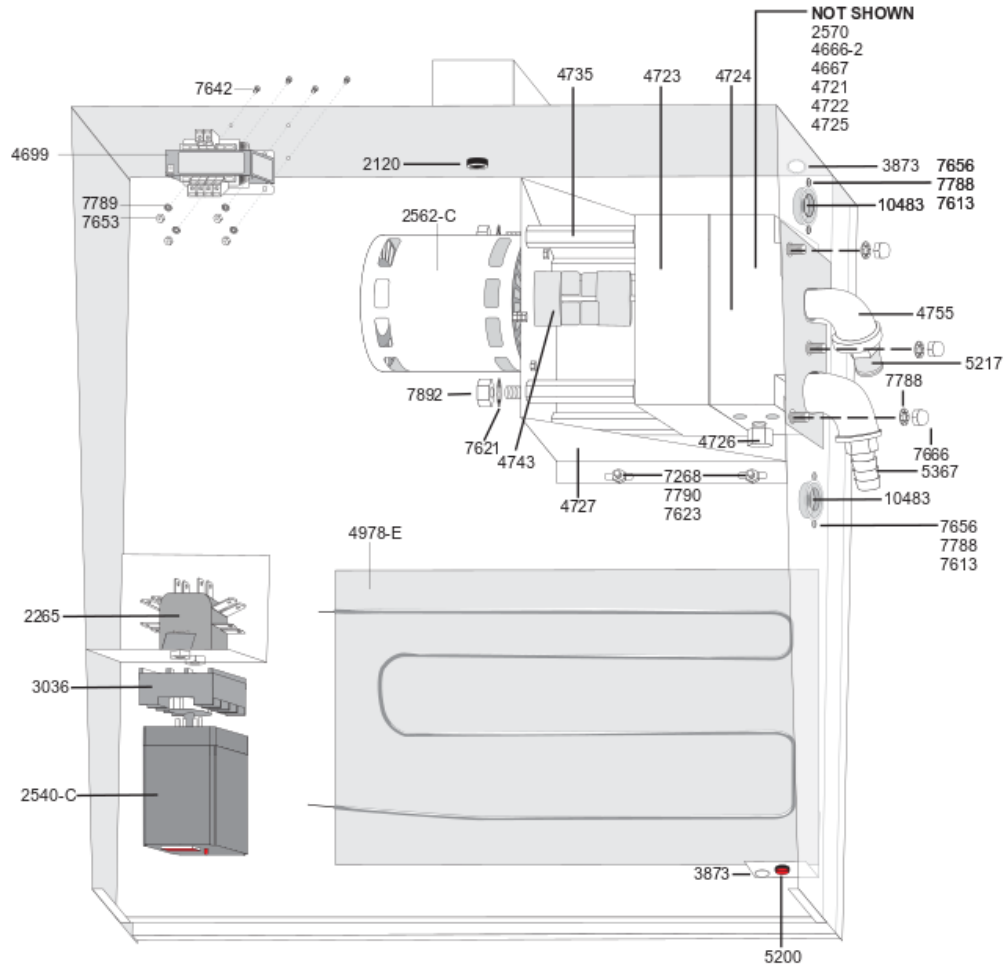
BIB-E-3.1-A
03/05

4750-E CDC PUMP COMPONENTS ASSEMBLED

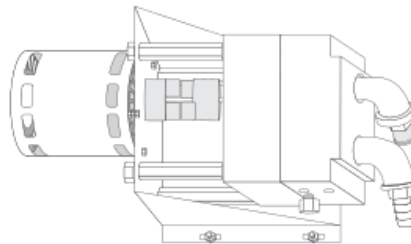

C. CRETORS AND COMPANY

7900 BAG-N-BOX PUMP 240V - HEATED

DOC: 79003006

BIB-E-3.1-A
03/05

BOTTOM VIEW

BEGINNING SERIAL 0504XXXX

2120	BUSHING - HEYCO
2265	TERMINAL BLOCK 2-PIN
2540-C	TIMER PLUG-IN - 230V
2562-C	MOTOR
3036	RELAY BASE - 8 PIN
3873	HOLE COVER 5/8
4699	TRANSFORMER-40W
4723	PUMP BODY W/ SEAL
4724	VALVE BODY
4726	STOP PLUG & PIN
4727	BRACKET
4735	SPACER
4743	COUPLING
4755	ELBOW - 90 DEGREE
4750-E	CDC PUMP COMPONENTS
4978-E	HEAT PAD - 240V
5200	INDICATOR LIGHT
5217	PLUG-QUICK DISCONNECT
5367	HOSE BARB
7613	6-32 x 5/16 x 7/64 HEX NUT
7621	1/4" INTERNAL TOOTH LOCKWASHER
7623	10-32 HEX NUT
7642	8-32 X 3/8 SS TRUSS HEAD
7653	8-32 HEX NUT
7268	10-32 x 1/2 SLTD TR HD
7656	6-32 x 3/8 BINDING HEAD
7666	6-32 CAP NUT
7788	#6 LOCKWASHER
7789	#8 STAR LOCKWASHER
7790	#10 STAR LOCKWASHER
7892	1/4-20" x 11/64" HEAVY JAM NUT
10483	RECEPTACLE ASSEMBLY

NOT SHOWN

2570	PUMP IDLER GEAR (SHORT)
4666-2	SHUTTLE
4667	SPRING
4722	SEAL
4725	GEAR & SHAFT
4721	"O" RING
4722	SEAL

C. CRETORS AND COMPANY

7900 - PUMP - 120V / 230V
 BEGINNING SERIAL: 10050000

DOC: 79003008

7900-A/E-3.1-B
 05/2010

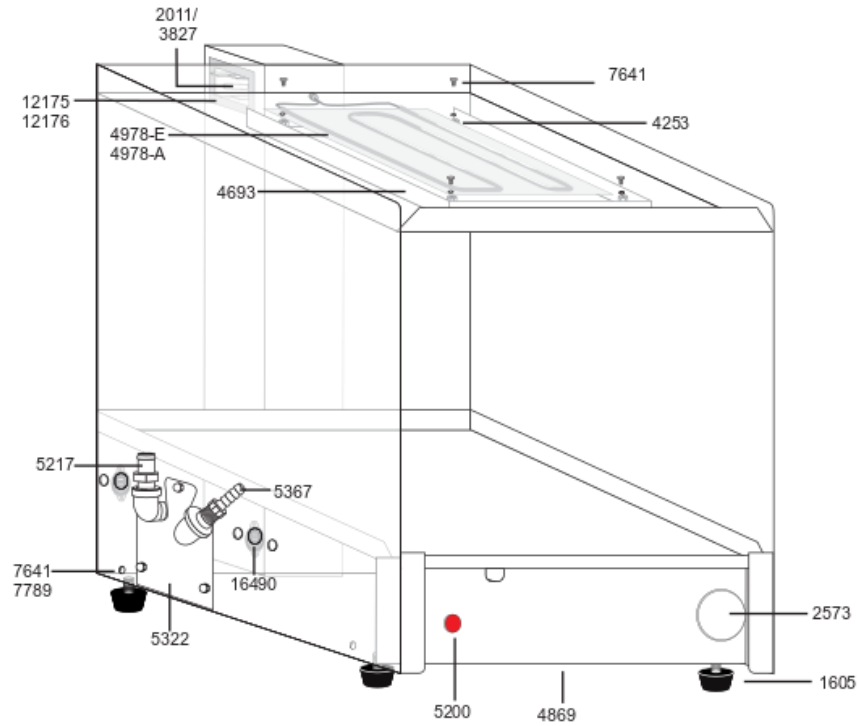

16489-F HEATER FRONT ASSY

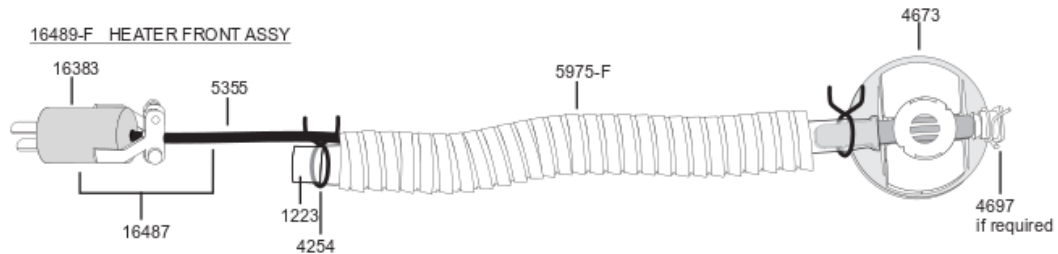

16489-R REAR HEATER ASSY

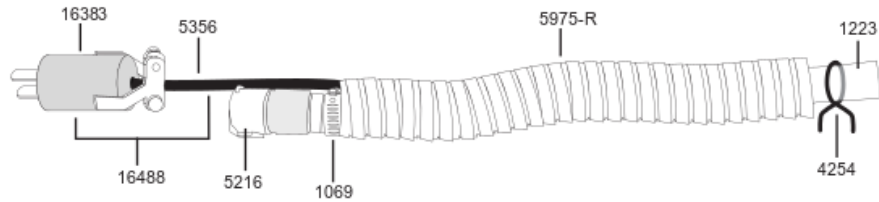

C. CRETORS AND COMPANY

7900 - PUMP - 120V / 230V

BEGINNING SERIAL: 10050000

DOC: 79003008

7900-A/E-3.1-B
05/2010

1605	RUBBER FOOT W/ HARDWARE
2011	RECEPTACLE-120v
2573	HOLE COVER "O" RING
3827	RECEPTACLE-230v
4253	8-32 x 1/2 SPACER HEX
4254	CLAMP-HOSE-SELF TIGHTENING
4693	ELEMENT COVER
4697	HOSE CLAMP-SELF TIGHTENING-1/2
4713	RECEPTACLE-GOLD METAL
4869	BOTTOM COVER
4978-A	HEAT PAD-120V
4978-E	HEAT PAD-230V
5200	INDICATOR LIGHT
5217	PLUG - QUICK DISCONNECT
5322	COVER PLATE SIDE DISCHARGE
5367	HOLE BARB
16489-F	HEATED TUBE ASSEMBLY FRONT (Parts Also Sold Separately)
16483	PLUG
5355	HEATER - ROPE 18"
16487	HEATER FRONT ASSEMBLY
5975-F	SLEEVE - STAINLESS STEEL - FRONT
1223	TUBING - NALGENE - CLEAR PER FOOT
16489-R	HEAT TUBE ASSEMBLY REAR (Parts Also Sold Separately)
1069	HOSE CLAMP
16483	PLUG
5356	HEATER - ROPE 26"
16488	HEATER REAR ASSEMBLY
5975-R	SLEEVE - STAINLESS STEEL - REAR
1223	TUBING - NALGENE - CLEAR PER FOOT
7641	8-32 x 1/4 SS TRUSS HEAD
7789	#8 STAR WASHER
16490	RECEPTACLE ASSY
12175	CONNECTOR PLATE 120V- 7900 PUMP
12176	CONNECTOR PLATE 230V- 7900 PUMP

C. CRETORS AND COMPANY

BAG-N-BOX TOPPER
WIRING DIAGRAM - 120V 60Hz
BEGINNING SERIAL No. 1704

DOC: BIBTar2

04/2017

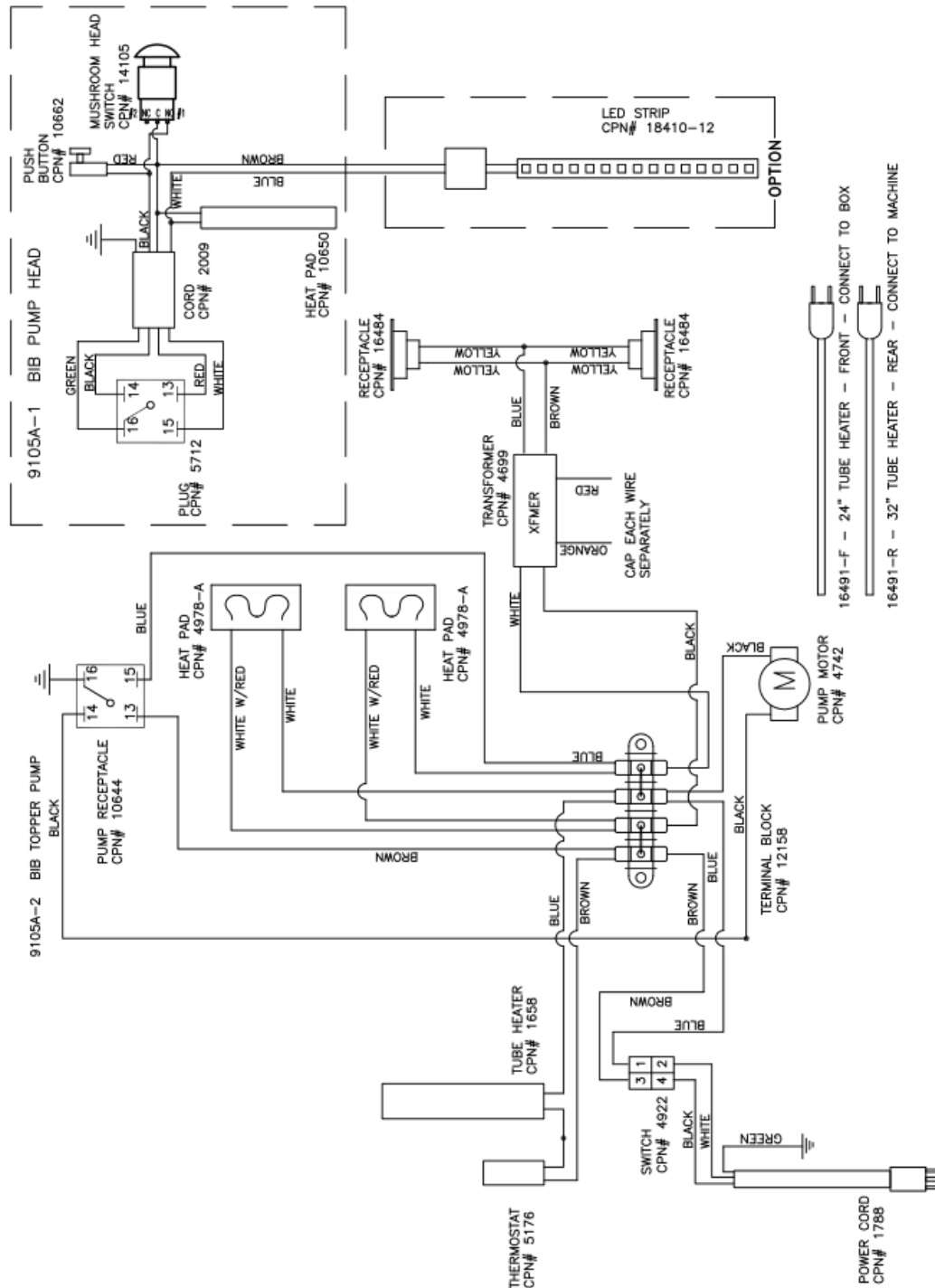

C. CRETORS AND COMPANY
170 MITTEL DRIVE
WOOD DALE, ILLINOIS 60191
PHONE (847) 616-6900, (800) 228-1885, FAX (847) 616-6970
WEB SITE: <http://www.cretors.com> Email: postmaster@cretors.com

BAG-N-BOX PUMP - HEATED
WIRING DIAGRAM - 230V 50Hz.
BEGINING SERIAL No. 1707

LOGIC / SALT SUGAR

DOC: BIBESSr1

07/2017

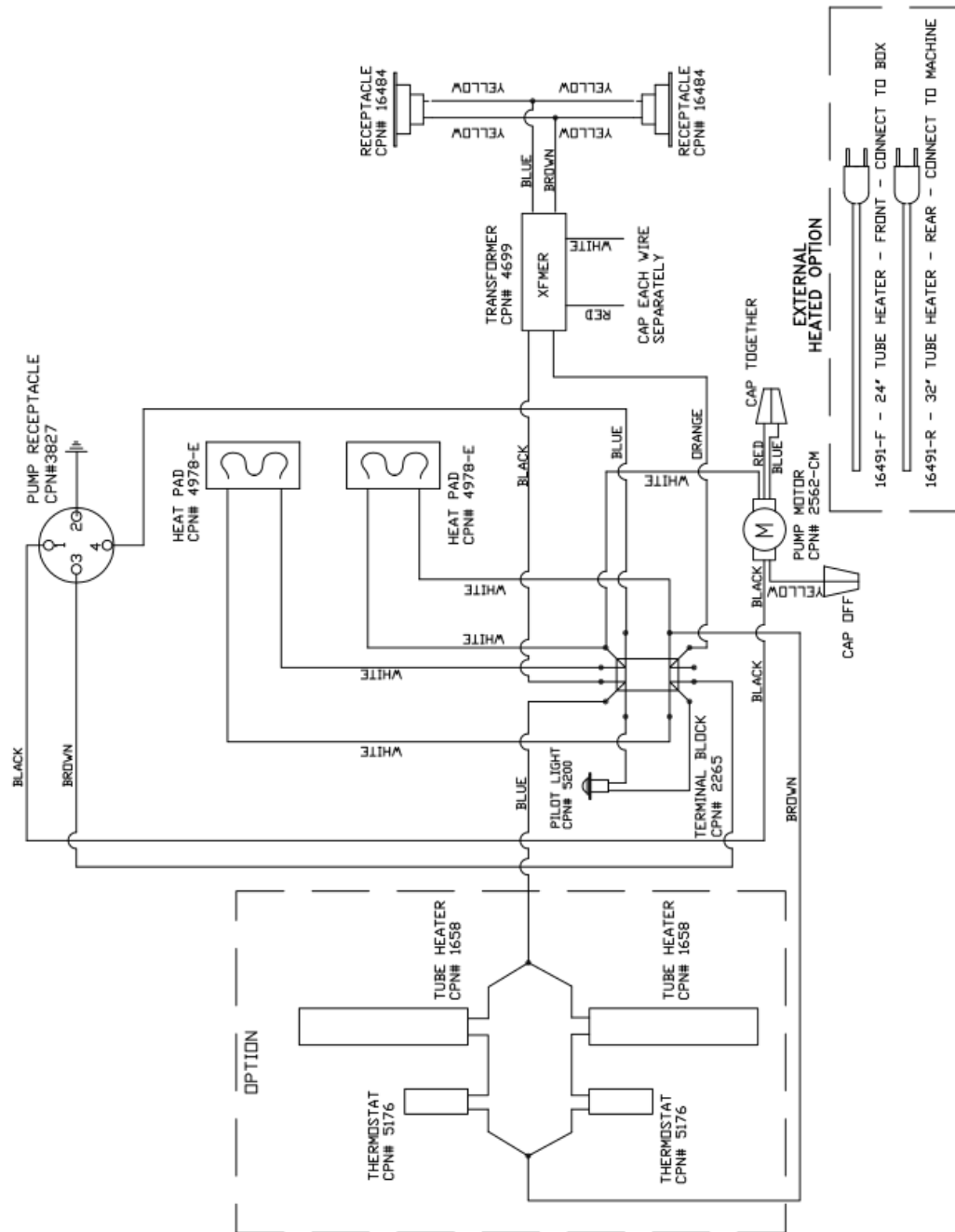

C.CRETORS AND COMPANY
3243 NORTH CALIFORNIA AVENUE
CHICAGO, ILLINOIS 60618
PHONE(773)588-1690, (800)228-1885, FAX (773)588-2171
WEB SITE: <http://www.cretors.com> Email: postmaster@cretors.com

BAG-N-BOX PUMP - HEATED SALT/SUGAR-LOGIC
 WIRING DIAGRAM - 100/120V 50/60Hz.
 BEGINING SERIAL No. 1701

DOC: BIBASSr2

01/2017

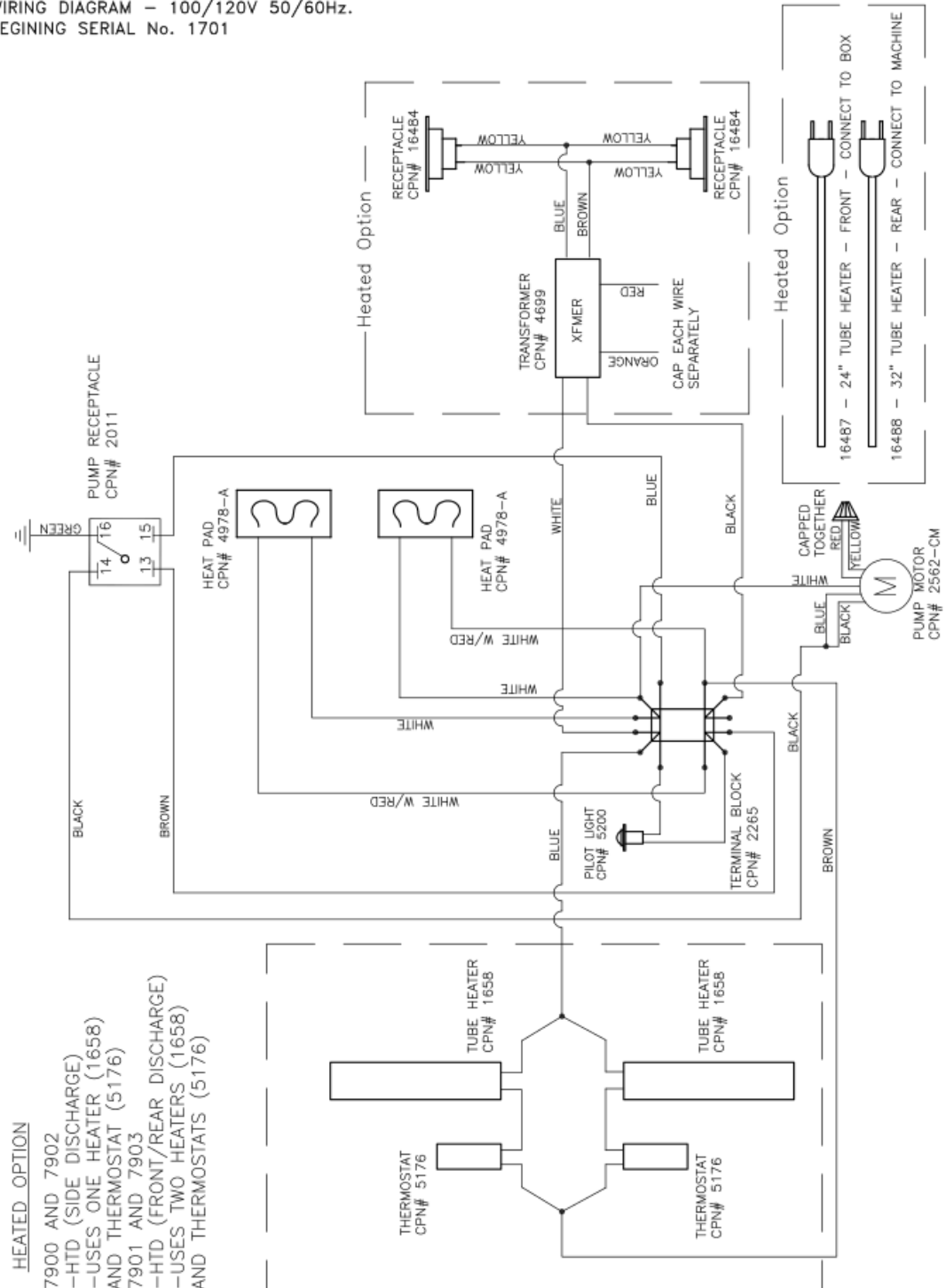

C.CRETORS AND COMPANY
 170 MITTEL DRIVE
 WOOD DALE, ILLINOIS 60191
 PHONE(847)616-6900, (800)228-1885, FAX (847)616-6970
 WEB SITE: <http://www.cretors.com> Email: postmaster@cretors.com



BAG-N-BOX PUMP - 7900/7901/7902/7903 - HTD
 WIRING DIAGRAM - 100-120V 50/60Hz
 BEGINING SERIAL No. 1612

DOC: BIBAr3

12/2016

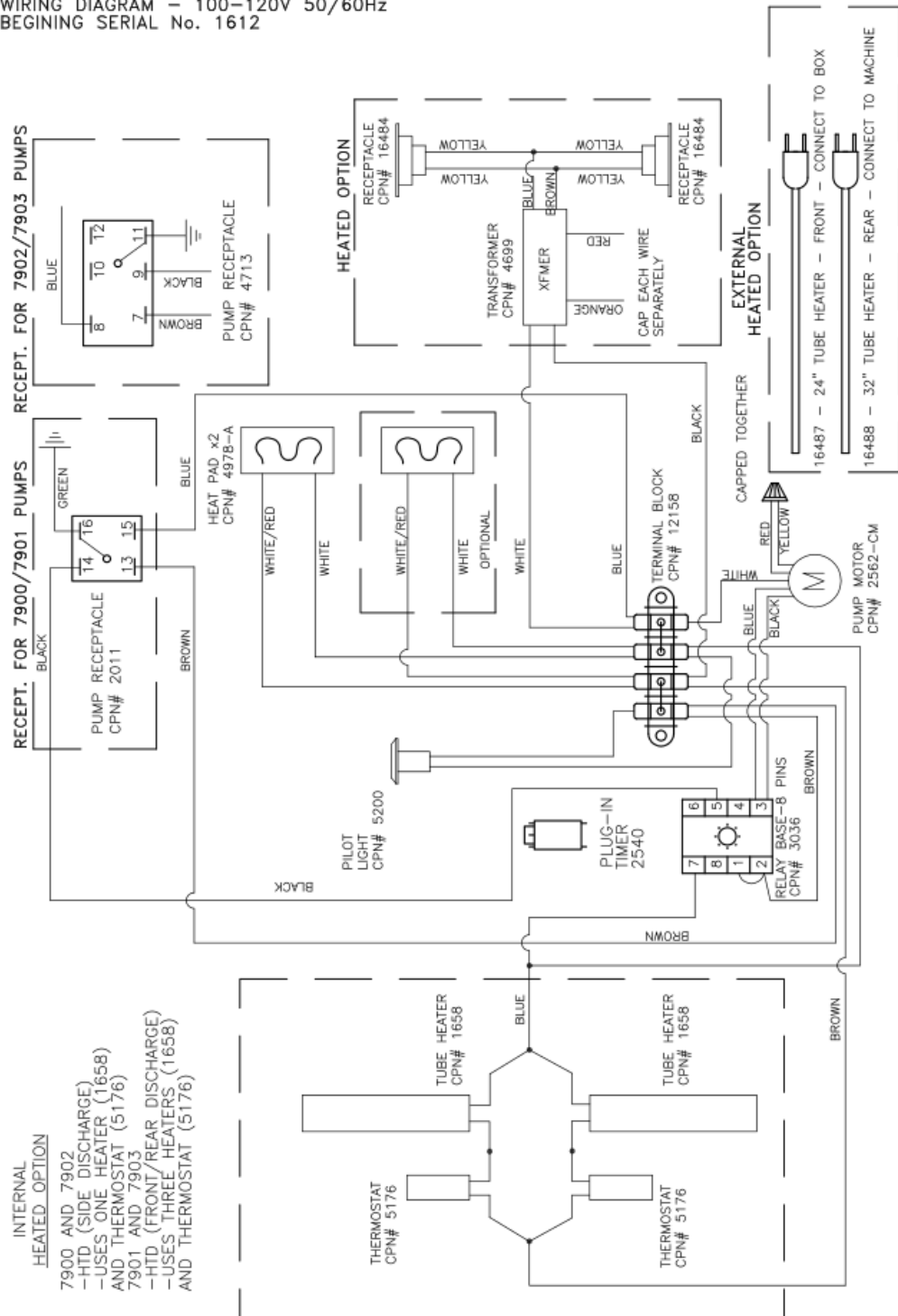

C.CRETORS AND COMPANY
 170 MITTEL DRIVE
 WOOD DALE, ILLINOIS 60191
 PHONE(847)616-6900, (800)228-1885, FAX (847)616-6970
 WEB SITE: <http://www.cretors.com> Email: postmaster@cretors.com