

#7772 Instructions



Step 1

Insert Cam Lock Screws into designated areas as seen.



Step 2

Insert Cam Nut into wooden plank and set plank in the middle as seen.

Make sure Cam Lock Screw and Cam Nut are together.



Step 3

Attach additional wooden planks.



Step 4

Insert Cam Nuts into planks and tighten.



Step 5

Insert screws into designated area as seen.



Step 6

Use a screwdriver to fasten the screws into the fixture.



Step 7

Insert Cam Lock Screws into designated areas as seen.



Step 8

Insert Cam Nut into wooden plank and set plank in the middle as seen.

Make sure Cam Lock Srew and Cam Nut are together.



Step 9

Attach additional wooden planks.



Step 10

Insert Cam Nuts into planks and tighten.



Step 11

Add top plank and insert screws into designated areas as seen.



Step 12

Use a screwdriver to fasten the screws into the fixture.



Step 13

Insert Cam Lock Screws into designated areas as seen.



Step 14

Attach wooden planks as seen on steps 8 through 10.



Step 15

Add top plank and insert screws into designated areas as seen.



Step 16

Use a screwdriver to fasten the screws into the fixture.



Step 17

Insert Cam Lock Screws into designated areas as seen.



Step 18

Attach wooden planks as seen. Make sure to insert Cam Nuts into planks and tighten.



Step 19

Add top plank and insert screws into designated areas as seen.



Step 20

Use a screwdriver to fasten the screws into the fixture.



Step 21

Insert Cam Lock Screws into designated areas as seen.



Step 22

Attach wooden planks as seen.
Make sure to insert Cam Nuts into planks and tighten.



Step 23

Add top plank and insert screws into designated areas as seen.



Step 24

Use a screwdriver to fasten the screws into the fixture.

Step 25

Attach casters, use a screwdriver to fasten the screws into wooden plank.



Step 26

Final result after four casters are attached.



Step 27

Align revolving component with the holes in the wooden plank as seen.

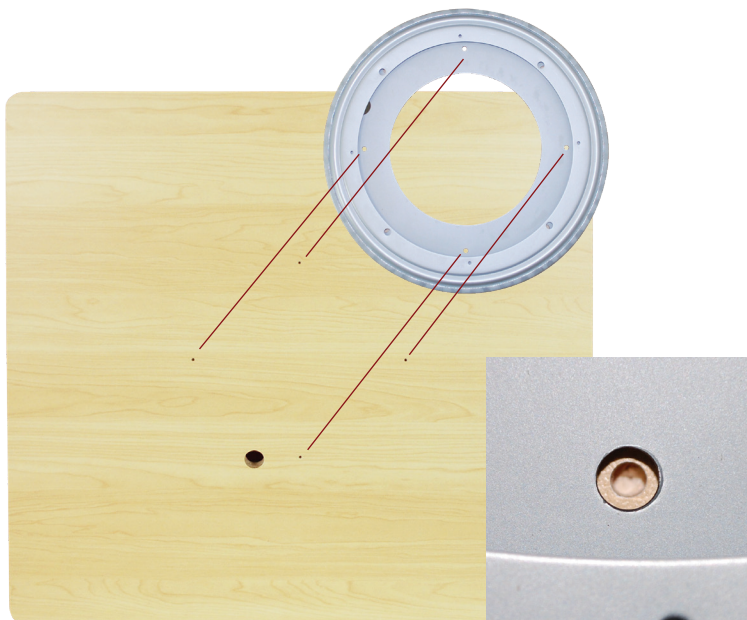

Step 28

Use screws and a screwdriver to fasten the revolving component into the wooden plank.

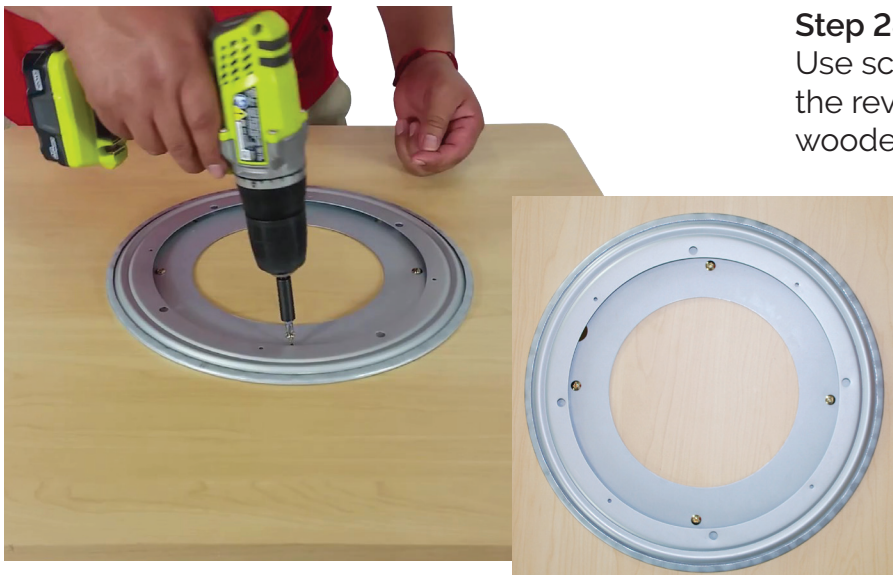

NOTE A

The last steps require that the plank with spinning component be attached to the T-Shirt Display Rack.

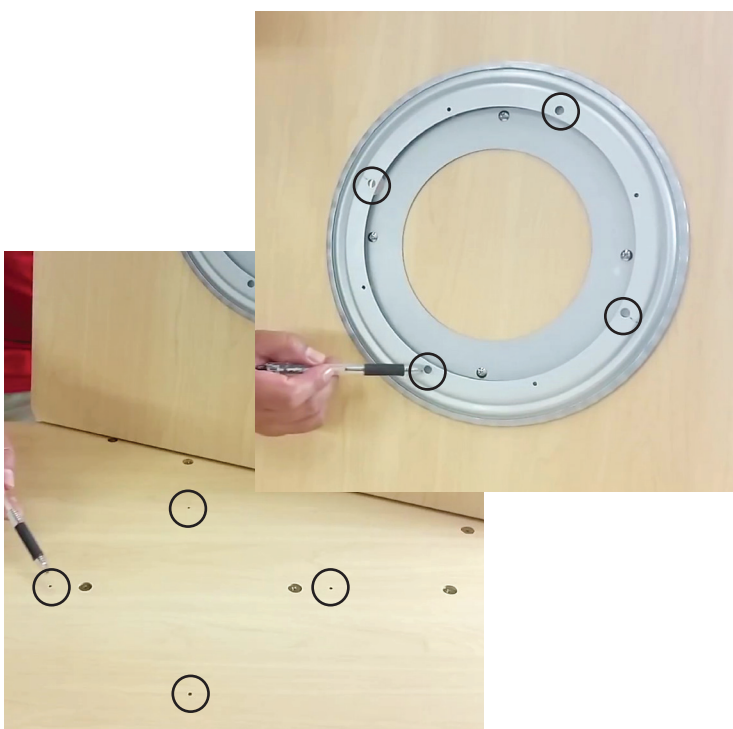

NOTE B

When the plank with the spinning component is flipped up (wheels facing up) the peep hole will be used to align and secure together with screws.



Step 29

Spinning component plank must be facing down with casters facing up as seen.



Step 30

Slowly rotate clockwise, until you see the spinning component and T-Shirt Display line up through the peep hole as seen.

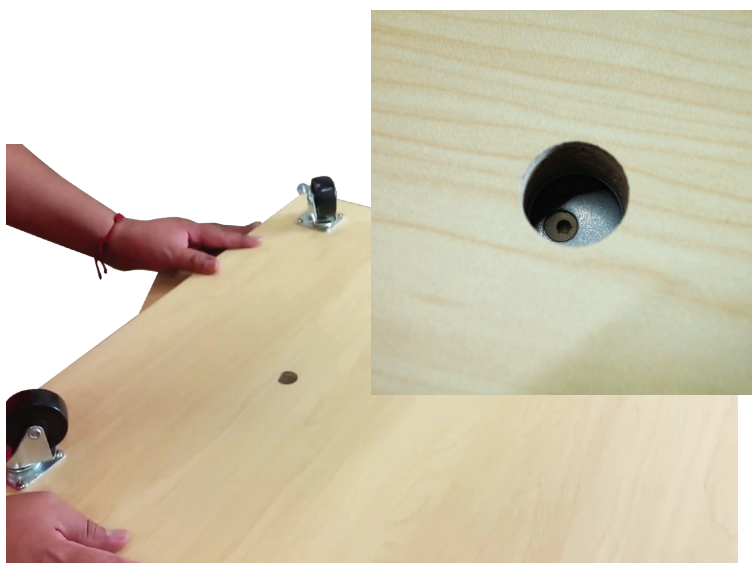

Step 31

Use a screw and a screwdriver to fasten the two components together.

Slowly rotate and redo steps 30 & 31 three more times.

This will have to be done a total of four times to be properly secured.



**The following are supplemental instructions,
they provide an illustrated assembly view of item #7772.**

ASSEMBLY INSTRUCTION



7772

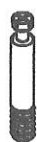
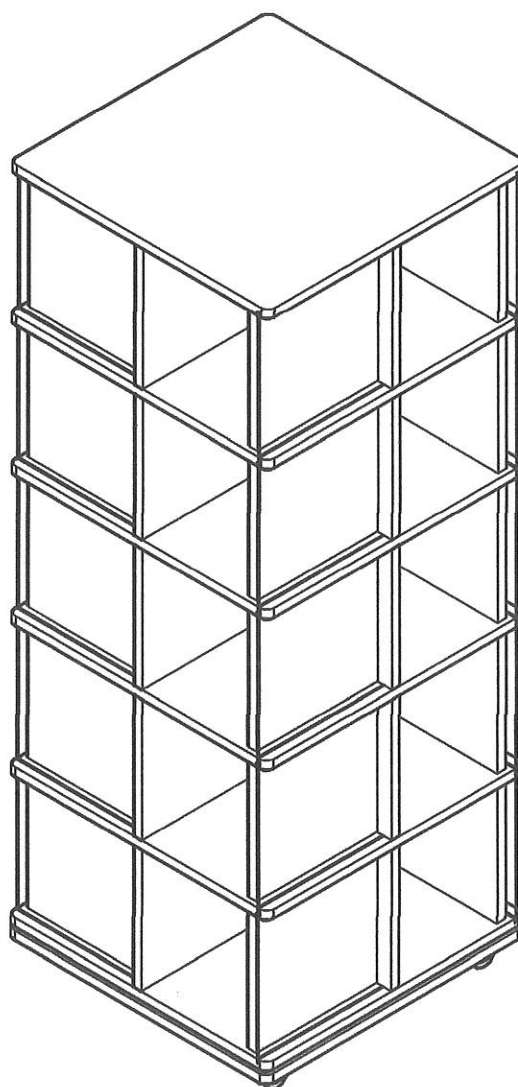

x70



x70



x70



x24



x2



x2

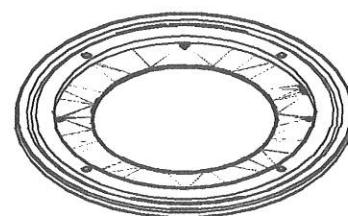

x1

(1)

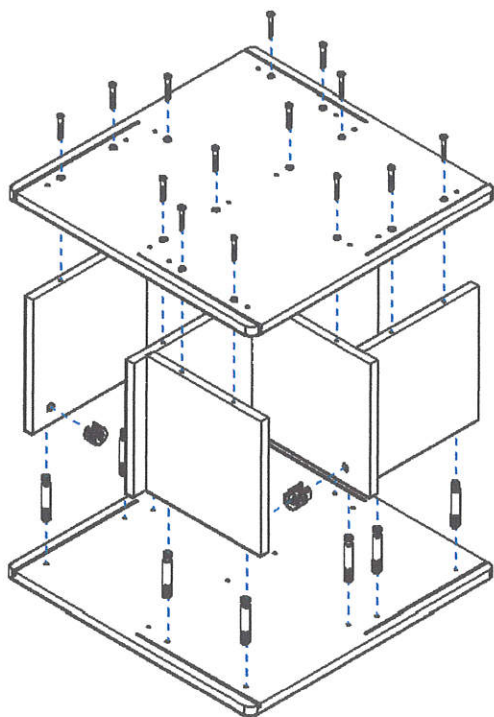

(2)

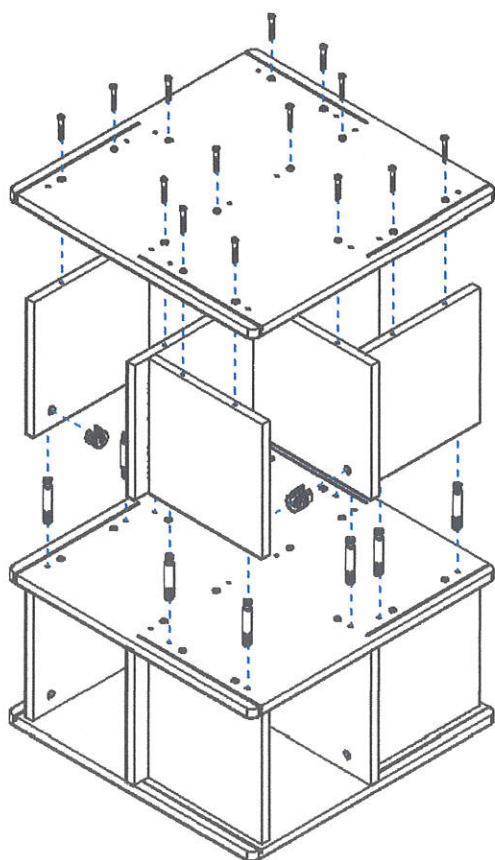

(3)

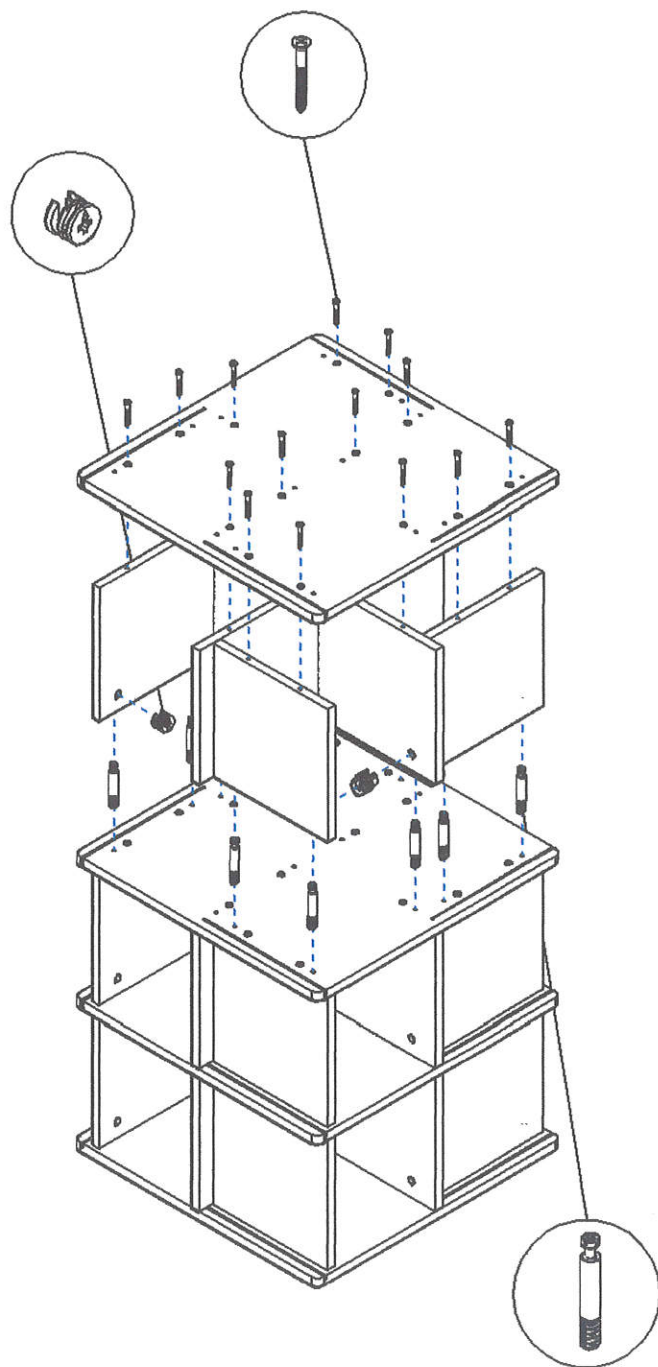

(4)

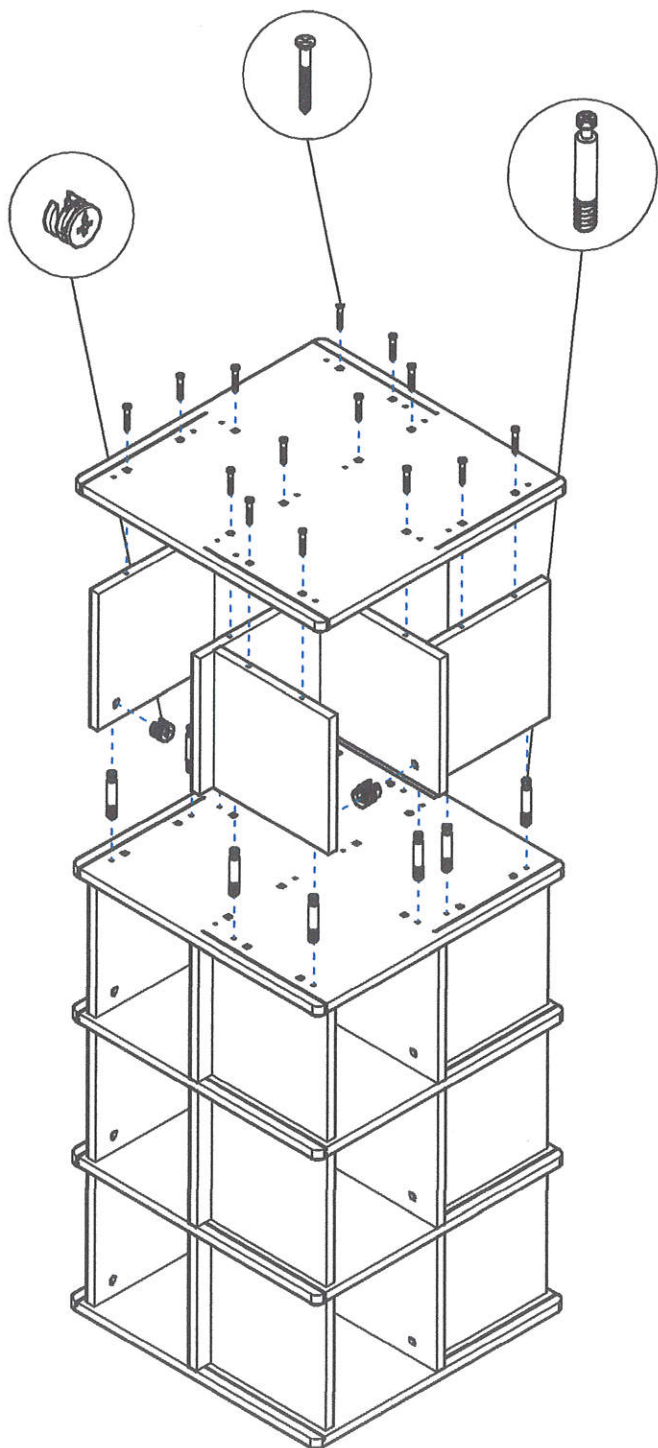

(5)

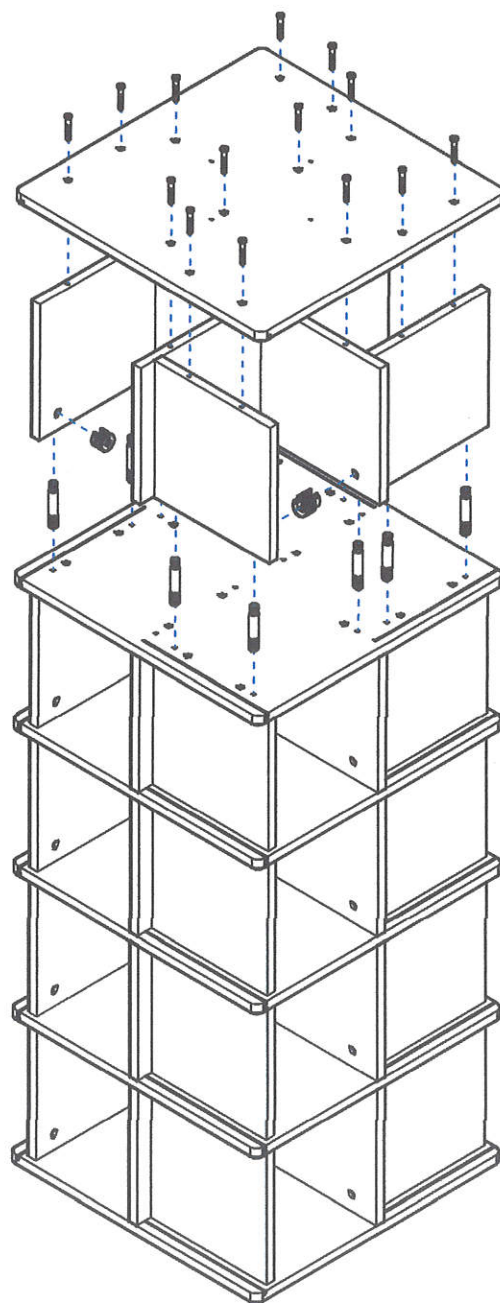

(6)

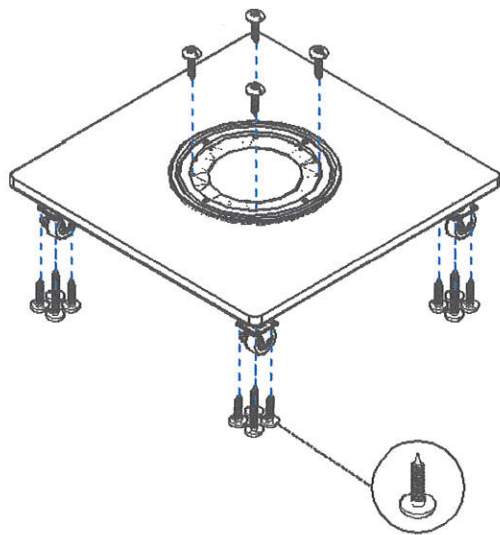

(8)

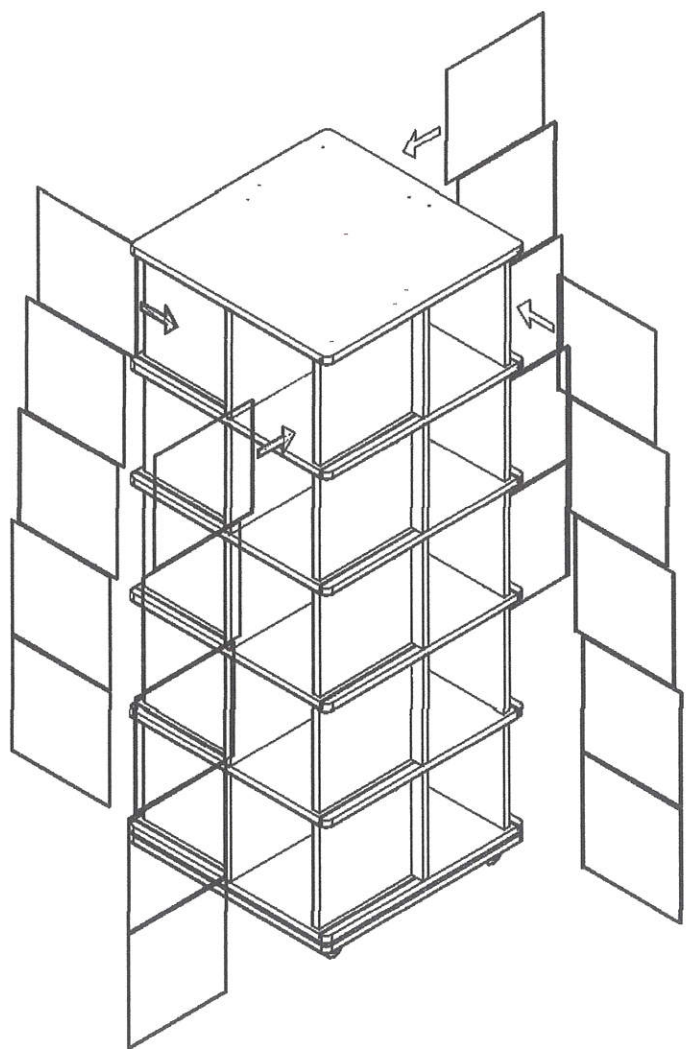

(7)

