

Quick Ship Outdoor Walk-In, 8' W x 10' L x 7'-2 1/4" H Cooler, No Floor, Door Centered on Length Side, LHH Door  
**9'-9 1/4"**

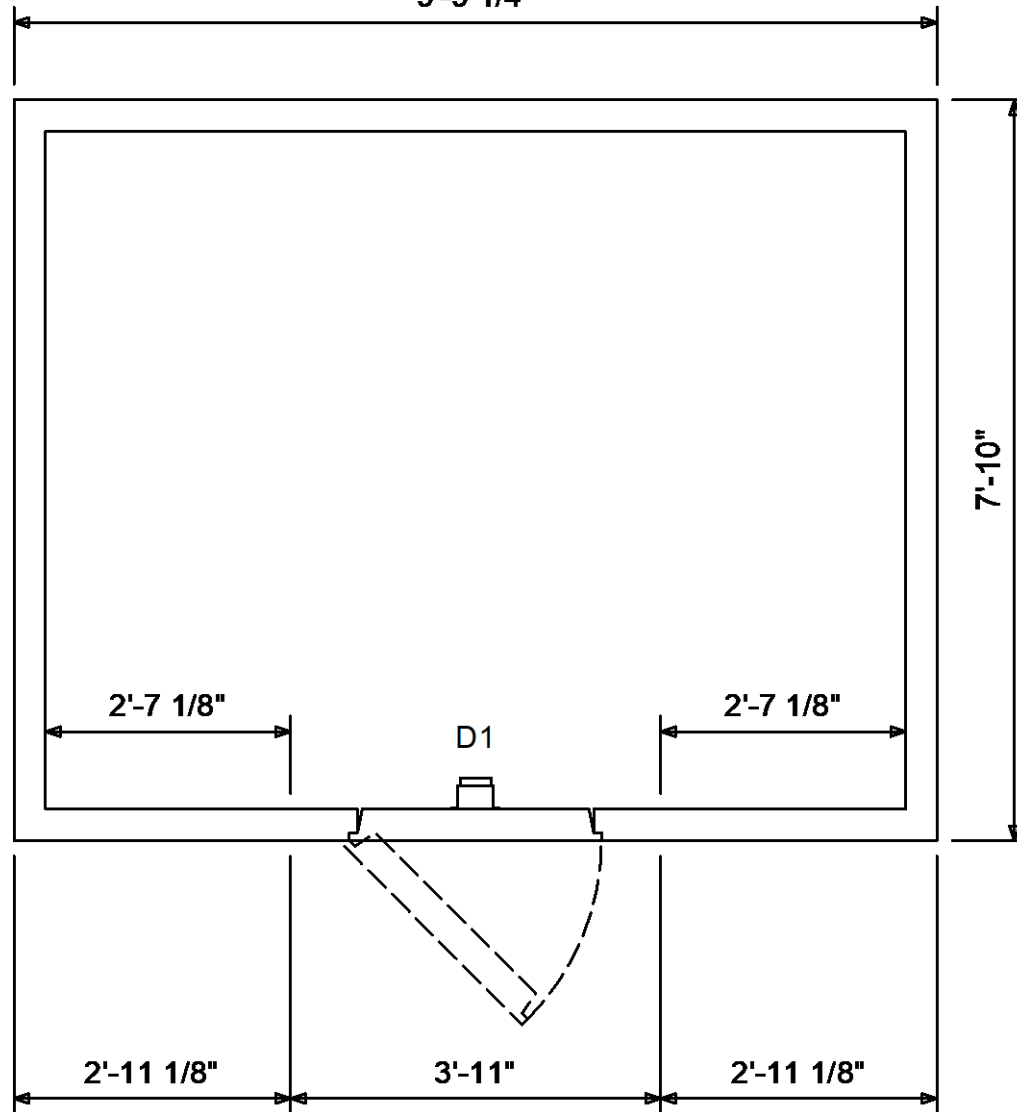

**-SPECIFICATION-  
 MODEL: QC081072LLN-O**

**Standard Features and Specs**

- \* 4" thick NAKS-XPS4 insulation providing R-29 for coolers and R-32 for freezers
- \* 50 year thermal warranty on insulation
- \* 15 year panel warranty
- \* 1 year parts warranty
- Standard Features and Specs
- \* 30" x 76" Left hinged flush door
- \* 2 super cam-rise spring assisted hinged
- \* Interior safety lock release handle
- \* Spring actuated door closer
- \* Digital LED thermometer with pilot light switch
- \* Vapor-proof light centered on interior jamb
- \* 26 guage Acrylume, corrosion resistant, stucco embossed on all interior and exterior surfaces.
- \* Floorless walk-ins are supplied with NSF vinyl screed
- \* Walk-in cooler door electrical 115/1/60, 1.0 amp
- \* 30" x 76" Left hinged flush door
- \* Total shipping weight: 1171 lb (1 pallets)

**Refrigeration:**

By others

**Notes:**

- \* Refrigeration is sized based on holding use, no product load was considered. For product load consult factory

Customer Approval:

Quote #: Revision:	Project: 8 x 10 x 7'-2 1/4 Outdoor Cooler No Floor (Length Side)	Date: 09/15/2020	
	Page 1 of 3		

**-SPECIFICATION-Continued**

- \* Allow a minimum of 2" clearance around all sides of the walk-in for proper air circulation
- \* Floor must be level for proper walk-in installation
- \* Walk-in shipment lead time is subject to terms and conditions
- \* Specifications subject to change without notice

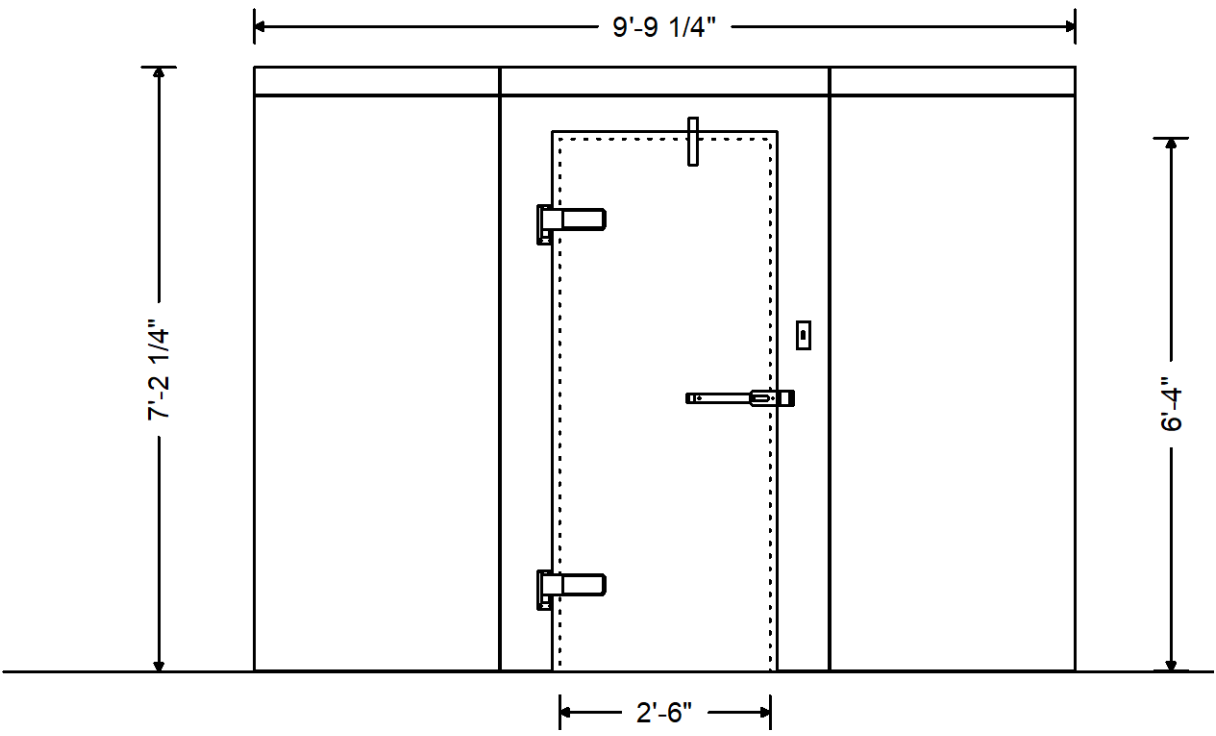

Customer Approval:

\_\_\_\_\_

Quote #: Revision:	Project: 8 x 10 x 7'2-1/4 Outdoor Cooler No Floor (Length Side)	Date: 09/15/2020	
	Page 2 of 3		

See customer label note

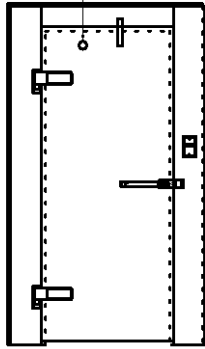

D1

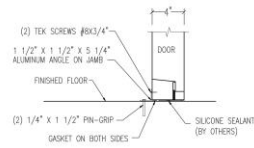

**FLUSH DOOR JAMB ALUMINUM ANGLE**

20018: INTERIOR FLUSH DOOR JAMB ALUMINUM ANGLE: 1 1/2" X 1 1/2" X 5 1/4" TO SECURE TO CONCRETE FLOOR QUANTITY 2 REQUIRED

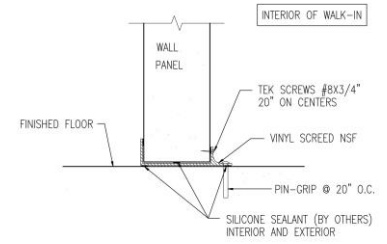

**VINYL CREED WALL PANEL**

8823: NSF VINYL FLOOR SCREED 72"

Quote #: Revision:	Project: 8 x 10 x 7'2-1/4 Outdoor Cooler No Floor (Length Side)	Date: 09/15/2020	
	Page 3 of 3		