

Magnetic Glass Wallboard Installation Guide

07/24/15

USE PROVIDED TEMPLATE
FOR HOLE LOCATIONS

BEFORE INSTALLATION
MEASURE THE BOARD:

Length= _____
Height= _____

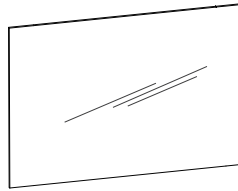

E x1

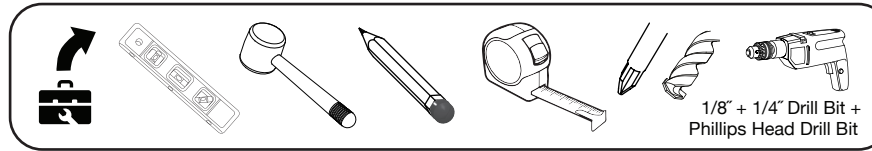

1/8" + 1/4" Drill Bit +
Phillips Head Drill Bit



**Heavy Lifting:
Assistance
Required**

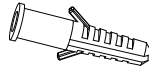

A x4

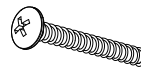

B x4
M5

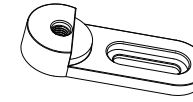

C x4

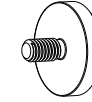

D x4

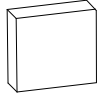

F X varies
depending on
the board size

1

Use included Template to mark drill
locations and padded square locations.
If template is damaged use tape measure.

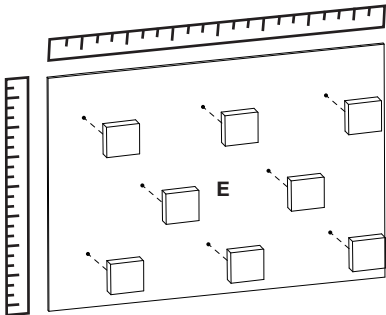

Metal Back



Place padded squares
evenly around the metal
backing of the board.

2

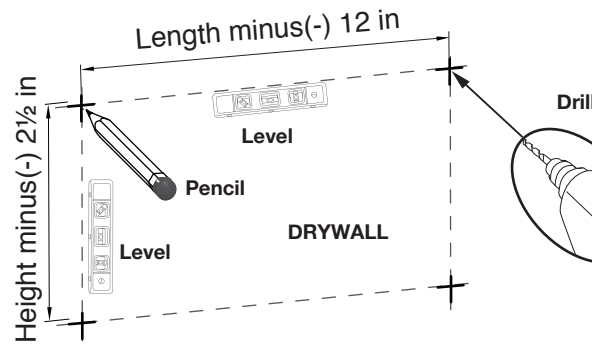

3

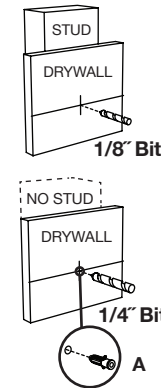

4

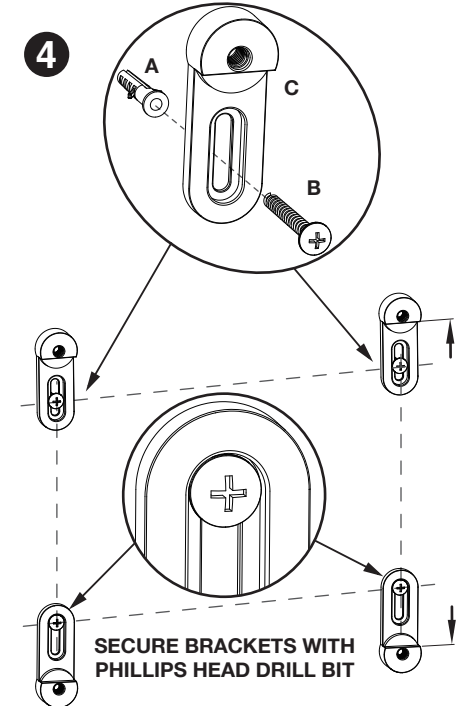

5

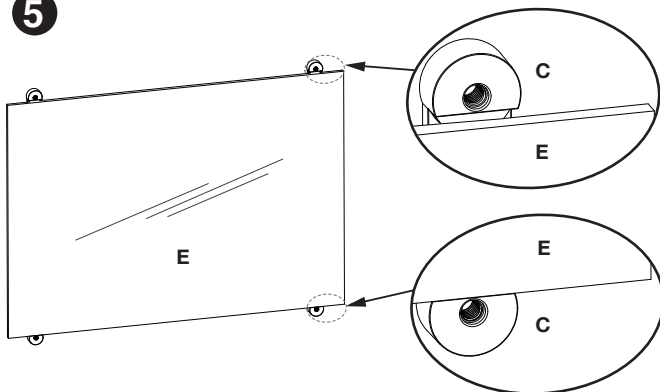

6

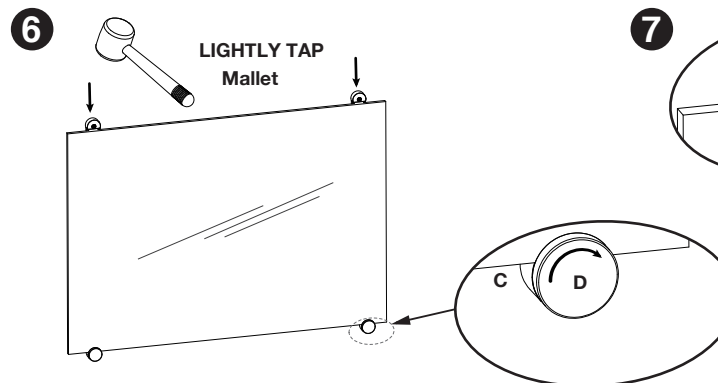

7

