

# INSTRUCTIONS

## #3672



**SPECIALTY**  
STORE SERVICES

fixture & retail solutions

If you need assistance, please contact  
Specialty Store Services at 800-871-2768



- 1** Fix the square wood pipe on the bottom. Use 1.5" screws (x5)

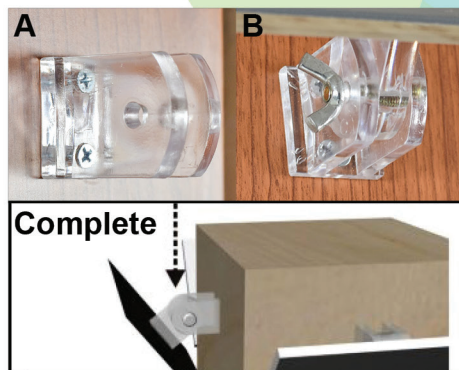

- 2** A: Fix acrylic bracket to wood pipe on all four sides. Use .78" screws (x8) in total.  
B: Fix acrylic mirror tab to acrylic bracket on all four sides. Use 1" screw and turn nut (x4) in total.



- 3** Gather pictured items to assemble the hooks on the boards.

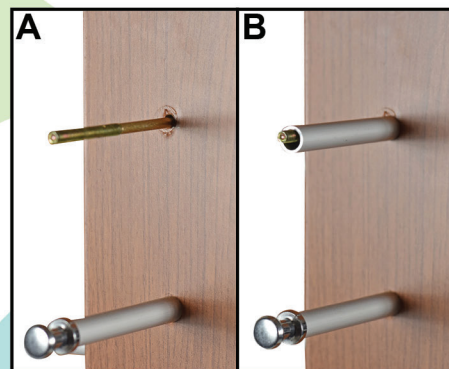

- 4** A: Insert a 3.25" screw into the board.  
B: Add a cover as seen on image.



- 5** Insert end cap and tighten screw. Repeat the process until all four boards are assembled.

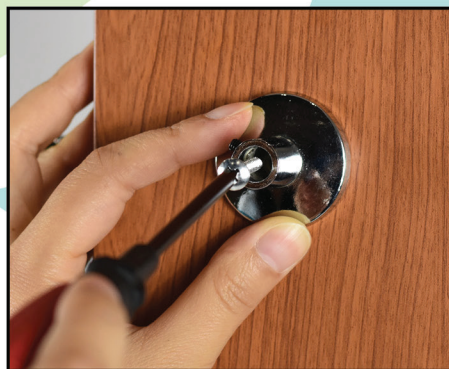

- 6** Fix support base to top and bottom of square wood pipe. Use 1" screw (x8) in total.



- 7** Gather pictured items to assemble and attach support arms.



- 8** Insert cylinder to support base and tighten screw as seen. Assemble to both top and bottom support base.



- 9** Fix and tighten cap screw to board and cylinder/support base.