



# MANUAL TURNOVER MAKER

**#348ETM**



**Intertek**  
#5017744

CONFORMS TO NSF-2

# INDEX

Safety Precautions ..... 2  
Specifications ..... 3  
Available Dies..... 3  
Operation ..... 4-5  
Cleaning..... 5

## SAFETY PRECAUTIONS



### **WARNING**

**Potential hazard or unsafe practice, which could result in serious injury or death.**

- DO NOT place hands near moving parts while in operation.
- Keep hands away from sharp parts.
- DO NOT operate the machine with loose clothing, jewelry, or long hair that can get caught in moving parts. Wear non-slip shoes while working with the machine. For hygiene and safety, keep hair tied back and wear protective gloves.



### **CAUTION**

**Potential hazard or unsafe practice, which could result in minor or moderate injury or product/property damage.**

- Keep the working area around the machine clean and organized.
- Consider environmental conditions surrounding the machine. Do not use the machine in humid, wet, or poorly lit environments. Do not use the machine close to flammable liquids or gas.
- Keep machine away from children and non-authorized personnel. Do not permit them to go near the machine or its working area.
- DO NOT use any instruments that are not part of the machine to help with operation.
- Check that the machine is not damaged prior to each use. Carefully check that all safety devices are working, that the removable parts are not blocked, that there are no parts damaged, that all the parts have been set up correctly, and that all conditions that could influence the regular function of the machine are in working order.
- If the machine is damaged or there are issues during its use, turn off the machine immediately and contact the manufacturer for assistance or repair. Repairs should only be made by qualified technicians, using the correct manufacturer parts. Non-compliance with these rules may void the warranty.



### **NOTICE**

**Information that needs special attention or must be fully understood, even though not dangerous.**

- This product is intended for commercial use only. Not for household use.
- This product is intended to form pastries into shape. Other use of the turnover machine will cause misuse and could void the warranty.

## SPECIFICATIONS

<b>FINISH</b>	304 Stainless Steel
<b>PRODUCTION</b>	600 Pcs/Hour
<b>DIMENSIONS</b>	20½"W x 9⅞"D x 10⅝"H
<b>WEIGHT</b>	21 lb.
<b>SHIPPING DIMENSIONS</b>	20⅞"W x 11⅜"D x 12⅝"H
<b>SHIPPING WEIGHT</b>	31 lb.

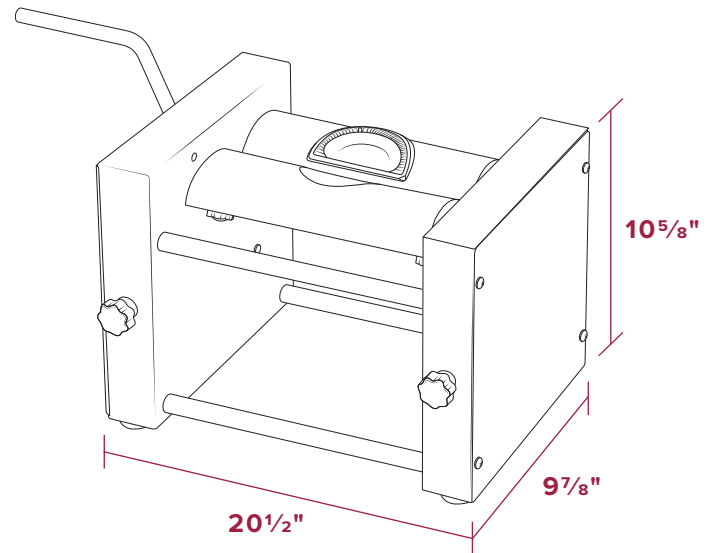

## AVAILABLE DIES

ITEM #	SHAPE	LENGTH	WIDTH
348ETMAD1	Semi-Circular	2 ½"	1 ⅛"
348ETMA1	Semi-Circular	3 ½"	1 ¾"
348ETMA3	Semi-Circular	4 ½"	2 ½"
348ETMA5	Semi-Circular	5"	3"
348ETMA8	Semi-Circular	5 ½"	3 ¼"
348ETMA11	Semi-Circular	6 ¾"	3 ¼"
348ETMA13	Semi-Circular	7 ¼"	3 ½"
348ETMA15	Semi-Circular	8"	4"
348ETMB3	Rectangular	7 ½"	2 ½"

# OPERATION

1. Place the dough sheet on the die mold. (Fig. 1)

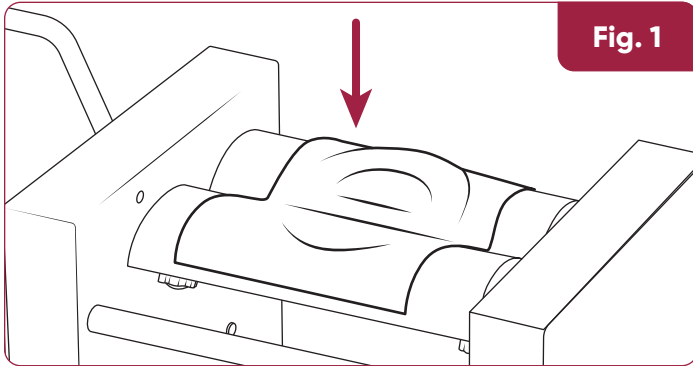

2. Add the filling into the dough sheet groove. (Fig. 2)

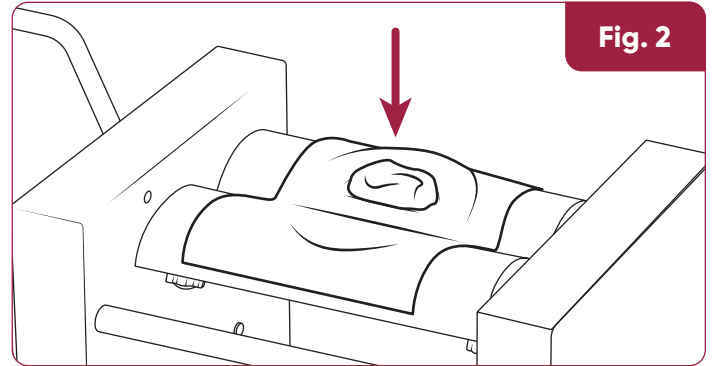

3. Rotate the handle to seal and trim. (Fig. 3)

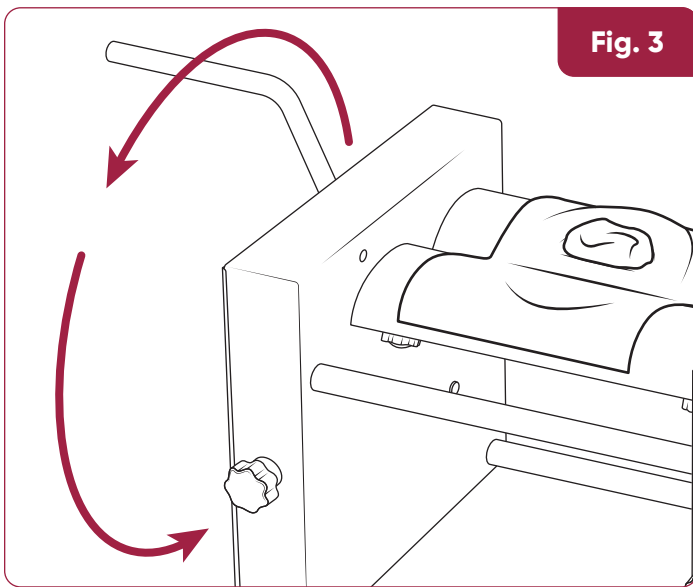

4. The finished product drops at the bottom. (Fig. 4)

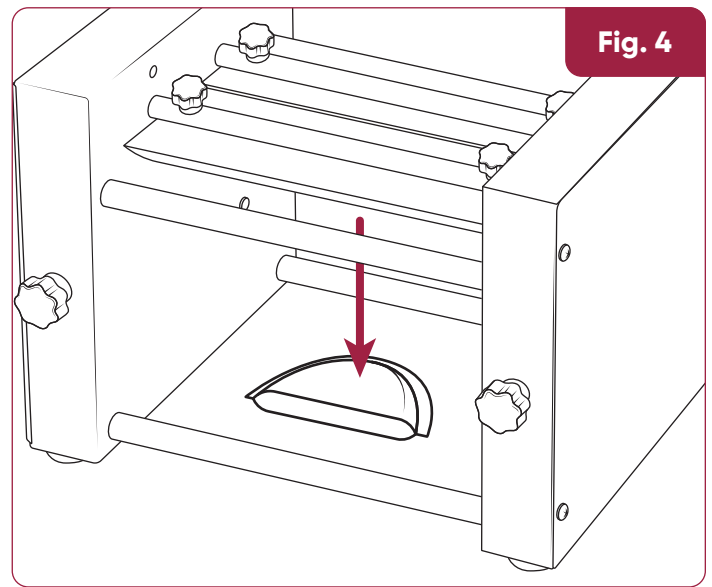

## Thickness Adjustment

1. The thickness can be adjusted using the knobs on the front of the machine. (Fig. 5)
2. Decrease the size of the gap of the die mold by rotating the knobs TOWARD the center of the machine.
3. Increase the size of the gap of the die mold by rotating the knobs AWAY from the center of the machine.

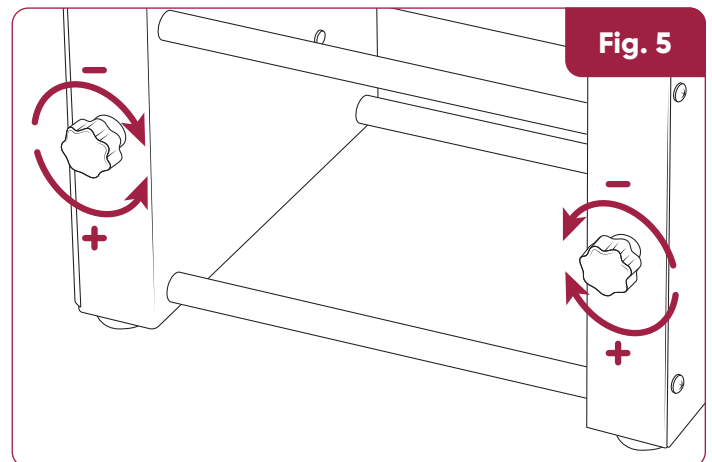

# OPERATION

## Changing the Dies

1. Rotate the handle to turn the mold, ensuring that the side with the screws is facing up.
2. Unscrew the red-colored hexagonal screw and remove the mold.
3. Align the new mold holes with the positioning holes on the support bracket, then screw in the red-colored hexagonal screw and tighten it.
4. Inspect the two newly replaced dies to ensure that the "→" and "←" markings are aligned and the gaps are uniform, and the distance between teeth dies and non-teeth dies are 0.
5. Adjust and calibrate as necessary to ensure that the operation and flipping effect of the machine meet expectations.

# CLEANING

1. Use a clean cloth to wipe the external surface of the turnover machine, removing the flour dust.  
**Note:** Make sure not to let any particles enter the internal components of the machine.
2. There is no need to remove the dies. You can use a mild detergent and a damp cloth to wipe the surface of the dies, removing any residual food or stains.  
**Note:** Ensure that no water or cleaning agent enters the internal parts of the machine.