

#257SBHT500

# Straight Back Hand Truck with 10" Pneumatic Wheels

### ASSEMBLY TIPS

- Read instructions thoroughly before proceeding.
- Tighten all parts by hand. Don't use power tool.
- For you safely, please do not coverload.
- For pneumatic wheel: Please check air pressure in tires. Maintain (30) PSI.

### PARTS LIST

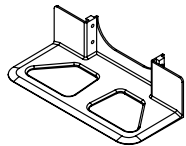

**A** Toe Plate (x1)

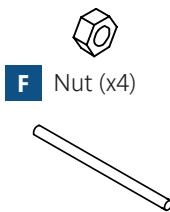

**B** Axle (x1)

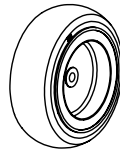

**C** Wheel Bracket (x2)



**G** M6 x 45 Screw (x4)



**H** Pin (x2)



**D** M8 x 55 Screw (x4)



**E** Washer (x4)

### STEP 1

- Attach one of the wheel brackets and one side of the toe plate to the reinforcing support using the M8 x 55 screws and nuts as shown above. Wait to fully tighten until next step.

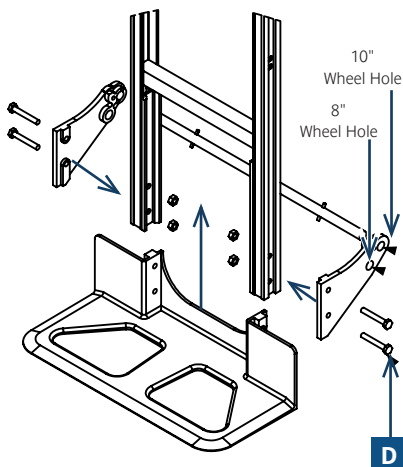

### STEP 2

- Place a washer over the axle, then the first wheel, followed by another washer as shown above. Insert the pin into the axle hole to secure the wheel in place. Repeat for second wheel.

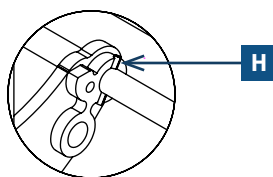

- The pin must be inserted into the groove.

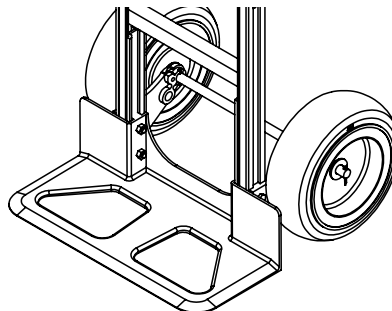

### STEP 3

- Insert the handle and secure in place using the M6 x 45 locking screws as shown above.

