

#275LPDC500

Low Profile Drum Caddy



Table of Contents

Introduction	3
Technical Specifications	3
Operation	3
Exploded Parts Diagram	4
Exploded Parts List	5

Introduction

Thank you for using this low profile drum caddy. For your safety and for correct operation, please carefully read these instructions before use.

NOTE: All of the information reported herein is based on data available at the moment of printing. The factory reserves the right to modify its own products at any moment without notice and without incurring any sanction. It is suggested to always verify possible updates.

Technical Specifications

Model	Capacity	Acceptable Drum Style	Overall Size	Net Weight	Fixed (Rear) Caster Diameter	Swivel (Front) Caster Diameter
257LPDC500	500 kg / 1100 lb.	30 or 55 gallon	37 3/8" x 22 3/8" x 29 1/2"	17 kg	5 15/16"	3"

Notice

1. Do not operate the drum caddy unless you are trained and authorized.
2. Please operate the drum caddy on a hard and flat surface. The grade must be less than 2°.
3. Please push the drum when operating the drum caddy.

Operation

1. Remove the handle from the dolly.
2. Use the prongs on the handle to push the top of the drum forward, lifting the front of the drum.
3. Slide the dolly under the drum.
4. Once the drum rests fully on top of the dolly, attach the handle back to the dolly.

Exploded Parts Diagram

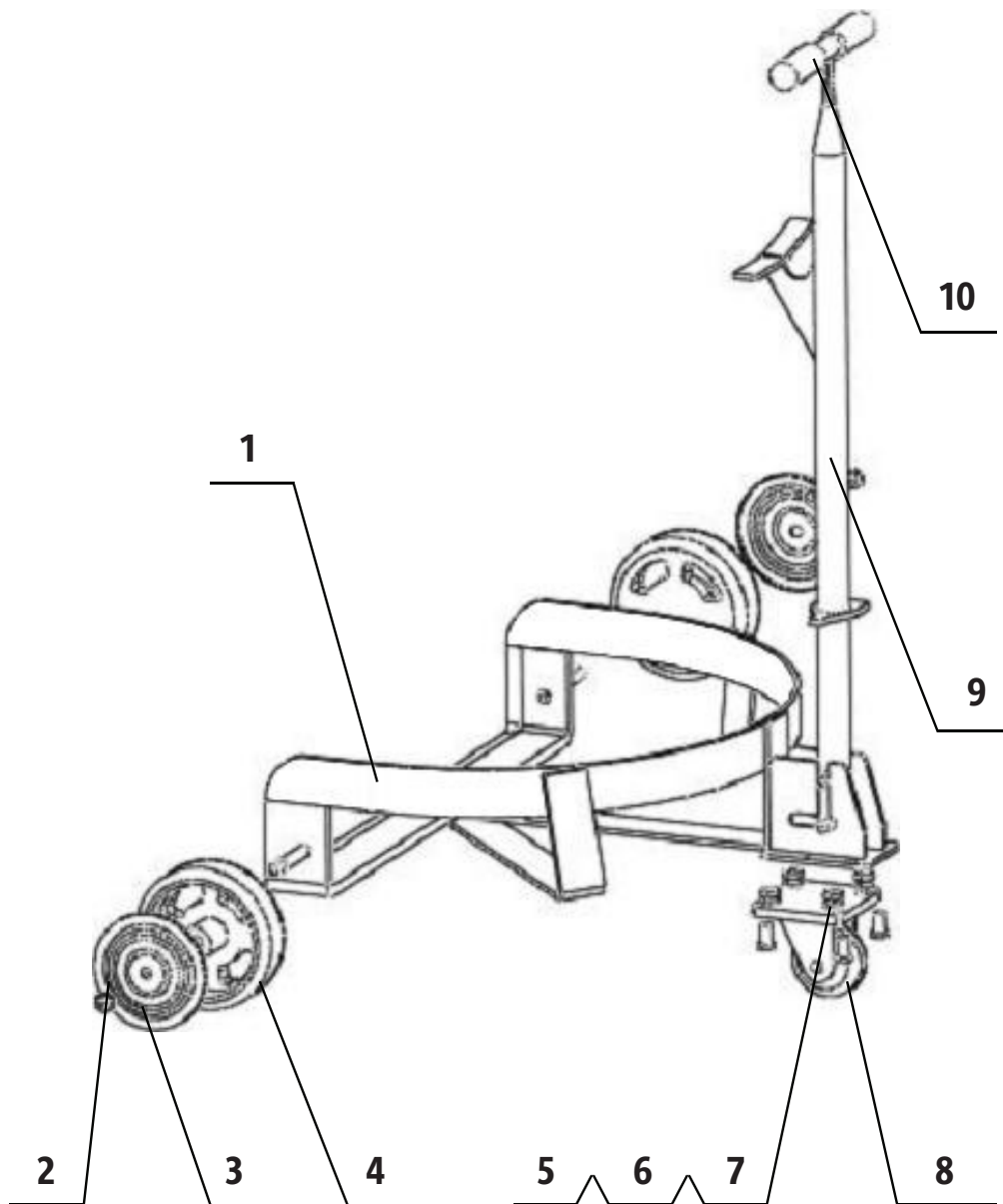

Exploded Parts List

No.	Description	Qty	Remark
1	Drum Body	1	
2	Locknut	2	M12
3	Decked Cover	2	
4	Fixed Caster	2	5 15/16" Diameter
5	Locknut	4	M8
6	Washer	4	8
7	Bolt	4	M18 x 18
8	Swivel Caster	1	3" Diameter
9	Handspike	1	
10	Handle Sheath	2	