

# PREVENTIVE MAINTENANCE PLAN

FROM 26-02-2024

## EAGLE TEMPO



2-3 GROUPS

1 EC



DIGIT VERSION

98260000000348 - MAINTENANCE KIT EAGLE TEMPO 2GR

98260000000349 - MAINTENANCE KIT EAGLE TEMPO 3GR



INSPIRED BY YOUR PASSION.

## Six (6) months or 50000 cycles maintenance

Approximate time for service is 2 hours uninterrupted. Consider that the technicians performing the service are aware of safety measures before commencing in regards to isolating power, pressure of steam and pressure of water.

Information should be sought from the site manger for any problems or concerns before commencing work, and to allow sufficient time to complete the task uninterrupted. Remove all covers before commencing and check for damage/signs of leaks

- |  |   |
|--|---|
| <input type="checkbox"/> Check for any signs of valves leaking                     | <input type="checkbox"/> Check Safety Valve   |
| <input type="checkbox"/> Check and inspect display, ensuring it is not faulty      | <input type="checkbox"/> Check auto fill function   |
| <input type="checkbox"/> Check for boiler leaks                                    | <input type="checkbox"/> Check steam pressure (____Bar)   |
| <input type="checkbox"/> Check the cleaning cycle counts. Total _____ (if present) | <input type="checkbox"/> Check the static water pressure (____Bar)                                |
| <input type="checkbox"/> Check the absolute counter (Total_____) (if present)      | <input type="checkbox"/> Check pump pressure (____Bar)  |
| <input type="checkbox"/> Replace cup gaskets (02280050)                            | <input type="checkbox"/> Check for over all coffee product outcomes                               |
| <input type="checkbox"/> Replace shower screens (03000066)                         | <input type="checkbox"/> Check boiler level   |
| <input type="checkbox"/> Check for any signs of leaking in machine                 | <input type="checkbox"/> Replace wand o-rings (02280047, 02280048)                                |
| <input type="checkbox"/> Check for any damaged wires or caballing                  | <input type="checkbox"/> Replace the wand kit (or-compass-spring – 982600213) for steam wand      |
| <input type="checkbox"/> Check for noisy pump motor                                | <input type="checkbox"/> Replace the wand kit (or-compass-spring – 982600211) for easy cream wand |
| <input type="checkbox"/> Check for blockage in waste hose                          | <input type="checkbox"/> Replace the Teflon pipe (11740003)                                       |
| <input type="checkbox"/> Check for leaking from hot water pipe                     |   |
| <input type="checkbox"/> Check anti vacuum valve for leaks                         |   |

**NOTE:** The water hardness must be less than 6° fr (french degree). The chlorine content must not exceed 100mg per litre (0.00000361lb/cu in), otherwise the conditions of guarantee of the machine will expire.

2 GR	3GR
1 X 02280047	1 X 02280047
1 X 02280048	1 X 02280048
2 X 02280050	3 X 02280050
2 X 03000066	3 X 03000066
1m X 11740003	1m X 11740003
1 X 982600211	1 X 982600211
1 X 982600213	1 X 982600213

### DATA

SITE NAME\_\_\_\_\_

TECHNICIAN \_\_\_\_\_

TECHNICIAN SIGNATURE\_\_\_\_\_

DATE\_\_\_\_\_

## Twelve (12) months or 100000 cycles maintenance

Approximate time for service is 2,5 hours uninterrupted. Consider that the technicians performing the service are aware of safety measures before commencing in regards to isolating power, pressure of steam and pressure of water.

Information should be sought from the site manager for any problems or concerns before commencing work, and to allow sufficient time to complete the task uninterrupted. Remove all covers before commencing and check for damage/signs of leaks.

Check, adjust replace (if necessary):

- |  |   |
|--|---|
| <input type="checkbox"/> Check for any signs of leaking in machine                 | <input type="checkbox"/> Check the absolute counter (Total_____ (if present))                               |
| <input type="checkbox"/> Check for any damaged wires or cabling                    | <input type="checkbox"/> Replace cup gaskets (02280050)   |
| <input type="checkbox"/> Check for noisy pump motor                                | <input type="checkbox"/> Replace shower screens (03000066)  |
| <input type="checkbox"/> Check for blockage in waste hose                          | <input type="checkbox"/> Replace anti vacuum Valve (01000023)   |
| <input type="checkbox"/> Check for leaking from hot water pipe                     | <input type="checkbox"/> Replace pre-infusion chamber gasket (02280012)                                     |
| <input type="checkbox"/> Check Safety Valve  | <input type="checkbox"/> Replace wand o-rings (02280036, 02280047, 02280048)                                |
| <input type="checkbox"/> Check auto fill function                                  | <input type="checkbox"/> Replace steam arm protectors (05000660)  |
| <input type="checkbox"/> Check steam pressure (_____Bar)                           | <input type="checkbox"/> Replace filter baskets (03000072, 03000073)  |
| <input type="checkbox"/> Check the static water pressure (_____Bar)                | <input type="checkbox"/> Replace the wand kit (or-compass-spring - 982600213) for steam and hot water wands |
| <input type="checkbox"/> Check pump pressure (_____Bar)                            | <input type="checkbox"/> Replace the wand kit (or-compass-spring - 982600211) for easy cream wand           |
| <input type="checkbox"/> Check for over all coffee product outcomes                | <input type="checkbox"/> Replace the Teflon pipe (11740003)   |
| <input type="checkbox"/> Check boiler level  | <input type="checkbox"/> Replace EC temperature probe (04901530, 092000304)                                 |
| <input type="checkbox"/> Check for any signs of valves leaking                     |   |
| <input type="checkbox"/> Check and inspect display, ensuring it is not faulty      |   |
| <input type="checkbox"/> Check for boiler leaks                                    |   |
| <input type="checkbox"/> Check the cleaning cycle counts. Total _____ (if present) |   |

2 GR	3GR
1 X 01000023	1 X 01000023
2 X 02280012	3 X 02280012
4 X 02280036	4 X 02280036
1 X 02280047	1 X 02280047
2 X 02280048	2 X 02280048
2 X 02280050	3 X 02280050
2 X 03000066	3 X 03000066
1 X 03000072	2 X 03000072
1 X 03000073	3 X 03000073
1 X 04901530	1 X 04901530
1 X 05000660	1 X 05000660
1 X 092000304	1 X 092000304
1m X 11740003	1m X 11740003
1 X 982600211	1 X 982600211
2 X 982600213	2 X 982600213

### DATA

SITE NAME\_\_\_\_\_

TECHNICIAN \_\_\_\_\_

TECHNICIAN SIGNATURE\_\_\_\_\_

DATE\_\_\_\_\_

One year maintenance kit

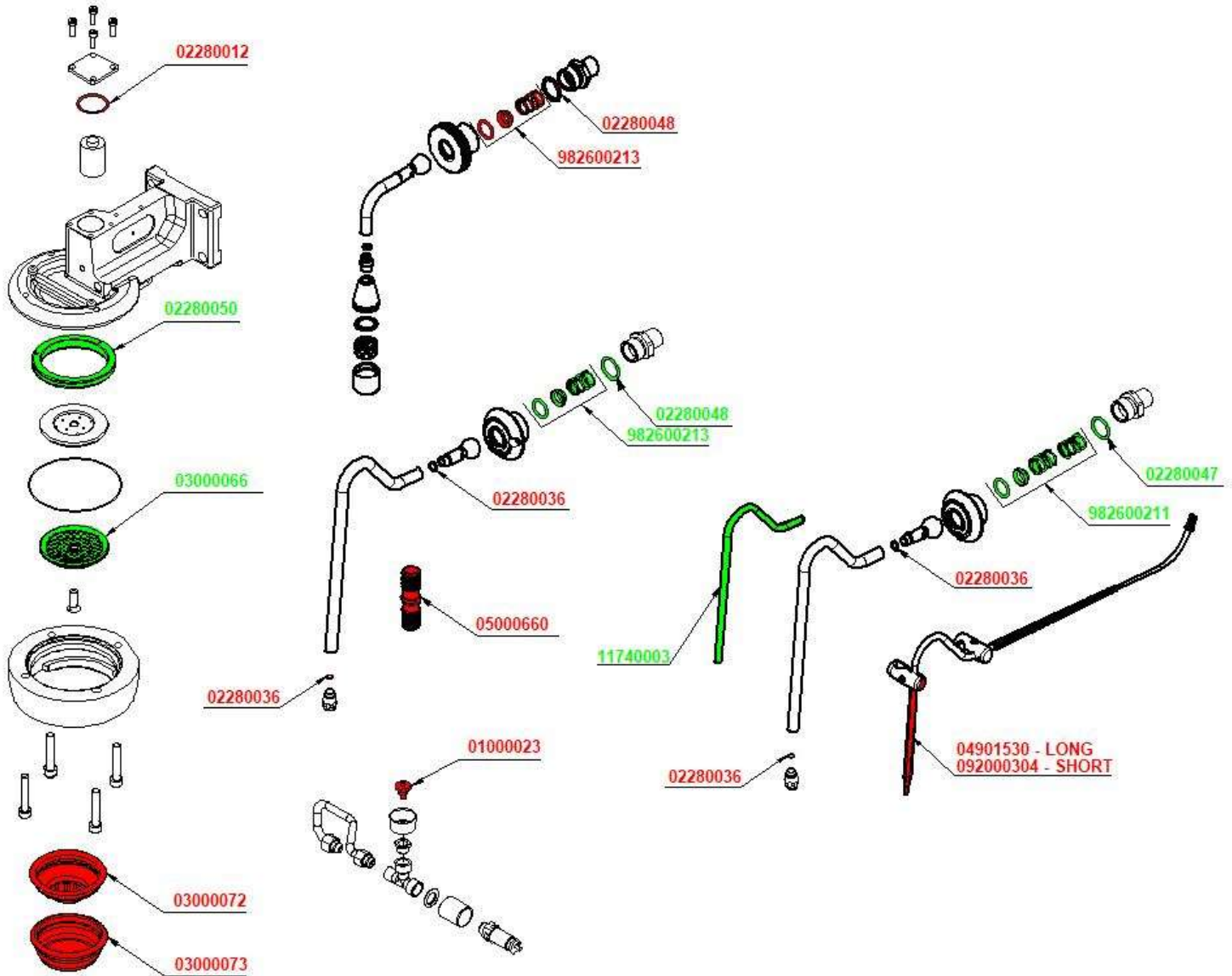

- CHANGE EVERY 4-6 MONTHS
- CHANGE EVERY 12 MONTHS



INSPIRED BY YOUR PASSION.

Simonelli Group s.p.a.

Via E. Betti, 1 - 62020 Belforte  
del Chienti - (MC) Italy

Tel. +39 0733.950243 - Fax +39  
0733.850247

e-mail: [info@victoriaarduino.com](mailto:info@victoriaarduino.com)  
[www.victoriaarduino.com](http://www.victoriaarduino.com)