

SOLera™

Installation Instructions

2 YEAR WARRANTY

Congratulations on choosing this SOLera™ Dispenser. SOLera is guaranteed to be free of manufacturing defects for two years from the original date of purchase. **Dispenser Amenities** will replace the entire unit or any component deemed by the company to be defective in manufacture, at no charge, during the warranty period. Shipping is extra. Any damage caused by misuse, mishandling or normal wear and tear is not covered by this warranty. The company makes no warranty, expressed or implied, except as above. For warranty claim, information or service, please call +1-519-685-1500. Or email info@dispenser-amenities.com.



IMPORTANT INFORMATION

You must install SOLera using **BOTH** the double-faced tape and the entire tube of silicone adhesive. **Do not fill the Dispenser until the silicone has cured for 24 hours.**

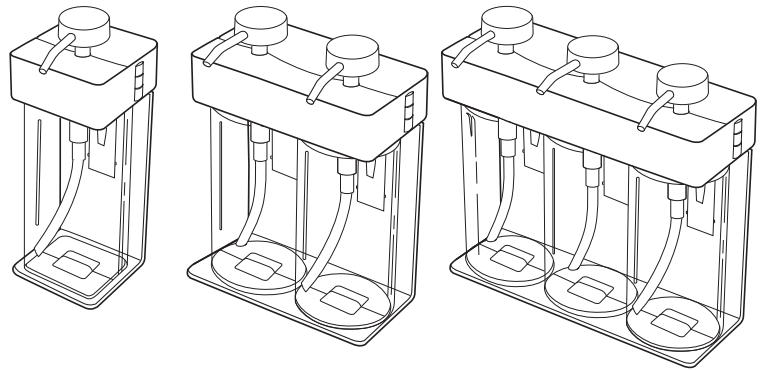

SOLera I, II, III

Mounting Instructions

1. Make certain that the wall area provides a clean, dry mounting surface. Clean with rubbing alcohol, if necessary, to remove soap film. If mounting onto molded fiberglass, surface should be cleaned with nail polish remover to eliminate any wax residue from the molding process.
2. Determine the exact location for your Dispenser. It is recommended that you place the unit away from the shower head spray. Often the wall opposite the shower head is preferable. Be certain to have plenty of clearance to open the gate and remove the bottles.
3. Unlock the gate and remove the bottles from the Dispenser.
4. Apply double-faced tape to the non-textured targets on the back of the unit. Remove protective backing on tape tabs.
5. Run a wavy bead of silicone on the entire textured area of the mounting bracket. Use the entire contents of the tube. Avoid getting any silicone into the open or recessed areas of the mounting bracket.
6. Press the unit firmly into place ensuring the tape and silicone form a strong bond with the wall.

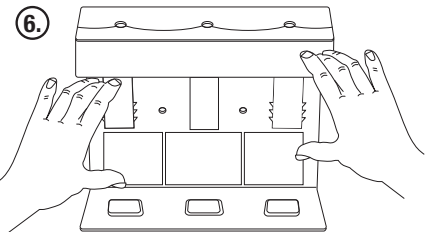
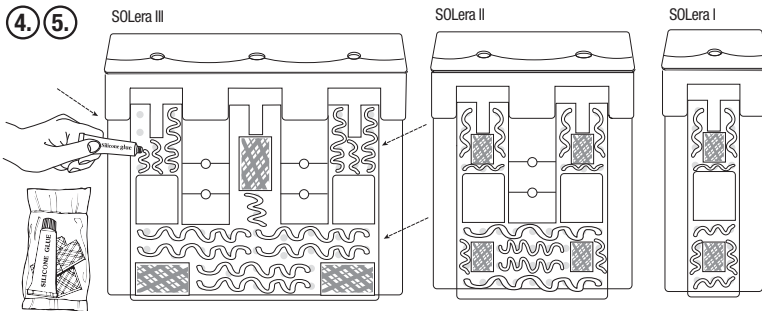
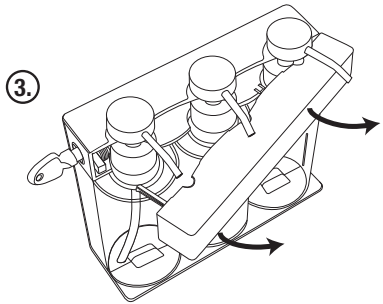
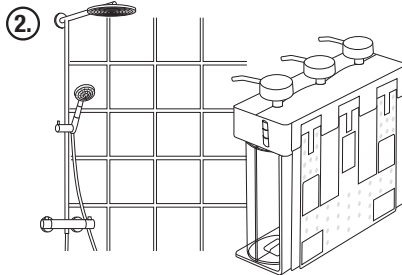
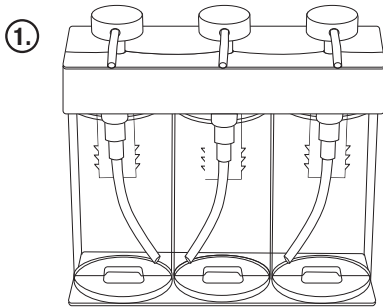

TAPE WILL SUPPORT THE BRACKET UNTIL THE SILICONE DRIES IN 24 HOURS. DO NOT INSTALL FILLED BOTTLES INTO THE DISPENSER FOR 24 HOURS.

Fill the bottles with your choice of liquids, place the bottles into position in the Dispenser and close the gate to lock them in place.

Cleaning and Maintenance

The best method to clean your Dispenser is with a soft, damp cloth. Avoid any cleaning products that have abrasives or solvents as this could void the product warranty.

Removing your Dispensers

What if you want to move them when you renovate?

The Dispensers can be removed from the shower wall without any damage. You simply take a sharp knife run it down the back of the unit, between the shower wall and dispenser back plate, cutting the silicone bond. Once you have done that, you can pull the unit from the wall. You can clean off excess silicone on the wall with a razor blade and any residue with paint thinner.



Dispenser Amenities Inc.
505 Newbold Street,
London, ON N6E 1K4 Canada

Tel: 1-800-639-4756 / 1-519-685-1500
Fax: 1-800-639-4759 / 1-519-668-4054
www.dispenser-amenities.com

www.dispenser-amenities.com/support/