



## High Wattage Strip Warmers



CONFORMS TO UL STD. UL-197

**Models:** 177SW24T, 177SW36T, 177SW48T, 177SW60T, 177SW72T,  
177SW24IN, 177SW36IN, 177SW48IN, 177SW60IN, 177SW72IN,  
177SW24TCP, 177SW36TCP, 177SW48TCP, 177SW60TCP, 177SW72TCP,  
177SW24INCP, 177SW36INCP, 177SW48INCP, 177SW60INCP, 177SW72INCP

02/2024

***Please read and keep these instructions. Indoor use only.***

## Index

<b>Introduction .....</b>	<b>3</b>
<b>Safety Instructions .....</b>	<b>3</b>
<b>Overview .....</b>	<b>4</b>
<b>Operation .....</b>	<b>5</b>
<b>Installation .....</b>	<b>5</b>
<b>Cleaning .....</b>	<b>5</b>
<b>Parts Diagram .....</b>	<b>6 - 7</b>
<b>Wiring Diagram.....</b>	<b>8</b>

## Introduction and Safety

### Introduction

1. Please read instructions before using this appliance. This appliance is for commercial use only.
2. When using electrical appliances, basic precautions should always be followed to reduce the risk of fire, electric shock, and injury.
3. Clean machine thoroughly before and after each use following the cleaning instructions provided below.

### Safety Instructions



**WARNING!**

All power must be disconnected at power source before any service procedure is performed.

1. This appliance is hot when in use. To avoid burns, do not let bare skin touch hot surfaces. Keep combustible materials, such as drapes and other furnishings, away from appliance.
2. Extreme caution is necessary when any appliance is used by or near children and whenever the appliance is left unattended.
3. Always unplug appliance when not in use and before cleaning, adjusting, or maintaining this machine. To disconnect appliance, turn switch off and remove plug from power source.
4. Do not operate any appliance with a damaged cord or plug, after the appliance malfunctions, or has been dropped or damaged. Return appliance to an authorized service facility for examination, electrical or mechanical adjustment, or repair.
5. Do not use outdoors. This appliance is not intended for wet or moist locations. Never locate appliance where it may fall into water.
6. Connect to properly grounded outlets only. Avoid the use of extension cords. Do not run cord under carpeting, runners, or the like. Arrange cord away from traffic area and where it will not create a tripping hazard.
7. This appliance is equipped with a power cord with a three blade plug. Plug ONLY into a matching three blade outlet. DO NOT cut or break off the third blade or attempt to use with a two blade extension cord.
8. To prevent a possible fire, it is recommended that the unit is placed on a non-combustible surface.
9. This appliance has electrical parts. Do not use it in areas where gasoline, paint, or flammable liquids are used or stored.

## Overview

### *Toggle Hardwired*

MODEL #	OVERALL DIMENSIONS	POWER SUPPLY	NET WEIGHT
177SW24T	24" L x 6.1"W x 2.6"H	120V, 500W	7.7 lb.
177SW36T	36" L x 6.1"W x 2.6"H	120V, 850W	11 lb.
177SW48T	48" L x 6.1"W x 2.6"H	120V, 1200W	14.33 lb.
177SW60T	60" L x 6.1"W x 2.6"H	120V, 1550W	17.6 lb.
177SW72T	72" L x 6.1"W x 2.6"H	120V, 1750W	20.87 lb.

### *Infinite Hardwired*

MODEL #	OVERALL DIMENSIONS	POWER SUPPLY	NET WEIGHT
177SW24IN	24" L x 6.1"W x 2.6"H	120V, 500W	7.7 lb.
177SW36IN	36" L x 6.1"W x 2.6"H	120V, 850W	11 lb.
177SW48IN	48" L x 6.1"W x 2.6"H	120V, 1200W	14.33 lb.
177SW60IN	60" L x 6.1"W x 2.6"H	120V, 1550W	17.6 lb.
177SW72IN	72" L x 6.1"W x 2.6"H	120V, 1750W	20.87 lb.

### *Toggle Cord and Plug*

MODEL #	OVERALL DIMENSIONS	POWER SUPPLY	NET WEIGHT
177SW24TCP	24" L x 6.1"W x 2.6"H	120V, 500W	7.7 lb.
177SW36TCP	36" L x 6.1"W x 2.6"H	120V, 850W	11 lb.
177SW48TCP	48" L x 6.1"W x 2.6"H	120V, 1200W	14.33 lb.
177SW60TCP	60" L x 6.1"W x 2.6"H	120V, 1550W	17.6 lb.
177SW72TCP	72" L x 6.1"W x 2.6"H	120V, 1750W	20.87 lb.

### *Infinite Cord and Plug*

MODEL #	OVERALL DIMENSIONS	POWER SUPPLY	NET WEIGHT
177SW24INCP	24" L x 6.1"W x 2.6"H	120V, 500W	7.7 lb.
177SW36INCP	36" L x 6.1"W x 2.6"H	120V, 850W	11 lb.
177SW48INCP	48" L x 6.1"W x 2.6"H	120V, 1200W	14.33 lb.
177SW60INCP	60" L x 6.1"W x 2.6"H	120V, 1550W	17.6 lb.
177SW72INCP	72" L x 6.1"W x 2.6"H	120V, 1750W	20.87 lb.

## Operation

1. Plug cord into grounded electrical outlet of the correct voltage. Electrical shock can occur if appliance is not grounded.
2. Flip the switch to the 'On' position.
3. Place food products directly under the elements for best results.
4. Turn unit off when not in use.
5. To disconnect appliance, turn switches off and remove plug from power source.

## Installation

1. For strip warmers of high wattage (18-25 watts per inch), 10-16" is the recommended mounting height.
2. Do not install food warmers above or around combustible surfaces.
3. Food warmers can be mounted to the underside of a shelf with a minimum gap of 1" to protect electrical system.
4. Remove the two center screws from end plates. Align the holes on the bracket with the mounting holes on the end plate. Use the screw to secure the bracket.
5. Drill 4 holes on the underside of a shelf. Use fasteners to install the brackets to the underside of the shelf.
6. A qualified electrician must install hardwired models or warranty will be void.

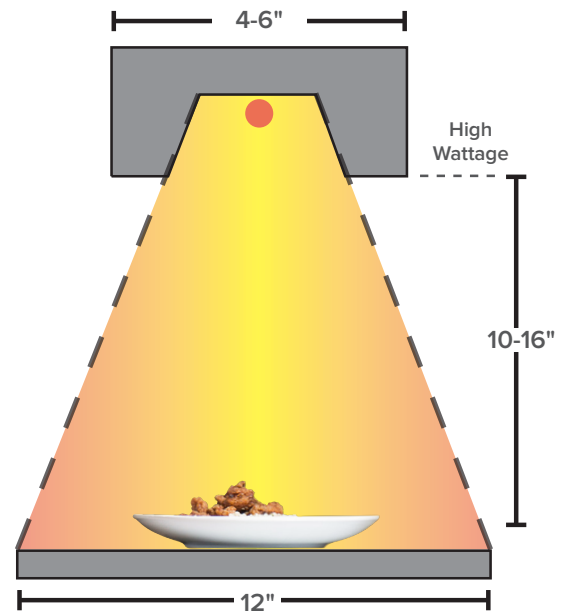

## Cleaning

1. Unplug the cord and let warmer cool before cleaning or moving.
2. This unit can be cleaned with a damp sponge and mild soap. Rinse with clean water and wipe dry.
3. Do not immerse in water or other liquid.

## Parts Diagram - Toggle Control

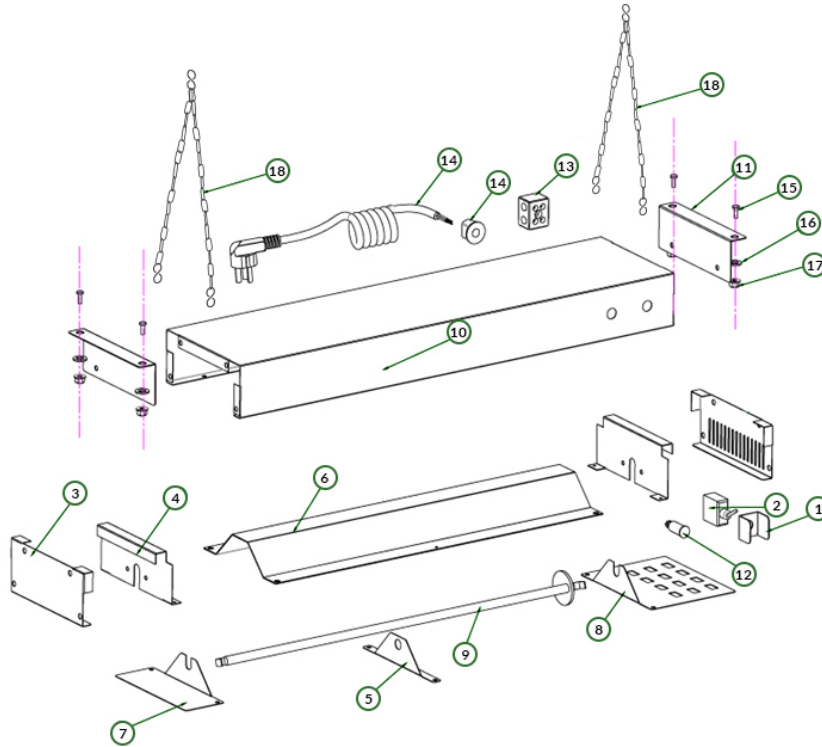

NO.	Description	Replacement Part#	Pcs.
1	Switch Guard	177PSW01 (177SW24/36/48/60/72T; 177SW24/36/48/60/72TCP)	1
2	Toggle Switch	177PSWSWITCH (177SW24/36/48/60/72T; 177SW24/36/48/60/72TCP)	1
3	End Plates		2
4	Element Guard	177PSWGUARD (177SW24/36/48/60/72T; 177SW24/36/48/60/72TCP)	1
5	Element Support (Mid)	177PSWELEM1 (177SW24/36/48/60/72T; 177SW24/36/48/60/72TCP)	1
6	Reflector		1
7	Element Support (Left)	177PSWELEM2 (177SW24/36/48/60/72T; 177SW24/36/48/60/72TCP)	1
8	Cover Plate		1
9	Element	177PSWELEM3 (177SW24T/TCP), 177PSWELEM4 (177SW36T/TCP), 177PSWELEM5 (177SW48T/TCP), 177PSWELEM6 (177SW60T/TCP), 177PSWELEM7 (177SW72T/72TCP)	1
10	Housing		1
11	Mounting Brackets	177PBRACKET (177SW24/36/48/60/72T; 177SW24/36/48/60/72TCP)	2
12	Indicator Light	177PLIGHTORG (177SW24/36/48/60/72T; 177SW24/36/48/60/72TCP)	1
13	Terminal Block	177PSWTB (177SW24/36/48/60/72T; 177SW24/36/48/60/72TCP)	1
14	Cord and Plug Set	177PSWCORD15 (177SW24/36/48/60/72T) [Sold Separately]	1
15	Screw		1
16	Washer		1
17	Nut		1
18	Support Chains	177PSWCHAIN [Sold Separately]	2

## Parts Diagram - Infinite Control

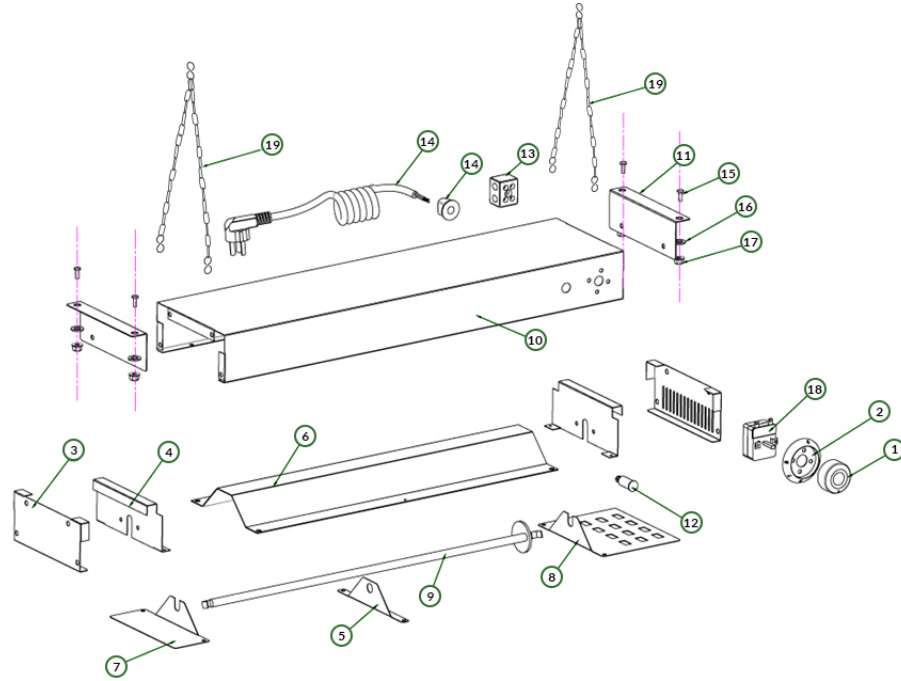

NO.	Description	Replacement Part#	Pcs.
1	Knob	177PSWKNOB (177SW24/36/48/60/72IN, 177SW24/36/48/60/72INCP)	1
2	Knob Base		1
3	End Plates		2
4	Element Guard	177PSWGUARD (177SW24/36/48/60/72IN, 177SW24/36/48/60/72INCP)	1
5	Element Support (Mid)	177PSWELEM1 (177SW24/36/48/60/72IN, 177SW24/36/48/60/72INCP)	1
6	Reflector		1
7	Element Support (Left)	177PSWELEM2 (177SW24/36/48/60/72IN, 177SW24/36/48/60/72INCP)	1
8	Cover Plate		1
9	Element	177PSWELEM3 (177SW24IN/24INCP), 177PSWELEM4 (177SW36IN/36INCP), 177PSWELEM5 (177SW48IN/48INCP), 177PSWELEM6 (177SW60IN/60INCP), 177PSWELEM7 (177SW72IN/72INCP)	1
10	Housing		1
11	Mounting Brackets	177PBRACKET (177SW24/36/48/60/72IN, 177SW24/36/48/60/72INCP)	2
12	Indicator Light	177PLIGHTORG (177SW24/36/48/60/72IN, 177SW24/36/48/60/72INCP)	1
13	Terminal Block	177PSWTB (177SW24/36/48/60/72IN, 177SW24/36/48/60/72INCP)	1
14	Cord and Plug Set	177PSWCORD15 (177SW24/36/48/60/72IN) [Sold Separately]	1
15	Screw		1
16	Washer		1
17	Nut		1
18	Infinite Heat Control	177PSWOTHERM	1
19	Support Chains	177PSWCHAIN [Sold Separately]	2

## Wiring Diagram - Toggle Control

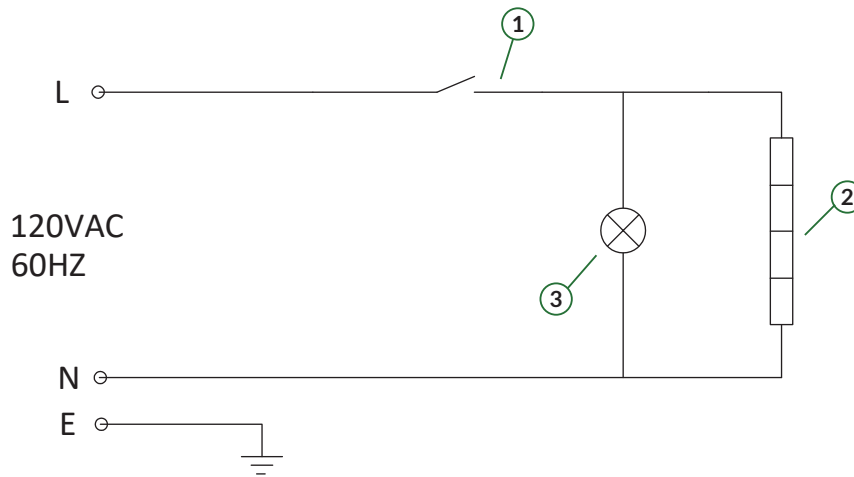

NO.	Description
1	Switch
2	Heater
3	Indicator

## Wiring Diagram - Infinite Control

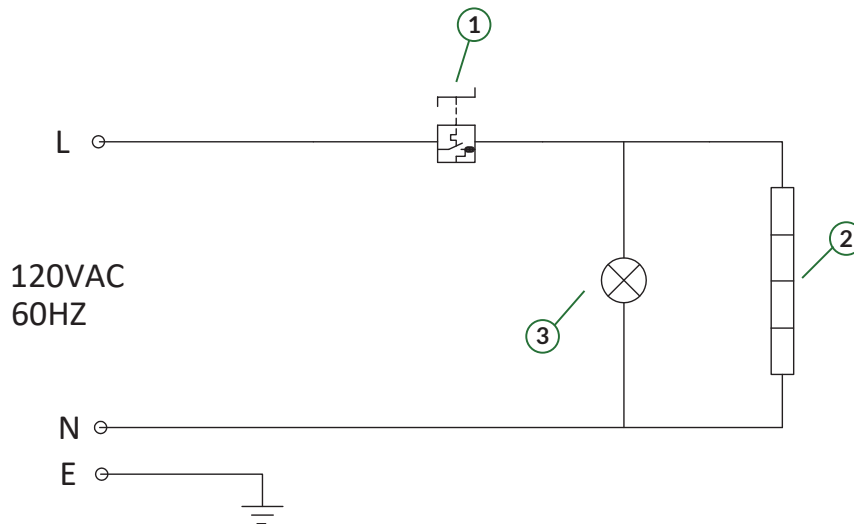

NO.	Description
1	Energy Regulator
2	Heater
3	Indicator