



177PBD3

Powdered Beverage Dispenser

Base Models: _____

#177PBD3

Note:

Please read the manual thoroughly prior to equipment setup, operation, and maintenance.

Index

Safety	3
Specifications	3
Parts Identification	4
Installation	6
Operation Instructions	6
Programming Instructions.....	7
Cleaning.....	9



E478819



E478819

CONFORMS TO UL STD. 197
CONFORMS TO NSF/ANSI STD. 4

Safety

- This appliance is designed for COMMERCIAL USE ONLY.
- DO NOT use outdoors.
- DO NOT alter or deform the power cord or plug in any way. This may cause electrical shock and/or damage unit.
- Do not pull the power cord.
- ALWAYS use on a circuit that is properly protected and capable of the rated load.
- DO NOT operate the dispenser unless it is properly grounded.
- Cleaning & maintenance should only be performed by properly trained persons with supervision.
- This unit is NOT intended for use by persons (including children) with reduced physical, sensory, or mental capabilities, or lack of experience and knowledge.
- Children should be supervised to ensure that they do not play with the appliance.
- ALWAYS unplug unit from power supply before cleaning or servicing.
- DO NOT submerge or saturate with water, unit is not waterproof.
- Install the machine in a dry area away from water and water splashes.
- DO NOT operate if your hands or feet are wet.
- Please keep 15cm (6") minimum air space all around the dispenser.

Specifications

Model No.	177PBD3
Voltage	AC120V 50Hz
Heater Power	1600W
Water Reservoir	5L
Hot Water Tank	1.8L
Powder Canister	3pc x 2.5L/pc
Dimensions	315mm(W) x 470mm(D) x 665mm(H)
Weight	48.5 lb.

Parts Identification (Front)

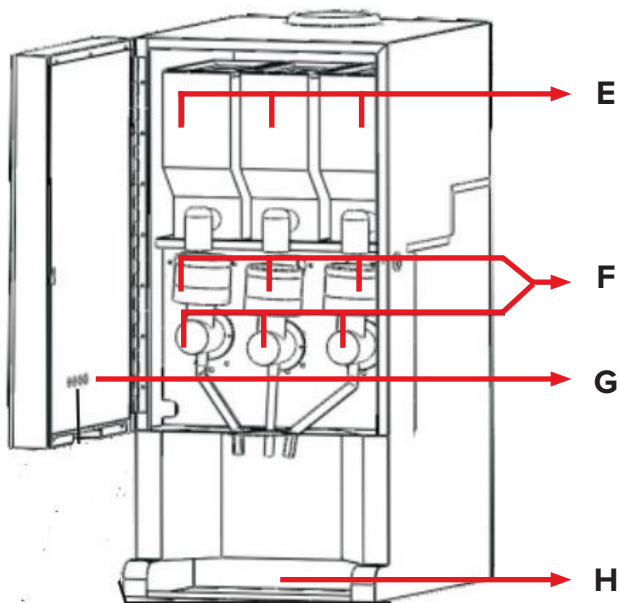
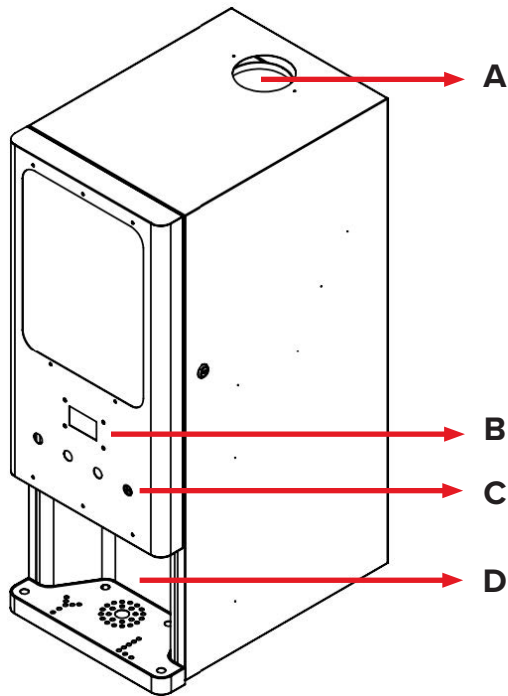

Button Board (B)

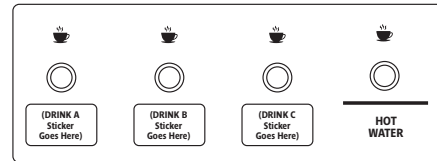

A	Water inlet
B	LED display
C	Button board
D	Drink outlets
E	Powder canisters
F	Mixing system
G	Mode switch
H	Waste water tray

Mode Switch (G)

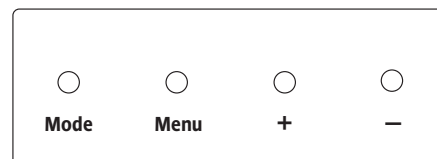

Parts Identification (Back)

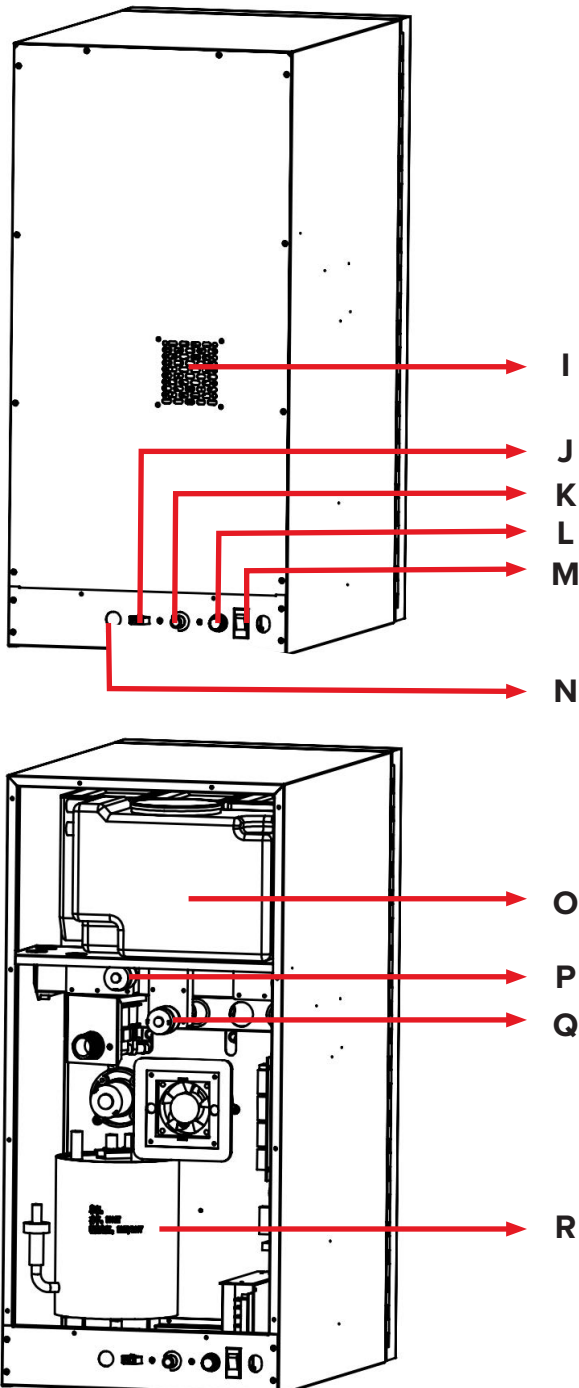

I	Exhaust fan
J	Wire connect for water pump
K	Pipe connect for water pump
L	Fuse set
M	Power switch
N	Hot water drain pipe
O	Water reservoir
P	Powder dispensing motor
Q	Mixing motor
R	Heating tank

Installation

NOTE: Please use filtered and softened water. If using ground or tap water, please soften it first.

1. Carefully unpack the machine and check for damage and missing parts.
2. Place the unit on a stable, flat surface in a dry area near power supply and water supply. Do not connect water line or power cord at this time.
3. For adequate ventilation, when installing the unit, maintain a distance of 6 in. between the unit and walls or other obstacles. Increase the distance if the unit is placed near a heating source.
4. Leave 60 in. of free space in front of the machine to allow for easy use and maintenance.
5. Attach the water line to the inlet located on the rear of the dispenser. Hold the water inlet fitting with a wrench when tightening the water line.
6. Turn on the water supply. Make sure to check for leaks at the water inlet. Tighten fitting if needed.
7. Connect the power supply cord to the power supply.
8. Run the full inspection upon turning on the unit and prior to first use.
 - Upon full inspection, the unit will check the functions of the powder dispensing motor, mixing motor, and water outlet. (See "Menu Functions" on page 7 for more information on running the full inspection.)

Operation Instructions

NOTE: See pages 7-8 for specific programming instructions.

1. Connect the machine to the power supply.
2. Verify that the water supply is ON, then turn the toggle switch to the ON Position.
3. The unit will begin filling with water and the LED display will show "FIL".
4. Add your powdered ingredient:
 - (a) Follow the arrow to rotate the ingredient outlet.
 - (b) Raise up the front side of canister and take it apart.
 - (c) Open the lid, and fill the canister with ingredients.
 - (d) Connect the axle and stall canister.
 - (e) Follow the arrow to rotate the ingredient outlet to use state.

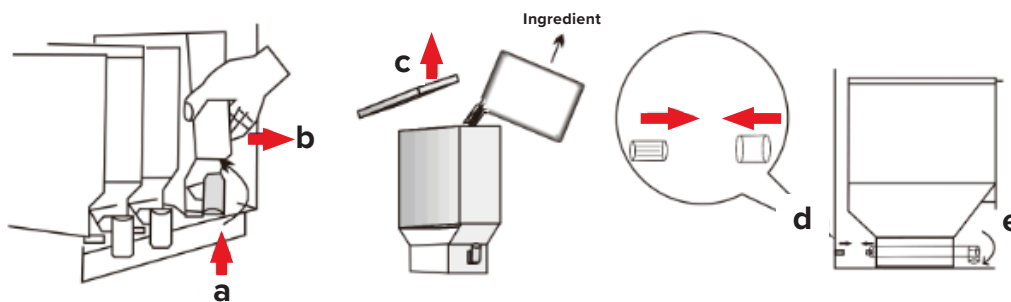

5. Set the water temperature. (See "Menu Functions" below for more information on setting the water temperature.)
 - After setting the water temperature the unit will display "HEA" while it heats up to temp.
 - Once the unit reaches desired temp, it will display "rEA".
6. Program the output volume of water and powdered ingredient to be dispensed from each drink option. (See "Data Settings" on page 8 for more information on setting volume output.)
7. Place cup under dispenser and press the drink button of your choice to dispense your beverage.

Programming Instructions

Button Board

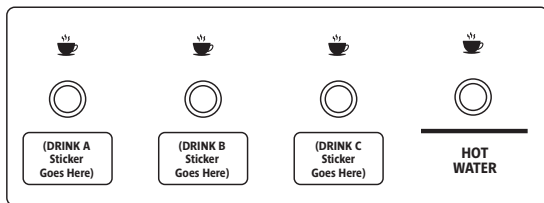

Mode Switch

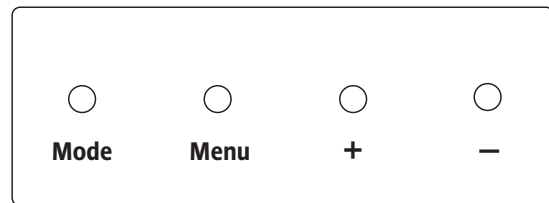

Menu Functions

1. To activate all menu functions, press the "Mode" button located on the inside panel of the door.
2. After pressing "Mode," the LED Display will show "SET." You can now navigate through the menu settings.
3. Cycle through the menu settings by pressing the "Menu" button.
4. There will be four available setting screens for you to navigate shown in the chart below. Press "Menu" until you reach your desired screen.
5. When you are finished altering settings, press "Mode" again to save and exit.

Screen	Default	After	Function Setting	Description	Save
1	"CLA"	Auto Cleaning		When the unit displays "CLA", press "Drink A". Machine will clean pipe and mixing chamber automatically.	Mode
2	"000"	Ex. "095" equals 95 degrees	High Temp.	Use "+" and "-" to adjust the temperature. Unit will display "HEA" while it reaches temp.	
3	"000"	Ex. "090" equals 90 degrees	Low Temp.	Use "+" and "-" to adjust the temperature.	
4	"CHE"	Full Check		When the unit displays "CHE", press "Drink A". Machine will check functions of powder dispensing motor, mixing motor, and water outlet.	

Data Settings

1. To activate all drink data setting functions, press the "Mode" button located on the inside panel of the door.
2. After Pressing "Mode," the LED display will show "SET." You can now navigate through the drink data settings.
3. Cycle through the menu settings by pressing the drink button in which you would like to alter settings for. (Example: "Drink A")
4. There will be four available setting screens for you to navigate shown in the chart below. Press "Drink" button until you reach your desired screen.
5. When you are finished altering settings, press "Mode" again to save and exit.

Screen	Default	After	Function Setting	Description	Save
1	"000"	Ex. "025"	Price	Increase and reduce by pressing buttons "+" and "-".	Mode
2	"A-1"	Ex. "065" equals 6.5 seconds	Water Volume	The number show on LED is water dispensing time, for example "065" means 6.5 seconds. Increase and reduce by pressing buttons "+" and "-".	
3	"A-2"	Ex. "030" equals 3 seconds	Powder Volume	The number show on LED is powder dispensing time, for example "030" means 3 seconds. increase and reduce by pressing buttons "+" and "-".	
4	1A000000	Ex. "1A000029" equals 29 cups sold	Sales	Increase and reduce by pressing buttons "+" and "-".	

Cleaning

- DO NOT use harsh chemicals or abrasive materials.
- DO NOT submerge or saturate with water, unit is not waterproof.
- Cleaning should be done at the end of every workday.
- Only those persons trained and qualified in equipment repair should attempt to clean the inside of this dispenser.

To clean the outside of the machine:

1. Turn the ON/OFF toggle switch to OFF, unplug, and allow unit to completely cool before cleaning.
2. Use a clean cloth with hot water mixed with Noble Chemical Sunbright liquid dish soap (or a neutral soap) to clean the outside of the unit.
3. For dirt smudges on the unit's exterior, a damp cloth will suffice.

To clean the inside of the machine:

1. Remove powder canisters and empty of all powder. (See "Operation Instructions" on page 6.)
2. Run the cleaning menu function. ("CLA" is the first screen of the menu functions.)