

# STAINLESS STEEL Microwave Shelf

**REGENCY**  
Space Solutions



## FEATURES

- 24" x 24" stainless steel microwave shelf
- 18-gauge type 430 stainless steel
- Includes a grommet hole to allow power cords to pass through



## SPECIFICATIONS

ITEM	GAUGE	DEPTH	WIDTH	LOADING CAPACITY	GROMMET
600MS2424	18 Gauge	24"	24"	200 lb.	Included

**FRONT**

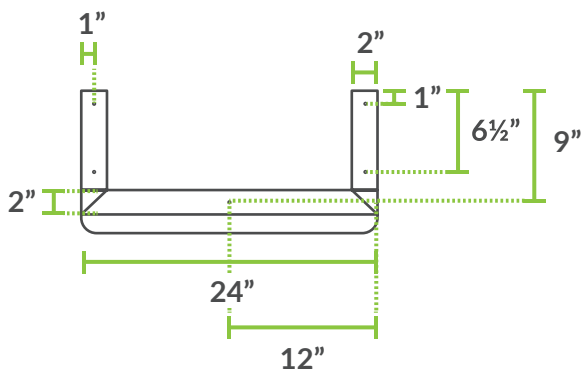

**SIDE**

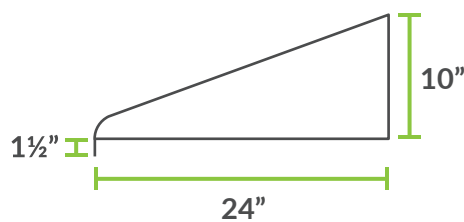

**TOP**

