



BEVERAGE-AIR

3779 Champion Blvd., Winston-Salem, NC 27105
1-888-845-9800 Fax# 1-336-245-6453
<http://www.Beverage-Air.com>

CUSTOMER'S CHOICE FOR A HOT KITCHEN
Tested & Certified to Ambient Class of 100°F

3 Year Parts/Labor Warranty
Additional 2 Year Compressor Warranty

UCRY/UCF SERIES UNDERCOUNTER UNITS

Compact shallow depth undercounter refrigerators and freezers with stainless steel exterior, heavy duty construction including durable sub top, 120° stay-open field reversible doors with cartridge style hinges & snap-in door gaskets.

CABINET CONSTRUCTION

20" and 27" base models designed to fit in limited space with stainless steel exterior and aluminum interior. Heavy duty construction with durable 1/2" insulated sub-top and 2" thick CFC and HCFC-free foamed-in-place polyurethane insulation. Cartridge style hinges with black anodized aluminum pull style door handles and 120° stay-open door feature. Snap-in-place vinyl magnetic gaskets. Standard options: 6" casters standard and 2 steel wire epoxy coated shelves per door section.

REFRIGERATION

Balanced interior forced air system with high humidity evaporator coils. Refrigeration system operates at 36° to 38°F for optimal food preservation while freezer model temperature is held at 0°F and below. Refrigerators and freezers utilize environmentally friendly refrigerants. Refrigerators use R134a and freezers use R404A refrigerants. Both are CFC and HCFC-free providing full compliance with environmental safety standards.

ELECTRICAL

Units wired at factory and ready for connection to a 115/60/1 phase, 15 amp dedicated outlet. 8' long cord and plug set included.

AVAILABLE ACCESSORIES

- Roller kit
- Stacking collars (20 & 27 models only)
- Shelf dividers
- Overshelf kits
- Richlite and composite cutting boards

OPTIONAL UPGRADES

- LED lighting (glass door refrigerators—not available on UCF27)
- Stainless steel interior
- Door locks
- Left hand hinge door(s) (excludes UCR34Y)
- Left hinge door(s) & 3" casters packed
- Door thermometer

Item No. _____
Quantity _____

**SHALLOW DEPTH
UNDERCOUNTER
REFRIGERATORS
AND FREEZERS
FOOD PREPARATION SERIES**

**MODELS:
UCR20Y
UCF20
UCF24
UCR27Y
UCF27
UCR34Y**



UCR / UCF20



UCR UCF27



UCR34

ELECTRICAL CONNECTION

Units pre-wired at factory and include 8' long cord and plug set.



115/60/1
NEMA-5-15P



Available From:

Model Specified _____

Store# _____

Location _____

Quantity _____



BEVERAGE-AIR

PLAN VIEWS

Shallow Depth Undercounter Refrigerators/Freezers

Models: UCR20Y, UCF20, UCF24, UCR27Y, UCF27, UCR34Y

MODEL	UCR20Y	UCF20	UCF24	UCR27Y	UCF27	UCR34Y
EXTERNAL DIMENSIONAL DATA						
Length Overall (inches)	20"	20"	24"	27"	27"	34"
Length Overall (mm)	508	508	609	686	686	864
Depth Overall (inches) - Less handle	22"	22"	25 3/4"	27 3/4"	27 3/4"	23 5/8"
Depth Overall (mm) - Less handle	559	559	654	705	705	600
Height Overall— on 6" legs (inches)	31 1/8"	31 1/8"	34 1/2"	34 1/2"	34 1/2"	31"
Height Overall—on 6" legs (mm)	791	791	876	876	876	787
Depth with Door Open 90 °	40 1/2"	40 1/2"	48 7/8"	53 1/4"	53 1/4"	38"
Clear Door Opening (inches)	15 3/4" x 18 3/16"	15 3/4" x 18 3/16"	21 9/16" x 19 9/16"	22 1/2" x 21 3/8"	22 1/2" x 21 3/8"	13/ 1/8" x 18"
Number of doors	1	1	1	1	1	2
INTERNAL DIMENSIONAL DATA						
NET Capacity (cubic ft.)	2.7	2.7	5.8	6.2	6.2	5.5
NET Capacity (Liters)	77	77	164	176	176	156
Internal Length Overall (inches)	16"	16"	20"	23"	23"	29 3/8"
Internal Length Overall (mm)	406	406	508	584	584	746
Internal Depth Overall (inches)	13"	13"	19 7/8"	18"	18"	17"
Internal Depth Overall (mm)	330	330	505	457	457	432
Internal Height Overall (inches)	19"	19"	23"	23"	23"	19"
Internal Height Overall (mm)	483	483	584	584	584	483
Number of shelves	2	2	2	2	2	4
ELECTRICAL DATA						
Full Load Amperes 115/60/1	3.0	5.3	6.0	4.0	6.0	4.0
ENERGY CONSUMPTION (KWH)	2.73	6.18	N/A	2.79	N/A	3.12
REFRIGERATION DATA						
Horsepower	1/6	1/4	1/4	1/6	1/4	1/5
WEIGHT DATA						
Gross Weight (Crated lbs)	113	114	130	157	165	164
Gross Weight (Crated kg)	51	51	60	71	74	75

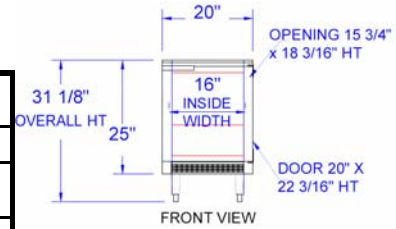

UCR/UCF20 FRONT

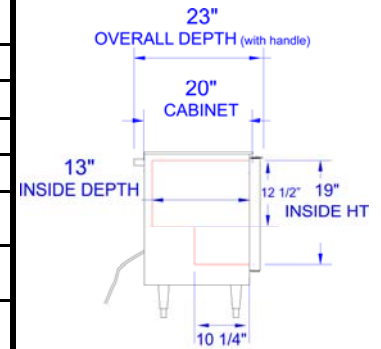

UCR/UCF20 END

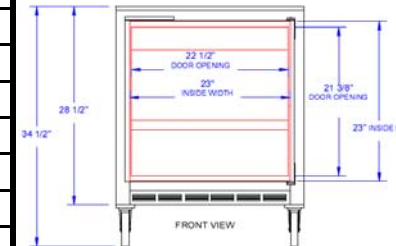

UCR/UCF27 FRONT

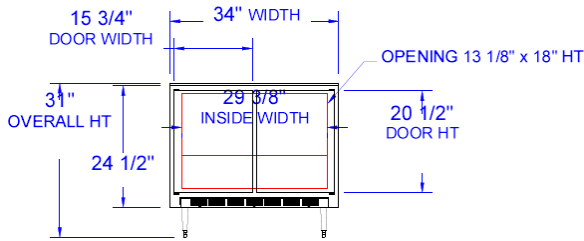

UCR34 FRONT

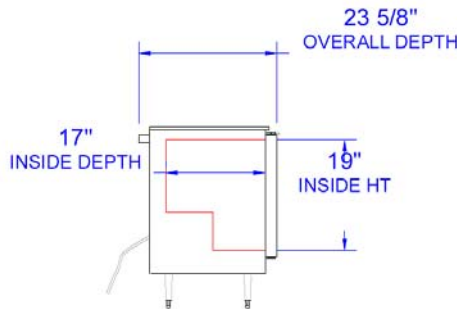

UCR34 FRONT

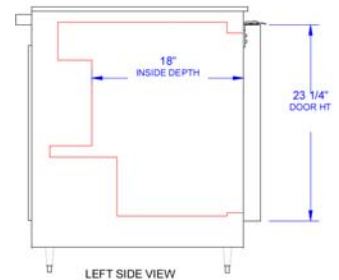

UCR/UCF27 END

BEVERAGE-AIR® CORPORATION

3779 Champion Blvd. • Winston-Salem, NC 27105 USA • (336) 245-6400 • Fax (336) 245-6453 • (888) 845-9800 • www.beverage-air.com

Specifications are subject to change without prior notice. 07/15