

# BUNN®

## BrewWISE® Single Soft Heat® DBC® Brewer

ITEM#

PROJECT

DATE



**Single SH DBC with  
1.5 gallon SH Servers**  
(servers sold separately)

Dimensions: 35.8" H x 9.3" W x 21.2" D  
(90.9cm H x 23.6cm W x 53.8cm D)

### Features

#### BrewWISE Brewing System

- Brews 11.4 gallons (43.2 litres) of perfect coffee per hour.
- Brews ½, 1, or 1½ gallon (1.9, 3.8 or 5.7 litre) batches.
- Stores individual coffee and flavor profiles using adjustable water volume, bypass percentage, pulse brew, and pre-infusion timing.
- Operate any combination of BrewWISE equipment error-free with wireless brewer-grinder interface via Smart Funnel®.
- Reduce accidents with safety features that decrease hot splashes from funnel, eliminate brewing when funnel or server is not present.
- Troubleshoot all switches and electrical components from the front panel with advanced diagnostic service tools.
- Energy saver mode reduces tank temperature during idle periods.
- Consistently brew perfect coffee using Digital Brewer Control™ with pulse brew.
- Simplify installation and calibration by creating your own recipe cards and dedicated funnels with the BrewWISE Recipe Writer using your PC (Windows® compatible).
- International electrical configurations available.
- Lower hot water faucet model available.



lower faucet  
model

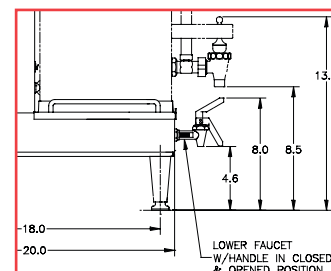

For current specification sheets and other information, go to [www.bunn.com](http://www.bunn.com).

### Related Products

**Easy Clear® EQHP-10**  
Product No. : 39000.0004

**Easy Clear® EQHP-10L**  
Product No. : 39000.0001

**Single/Dual Filter Pack**  
Product No. : 20138.0000  
Packed per case: 500  
Dimensions:  
5¼" Base x 4¼" Sidewall  
13.3 cm Base x 10.8 cm Sidewall



**BrewWISE® Recipe Writer (BRW)**  
Product No.: 34444.0000 (120V)  
Dimensions:  
2¾" H x 6⅞" W x 9½" D  
5.56 cm H x 16.2 cm W x 24.1 cm D



**Recipe Card**  
Product No.: 34447.0000  
• Program a recipe to be used on brewer or grinder.



**Ad Card**  
Product No.: 34448.0000  
• Program a message to appear on the brewer's display.



**G9-2T DBC**  
Product No.: 33700.0000  
**G9-2TA DBC**  
Intl. Product No.: 33700.0005  
• Grinder holds 6 pounds each of regular and decaf or specialty beans.



#### Model

Single SH DBC  
G9-2T DBC  
SH Server and Stands

#### Agency Listing



## Dimensions & Specifications

Model	Product #	Volts	Amps	Tank Heater Watts	Total Watts	Capacity	Cubic Measure	Shipping Weight	Cord Attached
Single SH DBC	33600.0000	120/240	17.5	4000	4100	11.4 gal./hr.	7.9 ft <sup>3</sup>	59 lbs.	No
Single SH DBC <sup>†</sup>	33600.0028	120/240	17.5	4000	4100	11.4 gal./hr.	7.9 ft <sup>3</sup>	59 lbs.	No
Single SH DBC	33600.0001	120/240	17.5	4000	4100	11.4 gal./hr.	7.9 ft <sup>3</sup>	59 lbs.	No
Single SH DBC*	33600.0013	120/240	17.5	4000	4100	11.4 gal./hr.	7.9 ft <sup>3</sup>	59 lbs.	No
Single SH DBC	33600.0022	120	15.8	1800	1900	5.3 gal./hr.	7.9 ft <sup>3</sup>	59 lbs.	No
Single SH DBC <sup>†</sup>	33600.0029	120	15.8	1800	1900	5.3 gal./hr.	7.9 ft <sup>3</sup>	59 lbs.	No
G9-2T DBC	33700.0000	120	9.4	n/a	1128	n/a	5.9 ft <sup>3</sup>	67 lbs.	Yes
SH Server (1.5 gal.)	27850.0001	n/a	n/a	n/a	n/a	1.9 gal.	2.4 ft <sup>3</sup>	17 lbs.	n/a
SH Server* (1.5 gal.)	27850.0004	n/a	n/a	n/a	n/a	1.9 gal.	2.4 ft <sup>3</sup>	17 lbs.	n/a
1SH Stand	27825.0000	120	.8	n/a	90	1 SH Server	1.2 ft <sup>3</sup>	13 lbs.	Yes
1SH Stand*	27825.0004	120	.8	n/a	90	1 SH Server	1.2 ft <sup>3</sup>	13 lbs.	Yes
2SH Stand	27875.0000	120	1.5	n/a	180	2 SH Servers	2.1 ft <sup>3</sup>	22 lbs.	Yes
2SH Stand*	27875.0003	120	1.5	n/a	180	2 SH Servers	2.1 ft <sup>3</sup>	22 lbs.	Yes

<sup>†</sup> Models have lower faucet. \*Models have black decor. <sup>†</sup>Model has funnel lock system.

Note: Soft Heat® Brewers and Servers are boxed and shipped separately.

**Brewing capacity:** based upon incoming water temp of 60°F (140°F rise).

Models listed as 120/208V or 120/240V must be connected to 208V or 240V electrical service respectively. Please refer to the installation manual.

Electrical: Brewer is 3-wires plus ground service rated 120/240V, single phase, 60Hz.

Grinder is 2-wires plus ground service rated 120V, 60Hz, circuit required, ¾ HP motor.

Plumbing: 20-90 psi (138-621 kPa). Machine supplied with ¼" male fitting.

