

SCL Series



Sandwich/Salad Prep Refrigerators



- Insulated lid for superior cold retention
- Full length cutting boards (various depths)
- Refrigerated cabinet base for added cold storage
- 430 Series stainless steel exterior, door and sides stand up to the rigors of day-to-day use
- 304 Series, corrosion-resistant stainless steel interior
- Includes (4) casters, (2) locking for stability
- Adjustable shelf/shelves included
- ETL Safety and ETL Sanitation Listed. NSF Compliant

178SCLM2 - 48" Mega Top Sandwich/Salad Prep Refrigerator



Product Features



- Full length, 8" deep cutting board
- Top holds up to (18) 1/6 size food pans up to 6" deep
- Insulated lid for better temperature retention
- (2) Self closing swing doors with recessed handle
- Refrigerated base with (2) adjustable shelves included
- Stainless steel door, sides and interior
- Includes (4) casters; (2) locking
- Temperature range of 32°F - 41°F
- NSF Compliant

Technical Data

Dimensions

Exterior Dimensions	47"W x 35 1/2"D x 46"H
Interior Dimensions	42 3/4"W x 23 3/4"D x 23 1/2"H
Cutting Board Dimensions	46 5/8"W x 8"D x 3/4"H
Net Volume (internal)	9.75 cu. ft.
Net Weight	253 lbs.
Pan Capacity (6" deep)	Up to (18) 1/6 size
Packaging Dimensions	52 1/4"W x 39 1/4"D x 49 1/2"H

Cooling

Temperature Range	32° - 41°F
Refrigerant	R-134a
Max. Ambient Temperature	90°F
Defrosting	Automatic
Temperature Controller	Digital
Horsepower	1/3

Construction

Exterior Material	430 Series stainless steel
Interior Material	304 Series stainless steel
Insulation Material	Foamed in place polyurethane
Number of Doors	2
Number of Shelves	2
Shelf Material	Plastic coated steel
Shelf Load Capacity	90 lbs.

Electrical

Voltage	120
Amps	7.8
Hz	60
Phase	1
Plug Type	NEMA 5-15P
Electrical Cord Length	84"

When you need more room for toppings but have limited space on the prep line, this Avantco SCLM2 is the perfect solution, with extra ingredient storage compared to a normal 48" prep table, and a 8" deep cutting board to prepare your culinary creations! This unit features a mega top design that can hold up to (18) 1/6 size food pans full of your most commonly used meats, cheeses, and toppings, and an insulated lid to keep in cold temperatures when not in use. A 8" deep cutting board gives you plenty of space to assemble subs, salads, and hoagies, while the exterior sides and door of the unit are made from 430 stainless steel to stand up to the rigors of day to day use.

To help you spend more time at the prep line, the refrigerated cabinet base below the work area gives you room to store extra ingredients, garnishes, condiments, or topping pans, and it is made of 304 stainless steel to resist corrosion and make cleaning a breeze. Two adjustable plastic coated shelves also help you stay organized.

Additional features include an interior fan that directs cold air up to the topping area, and (4) casters for easy mobility.

178SCLM2 - 48" Mega Top Sandwich/Salad Prep Refrigerator



www.AvantcoRefrigeration.com

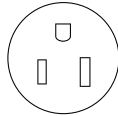

NEMA 5-15P

Plan View

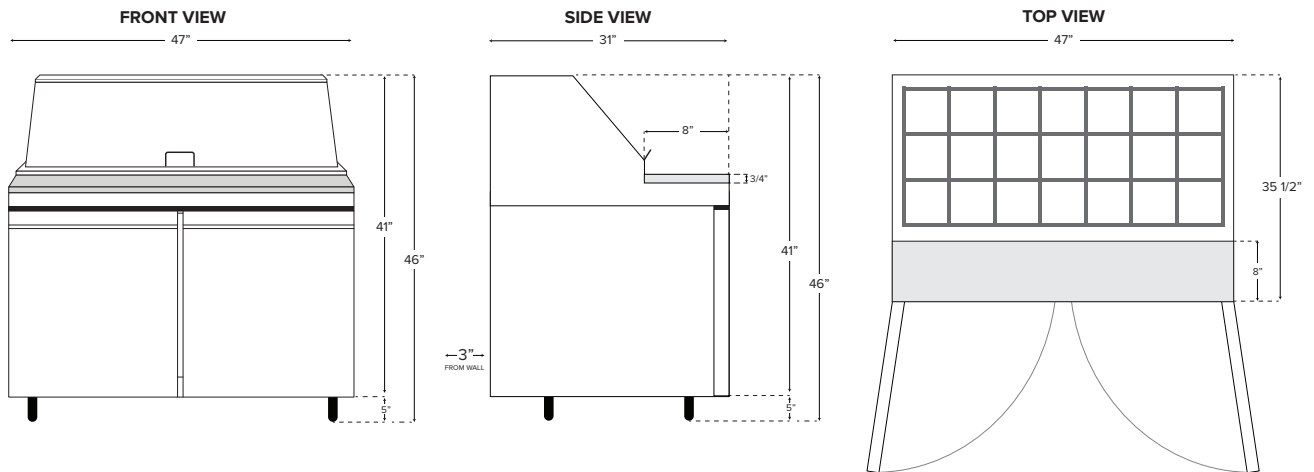

Warranty Information

This item is backed by a 1 year parts and labor warranty with 5 year warranty on the compressor, unless otherwise stated. For warranty inquiries or service, first locate the model number (located on the front of the unit, or inside the door jamb) and the bold number on the service plate (located on the front of the unit). Next, call 1-800-678-5517. You must have the model number and service plate number when contacting service technicians.



Parts & Labor



Compressor

Failure to contact Avantco Refrigeration prior to obtaining equipment service may void your warranty.

Avantco Refrigeration will not warrant coverage for component failure or other damages that arise under the following conditions:

- Failure to install and/or use unit within proper operating conditions specified by Avantco Refrigeration
- Failure to properly maintain the unit. This includes, but is not limited to, basic preventative maintenance such as cleaning the condenser coil.
- Installation in a non-commercial or residential application
- Products sold or used outside of the United States

Additionally, no claims can be made against this warranty for spoilage of product, loss of sales or profits, or any other consequential damages.

Normal wear type parts, such as light bulbs and gaskets, are not included in warranty coverage.